

Wednesday, November 25, 2015 11:37:16 AM  
 P:\14165\_Loring House\Drawings\Working\CAD\Plot Files\D1.05-DEMO PLAN ROOF.dwg

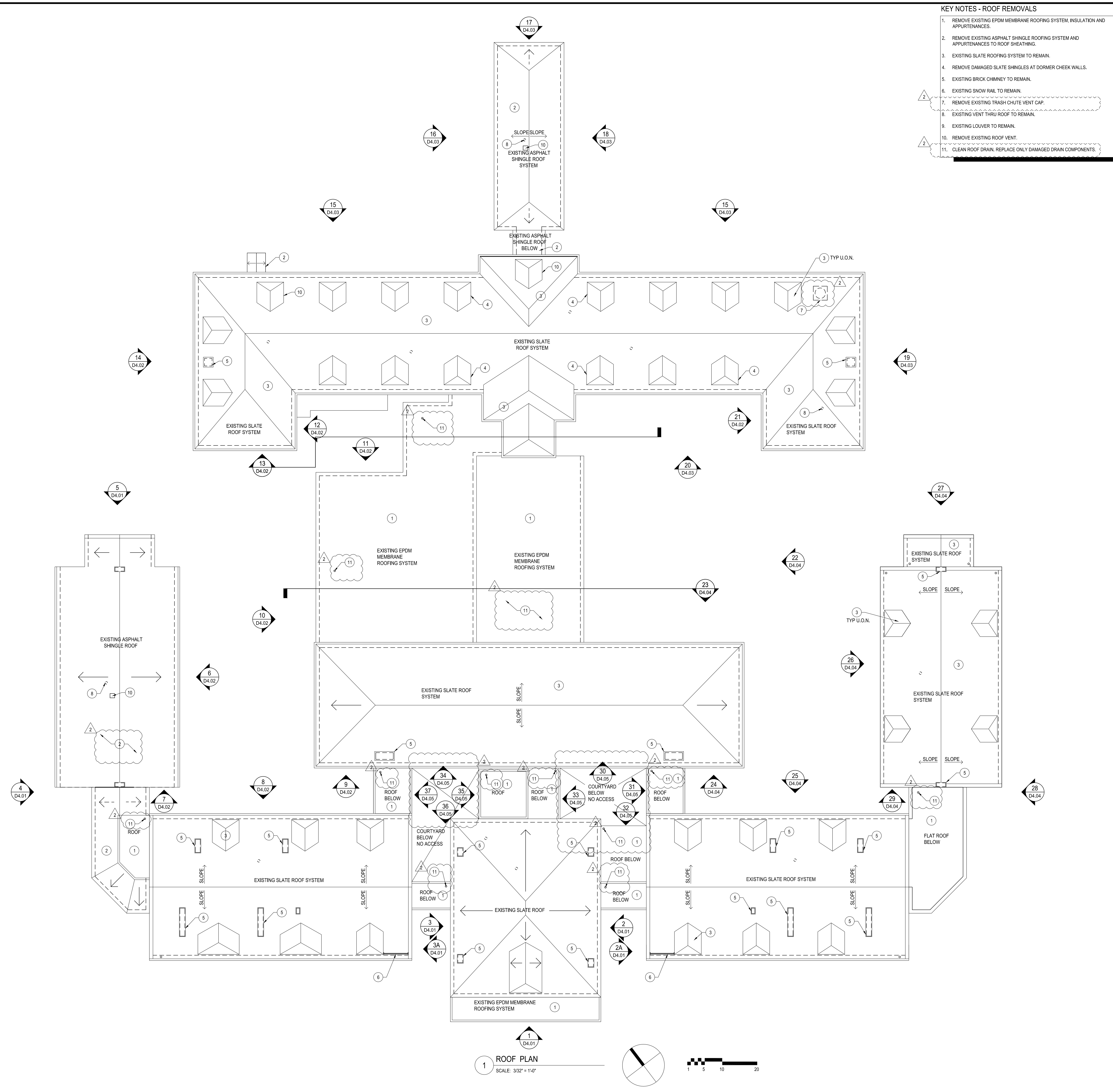

- KEY NOTES - ROOF REMOVALS**
1. REMOVE EXISTING EPDM MEMBRANE ROOFING SYSTEM, INSULATION AND APPURTENANCES.
  2. REMOVE EXISTING ASPHALT SHINGLE ROOFING SYSTEM AND APPURTENANCES TO ROOF SHEATHING.
  3. EXISTING SLATE ROOFING SYSTEM TO REMAIN.
  4. REMOVE DAMAGED SLATE SHINGLES AT DORMER CHEEK WALLS.
  5. EXISTING BRICK CHIMNEY TO REMAIN.
  6. EXISTING SNOW RAIL TO REMAIN.
  7. REMOVE EXISTING TRASH CHUTE VENT CAP.
  8. EXISTING VENT THRU ROOF TO REMAIN.
  9. EXISTING LOUVER TO REMAIN.
  10. REMOVE EXISTING ROOF VENT.
  11. CLEAN ROOF DRAIN. REPLACE ONLY DAMAGED DRAIN COMPONENTS.

**tat** |  
 the architectural team

The Architectural Team, Inc.  
 50 Commandant's Way at Admiral's Hill  
 Chelsea MA 02150  
 T 617.889.4402  
 F 617.884.4329  
 www.architecturalteam.com  
 ©2011 The Architectural Team, Inc.

Consultant:

Revision:  
 2 | REVISION | 2015.11.25

Architect of Record:



Drawn: SEA  
 Checked: PRR  
 Scale: 3/32" = 1'-0"  
 Key Plan:

Project Name:  
**LORING HOUSE**

1125 Brighton Avenue  
 Portland, ME 04102

Sheet Name:  
**Roof Plan**

Project Number:  
 14165  
 Issue Date:  
 November 25, 2015

Sheet Number:  
**D1.05**