

Consultant:

**(SGC)** **SGC ENGINEERING, LLC**  
- Civil Design & Survey Engineering  
- Environmental & Regulatory Permitting  
- Electrical Power Systems Engineering

SERVING OUR CLIENTS IN THE U.S.A. & CANADA

101 County Road  
Westbrook, Maine 04092  
Tel: 207-541-6100  
Fax: 207-541-6101 14 School Street, Suite 205  
Bangor, Maine 04401  
Tel: 207-541-6100  
Fax: 207-541-6101 14 School Street, Suite 205  
Bangor, ME 04401  
Tel: 207-541-6100  
Fax: 207-541-6101 14 School Street, Suite 205  
Bangor, ME 04401  
Tel: 207-541-6100  
Fax: 207-541-6101

Revision:

- 08/24/15
- 10/19/15
- 11/25/15

Engineer of Record:

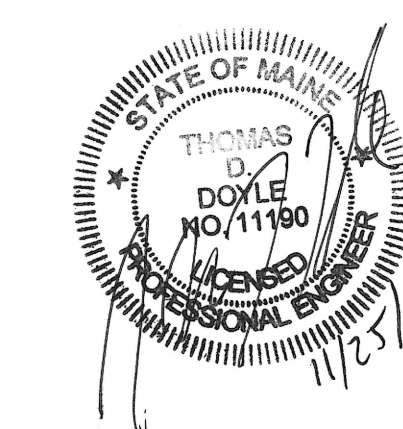

PROGRESS DOCUMENTS  
NOT FOR CONSTRUCTION

Drawn: TDD  
Checked: TMH  
Scale: AS NOTED  
Key Plan:

Project Name:  
**LORING HOUSE**

1125 Brighton Avenue  
Portland, ME 04102

Sheet Name:  
**Grading & Drainage Plan**

Project Number:  
14165

Issue Date:  
OCTOBER 19, 2015

Sheet Number:

**C3.1**

**Legend:**

**EXISTING**

- Found Monument
- Found Iron Pipe
- Catch Basin
- Sanitary Manhole
- Manhole
- Fire Hydrant
- Lamp Post
- Utility Pole w/Guy Wire
- Sign
- Water Shutoff
- Water Valve
- 6" Bollard
- Coniferous Tree
- Deciduous Tree
- Chainlink Fence
- Approximate Boundary Line
- Approximate Abutter's Line
- Approximate Easement
- Major Contour
- Minor Contour
- SD Storm Drain
- S Sanitary Sewer
- OHW Overhead Wire
- Building

**PROPOSED**

- Asphalt Pavement/Sidewalk
- Concrete Slabs/Walkway
- Loam and Seed/Re-Grade
- Storm Drain
- Underdrain/Foundation Drain
- HC Accessible Routes
- Catch Basin
- Window Well w/Drain Cover

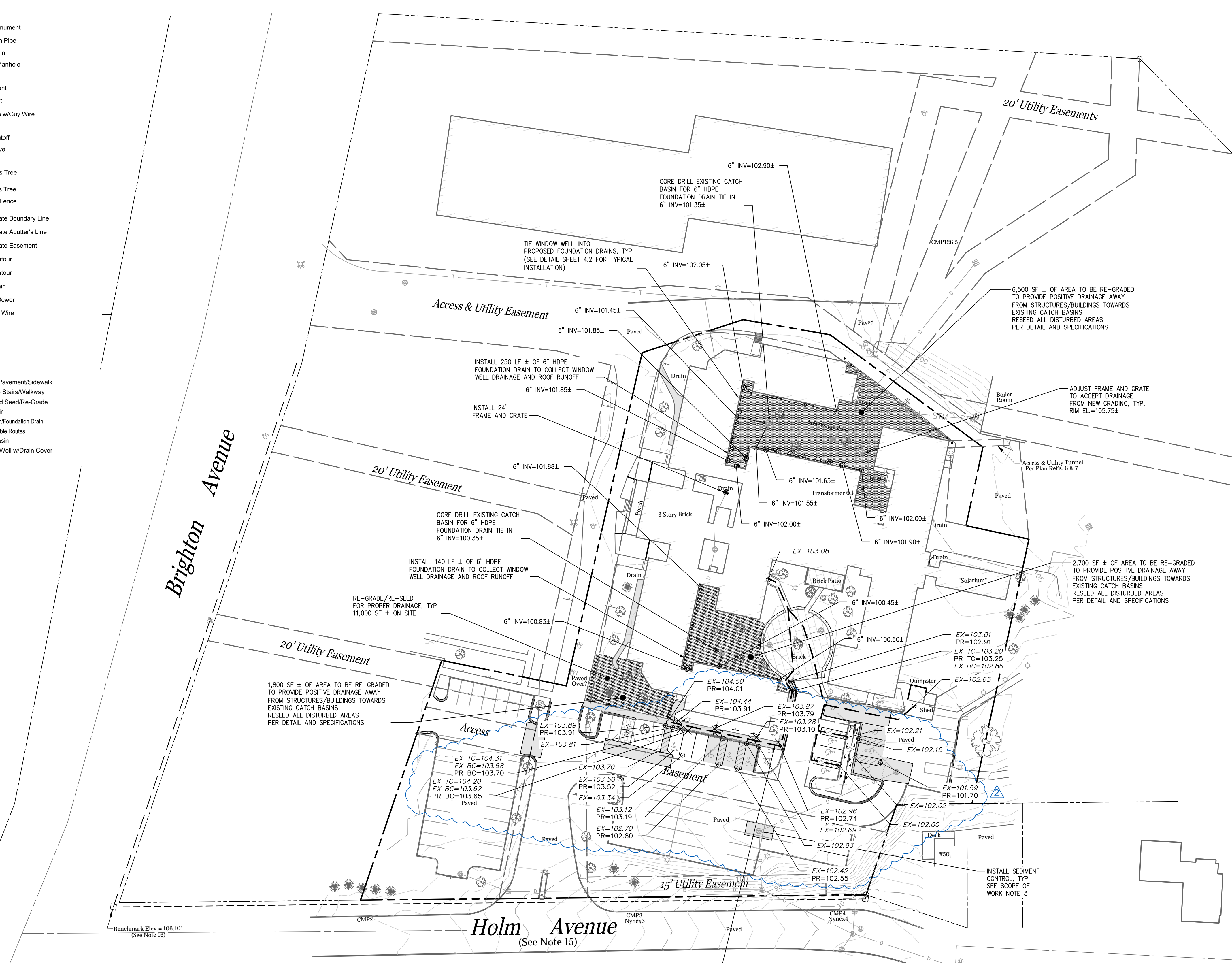

- SCOPE OF WORK NOTES:**
- ACCESSIBLE ROUTES SHALL HAVE A MAXIMUM SLOPE OF 1:20 IN THE DIRECTION OF TRAVEL AND A MAXIMUM CROSS SLOPE OF 1:50 (V.I.F.). PROVIDE NEW ACCESSIBLE CURB RAMPS AT ALL CURBS ALONG ACCESSIBLE ROUTES.
  - PROTECT EXISTING TREES/VEGETATION THROUGHOUT SITE DURING CONSTRUCTION.
  - INSTALL CATCH BASIN SEDIMENT CONTROL DEVICES IN ALL EXISTING CATCH BASINS IN VICINITY OF CONSTRUCTION AREAS THROUGHOUT SITE FOR EROSION AND SEDIMENT CONTROL. SEE DETAIL SHEET 4.2.

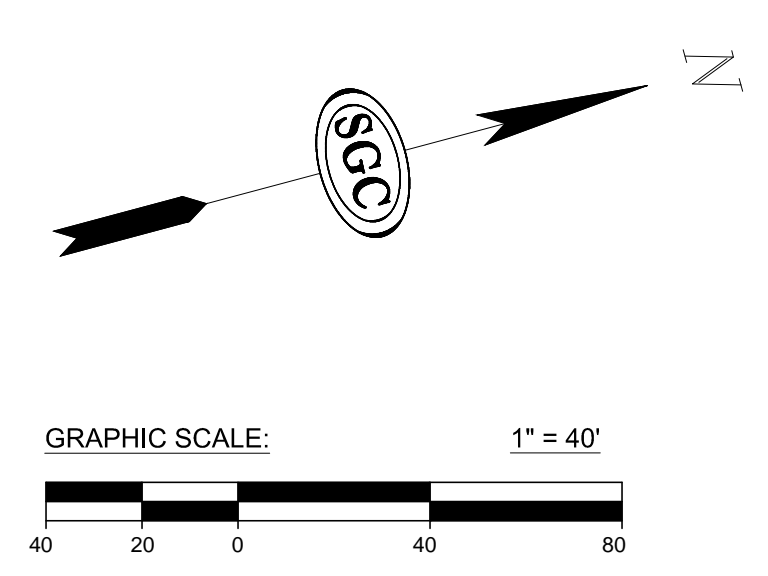

ACCESSIBLE ROUTES SHALL HAVE A MAXIMUM SLOPE OF 1:20 IN THE DIRECTION OF TRAVEL AND A MAXIMUM CROSS SLOPE OF 1:50 (V.I.F.). PROVIDE NEW ACCESSIBLE CURB RAMPS AT ALL CURBS ALONG ACCESSIBLE ROUTES. ALL AREAS TO BE FIELD VERIFIED AT A LATER DATE PRIOR TO CONSTRUCTION.