

NO REPRODUCTION OR MISUSE OF THIS DOCUMENT WITHOUT WRITTEN PERMISSION FROM GRANT HAYS ASSOCIATES IS PROHIBITED

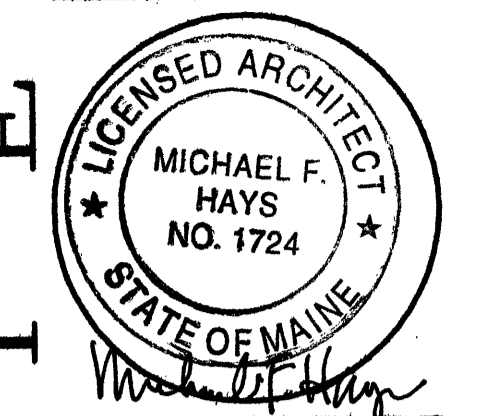

REVISIONS

PHASE II  
**EVERGREEN CREDIT UNION**  
 225 RIVERSIDE STREET PORTLAND, MAINE

ARCHITECTURE  
 INTERIOR DESIGN  
 P.O. BOX 8179 FALMOUTH, MAINE 04105  
 (207) 871-6900 (207) 871-8308

ENLARGED  
 SECOND FLOOR  
 PLAN

SCALE 1/4" = 1'-0"  
 DATE 12 NOV. 07  
 DRAWN BY SAM/MPH  
 JOB NO. 070901  
 DRAWING NO. **A-2**

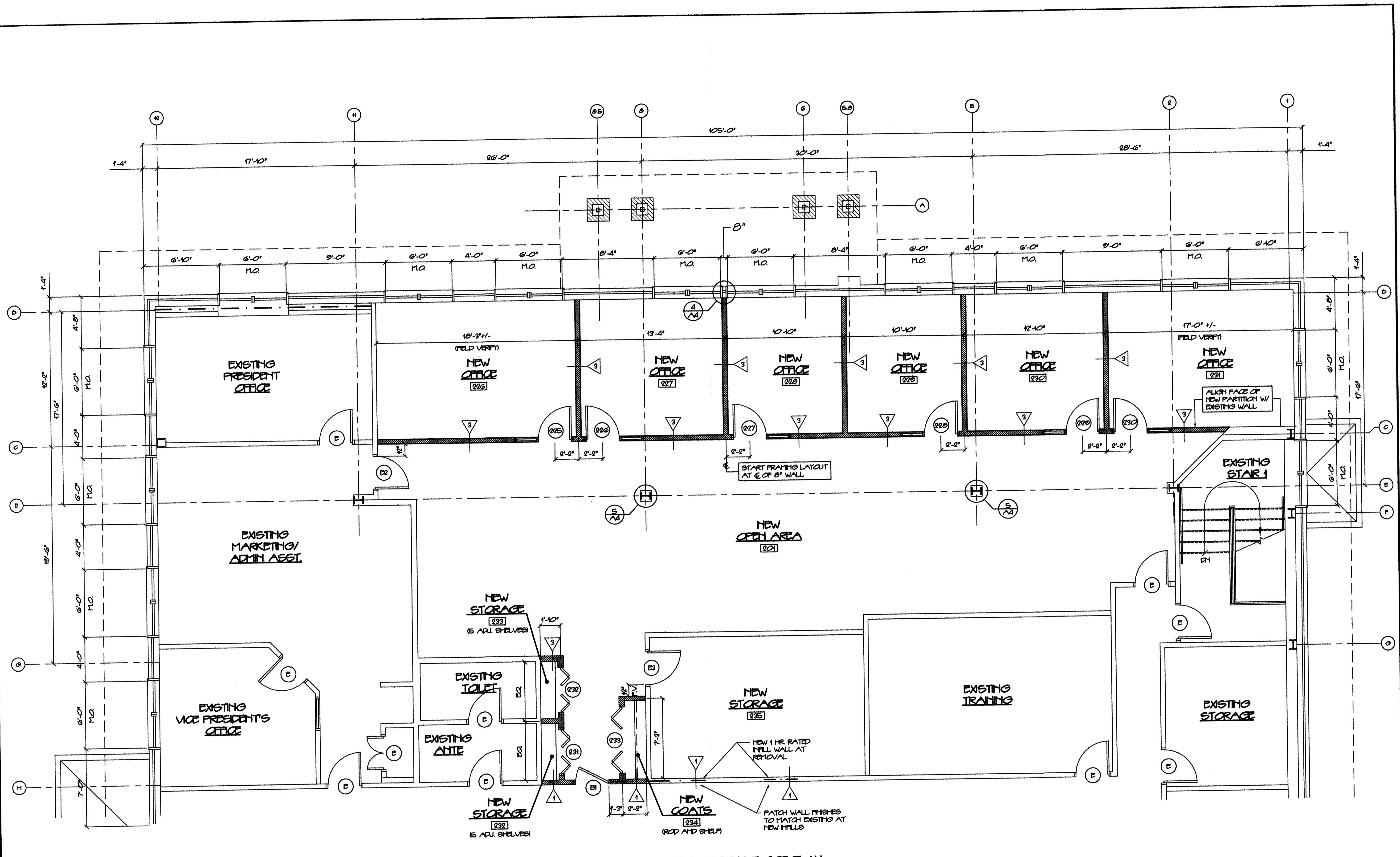

**PARTIAL SECOND FLOOR PLAN**  
 SCALE 1/4" = 1'-0"

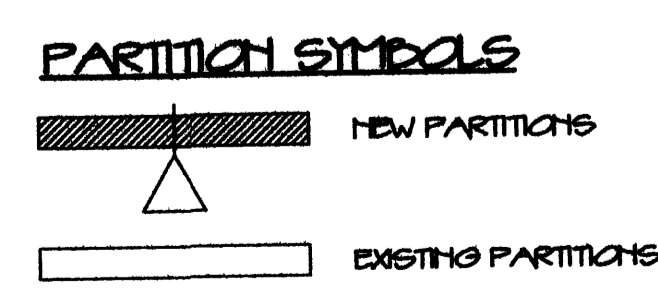

PARTITION LEGEND	
SYMBOL	DETAIL
	1 AS
	NOT USED
	3 AS

**GENERAL NOTE**

- SEE SHEET A-6 FOR ACCESSIBILITY NOTES AND DETAILS.
- PROVIDE INTERIOR WINDOW SILENTE WINDOW BLINDS AT OFFICE 226, 227, 228, 229, 230 & 231.

