



**APPLICATION FOR PERMIT**  
**DEPARTMENT OF BUILDING INSPECTIONS SERVICES**  
**ELECTRICAL INSTALLATIONS**

Date September 4, 1984  
 Receipt and Permit number 05320

To the CHIEF ELECTRICAL INSPECTOR, Portland, Maine.

The undersigned hereby applies for a permit to make electrical installations in accordance with the laws of Maine, the Portland Electrical Ordinance, the National Electrical Code and the following specifications:

LOCATION OF WORK: 155 Riverside Street (Verrillo's)  
 OWNER'S NAME: Northeast Motor Lodge ADDRESS: New Hampshire

OUTLETS: Receptacles \_\_\_\_\_ Switches \_\_\_\_\_ Plugmold \_\_\_\_\_ ft. TOTAL 6 3.00  
 FIXTURES (number of): Incandescent \_\_\_\_\_ Fluorescent \_\_\_\_\_ (not strip) TOTAL 8 3.00  
 Strip Fluorescent \_\_\_\_\_ ft. \_\_\_\_\_

SERVICES: Overhead \_\_\_\_\_ Underground \_\_\_\_\_ Temporary \_\_\_\_\_ TOTAL amperes \_\_\_\_\_

METERS: (number of) \_\_\_\_\_

MOTORS: (number of) \_\_\_\_\_  
 Fractional \_\_\_\_\_  
 1 HP or over \_\_\_\_\_

RESIDENTIAL HEATING: Oil or Gas (number of units) \_\_\_\_\_  
 Electric (number of rooms) \_\_\_\_\_

COMMERCIAL OR INDUSTRIAL HEATING: Oil or Gas (by a main boiler) \_\_\_\_\_  
 Oil or Gas (by separate units) \_\_\_\_\_  
 Electric: Under 20 kws \_\_\_\_\_ Over 20 kws \_\_\_\_\_

APPLIANCES: (number of)  
 Ranges \_\_\_\_\_ W/a \_\_\_\_\_  
 Cook Tops \_\_\_\_\_ Dis \_\_\_\_\_  
 Wall Ovens \_\_\_\_\_ Dis \_\_\_\_\_  
 Dryers \_\_\_\_\_ Comp \_\_\_\_\_  
 Fans \_\_\_\_\_ Others (denote) \_\_\_\_\_  
 TOTAL \_\_\_\_\_

MISCELLANEOUS: (number of)  
 Branch Panels \_\_\_\_\_  
 Transformers \_\_\_\_\_  
 Air Conditioners Central Unit \_\_\_\_\_  
 Separate Units (windows) \_\_\_\_\_  
 Signs 20 sq. ft. and under \_\_\_\_\_  
 Over 20 sq. ft. \_\_\_\_\_  
 Swimming Pools Above Ground \_\_\_\_\_  
 In Ground \_\_\_\_\_  
 Fire/Burglar Alarms Residential \_\_\_\_\_  
 Commercial \_\_\_\_\_  
 Heavy Duty Outlets, 220 Volt (such as welders) 30 amps and under \_\_\_\_\_  
 over 30 amps \_\_\_\_\_  
 Circus, Fairs, etc. \_\_\_\_\_  
 Alterations to wires \_\_\_\_\_  
 Repairs after fire \_\_\_\_\_  
 Emergency Lights, battery \_\_\_\_\_  
 Emergency Generators \_\_\_\_\_

INSTALLATION FEE DUE: \_\_\_\_\_  
 FOR ADDITIONAL WORK NOT ON ORIGINAL PERMIT ..... DOUBLE FEE DUE: \_\_\_\_\_  
 FOR REMOVAL OF A "STOP ORDER" (304-16.b) .....  
 TOTAL AMOUNT DUE: 6.00

INSPECTION: Will be ready on \_\_\_\_\_, 19\_\_ ; or Will Call  \_\_\_\_\_  
 CONTRACTOR'S NAME: Freeman Cleaves  
 ADDRESS: 49A Pleasant Hill Road, Falmouth  
 TEL.: 797-3566  
 MASTER LICENSE NO.: 2957 SIGNATURE OF CONTRACTOR: \_\_\_\_\_  
 LIMITED LICENSE NO.: \_\_\_\_\_  
 Robert Orr for Freeman Cleaves

INSPECTOR'S COPY — WHITE  
 OFFICE COPY — CANARY  
 CONTRACTOR'S COPY — GREEN



APPLICATION FOR PERMIT

B.O.C.A. USE GROUP ..... 949

B.O.C.A. TYPE OF CONSTRUCTION .....

ZONING LOCATION ..... B-2 ..... PORTLAND, MAINE .. August 6, 1984

CITY OF PORTLAND

To the CHIEF OF BUILDING & INSPECTION SERVICES, PORTLAND, MAINE

The undersigned hereby applies for a permit to erect, alter, repair, demolish, move or install the following building, structure, equipment or change use in accordance with the laws of the State of Maine, the Portland B.O.C.A. Building Code and Zoning Ordinance of the City of Portland with plans and specifications, if any, submitted herewith and the following specifications:

LOCATION ..... 155 Riverside Street ..... Fire District #1 □, #2 □

1. Owner's name and address Verillo's, Cape Telephone .....

2. Lessee's name and address Telephone .....

3. Contractor's name and address Bailey Sign, Thompson Point Telephone 774-2843

Proposed use of building ..... No. of sheets

Material ..... No. stories ..... Heat ..... Style of roof ..... Roofing

Other buildings on same lot ..... No. families

Estimated structural cost \$ ..... Applied Fees \$

FIELD INSPECTOR - Mr. Carroll @ 775-5451 Base Fee .....

Late Fee .....

TOTAL \$ 75.00

to erect 5 x 10 pole sign, illuminated as shown in plans attached

Stamp of Special Conditions

NOTE TO APPLICANT: Separate permits are required by the installers and subcontractors of heating, plumbing, electrical and mechanicals.

DETAILS OF NEW WORK

Is any plumbing involved in this work? Is any electrical work involved in this work?
If not, what is proposed for sewage?
Form notice sent?
Height average grade to top of plate Height average grade to highest point of roof
Solid or filled land? earth or rock?
Material of foundation Thickness, top bottom cellar
Kind of roof Rise per foot Roof covering
No. of chimneys Material of chimney's of lining Kind of heat fuel
Flaming Lumber - Kind Dressed or full size? Corner posts Sills
Size Girders Columns or girders Size Max. on centers
Studs (outside walls and carrying partitions) 2x4-16' G. C. Bridging in every floor and flat roof span over 8 feet
Joists and rafters 1st floor 2nd 3rd roof
On centers 1st floor 2nd 3rd roof
Maximum span 1st floor 2nd 3rd roof
If one story building with masonry walls, thickness of walls? height?

IF A GARAGE

No. cars now accommodated on same lot to be accommodated number commercial cars to be accommodated
Will auto zone repairing be done other than minor repairs to cars habitually stored in the proposed building?

APPROVALS BY: DATE BUILDING INSPECTION - PLAN EXAMINER ZONING: B. H. Mallory 8/6/84 BUILDING CODE: Fire Dept.: Health Dept.: Others:

MISCELLANEOUS Will work require disturbing of any tree on a public street? Will there be in charge of the above work a person competent to see that the State and City requirements pertaining thereto are observed?

Signature of Applicant Russell, Carlene Phone # Type Name of above 1 □ 2 □ 3 □ 4 □ Other and Address

FIELD INSPECTOR'S COPY APPLICANT'S COPY OFFICE FILE COPY

Carroll

*Handwritten:* 10/10/55

REPORT &  
RECOMMENDATIONS  
FOR THE  
CONSTRUCTION OF  
A  
ROAD



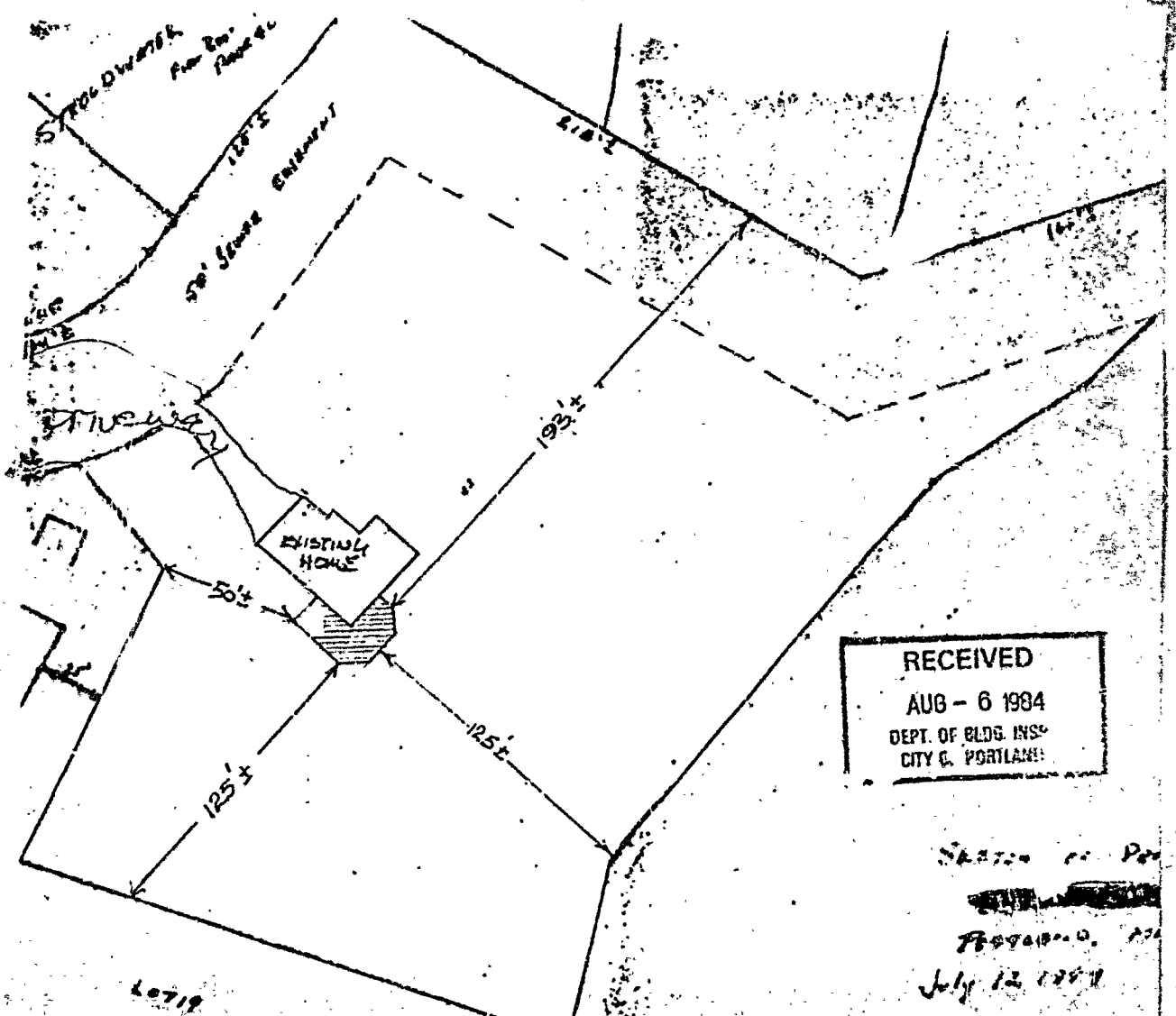

RECEIVED  
 AUG - 6 1984  
 DEPT. OF BLDG. INSP.  
 CITY OF PORTLAND

SECTION OF PLAN  
 JULY 12 1979

RECEIVED  
 JUL 18 1979  
 DEPT. OF BLDG. INSP.  
 CITY OF PORTLAND

R.P. T...  
 Frank H.  
 Box 72  
 Woodford  
 Portland

42719  
 NADZO PROPERTY  
 PLOT PLAN IS EXISTING HOME  
 AND PROPOSED SCREEN  
 PORCH ADDITION WITH  
 SETBACKS  
 71 STROUDWATER RD  
 PORTLAND MAINE  
 THE GILMAN GROUP  
 3 DANA STREET  
 PORTLAND MAINE  
 772-0541

PLOT PLAN

APPLICATION FOR PERMIT

PERMIT ISSUED

B.O.C.A. USE GROUP ..... B.O.C.A. TYPE OF CONSTRUCTION 01091

SEP. 6 1984

ZONING LOCATION B-2 PORTLAND, MAINE Sept. 4, 1984

CITY OF PORTLAND

To the CHIEF OF BUILDING & INSPECTION SERVICES, PORTLAND, MAINE

The undersigned hereby applies for a permit to erect, alter, repair, demolish, move or in all the following building, structure, equipment or change use in accordance with the Laws of the State of Maine, the Portland B.O.C.A. Building Code and Zoning Ordinance of the City of Portland with plans and specifications, if any, submitted herewith to the following specifications:

LOCATION 155 Riverside Street Fire District #1 [ ] #2 [ ]
1. Owner's name and address Northeast Motor Lodge, NE Telephone
2. Lessee's name and address Verrillo's Rest, 155 Riverside Telephone 775-6536
3. Contractor's name and address Lease - Robert Orr Telephone

Proposed use of building No. of stories No. families
Last use No. families
Material No. stories Heat Style of roof Roofing
Other buildings on same lot

Estimated contractual cost \$8,000 Appeal Fees \$
FIELD INSPECTOR - Mr. Carroll @ 775-5451 Base Fee
Late Fee
TOTAL \$ 50.00

16' x 30' addition to existing building for storage

Stamp of Special Conditions

send to #2

NOTE TO APPLICANT: Separate permits are required by the installers and subcontractors of heating, plumbing, electrical and mechanicals.

DETAILS OF NEW WORK

Is any plumbing involved in this work? Is any electrical work involved in this work?
Is connection to be made to public sewer? If not, what is proposed for sewage?
Has septic tank notice been sent? Form notice sent?
Height average grade to top of plate Height average grade to highest point of roof
Size front depth No. stories solid or filled land? earth or rock?
Material of foundation Thickness, top bottom cellar
Kind of roof Rise per foot Roof covering
No. of chimneys Material of chimneys of lining kind of heat fuel
Framing Lumber - Kind Dressed or full size? Corner posts Sills
Size Girder Columns under girders Size Max. on centers
Studs (outside walls and carrying partitions) 2x4-16" O. C. Bridging in every floor and flat roof span over 8 feet.
Joists and rafters: 1st floor 2nd 3rd roof
On centers: 1st floor 2nd 3rd roof
Maximum space: 1st floor 2nd 3rd roof
If one story building with masonry walls, thickness of walls? height?

IF A GARAGE

No. cars now accommodated on same lot accommodated number commercial cars to be accommodated
Will automobile repairing be done other than motor cars habitually stored in the proposed building?

APPROVALS BY:

BUILDING INSPECTION - PLAN EXAM
ZONING: [Signature]
BUILDING CODE: [Signature]
Fire Dept. James J. [Signature]
Health Dept.
Others:

MISCELLANEOUS

work require disturbing of any tree on a public street?
Will there be in charge of the above work a person competent to see that the State and City requirements pertaining thereto are observed?

Signature of Applicant [Signature] Phone #
Type: Name of above Robert Orr for Verrillo's 1 [ ] 2 [ ] 3 [ ] 4 [ ]
Other and Address

FIELD INSPECTOR'S COPY APPLICANT'S COPY OFFICE FILE COPY

[Signature: T. M. Carroll]

NOTES

Permit No. 011 1091  
Location 1511 Edwards St  
Owner Orlando M. ...  
Date of perm. 8-1-84  
Approved [Signature]  
Dwelling 2 Bed/1 Bath  
Garage \_\_\_\_\_  
Alteration \_\_\_\_\_

Notes section with horizontal lines, partially crossed out with a large 'X'.

B

### APPLICATION FOR PERMIT

PERMIT ISSUED

B.O.C.A. USE GROUP .....  
B.O.C.A. TYPE OF CONSTRUCTION ..... 1193

SEP 11 1958

ZONING LOCATION ..... PORTLAND, MAINE Sept. 4, 1958

City Of Portland

To the CHIEF OF BUILDING & INSPECTION SERVICES, PORTLAND, MAINE

The undersigned hereby applies for a permit to erect, alter, repair, demolish, move or install the following building, structure, equipment or change use in accordance with the Laws of the State of Maine, the Portland E.O.C.A. Building Code and Zoning Ordinance of the City of Portland with plans and specifications, if any, submitted herewith and the following specifications:

LOCATION ... 255 Riverside Street  
1. Owner's name and address ... Howard Johnson's ... same ... Fire District #1  #2   
2. Lessee's name and address ...  
3. Contractor's name and address ... Coyne Signs ... 24 Cove St., Port., Me ... Telephone 772-4144

Proposed use of building ... Hotel & rest. erect sign ... No. of sheets  
Last use ...  
Material ... No. stories ... Heat ... Style of roof ... Roofing  
Other buildings on same lot ...  
Estimated contractual cost \$ ...

FIELD INSPECTOR - Mr. ... @ 775-5451  
To replace faces on existing pole sign, 6' x 8', aluminated dishpan, not illuminated.

Appeal Fees \$  
Base Fee  
Late Fee  
TOTAL \$ 34.60

Stamp of Special Conditions

ISSUE PERMIT TO #3

NOTE TO APPLICANT: Separate permits are required by the installers and subcontractors of heating, plumbing, electrical and mechanicals.

#### DETAILS OF NEW WORK

Is any plumbing involved in this work? ... Is any electrical work involved in this work? ... no  
Is connection to be made to public sewer? ... If not, what is proposed for sewage?  
Has septic tank note been sent? ... Form notice sent?  
Height average grade top of plate ... Height average grade to highest point of roof  
Size, front ... depth ... No. stories ... solid filled land? ... earth or rock?  
Material of foundation ... Thickness, top ... bottom ... cellar  
Kind of roof ... Rise per foot ... Roof covering  
No. of chimneys ... Material of chimneys ... of lining ... Kind of heat ... fuel  
Framing Lumber - Kind ... Dressed or full size? ... Corner posts ... Sills  
Size Girder ... Columns under girders ... Size ... Max. on centers  
Studs (outside walls and carrying partitions) 2x4-16" O. C. Bridging in every floor and flat roof span over 8 feet.  
Joists and rafters: 1st floor ... 2nd ... 3rd ... roof  
On centers: 1st floor ... 2nd ... 3rd ... roof  
Maximum span: 1st floor ... 2nd ... 3rd ... roof  
If one story building with masonry walls, thickness of walls? ... height

#### IF A GARAGE

No. cars now accommodated on same lot ... to be accommodated ... number commercial cars to be accommodated  
Will automobile repairing be done other than minor repairs to cars habitually stored in the proposed building?

APPROVALS BY: ... CITY ... MISCELLANEOUS  
BUILDING INSPECTION - PLAN EXAMINER ... Will work require disturbing of any tree on a public street?  
ZONING: ...  
BUILDING CODE: ...  
Fire Dept.: ... Will there be in charge of the above work a person competent to see that the State and City requirements pertaining thereto are observed? ... YES  
Health Dept.: ...  
Others: ...

Signature of Applicant ... Jane Sadler for Coyne Signs ... Phone # ...  
Name of above ... Howard Tomsons ... and Address ...

FIELD INSPECTOR'S COPY ... APPLICANT'S COPY ... OFFICE FILE COPY

PERMIT # 001031 CITY OF Portland BUILDING PERMIT APPLICATION MAP # \_\_\_\_\_ LOT# \_\_\_\_\_

Please fill out any part which applies to job. Proper plans must accompany form.

Owner: Lou Verrillo  
 Address: 155 Riverside, NEYMENK, Portland, 04103  
 LOCATION OF CONSTRUCTION 155 Riverside  
 CONTRACTOR: Bailey Sign SUBCONTRACTORS: 174-28 7  
 ADDRESS: 9 Thomas Drive, Colonel Westbrook Executive Park, Westbrook, 04092

For Official Use Only	
Date: <u>August 17, 1988</u>	Subdivision: Yes / No _____
Inside Fire Units _____	Name _____
Blg Code _____	Lot _____
Time Limit _____	Block _____
Estimated Cost _____	Permit Expiration _____
Value/Structure _____	Ownership _____ Public _____ Private _____
Fee: <u>\$47.40</u>	

Est. Construction Cost: \_\_\_\_\_ Type of Use: Restaurant/Lounge  
 Past Use: \_\_\_\_\_  
 Building Dimensions L \_\_\_\_\_ W \_\_\_\_\_ Sq. Ft. \_\_\_\_\_ # Stories: \_\_\_\_\_ Lot Size: \_\_\_\_\_  
 Is Proposed Use: \_\_\_\_\_ Seasonal \_\_\_\_\_ Condominium \_\_\_\_\_ Apartment \_\_\_\_\_  
 (Version - Explain \_\_\_\_\_)

COMPLETE ONLY IF THE NUMBER OF UNITS WILL CHANGE  
 Residential Buildings Only:  
 # Of Dwelling Units \_\_\_\_\_ # Of New Dwelling Units \_\_\_\_\_

Foundation:  
 1. Type of Soil: \_\_\_\_\_  
 2. Set Backs - Front \_\_\_\_\_ Rear \_\_\_\_\_ Side(s) \_\_\_\_\_  
 3. Footings Size: \_\_\_\_\_  
 4. Foundation Size: \_\_\_\_\_  
 5. Other \_\_\_\_\_

Floor:  
 1. Sills Size: \_\_\_\_\_ Sills must be anchored.  
 2. Girder Size: \_\_\_\_\_  
 3. Lally Column Spacing: \_\_\_\_\_ Size: \_\_\_\_\_  
 4. Joists Size: \_\_\_\_\_ Spacing 16" O.C.  
 5. Bridging Type: \_\_\_\_\_ Size: \_\_\_\_\_  
 6. Floor Sheathing Type: \_\_\_\_\_ Size: \_\_\_\_\_  
 7. Other Material: \_\_\_\_\_

Exterior Walls:  
 1. Studding Size \_\_\_\_\_ Spacing \_\_\_\_\_  
 2. No. windows \_\_\_\_\_  
 3. No. Doors \_\_\_\_\_  
 4. Header Sizes \_\_\_\_\_ Span(s) \_\_\_\_\_  
 5. Bracing: Yes \_\_\_\_\_ No \_\_\_\_\_  
 6. Corner Posts Size \_\_\_\_\_ Size \_\_\_\_\_  
 7. Insulation Type \_\_\_\_\_ Size \_\_\_\_\_  
 8. Sheathing Type \_\_\_\_\_ Size \_\_\_\_\_  
 9. Siding Type \_\_\_\_\_ Weather Exposure \_\_\_\_\_  
 10. Masonry Materials \_\_\_\_\_  
 11. Metal Materials \_\_\_\_\_

Interior Walls:  
 1. Studding Size \_\_\_\_\_ Spacing \_\_\_\_\_  
 2. Header Sizes \_\_\_\_\_ Span(s) \_\_\_\_\_  
 3. Wall Covering Type \_\_\_\_\_  
 4. Fire Wall if required \_\_\_\_\_  
 5. Other Materials \_\_\_\_\_

Ceiling:  
 1. Ceiling Joists Size: \_\_\_\_\_  
 2. Ceiling Strapping Size \_\_\_\_\_ Spacing \_\_\_\_\_  
 3. Type Ceiling: \_\_\_\_\_  
 4. Insulation Type \_\_\_\_\_ Size \_\_\_\_\_  
 5. Ceiling Height: \_\_\_\_\_

Roof:  
 1. Truss or Rafter Size \_\_\_\_\_ Spar \_\_\_\_\_  
 2. Sheathing Type \_\_\_\_\_ Size \_\_\_\_\_  
 3. Roof Covering Type \_\_\_\_\_  
 4. Other \_\_\_\_\_

Chimneys:  
 Type: \_\_\_\_\_ Number of Fire Places \_\_\_\_\_

Heating:  
 Type of Heat: \_\_\_\_\_

Electrical:  
 Service Entrance Size: \_\_\_\_\_ Smoke Detector Required Yes \_\_\_\_\_ No \_\_\_\_\_

Plumbing:  
 1. Approval of soil test if required Yes 20 No \_\_\_\_\_  
 2. No. of Tubs or Showers \_\_\_\_\_  
 3. No. of Flushes \_\_\_\_\_  
 4. No. of Lavatories \_\_\_\_\_  
 5. No. of Other Fixtures 04-33

Swimming Pools:  
 1. Type: \_\_\_\_\_  
 2. Pool Size: \_\_\_\_\_ x \_\_\_\_\_ Square Footage \_\_\_\_\_  
 3. Must conform to National Electrical Code and State Law.

Zoning:  
 District B2 Street Frontage Req. \_\_\_\_\_ Provided \_\_\_\_\_  
 Required Setbacks: Front \_\_\_\_\_ Back \_\_\_\_\_ Side \_\_\_\_\_ Side \_\_\_\_\_

Review Required:  
 Zoning Board Approval: Yes \_\_\_\_\_ No \_\_\_\_\_ Date: \_\_\_\_\_  
 Planning Board Approval: Yes \_\_\_\_\_ No \_\_\_\_\_ Date: \_\_\_\_\_  
 Conditional Use: \_\_\_\_\_ Variance \_\_\_\_\_ Site Plan \_\_\_\_\_ Subdivision \_\_\_\_\_  
 Shore and Floodpl. in Mgmt \_\_\_\_\_ Special Exception \_\_\_\_\_  
 Other (Explain) \_\_\_\_\_  
 Date Approved: 8/17/88

Permit Received By Nancy Grossman

Signature of Applicant Nancy L. Benin Date 8/17/88

Signature of CEO Agent of owner Date \_\_\_\_\_

Inspection Dates \_\_\_\_\_

PLOT PLAN



**FEES (Breakdown From Front)**  
Base Fee \$25.00 \_\_\_\_\_  
Subdivision Fee \$ \_\_\_\_\_  
Site Plan Review Fee \$ \_\_\_\_\_  
Other Fees \$22.40 \_\_\_\_\_  
(Explain) \_\_\_\_\_  
Late Fee \$ \_\_\_\_\_

Type	Inspection Record	Date
_____	_____	____/____/____
_____	_____	____/____/____
_____	_____	____/____/____
_____	_____	____/____/____
_____	_____	____/____/____

COMMENTS

\_\_\_\_\_  
\_\_\_\_\_  
\_\_\_\_\_  
\_\_\_\_\_  
\_\_\_\_\_  
\_\_\_\_\_  
\_\_\_\_\_

Signature of Applicant Rodney L. Bonn agent of owner Date 8/17/88



9 Thomas Drive  
Westbrook, ME 04092  
774-2843  
1 800 543-SIGN  
Col. Westbrook Executive Park

FACE 1	MATERIAL	COPY	COPY	COPY	SEALS
FACE 2	MATERIAL	COPY	COPY	COPY	SEALS
BUILDING TYPE	ELEC. LOC.	LOAD	LOAD	LOAD	LOAD
POLE COVER	HGT. & BOT.	MATERIAL	COPY	SERVING	(face)

Customer	VERRILO'S
Location	155 RIVERSIDE ST. WESTBROOK, ME.
Remarks	EXIT & 04103
Revised	5/17 Pedicure 6/13/88 Add NEON ARROW 6/14/88 Change Bar Spacing
Scale	1/2" = 1'
Date	5/17/88
Job/W.O.#	Sheet 1 of 1
Project #	D-012
Drawing #	7350
ACCEPTANCE SIGNATURE/DATE	R. Verillo

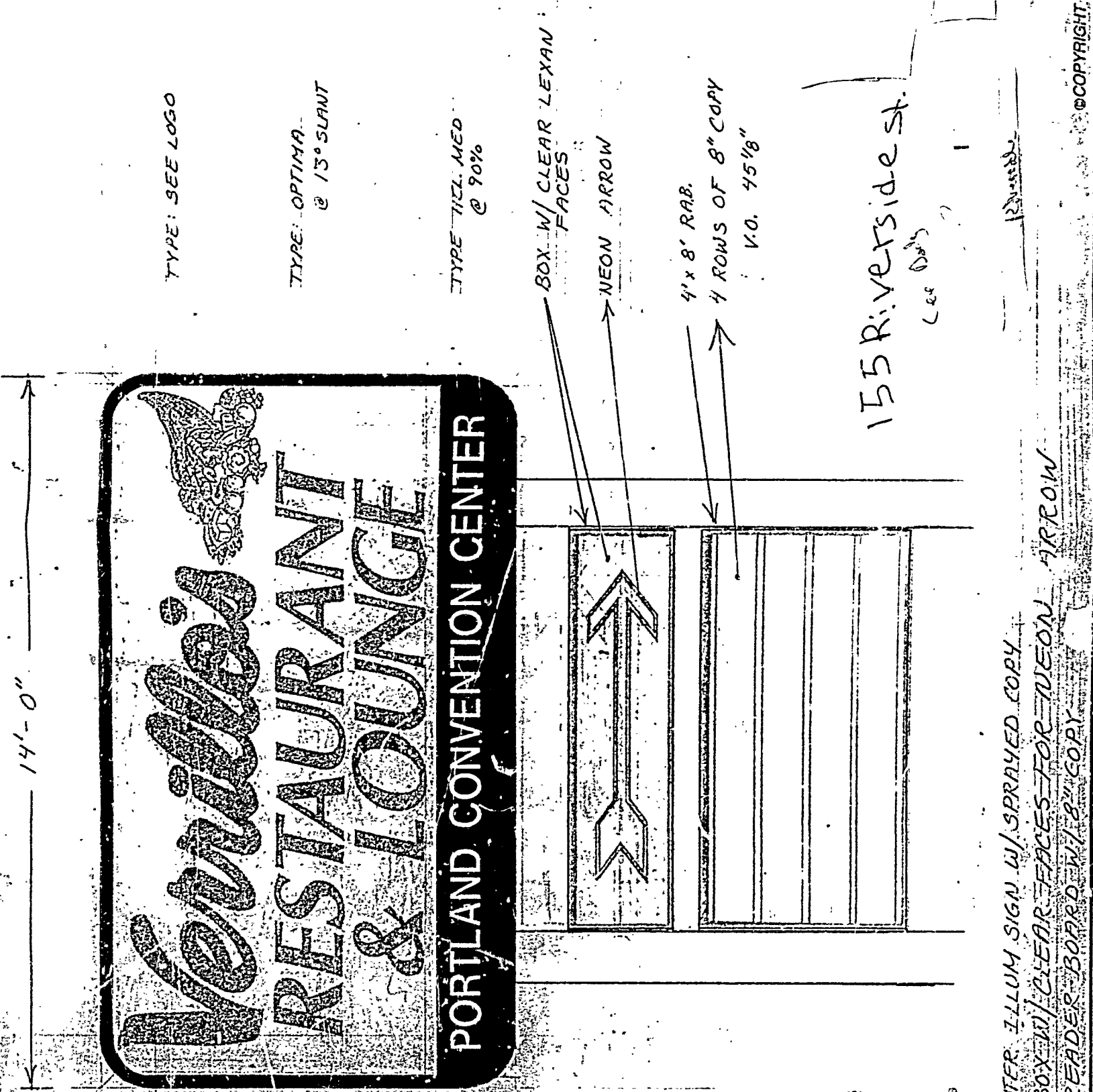

AUG 17 1988

DEPT. OF BUILDING & PERMITS  
CITY OF PORTLAND

1-D.F. 8'x14' INTER. ILLUM SIGN W/ SPRAYED COPY

1-D.F. 2'x8' BOX W/ CLEAR FACES FOR NEON ARROW

1-D.F. 4'x8' READER BOARD W/ 8" COPY

APPLICATION FOR PERMIT

PERMIT ISSUED

B.O.C.A. USE GROUP .....

B.O.C.A. TYPE OF CONSTRUCTION ..... 01193

SEP 11 1986

ZONING LOCATION ... B-2 ... PORTLAND, MAINE Sept. 11, 1986

City Of Portland

To the CHIEF OF BUILDING & INSPECTION SERVICES, PORTLAND, MAINE

The undersigned hereby applies for a permit to erect, alter, repair, demolish, move or install the following building, structure, equipment or change use in accordance with the Laws of the State of Maine, the Portland B.O.C.A. Building Code and Zoning Ordinance of the City of Portland with plans, and specifications, if any, submitted herewith and the following specifications:

LOCATION ... 155 Riverside Street ... Fire District #1 ...
1. Owner's name and address ... Howard Johnson's ... same ... Telephone 775-5861
2. Lessee's name and address ...
3. Contractor's name and address ... Coyne Signs ... 84 Cove St., Port., Me ... Telephone 772-4144

Proposed use of building ... Hotel & rest. erect sign ... No. of sheets
Last use ... No families
Material ... No. stories ... Heat ... Style of roof ... Roofing
Other buildings on same lot
Estimated contractual cost \$

FIELD INSPECTOR—Mr. @ 775-5451
To replace faces on existing pole sign, 6' x 8', aluminated dishpan, not illuminated.
Appeal Fees \$
Base Fee
Late Fee
TOTAL \$ 34.60

Stamp of Special Conditions

ISSUE PERMIT TO #3

NOTE TO APPLICANT: Separate permits are required by the installers and subcontractors of heating, plumbing, electrical and mechanicals.

DETAILS OF NEW WORK

Is any plumbing involved in this work? ... Is any electrical work involved in this work? ... NO
Is connection to be made to public sewer? ... If not, what is proposed for sewage?
Has septic tank notice been sent? ... Form notice sent?
Height average grade to top of plate ... Height average grade to highest point of roof
Size front ... depth ... No. stories ... solid or filled land? ... earth or rock?
Material of foundation ... Thickness, top ... bottom ... cellar
Kind of roof ... Rise per foot ... Roof covering
No. of chimneys ... Material of chimneys ... of lining ... Kind ... fuel
Framing Lumber—Kind ... Dressed or full size? ... Corner posts ... Sills
Size Girder ... Columns under girders ... Size ...
Studs (outside walls and carrying partitions) 2x4-16" O. C. Bridging in eaves ... over 8 feet.
Joists and rafters: 1st floor ... 2nd ... roof
On centers: 1st floor ... 2nd ... roof
Maximum span: 1st floor ... 2nd ... 3rd ... roof
If one story building with masonry walls, thickness of walls? ... height?

IF A GARAGE

No. cars now accommodated on same lot ... to be accommodated ... number commercial cars to be accommodated
Will automobile repairing be done other than minor repairs to cars habitually stored in the proposed building?

APPROVALS BY: DATE
BUILDING INSPECTION—PLAN EXAMINER
ZONING: A.R. ... Sept. 11, 1986
BUILDING CODE:
Fire Dept.:
Health Dept.:
Others:

MISCELLANEOUS
Will work require disturbing of any tree on a public street? NO
Will there be in charge of the above work a person competent to see that the State and City requirements pertaining thereto are observed? ... yes.

Signature of Applicant ... Jane Sadler ... Phone #
Type Name of above ... Jane Sadler for Coyne Signs ... 1 2 3 4
and Portland Glass Other
HOWARD JOHNSON'S and Address

FIELD INSPECTOR'S COPY [Signature] APPLICANT'S COPY OFFICE FILE COPY

NOTES

10/15/86 Work not started yet

Handwritten notes on a set of horizontal lines.

A vertical column of horizontal lines for notes.

A vertical column of horizontal lines for notes.

Permit No 86/1193  
 Location 575 Rutlandville  
 Owner Howard Thomas  
 Date of permit 9-17-86  
 Approved 9-11-86  
 Drawing Park sign  
 Garage  
 Alteration

912741

Per # 912741 City of Portland BUILDING PERMIT APPLICATION Fee \$35. Zone Map # Lot#

Applicant: L L P Corp Phone # 775-6536
Address: 155 Riverside St; Ptld, ME 04103
Location: 155 Riverside St. (Verrillo's)
Contractor: Leavitt & Parris Sub.
Address: Payne Rd; Scarborough, ME Phone # 0-4074
Proposed Use: restaurant w tent
Pas' se: restaurant
Dimensions L W Total Sq. Ft.
# Bedrooms Lot Size
Conversion: Erect one tent - 6/21/91

For Official Use Only
Date: 6/13/91
Inside Fire Limits
Brag Code
Time Limit
Estimated Cost
Zoning: B-4 Business
Review Required:
Zoning Board Approval: Yes No Date
Planning Board Approval: Yes No Date
Conditional Use: Variance Site Plan Subdivision
Shoreland Zoning Yes No Floodplain Yes No
Special Exemption
Other (Explain)

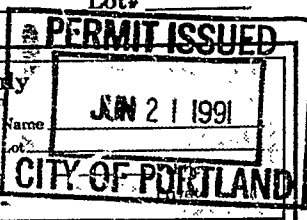

Foundation:
1. Type of Soil:
2. Set Backs - Front Rear Side(s)
1. Footings Size:
1. Foundation Size:
1. Other

Ceiling:
1. Ceiling Joists Size:
2. Ceiling Strapping Size Spacing
3. Type Ceilings:
4. Insulation Type Size
5. Ceiling Height:
Roof:
1. Truss or Rafter Size Span Action:
2. Sheathing Type Size
3. Roof Covering Type
Chimneys:
Type: Number of Fire Places
Heating:
Type of Heat:
Electrical:
Service Entrance Size: Smoke Detector Required Yes No
Plumbing:
1. Approval of soil test if required Yes No
2. No. of Tubs or Showers
3. No. of Flushes
4. No. of Lavatories
5. No. of Other Fixtures
Swimming Pools:
1. Type:
2. Pool Size: x Square Footage
3. Must conform to National Electrical Code and State Law.

Floor:
1. Sills Size: Sills must be anchored.
1. Girder Size:
1. Lally Column Spacing: Size:
1. Joists Size: Spacing 16" O.C.
1. Bridging Type: Size:
1. Floor Sheathing Type: Size:
1. Other Material:

Exterior Walls:
1. Studding Size Spacing
1. No. windows
1. No. Doors
1. Header Sizes Span(s)
1. Bracing: Yes No
1. Corner Posts Size
1. Insulation Type Size
1. Sheathing Type Size
1. Siding Type Weather Exposure
Masonry Materials
Metal Materials

Interior Walls:
1. Studding Size Spacing
1. Header Sizes Span(s)
1. Wall Covering Type
1. Fire Wall if required
1. Other Materials

Permit Received By Louise E. Chase
Signature of Applicant Linda Orr Date 6/13/91
Signature of CEO Michael L. ... Date 6/13/91
Inspection Dates
White-Tax Assessor Yellow-GPCOG White Tag -CEO [2]
© Copyright GPCOG 1988

PERMIT # 1031 CITY OF Portland BUILDING PERMIT APPLICATION MAP # \_\_\_\_\_ LOT# \_\_\_\_\_

Please fill out any part which applies to job. Proper plans must accompany form.

Owner: Lou Verrillo  
 Address: 155 Riverside, SEASIDE, Portland, 04103

LOCATION OF CONSTRUCTION: 155 Riverside  
 CONTRACTOR: Balley Sign SUB-CONTRACTORS: XXX-2843

ADDRESS: 9 Thomas Drive, Colonel Westbrook Executive Park, Westbrook, 04092

Est. Construction Cost: \_\_\_\_\_ Type of Use: Restaurant/Lounge

Building Dimensions L: \_\_\_\_\_ W: \_\_\_\_\_ Sq. Ft.: \_\_\_\_\_ Stories: \_\_\_\_\_  
 In Purpose Use: \_\_\_\_\_ Seasonal \_\_\_\_\_ Condominium \_\_\_\_\_ Apartment \_\_\_\_\_

Conversion - Explain \_\_\_\_\_  
 COMPLETE ONLY IF THE NUMBER OF UNITS WILL CHANGE  
 Residential Buildings Only \_\_\_\_\_ # of Dwelling Units \_\_\_\_\_ # of New Dwelling Units \_\_\_\_\_

Foundation:  
 1. Type of Soil: \_\_\_\_\_  
 2. Set Backs - Front \_\_\_\_\_ Rear \_\_\_\_\_ Side(s) \_\_\_\_\_  
 3. Footings Size: \_\_\_\_\_  
 4. Foundation Size: \_\_\_\_\_  
 5. Other: \_\_\_\_\_

Floor:  
 1. Sills Size: \_\_\_\_\_ Sills must be anchored.  
 2. Girder Size: \_\_\_\_\_  
 3. Lally Column Spacing: \_\_\_\_\_ Size: \_\_\_\_\_ Spacing if O.C. \_\_\_\_\_  
 4. Joists Size: \_\_\_\_\_  
 5. Bridging Type: \_\_\_\_\_ Size: \_\_\_\_\_  
 6. Floor Sheathing Type: \_\_\_\_\_ Size: \_\_\_\_\_  
 7. Other Material: \_\_\_\_\_

Exterior Walls:  
 1. Studding Size \_\_\_\_\_ Spacing \_\_\_\_\_  
 2. No. windows \_\_\_\_\_  
 3. No. Doors \_\_\_\_\_  
 4. Header Sizes \_\_\_\_\_ Spans(s) \_\_\_\_\_  
 5. Bracing: Yes \_\_\_\_\_ No \_\_\_\_\_  
 6. Corner Posts Size \_\_\_\_\_  
 7. Insulation Type \_\_\_\_\_ Size \_\_\_\_\_  
 8. Sheathing Type \_\_\_\_\_ Size \_\_\_\_\_  
 9. Siding Type \_\_\_\_\_ Weather Exposure \_\_\_\_\_  
 10. Masonry Materials \_\_\_\_\_

Interior Walls:  
 1. Studding Size \_\_\_\_\_ Spacing \_\_\_\_\_  
 2. Header Size \_\_\_\_\_ Spans(s) \_\_\_\_\_  
 3. Wall Covering Type \_\_\_\_\_  
 4. Fire Wall if required \_\_\_\_\_  
 5. Other Materials \_\_\_\_\_

**For Official Use Only**

Date: August 17, 1988 Substitution: Yes / No \_\_\_\_\_  
 Inside Fire Limit \_\_\_\_\_ Name \_\_\_\_\_  
 Side Cost \_\_\_\_\_ Lot \_\_\_\_\_  
 Time Limit \_\_\_\_\_ Block \_\_\_\_\_  
 Estimated Cost \_\_\_\_\_ Permit Expiration \_\_\_\_\_  
 Value: XXXXX \$47,400 Ownership \_\_\_\_\_ Public \_\_\_\_\_  
 Fee: XXXXX \$4092 Private \_\_\_\_\_

Ceiling:  
 1. Ceiling Joists Size: \_\_\_\_\_ Spacing \_\_\_\_\_  
 2. Ceiling Strapping Size: \_\_\_\_\_  
 3. Type Ceiling: \_\_\_\_\_  
 4. Insulation Type \_\_\_\_\_  
 5. Ceiling Height: \_\_\_\_\_

Roof:  
 1. Truss or Rafters Size \_\_\_\_\_ Spacing \_\_\_\_\_  
 2. Sheathing Type \_\_\_\_\_ Size \_\_\_\_\_  
 3. Roof Covering Type \_\_\_\_\_  
 4. Other \_\_\_\_\_

Chimneys:  
 Type: \_\_\_\_\_ Number of Fire Places \_\_\_\_\_

Heating:  
 Type of Heat: \_\_\_\_\_  
 Electrical: \_\_\_\_\_  
 Service Entrance Size: \_\_\_\_\_ Smoke Detector Required Yes \_\_\_\_\_ No \_\_\_\_\_

Plumbing:  
 1. Approval of soil test if required \_\_\_\_\_ Yes \_\_\_\_\_ No \_\_\_\_\_  
 2. No. of Tubs or Showers \_\_\_\_\_  
 3. No. of Flushes \_\_\_\_\_  
 4. No. of Lavatories \_\_\_\_\_  
 5. No. of Other Fixtures \_\_\_\_\_

Swimming Pools:  
 1. Type: \_\_\_\_\_ Square Footage \_\_\_\_\_  
 2. Pool Size: \_\_\_\_\_  
 3. Must conform to National Electrical Code and State Law.

Zoning:  
 District: \_\_\_\_\_ Street Frontage Req: \_\_\_\_\_ Provided \_\_\_\_\_  
 Required Setbacks: Front \_\_\_\_\_ Back \_\_\_\_\_ Side \_\_\_\_\_

Review Required:  
 Zoning Board Approval: Yes \_\_\_\_\_ No \_\_\_\_\_ Date: \_\_\_\_\_  
 Planning Board Approval: Yes \_\_\_\_\_ No \_\_\_\_\_ Date: \_\_\_\_\_  
 Conditional Use: \_\_\_\_\_ Variance \_\_\_\_\_ Site Plan \_\_\_\_\_  
 Shore and Floodplain Mgmt \_\_\_\_\_ Special Exception \_\_\_\_\_  
 Other (Explain) \_\_\_\_\_  
 Date Approved: \_\_\_\_\_

Permit Received By: Nancy Gross em  
 Signature of Applicant: [Signature] Date: 8/17/88  
 Signature of CEO: [Signature] Date: \_\_\_\_\_  
 Inspection Dates: \_\_\_\_\_  
 White-Tax Assessor \_\_\_\_\_ Yellow-GPCOG \_\_\_\_\_ White Tag -CEO \_\_\_\_\_

PERMIT # \_\_\_\_\_ PORTLAND BUILDING PERMIT APPLICATION DATE 09/02/87 PERMIT ISSUED

1. GENERAL INFORMATION:  
 Location/Address of construction 155 Riverside Street  
 1. Owner's name Verrill, Tom Tel: 775-6536  
 Address East  
 2. Lessee's name \_\_\_\_\_ Tel. \_\_\_\_\_  
 Address \_\_\_\_\_  
 3. Contractor's name John McQuinn Tel. 797-8179  
 Address Box 8025 Portland ME 04104  
 4. Is this a legally recorded lot? yes  no

SEP 3 1987  
 City Of Portland

DESCRIPTION OF WORK:  
to erect storage building 16' x 24' as per plans  
send permit to #3

III. BUILDING DIMENSIONS: length \_\_\_\_\_ width \_\_\_\_\_ square footage \_\_\_\_\_ height \_\_\_\_\_ #stories \_\_\_\_\_  
 IV. ZONE \_\_\_\_\_ Street frontage \_\_\_\_\_ Zoning board approval: no  yes  date \_\_\_\_\_  
 Setbacks: front \_\_\_\_\_ back \_\_\_\_\_ side \_\_\_\_\_ side \_\_\_\_\_ Planning board approval: no  yes  date \_\_\_\_\_

V. REVIEW REQUIRED: variance \_\_\_\_\_ other \_\_\_\_\_ Number of off-street parking spaces:  
 site plan \_\_\_\_\_ subdivision \_\_\_\_\_ shore \_\_\_\_\_ floodplain mgmt \_\_\_\_\_ enclosed \_\_\_\_\_ outdoors \_\_\_\_\_

VI. FEES:  
 base fee \_\_\_\_\_ other fees \_\_\_\_\_  
 subdivision fee \_\_\_\_\_ late fee \_\_\_\_\_  
 site plan review fee \_\_\_\_\_ TOTAL \$35.00

VII. DETAILS OF WORK  
 1. WATER SUPPLY:  public  private  
 2. SEWER:  public  private, type \_\_\_\_\_  
 3. HEAT: type \_\_\_\_\_ fuel \_\_\_\_\_  
 4. FOUNDATION: type \_\_\_\_\_  
 thickness \_\_\_\_\_ footing \_\_\_\_\_  
 5. ROOF: type \_\_\_\_\_ pitch \_\_\_\_\_  
 covering \_\_\_\_\_ load \_\_\_\_\_  
 6. PLUMBING:  
 SPRINKLER SYSTEM? yes  no   
 7. ELECTRICAL:  
 service entrance size \_\_\_\_\_  
 # smoke detectors \_\_\_\_\_  
 8. CHIMNEY: # flues \_\_\_\_\_  
 material \_\_\_\_\_ # fireplaces \_\_\_\_\_  
 9. FRAMING: floor joists \_\_\_\_\_ size \_\_\_\_\_ max. on center \_\_\_\_\_  
 ceiling joists \_\_\_\_\_ rafters \_\_\_\_\_  
 studs \_\_\_\_\_ wall studs \_\_\_\_\_  
 10. If 1-story building w/masonry  
 walls: wall thickness \_\_\_\_\_  
 height \_\_\_\_\_  
 11. BEDROOM WINDOWS  
 height \_\_\_\_\_ width \_\_\_\_\_  
 sill height \_\_\_\_\_  
 egress window? yes  no

VIII. OFFICE USE:  
 TAX MAP # \_\_\_\_\_  
 LOT # \_\_\_\_\_  
 VALUE/STRUCTURE: \_\_\_\_\_  
 PERMIT EXPIRATION: \_\_\_\_\_  
 IX. NEW OR PHASED SUBDIVISION REFERENCE:  
 Name \_\_\_\_\_  
 Lot \_\_\_\_\_  
 Block \_\_\_\_\_

CODE \_\_\_\_\_ If other, explain \_\_\_\_\_ Seasonal \_\_\_\_\_ Condominium \_\_\_\_\_ Apartment \_\_\_\_\_  
 X. PROPOSED USE: 327 - restaurant 437 - storage building  
 XI. PAST USE: \_\_\_\_\_  
 XII. OWNERSHIP: PUBLIC  PRIVATE

XIII. EST. CONSTRUCTION COST: \$2,300 XIV. GR. SQ. FT. OF LOT \_\_\_\_\_  
 BUILDING \_\_\_\_\_

COMPLETE XV AND XVI ONLY IF THE NUMBER OF UNITS WILL CHANGE  
 XV. RESIDENTIAL BUILDINGS ONLY: BEDROOMS  
 # NEW DWELLING UNITS WITH: 1. BDRM \_\_\_\_\_ 2. BDRMS \_\_\_\_\_ 3. BDRMS \_\_\_\_\_  
 # EXISTING DWELLING UNITS WITH: \_\_\_\_\_  
 XVI. # RESIDENTIAL UNITS:  
 # NEW DWELLINGS \_\_\_\_\_  
 # EXISTING DWELLINGS \_\_\_\_\_  
 TOTAL RESIDENTIAL UNITS \_\_\_\_\_

APPROVALS BY: \_\_\_\_\_ DATE \_\_\_\_\_ MISCELLANEOUS  
 BUILDING INSPECTION - PLAN EXAMINER \_\_\_\_\_ Will work require disturbing of any tree on a public street?  
 ZONING: \_\_\_\_\_ Will there be in charge of the above work a person competent to see that the State and City requirements pertaining thereto are observed?  
 C.F.O. \_\_\_\_\_  
 FIRE DEPT. \_\_\_\_\_

NOTE TO APPLICANT: Separate permits are required by the installers and subcontractors of heating, plumbing, electrical, and mechanicals.

District No. 2 XVII. SIGNATURE OF APPLICANT \_\_\_\_\_ PHONE # \_\_\_\_\_  
 TYPE NAME OF ABOVE John McQuinn for Tom Verrill 1 2 3 4

White-GPCOG Green - Applicant Yellow-Assessor Pink-Office File Gold - Field Inspector  
Mr. CAPPOL

**City of Portland, Maine - Building Use Permit Application** 389 Congress Street, 04101, Tel: (207) 874-8703, FAX: 874-8716

Location of Construction: 155 Riverside St.		Owner: Howard Johnson Motor Lodge		Phone:		Permit No: <b>941362</b>	
Owner Address: 155 Riverside St 04103		Lease/Buyer's Name: Howard Johnson Motor Lodge		Phone: 774-5861		Business Name:	
Contractor Name: 155 Riverside St Portland, ME 04103		Address: 268 A 11		Phone:		<div style="border: 1px solid black; padding: 5px; text-align: center;"> <b>PERMIT ISSUED</b>                  DEC 20 1994  <b>CITY OF PORTLAND</b> </div>	
Past Use: motor lodge		Proposed Use: motor lodge w renovations		COST OF WORK: \$ 15,000		PERMIT FEE: \$ 95	
Proposed Project Description: structural repair of the pool roof		FIRE DEPT. <input type="checkbox"/> Approved <input type="checkbox"/> Denied Signature:		INSPECTION: Use Group: Type: 200A 93 Signature: <i>Hoffner</i>		Zoning: <b>B 4</b> CBL: <b>268-A-11</b> Zoning Approval: <i>✓</i> Special Zone or Reviews: <input type="checkbox"/> Shoreland <input type="checkbox"/> Wetland <input type="checkbox"/> Flood Zone <input type="checkbox"/> Subdivision <input type="checkbox"/> Site Plan <input type="checkbox"/> major <input type="checkbox"/> minor <input type="checkbox"/> mm <input type="checkbox"/>	
Permit Taken By:		Date Applied For:		PEDESTRIAN ACTIVITIES DISTRICT (P.A.D.) Action: <input type="checkbox"/> Approved <input type="checkbox"/> Approved with Conditions <input type="checkbox"/> Denied Signature: Date:		Zoning Appeal: <input type="checkbox"/> Variance <input type="checkbox"/> Miscellaneous <input type="checkbox"/> Conditional Use <input type="checkbox"/> Interpretation <input type="checkbox"/> Approved <input type="checkbox"/> Denied Historic Preservation: <input type="checkbox"/> Not in District or Landmark <input type="checkbox"/> Does Not Require Review <input type="checkbox"/> Requires Review	

1. This permit application doesn't preclude the Applicant(s) from meeting applicable State and Federal rules.
2. Building permits do not include plumbing, septic or electrical work.
3. Building permits are void if work is not started within six (6) months of the date of issuance. False information may invalidate a building permit and stop all work.

\*contractor: Dahlgren Construction  
 20 U S Rte #1  
 Yarmouth, ME 04096

**CERTIFICATION**

I hereby certify that I am the owner of record of the named property, or that the proposed work is authorized by the owner of record and that I have been authorized by the owner to make this application as his authorized agent and I agree to conform to all applicable laws of this jurisdiction. In addition, if a permit for work described in the application issued, I certify that the code official's authorized representative shall have the authority to enter all areas covered by such permit at any reasonable hour to enforce the provisions of the code(s) applicable to such permit

*L. O. Dahlgren* 20 US #1 Yarmouth ME      12-16-94      846 3505  
 SIGNATURE OF APPLICANT      ADDRESS:      DATE:      PHONE:

RESPONSIBLE PERSON IN CHARGE OF WORK, TITLE      PHONE:  
 White-Permit Desk   Green-Assessor's   Canary-D.P.W.   Pink-Public File   Ivory Card-Inspector

CEO DISTRICT **4**  
*Mr. Carroll*

**City of Portland, Maine - Building or Use Permit Application** 389 Congress Street, 04101, Tel: (207) 874-8703, FAX: 874-8716

Location of Construction: 155 Riverside St		Owner: H.J. Assoc.		Phone:		Permit No: <b>950270</b> <b>PERMIT ISSUED</b> MAR 28 1995 <b>CITY OF PORTLAND</b>
Owner Address:		Leasee/Buyer's Name: Verrillo's		Business Name:		
Contractor Name: C.N. Brown P.O. Box 200 So. Paris, ME 04281 743-9212		Address: So. Paris, ME 04281 743-9212		Phone:		Permit Issued: MAR 28 1995 <b>CITY OF PORTLAND</b>
Past Use: Parking Lot		Proposed Use: Function		Attn: Margaret		
Proposed Project Description: Erect tent as per plans for function from 10 Apr thru 13 Apr 1995		COST OF WORK: \$		PERMIT FEE: \$ 35.00		Zone: R-4 CBL: 267-B-001 Zoning Approval: 3/27/95 Special Zoning or Reviews: <input type="checkbox"/> Shoreland <input type="checkbox"/> Wetland <input type="checkbox"/> Flood Zone <input type="checkbox"/> Subdivision <input type="checkbox"/> Site Plan maj <input type="checkbox"/> minor <input type="checkbox"/> mm <input type="checkbox"/>
		FIRE DEPT. <input checked="" type="checkbox"/> Approved <input type="checkbox"/> Denied		INSPECTION: 4 Use Group: Type: Signature: [Signature] Signature: [Signature]		
Permit Taken By: Mary Gresik		Date Applied For: 23 March 1995		PEDESTRIAN ACTIVITIES DISTRICT (P.A.D.) Action: <input type="checkbox"/> Approved <input type="checkbox"/> Approved with Conditions <input type="checkbox"/> Denied Signature: _____ Date: _____		Zoning Appeal <input type="checkbox"/> Variance <input type="checkbox"/> Miscellaneous <input type="checkbox"/> Conditional Use <input type="checkbox"/> Interpretation <input checked="" type="checkbox"/> Approved <input type="checkbox"/> Denied Historic Preservation <input checked="" type="checkbox"/> Not in District or Landmark <input type="checkbox"/> Does Not Require Review <input type="checkbox"/> Requires Review Action: <input type="checkbox"/> Approved <input type="checkbox"/> Approved with Conditions <input type="checkbox"/> Denied Date: 3/24/95 [Signature] CEO DISTRICT 4 [Signature]
<p><b>CERTIFICATION</b></p> <p>I hereby certify that I am the owner of record of the named property, or that the proposed work is authorized by the owner of record and that I have been authorized by the owner to make this application as his authorized agent and I agree to conform to all applicable laws of this jurisdiction. In addition, if a permit for work described in the application issued, I certify that the code official's authorized representative shall have the authority to enter all areas covered by such permit at any reasonable hour to enforce the provisions of the code(s) applicable to such permit</p>						
SIGNATURE OF APPLICANT: [Signature]		ADDRESS: Stephen Lawrence		DATE: 23 March 1995		
RESPONSIBLE PERSON IN CHARGE OF WORK, TITLE		White-Permit Desk Green-Assessor's Canary-D.P.W. Pink-Public File Ivory Card-Inspector		PHONE:		