

BUILDING PLAN

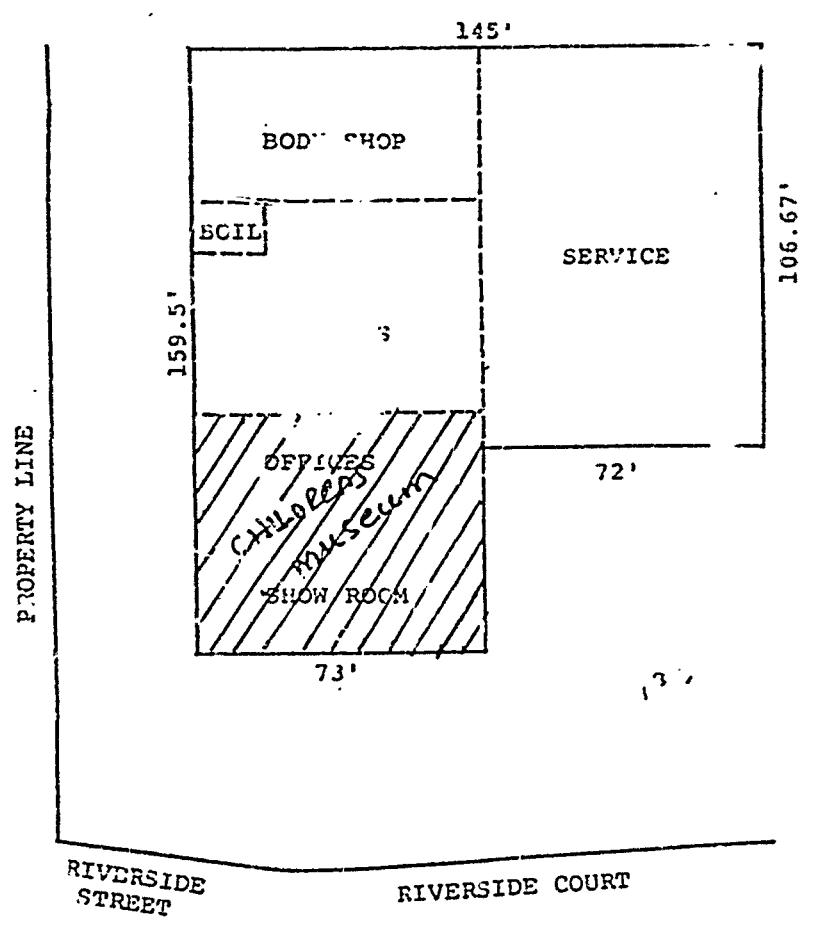

SCALE: 1"=40' ±

HENNESSY ASSOCIATES

FRONT

Riverside Court

Riverside ST.

GREEN - EXISTING

PINK - new partial
Height walls

64'

4600 SF
used for Exhibit
including STAFF OFFICE

SCALE 1/8" = 1'-0"

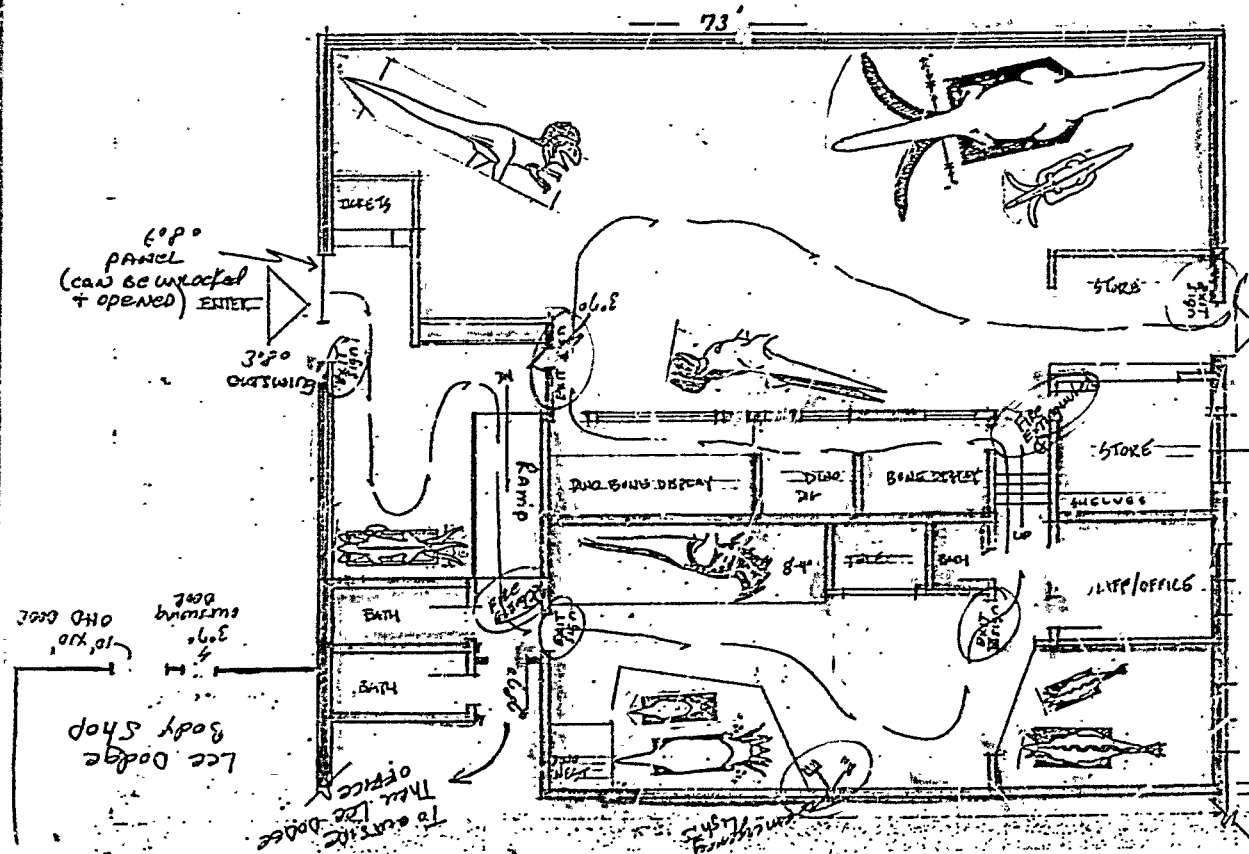



The Children's Museum of Maine

On the Campus of Westbrook College

746 Stevens Avenue Portland, ME 04103 (207) 797-KITE (5483)

June 6, 1990

Lt. Wallace Garroway
Central Station
380 Congress Street
Portland, ME 04101

Dear Mr. Garroway,

Regarding your visit to 191 Riverside Street (former Lee Dodge location) and our discussion of this building for the Children's Museum of Maine's annual educational show and fundraiser, we are very aware and also find it most important to maintain and design a safe public site.

With the public's safety in mind we have addressed the exhibit space in the following manner:

1. Minimal "candlelight" needed for safe egress will be maintained throughout.
2. Exits will be posted throughout with lighted signs where needed and all exits will be clearly indicated.
3. Emergency lights will be installed throughout all areas where required by the time we open to the public. (June 9, 1990)
4. Exhibits will be treated with a chemical that has a rating approved according to NFP 701 where needed.
5. Silks & Greenery, a local retailer, uses only materials that are fire retardant for their "decorations".
6. The public path through the exhibit is clearly marked and well lighted throughout, even during total loss of electricity.
7. The exhibit will be open only one evening (Friday) week until 8pm. Hours will normally be from 10am-5pm. The exhibit will only be open from June 9 -September 3, 1990.
8. The Children's Museum maintains and the Staff will be trained and understand clearly the emergency procedures regarding the 191 Riverside Street exhibit space.

The Children's Museum of Maine would never jeopardize anyone's life and only wish to present a safe, educational exhibit program to the general public. We hope these steps meet with the approval of the necessary codes of the City of Portland. Thank you for your time and interest in the Children's Museum.

Sincerely,

Anthony W. Mollica
Anthony W. Mollica
Executive Director

encl.



The Children's Museum of Maine
On the Campus of Westbrook College
74 Stevens Avenue Portland, ME 04103 (207) 757-KITE (5433)

EMERGENCY PROCEDURES

FIRE:

1. When a fire is in the building -- clear the building. The Staff person in charge is to go to the furthest part of the building (back area) and be the last person to leave. Have everyone assemble away from the building in the parking lot.
2. If there is a fire -- immediately call 911. Remain calm and describe your location (191 Riverside Street near exit 3). The nearest phone outside the exhibit is at the Lee Dodge Body Shop next door or The Pounty Restaurant across the street.
3. Fire Extinguishers are mounted throughout the exhibit and are easily used. (only if everyone is safe)

ACCIDENT:

1. Notify the Staff Person in Charge.
2. If a person is severely injured, a staff person will immediately call 911, give the location of the exhibit (191 Riverside Street) and the nature of the injury. Unless you are trained, DO NOT attempt to assist.
3. In case of a minor scrape or cut, there is a first aid box located in the staff room.
4. If a person feels ill and needs to sit down for a few minutes, please assist them. A staff person or volunteer MUST remain with the visitor at all times.

THEFT:

1. Notify the staff person in charge immediately.
2. We prosecute for shoplifting. Call the Museum Director immediately.
3. Call the police to file a report.

DISPLAY THIS CARD ON PRINCIPAL FRONTAGE OF WORK
CITY OF PORTLAND
BUILDING INSPECTION
PERMIT

Please Read
Application And
Notes, If Any,
Attached

DEPARTMENT ISSUED
No. MAR 18 1988

CITY OF PORTLAND

This is to certify that Childrens Museum of Maine
has permission to change of use from retail to museum
AT Brighton Avenue, Pine Tree Shopping Center

provided that the person or persons, firm or corporation accepting this permit shall comply with all of the provisions of the Statutes of Maine and of the Ordinances of the City of Portland regulating the construction, maintenance and use of buildings and structures, and of the application on file in this department.

Apply to Public Works for street line and grade if nature of work requires such information.

Notification for inspection must be given and written permission procured before this building or part thereof is lathed or otherwise closed-in.

A certificate of occupancy must be procured by owner before this building or part thereof is occupied.

OTHER REQUIRED APPROVALS

Fire Dept. _____
Health Dept. _____
Appeal Board _____
Other _____

Department Name

[Signature]
Director - Building & Inspection Services

PENALTY FOR REMOVING THIS CARD

[Signature]

6/10/88 Certificate of Incorporation
issued K. Blauvelt
C. F. O.

Receipt - Applicant's Copy
CITY OF PORTLAND, MAINE
Department of Building Inspection

L 16501

March 17 1988

Received from Childrens Museum of Maine a fee

of Twenty-five no /100 Dollars \$ 25

for permit to Change of use from retail to museum

at given New Produce Shipping Center Est. Cost \$

Ch. # 1418 P. Sarno
Inspector of Buildings
Per MS

THIS IS NOT A PERMIT

No work is to be started until PERMIT CARD is actually posted upon the premises. Acceptance of this receipt is no guarantee that permit will be granted. PRESERVE THIS RECEIPT. In case permit cannot be granted the amount of the fee will be refunded upon return of the receipt less \$5. or 10% whichever is greater.

PERMIT # _____ CITY OF Portland BUILDING PERMIT APPLICATION

MAP # _____ LOT# _____

Please fill out any part which applies to job. Proper plans must accompany form.

Owner: Amalos Co.

Address: wo City Center 772-1533

LOCATION OF CONSTRUCTION Brighton Ave., Pine Tree Shopping Center

CONTRACTOR: Childrens Museum SUBCONTRACTORS: _____

ADDRESS: 746 Stevens Avenue 04103 797-5483

Est. Construction Cost: _____ Type of Use: Museum

Past Use: Retail

Building Dimensions L _____ W _____ Sq. Ft. _____ # Stories: _____ Lot Size: _____

Is Proposed Use: _____ Seasonal _____ Condominium _____ Apartment _____

Conversion - Explain Change of use from retail to museum as per plans

COMPLETE ONLY IF THE NUMBER OF UNITS WILL CHANGE

Residential Buildings Only:

Of Dwelling Units _____ # Of New Dwelling Units _____

Foundation:

1. Type of Soil: _____
2. Set Backs - Front _____ Rear _____ Side(s) _____
3. Footings Size: _____
4. Foundation Size: _____
5. Other _____

Floor:

1. Sills Size: _____ Sills must be anchored.
2. Girder Size: _____
3. Lally Column Spacing: _____ Size: _____
4. Joists Size: _____ Spacing 16" O.C.
5. Bridging Type: _____ Size: _____
6. Floor Sheathing Type: _____ Size: _____
7. Other Material: _____

Exterior Walls:

1. Studding Size _____ Spacing _____
2. No. windows _____
3. No. Doors _____
4. Header Sizes _____ Span(s) _____
5. Bracing: Yes _____ No _____
6. Corner Posts Size _____
7. Insulation Type _____ Size _____
8. Sheathing Type _____ Size _____
9. Siding Type _____ Weather Exposure _____
10. Masonry Materials _____
11. Metal Materials _____

Interior Walls:

1. Studding Size _____ Spacing _____
2. Header Sizes _____ Span(s) _____
3. Wall Covering Type _____
4. Fire Wall if required _____
5. Other Materials _____

For Official Use Only	
Date <u>March 17, 1988</u>	Subdivision: Yes / No _____
Inside Fire Limits _____	Name _____
Bldg Code _____	Lot _____
Typ Limit _____	Block _____
Estimated Cost _____	Permit Expiration: _____
Value/Structure _____	Ownership: _____ Public _____ Private _____
Fee <u>25</u>	

Ceiling:

1. Ceiling Joists Size: _____
2. Ceiling Strapping Size _____ Spacing _____
3. Type Ceilings: _____
4. Insulation Type _____ Size WAR 28 1988
5. Ceiling Height: _____

Roof:

1. Truss or Rafter Size _____ Spacing City of Portland
2. Sheathing Type _____ Size _____
3. Roof Covering Type _____
4. Other _____

Chim:

Number of Fire Places _____

Heatin:

Type of Heat: _____

Electrical:

Service Entrance Size: _____ Smoke Detector Required Yes _____ No _____

Plumbing:

1. Approval of soil test if required Yes _____ No _____
2. No. of Tubs or Showers _____
3. No. of Flushes _____
4. No. of Lavatories _____
5. No. of Other Fixtures _____

Swimming Pools:

1. Type: _____
2. Pool Size: _____ x _____ Square Footage _____
3. Must conform to National Electrical Code and State Law.

Zoning:

District _____ Street Frontage Req: _____ Provided _____

Required Setbacks: Front _____ Back _____ Side _____ Side _____

Review Required:

Zoning Board Approval: Yes _____ No _____ Date: _____
 Planning Board Approval: Yes _____ No _____ Date: _____
 Conditional Use: _____ Variance _____ Site Plan _____ Subdivision _____
 Shore and Floodplain Mgmt _____ Special Exception _____
 Other _____ (Explain) _____
 Date Approved _____

Permit Received By Lynne Benoit

Signature of Applicant _____ Date 3/17/88

Signature of CEO Anthony Mollica Date _____

Inspection Dates _____

PERMIT # _____ CITY OF Portland BUILDING PERMIT APPLICATION MAP # _____ LOT# _____

Please fill out any part which applies to job. Proper plans must accompany form.

Owner: Boulos Co.

Address: Two City Center 772-1333

LOCATION OF CONSTRUCTION Brighton Ave., Pine Tree Shopping Center

CONTRACTOR: Childrens Museum SUBCONTRACTORS: _____

ADDRESS: 746 Stevens Avenue 04103 797-5483

Est. Construction Cost: _____ Type of Use: Museum

Past Use: Retail

Building Dimensions L _____ W _____ Sq. Ft. _____ # Stories: _____ Lot Size: _____

Is Proposed Use: _____ Seasonal _____ Condominium _____ Apartment _____

_____ Conversion - Explain Change of use from retail to museum as per plans

COMPLETE ONLY IF THE NUMBER OF UNITS WILL CHANGE

Residential Buildings Only:

Of Dwelling Units _____ # Of New Dwelling _____

Foundation:

1. Type of Soil: _____
2. Set Backs - Front _____ Rear _____ Side(s) _____
3. Footings Size: _____
4. Foundation Size: _____
5. Other _____

Floor:

1. Sills Size: _____ Sills must be anchored.
2. Girder Size: _____
3. Lally Column Spacing: _____ Size: _____
4. Joists Size: _____ Spacing 16" O.C.
5. Bridging Type: _____ Size: _____
6. Floor Sheathing Type: _____ Size: _____
7. Other Material: _____

Exterior Walls:

1. Studding Size _____ Spacing _____
2. No. windows _____
3. No. Doors _____
4. Header Sizes _____ Span(s) _____
5. Bracing: Yes _____ No _____
6. Corner Posts Size _____
7. Insulation Type _____ Size _____
8. Sheathing Type _____ Size _____
9. Siding Type _____ Weather Exposure _____
10. Masonry Materials _____
11. Metal Materials _____

Interior Walls:

1. Studding Size _____ Spacing _____
2. Header Size _____ Span(s) _____
3. Wall Covering Type _____
4. Fire Wall if required _____
5. Other Materials _____

For Official Use Only	
Date <u>March 17, 1988</u>	Subdivision: Yes / No _____
Inside Fire Limits _____	Name _____
Bldg Code _____	Lot _____
Type Limit _____	Block _____
Estimated Cost _____	Permit Expiration: _____
Value/Structure _____	Ownership: _____
Fee <u>25</u>	Public _____ Private _____

Ceiling:

1. Ceiling Joists Size: _____ SCAFFOLD ISSUED
2. Ceiling Strapping Size _____ Spacing _____
3. Type Ceilings: _____
4. Insulation Type _____ Size MAR 28 1988
5. Ceiling Height: _____

Roof:

1. Truss or Rafter Size _____ Span City of Portland
2. Sheathing Type _____ Size _____
3. Roof Covering Type _____
4. Other _____

Chimneys:

Type: _____ Number of Fire Places _____

Heating:

Type of Heat: _____

Electrical:

Service Entrance Size: _____ Smoke Detector Required Yes _____ No _____

Plumbing:

1. Approval of soil test if required Yes _____ No _____
2. No. of Tubs or Showers _____
3. No. of Flushes _____
4. No. of Lavatories _____
5. No. of Other Fixtures _____

Swimming Pools:

1. Type: _____
2. Pool Size: _____ x _____ Square Footage _____
3. Must conform to National Electrical Code and State Law.

Zoning:

District _____ Street Frontage Req.: _____ Provided _____

Required Setbacks: Front _____ Back _____ Side _____

Review Required:

Zoning Board Approval: Yes _____ No _____ Date: _____
 Planning Board Approval: Yes _____ No _____ Date: _____
 Conditional Use: _____ Variance _____ Site Plan _____ Subdivision _____
 Shore and Floodplain Mgmt. _____ Special Exception _____
 Other (Explain) _____
 Date Approved _____

Permit Received By Lynne Benoit

Signature of Applicant _____ Date 3/17/88

Signature of CEO Anthony Mollica Date _____

Inspection Dates _____

HARCROS CHEMICALS INC
KANSAS CITY, KANSAS

MATERIAL SAFETY DATA SHEET

PRODUCT NAME: AMMONIUM CHLORIDE TREATED 50# DATE: 10/07/89 PAGE 02
PRODUCT CODE: 16-23270-02

SECTION II Health Hazards CONTINUED

Inhalation: Move to fresh air. If breathing ceases, begin artificial respiration. Contact a physician.

Ingestion: Drink large amounts of water. DO NOT INDUCE VOMITING. Call a physician.

Other Information:

Remove contaminated clothing and footwear and wash before reuse. Follow good industrial hygiene practices. CARCINOGENICITY: Not listed as a carcinogen by IARC, NTP, OSHA or ACGIH.

SENSITIZATION: No reports of human sensitization.

MUTAGEN ACTIVITY: Test for mutagenic Activity in bacterial cell cultures have been inconclusive, with positive results in some studies and negative results in others.

SECTION III Special Protection Information

Respiratory Protection: Where dust, mist or vapor exceeds TLV, use an appropriate NIOSH approved respirator.

Ventilation Required: Work areas should maintain good ventilation. Local exhaust if dusty condition prevails or if TLV is exceeded.

Protective Clothing:

Eyes: Wear chemical goggles.

Skin: Wear protective gloves. Wear clothing designed to minimize skin exposure.

Additional Protective Measures: Wash with soap and water before eating, drinking, or using toilet facilities. Safety shower, eyebath and washing facilities should be available.

* SECTION IV Fire & Explosion Hazard Data

Flash Point (Method): Not flammable.

Flammable Limits (% Volume in Air):

Upper: N/A

Lower: N/A

Extinguishing Media: As appropriate for combustibles in area. Water spray will reduce irritating fumes and gases.

Special Fire Fighting Procedures: Use extinguishing medium appropriate to the surrounding fire. Firefighters must wear self-contained breathing apparatus and protective clothing.

Unusual Fire and Explosion Hazards: Ammonium chloride if overheated to

CONTINUED ON PAGE 03

HARCROS CHEMICALS INC
KANSAS CITY, KANSAS

MATERIAL SAFETY DATA SHEET

PRODUCT NAME: AMMONIUM CHLORIDE TREATED 50# DATE: 10/07/89 PAGE 03
PRODUCT CODE: 16-23270-02

SECTION I Fire & Explosion Hazard Data CONTINUED
500-600 deg. F, which is readily achieved in a fire, may evolve toxic hydrogen chloride and ammonia gases.

SECTION V Physical Data

Boiling Point: Sublimes @ approx. 340 deg. C.
Specific Gravity (H₂O=1): 1.529
Vapor Pressure (MM HG.): N/A
Vapor Density (AIR=1): N/A
Evaporation Rate (____=1): N/A
Solubility in Water: 27% solution @ 68 deg. F
Percent Volatile by Volume: N/A
pH: 5.5, 1% solution
Appearance and Odor: White to off-white crystals, granules, rods or powder; odorless.

SECTION VI Reactivity Data

Stability: Stable, hygroscopic.
Incompatibility: Reactive with metals, metal oxides, hydroxides, strong oxidants, potassium chlorate, and amines. Incompatible and contact should be avoided with alkalis and their carbonates, lead and silver salts. When reacted with alkalis, ammonia is released; with acids, hydrogen chloride is released.
Hazardous Decomposition Products: Sublimes and decomposes at 340 deg. C to release ammonia and hydrogen chloride gases. The latter partially reform ammonium chloride as a dust cloud or smoke.
Hazardous Polymerization: Will not occur.

SECTION VII Spill and Leak

Steps to be taken if material released or spilled: Sweep up dry chemical into an empty, clean container with a cover. Avoid breathing dust or fumes. Flush residue with plenty of water.

Waste Disposal Method:

Material that cannot be used should be disposed of at an approved facility in accordance with applicable federal, state and local regulations. If permitted, may be dissolved in water and flushed to sewer.

EPA Hazardous Substance RQ 5000 lb, 40 CFR, 116-117.

CONTINUED ON PAGE 04

HARCROS CHEMICALS INC
KANSAS CITY, KANSAS

MATERIAL SAFETY DATA SHEET

PRODUCT NAME: AMMONIUM CHLORIDE TREATED 50# DATE: 10/07/89 PAGE 04
PRODUCT CODE: 16-23270-02

SECTION VIII D.O.T. Shipping Information

Proper Shipping Name: NONE
Hazard Class: NONE
ID Number: NONE
Label Requirements: NONE
Reportable Quantity: NONE
Other Information:

SECTION IX Additional Information

This information may be of importance to you:

Keep containers tightly closed when not in use. Store in a cool, dry, well ventilated area away from acids, alkalis, nitrites and nitrates.

Treated product contains 1/2% of anti-caking agent.

NPCA HMIS 200 H

900517

Permit # 900517 City of Portland BUILDING PERMIT APPLICATION Fee \$25. Zone _____ Map # _____ Lot# _____
Please fill out any part which applies to job. Proper plans must accompany form.

Owner: Lee Dodge Inc. Phone # _____
Address: 191 Riverside St.; Ptd, ME 04103
LOCATION OF CONSTRUCTION 191 Riverside St.
Lessee: Children's Museum of Maine
Contractor: _____
Address: 746 Stevens Ave; Ptd, ME 04103 Phone # 797-5483 *call path up*
Est. Construction Cost: _____ Proposed Use: Dinosaur Exhibit
Past Use: auto showroom
of Existing Res. Units _____ # of New Res. Units _____
Building Dimensions L _____ W _____ Total Sq. Ft. _____
Stories: _____ # Bedrooms _____ Lot Size: _____
Is Proposed Use: Seasonal _____ Condominium _____ Conversion _____
Explain Conversion CHANGE OF USE - from auto showroom to
dinosaur exhibit

For Official Use Only PERMIT ISSUED
Date 6/5/90 Subdivision: _____ Name _____
Inside Fire Limits _____ Lot JUN 15 1990
Blk. Code _____ Ownership: _____
Time Limit _____ Estimated Cost _____
Zoning: B-4 Zone
Street Frontage Provided: _____
Provided Setbacks: Front _____ Back _____ Side _____
Review Required: _____
Zoning Board Approval: Yes _____ No _____ Date: _____
Planning Board Approval: Yes _____ No _____ Date: _____
Conditional Use: _____ Variance _____ Site Plan _____ Subdivision _____
Shoreland Zoning Yes _____ No _____ Floodplain Yes _____ No _____
Special Exception _____
Other (Explain) OK WRH 6-14-90

Foundation:
1. Type of Soil: _____
2. Set Backs - Front _____ Rear _____ Side(s) _____
3. Footings Size: _____
4. Foundation Size: _____
5. Other _____

Floor:
1. Sills Size: _____ Sills must be anchored.
2. Girder Size: _____
3. Lally Column Spacing: _____ Size: _____
4. Joists Size: _____ Spacing 16" O.C.
5. Bridging Type: _____ Size: _____
6. Floor Sheathing Type: _____ Size: _____
7. Other Material: _____

Exterior Walls:
1. Studding Size _____ Spacing _____
2. No. windows _____
3. No. Doors _____
4. Header Sizes _____ Span(s) _____
5. Bracing: Yes _____ No _____
6. Corner Posts Size _____
7. Insulation Type _____ Size _____
8. Sheathing Type _____ Size _____
9. Siding Type _____
10. Masonry Materials _____ Weather Exposure _____
11. Metal Materials _____

Interior Walls:
1. Studding Size _____ Spacing _____
2. Header Sizes _____ Span(s) _____
3. Wall Covering Type _____
4. Fire Wal if required _____
5. Other Materials _____

Ceiling:
1. Ceiling Joists Size: _____
2. Ceiling Strapping Size _____ Spacing _____
3. Type Ceilings: _____
4. Insulation Type _____ Size _____
5. Ceiling Height: _____

Roof:
1. Truss or Rafter Size _____ Span _____
2. Sheathing Type _____ Size _____
3. Roof Covering Type _____

Chimneys:
Type: _____ Number of Fire Places _____

Heating:
Type of Heat: _____
Electrical:
Service Entrance Size: _____ Smoke Detector Required Yes _____ No _____

Plumbing:
1. Approval of soil test if required Yes _____ No _____
2. No. of Tubs or Showers _____
3. No. of Flushes _____
4. No. of Lavatories _____
5. No. of Other Fixtures _____

Swimming Pools:
1. Type: _____
2. Pool Size: _____ x _____ Square Footage _____
3. Must conform to National Electrical Code and State Law.

Permit Received By Louise E. Chase
Signature of Applicant Michael Date 6/5/90
Signature of CEO Michael Date 6-7-90
Inspection Dates _____

PERMIT ISSUED WITH LETTER

White-Tax Assesor Yellow-GPCOG White Tag -CEO

127 © Copyright GPCOG 19
MRS. LOUISE CHASE

Permit # _____ City of Portland BUILDING PERMIT APPLICATION Fee \$10.00 Zone _____ Map # _____ Lot# _____
 Please fill out any part which applies to job. Proper plans must accompany form.

Owner: Lee Dodge/Hyundai Phone # 856-6685 - Donald
 Address: 200 Main St., West., ME 04092 Send Attn: Lee
 LOCATION OF CONSTRUCTION 191 Riverside St.
 Contractor: _____ Sub: _____
 Address: _____ Phone # _____
 Est. Construction Cost: _____ Proposed Use: Body Shop
 Past Use: same
 # of Existing Res. Units _____ # of New Res. Units _____
 Building Dimensions L _____ W _____ Total Sq. Ft. _____
 # Stories: _____ # Bedrooms _____ Lot Size: _____
 Is Proposed Use: Seasonal _____ Condominium _____ Conversion _____
 Explain Conversion Erect 4'x8' temp. sign for one month, April 14 to
 May 14, 1990 1st. time

For Official Use Only PERMIT ISSUED
 Date: April 13, 1990 Subdivision: _____
 Inside Fire Limits: _____ Name: APR 18 1990
 Bldg Code: _____ Lot: _____
 Time Limit: _____ Ownership: Public
 Estimated Cost: _____ City Of Portland
 Zoning: Street Frontage Provided: _____
 Provided Setbacks: Front _____ Back _____ Side _____
 Review Required: Zoning Board Approval: Yes _____ No _____ Date: _____
 Planning Board Approval: Yes _____ No _____ Date: _____
 Conditional Use: _____ Variance _____ Site Plan _____ Subdivision _____
 Shoreland Zoning Yes _____ No _____ Floodplain Yes _____ No _____
 Special Exception _____
 Other: (Explain) _____

Foundation:
 1. Type of Soil: _____
 2. Set Backs - Front _____ Rear _____ Side(s) _____
 3. Footings Size: _____
 4. Foundation Size: _____
 5. Other: _____

Floor:
 1. Sills Size: _____ Sills must be anchored.
 2. Girder Size: _____
 3. Lally Column Spacing: _____ Size: _____
 4. Joists Size: _____ Spacing 16" O.C.
 5. Bridging Type: _____ Size: _____
 6. Floor Sheathing Type: _____ Size: _____
 7. Other Material: _____

Exterior Walls:
 1. Studding Size _____ Spacing _____
 2. No. windows _____
 3. No. Doors _____
 4. Header Sizes _____ Span(s) _____
 5. Bracing: Yes _____ No _____
 6. Corner Posts Size _____
 7. Insulation Type _____ Size _____
 8. Sheathing Type _____ Size _____
 9. Siding Type _____ Weather Exposure _____
 10. Masonry Materials _____
 11. Metal Materials _____

Interior Walls:
 1. Studding Size _____ Spacing _____
 2. Header Sizes _____ Span(s) _____
 3. Wall Covering Type _____
 4. Fire Wall if required _____
 5. Other Materials _____

Ceiling:
 1. Ceiling Joists Size: _____
 2. Ceiling Strapping Size _____ Spacing _____
 3. Type Ceilings: _____
 4. Insulation Type _____ Size _____
 5. Ceiling Height: _____

Roof:
 1. Truss or Rafter Size _____
 2. Sheathing Type _____
 3. Roof Covering Type _____

Chimneys:
 Type: _____ Number of Fire Places _____

Heating:
 Type of Heat: _____

Electrical:
 Service Entrance Size: _____ Smoke Detector Required Yes _____ No _____

Plumbing:
 1. Approval of soil test if required Yes _____ No _____
 2. No. of Tubs or Showers _____
 3. No. of Flushes _____
 4. No. of Lavatories _____
 5. No. of Other Fixtures _____

Swimming Pools:
 1. Type: _____
 2. Pool Size: _____ x _____ Square Footage _____
 3. Must conform to National Electrical Code and State Law.

Permit Received By: Joyce M. Rinaldi

Signature of Applicant: _____ Date 4/13/90

Signature of CEO: _____ Date _____

Inspection Dates: _____

PLOT PLAN

N
↑

FEES (Breakdown From Front)
Base Fee \$ 10.00 _____
Subdivision Fee \$ _____
Site Plan Review Fee \$ _____
Other Fees \$ _____
(Explain) _____
Late Fee \$ _____

Type	Inspection Record	Date
_____	_____	____/____/____
_____	_____	____/____/____
_____	_____	____/____/____
_____	_____	____/____/____
_____	_____	____/____/____

COMMENTS

Signature of Applicant Ernest J. Givens Date 4/13/90

Permit # City of Portland BUILDING PERMIT APPLICATION Fee \$10.00 Zone _____ Map # _____ Lot# _____
 Please fill out any part which applies to job. Proper plans must accompany form.

Owner: Lee Dodge/Hyundai Phone # 856-6685 - Donald
 Address: 200 Main St., West., ME 04092 Send Attn: Lee
 LOCATION OF CONSTRUCTION 191 Riverside St.
 Contractor: _____ Sub: _____
 Address: _____ Phone # _____
 Est. Construction Cost: _____ Proposed Use: Body Shop
 Past Use: same
 # of Existing Res. Units _____ # of New Res. Units _____
 Building Dimensions L _____ W _____ Total Sq. Ft. _____
 # Stories: _____ # Bedrooms _____ Lot Size: _____
 Is Proposed Use: Seasonal _____ Condominium _____ Conversion _____
 Explain Conversion Erect 4'x8' temp. sign for one month, April 14 to
May 14, 1990 1st. time

For Official Use Only		PERMIT ISSUE
Date <u>April 13, 1990</u>	Subdivision:	Name <u>APR 18 1990</u>
Inside Fire Limits _____		Lot _____
Bldg Code _____	Ownership:	<u>City Of Portland</u> Public
Time Limit _____		
Estimated Cost _____		
Zoning:		
Street Frontage Provided: _____		
Provided Setbacks: Front _____ Back _____ Side _____ Side _____		
Review Required:		
Zoning Board Approval: Yes _____ No _____ Date: _____		
Planning Board Approval: Yes _____ No _____ Date: _____		
Conditional Use: _____ Variance _____ Site Plan _____ Subdivision _____		
Shoreland Zoning Yes _____ No _____ Floodplain Yes _____ No _____		
Special Exception _____		
Other (Explain) _____		

Foundation:

- Type of Soil: _____
- Set Backs - Front _____ Rear _____ Side(s) _____
- Footings Size: _____
- Foundation Size: _____
- Other _____

Floor:

- Sills Size: _____ Sills must be anchored.
- Girder Size: _____
- Lally Column Spacing: _____ Size: _____ Spacing 16" O.C.
- Joists Size: _____ Size: _____
- Bridging Type: _____ Size: _____
- Floor Sheathing Type: _____ Size: _____
- Other Material: _____

Exterior Walls:

- Studding Size _____ Spacing _____
- No. windows _____
- No. Doors _____
- Header Sizes _____ Span(s) _____
- Bracing: Yes _____ No _____
- Corner Posts Size _____
- Insulation Type _____ Size _____
- Sheathing Type _____ Size _____
- Siding Type _____ Weather Exposure _____
- Masonry Materials _____
- Metal Materials _____

Interior Walls:

- Studding Size _____ Spacing _____
- Header Sizes _____ Span(s) _____
- Wall Covering Type _____
- Fire Wall if required _____
- Other Materials _____

Ceiling:

- Ceiling Joists Size: _____ Spacing _____
- Ceiling Strapping Size _____
- Type Ceilings: _____
- Insulation Type _____ Size _____
- Ceiling Height: _____

Roof:

- Truss or Rafter Size _____ Span _____
- Sheathing Type _____ Size _____
- Roof Covering Type _____

Chimneys:

- Type: _____ Number of Fire Places _____

Heating:

- Type of Heat: _____

Electrical:

- Service Entrance Size: _____ Smoke Detector Required Yes _____ No _____

Plumbing:

- Approval of soil test if required Yes _____ No _____
- No. of Tubs or Showers _____
- No. of Flushes _____
- No. of Lavatories _____
- No. of Other Fixtures _____

Swimming Pools:

- Type: _____
- Pool Size: _____ x _____ Square Footage _____
- Must conform to National Electrical Code and State Law.

Permit Received By Joyce M. Rinaldi

Signature of Applicant [Signature] Date 4/13/90

Signature of CEO _____ Date _____

Inspection Dates _____

PERMIT # 000687 CITY OF Portland BUILDING PERMIT APPLICATION

MAP # _____ LOT# _____

Please fill out any part which applies to job. Proper plans must accompany form.

Owner: Lee Dodge

Address: 791 Riverside, Portland, Me 04103

LOCATION OF CONSTRUCTION Same

CONTRACTOR: Maine Bay Canvas SUBCONTRACTORS: 773-2261

ADDRESS: 977 Brighton Avenue, Portland, Me 04102

Est. Construction Cost: _____ Type of Use: 2 Tents/car sheds

Past Use: _____

Building Dimensions L _____ W _____ Sq. Ft. _____ # Stories: _____ Lot Size: _____

Is Proposed Use: _____ Seasonal _____ Condominium _____ Apartment _____

Conversion - Explain To erect 2 40 x 100 tents for car

sheds from 6/19 to 7/2. Certificate of

COMPLETE ONLY IF THE NUMBER OF UNITS WILL CHANGE Flame resistance attached

Residential Buildings Only: _____

Of Dwelling Units _____ # Of New Dwelling Units _____

Foundation:

1. Type of Soil: _____

2. Set Backs - Front _____ Rear _____ Side(s) _____

3. Footings Size: _____

4. Foundation Size: _____

5. Other _____

Floor:

1. Sills Size: _____ Sills must be anchored.

2. Girder Size: _____

3. Lally Column Spacing: _____ Size: _____

4. Joists Size: _____ Spacing 16" O.C.

5. Bridging Type: _____ Size: _____

6. Floor Sheathing Type: _____ Size: _____

7. Other Material: _____

Exterior Walls:

1. Studding Size _____ Spacing _____

2. No. windows _____

3. No. Doors _____

4. Header Sizes _____ Span(s) _____

5. Bracing: Yes _____ No _____

6. Corner Posts Size _____

7. Insulation Type _____ Size _____

8. Sheathing Type _____ Size _____

9. Siding Type _____ Weather Exposure _____

10. Masonry Materials _____

11. Metal Materials _____

Interior Walls:

1. Studding Size _____ Spacing _____

2. Header Sizes _____ Span(s) _____

3. Wall Covering Type _____

4. Fire Wall if required _____

5. Other Materials _____

For Official Use Only	
Date <u>June 9, 1988</u>	Subdivision: Yes / No _____
Inside Fire Limits _____	Name _____
Blk. Code _____	Lot _____
Type _____	Block _____
Estimated Cost _____	Permit Expiration: _____
Value/Structure _____	Ownership: _____ Public _____ Private _____
Fee <u>\$35.00</u>	

Ceiling: **PERMIT ISSUED**
 1. Ceiling Joists Size: _____
 2. Ceiling Strapping Size _____ Spacing _____
 3. Type Ceilings: _____ **JUN 14 1988**
 4. Insulation Type _____ Size _____
 5. Ceiling Height: _____

Roof: **City Of Portland**
 1. Truss or Rafter Size _____ Span _____
 2. Sheathing Type _____ Size _____
 3. Roof Covering Type _____
 4. Other _____

Chimneys: _____
 Type: _____ Number of Fire Places _____

Heating: _____
 Type of Heat: _____

Electrical: _____
 Service Entrance Size: _____ Smoke Detector Required Yes _____ No _____

Plumbing: _____
 1. Approval of soil test if required Yes 2c No _____
 2. No. of Tubs or Showers _____
 3. No. of Flushes _____
 4. No. of Lavatories _____
 5. No. of Other Fixtures _____

Swimming Pools: _____
 1. Type: _____
 2. Pool Size: _____ x _____ Square Footage _____
 3. Must conform to National Electrical Code and State Law.

Zoning: _____
 District B-2 Street Frontage Req.: _____ Provided _____
 Required Setbacks: Front _____ Back _____ Side _____

Review Required: _____
 Zoning Board Approval: Yes _____ No _____ Date: _____
 Planning Board Approval: Yes _____ No _____ Date: _____
 Conditional Use: _____ Variance _____ Site Plan _____ Subdivision _____
 Shore and Floodplain Mgmt. _____ Special Exception _____
 Other (Explain) _____
 Date Approved OK. [Signature] June 10, 1988

Permit Received By Nancy L. Deema

Signature of Applicant [Signature] Date 6/9/88

Signature of CEO [Signature] Date 6-13-88

Inspection Date: _____

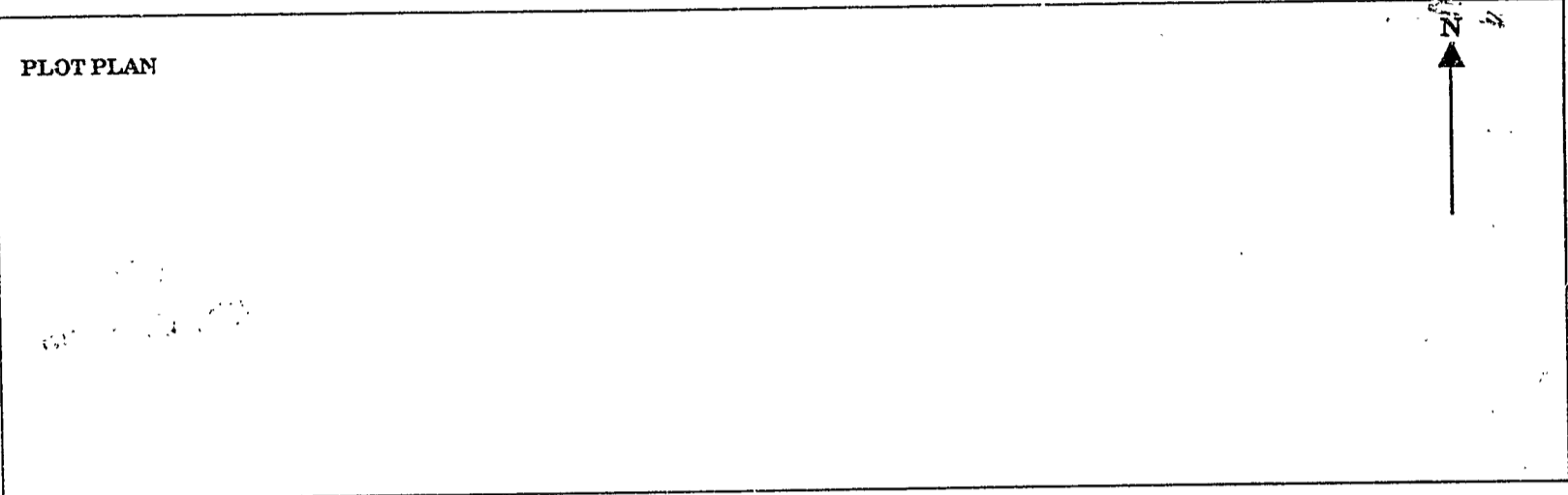

FEES (Breakdown From Front)	Type	Inspection Record	Date
Base Fee \$35.00 _____	_____	_____	____/____/____
Subdivision Fee \$ _____	_____	_____	____/____/____
Site Plan Review Fee \$ _____	_____	_____	____/____/____
Other Fees \$ _____	_____	_____	____/____/____
(Explain) _____	_____	_____	____/____/____
Late Fee \$ _____	_____	_____	____/____/____

COMMENTS

Signature of Applicant *Chad Kim* Date 6/9/88

CERTIFICATE OF FLAME RESISTANCE

Issued By



APPROVED AND LISTED UNDER THE
RE-EXAMINATION SERVICE OF UNDER-
WRITERS' LABORATORIES - FILE R5117

Graniteville Company

WOODHEAD DIVISION

Date 3-2-87

FIRE CHIEF

TRADE MARK ® REGISTERED

This is to certify that the fabric described on the reverse side of this certificate, covered by our order no. 165JA and
customer's order no. _____

FOR THE ASTRUP CO.

Was finished on 11-15-86 with our 1802 Fire Chief in accordance with specification 16A
DATE

FIRE CHIEF®

(Weather Resistant for Interior or Outdoor Use)
WILL BE CERTIFIED ON REQUEST, UNDER
CALIFORNIA LAW.

REGISTERED
APPLICATION
CONCERN NO.

A-196



GRANITEVILLE COMPANY

Sherman Converse, Director of Research

"LOOK FOR THE FIRE CHIEF TRADE MARK ON THE SELVAGE"

We hereby certify this to be a true copy of the original "CERTIFICATE OF FLAME RESISTANCE" issued
to us, "original copy" of which has been filed with the California State Fire Marshal.

The ASTRUP COMPANY

Address _____

Signed by _____

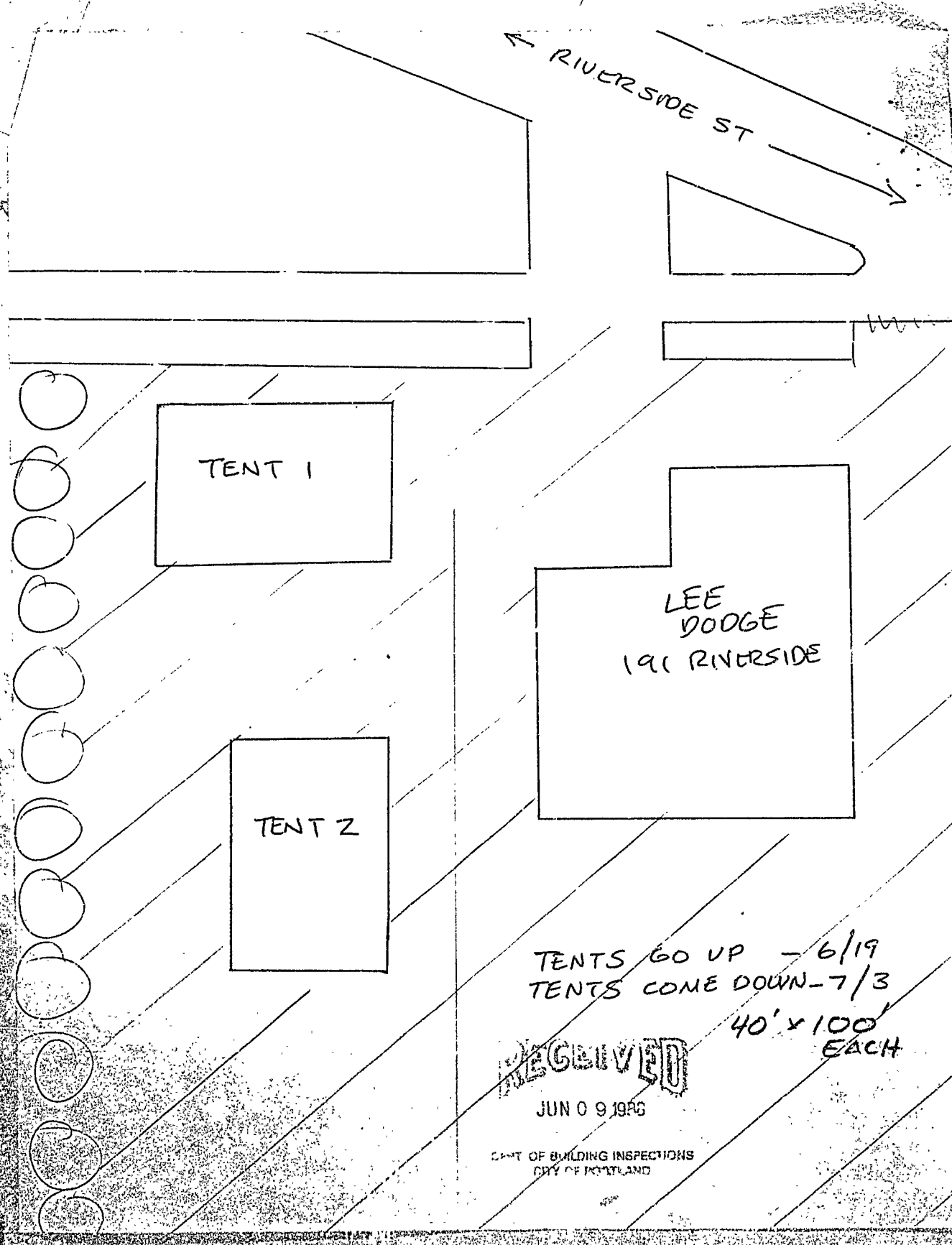

← RIVERSIDE ST →

TENT 1

LEE
DODGE
191 RIVERSIDE

TENT 2

TENTS GO UP - 6/19
TENTS COME DOWN - 7/3

40' x 100'
EACH

RECEIVED

JUN 09 1946

DEPT OF BUILDING INSPECTIONS
CITY OF PORTLAND

MAIL PERMIT TO Michael O'Connell Children's Museum of Maine 745 Stevens Ave. Portland, 04103
 Permit # _____ City of Portland BUILDING PERMIT APPLICATION Fee \$25.00 Zone _____ Map # _____ Lot# _____
 Please fill out any part which applies to job. Proper plans must accompany form.

Owner: Lee Dodge Phone # _____
 Address: 191 Riverside St. Portland, Maine 912608
 LOCATION OF CONSTRUCTION 191 Riverside St.
 Contractor: self Sub: _____
 Address: _____ Phone # _____
 Est. Construction Cost: \$500.00 Proposed Use: Childrens Museum
 Past Use: Auto showroom
 # of Existing Res. Units _____ # of New Res. Units _____
 Building Dimensions L _____ W _____ Total Sq. Ft. _____
 # Stories: _____ # Bedrooms _____ Lot Size: _____
 Is Proposed Use: Seasonal _____ Condominium _____ Conversion _____
 Explain Conversion Change of Use as above with renovations as per plan

For Official Use Only

Date: May 6, 1991
 Inside Fire Limits _____
 Bldg Code _____
 Time Limit _____
 Estimated Cost _____

Subdivision: _____
 Name: _____
 Lot #: _____
 Ownership: _____

PERMIT ISSUED
 MAY 16 1991
 CITY OF PORTLAND

Zoning: B-4 Zone
 Street Frontage Provided: _____
 Provided Setbacks: Front _____ Back _____ Side _____
 Review Required: _____
 Zoning Board Approval: Yes _____ No _____ Date: _____
 Planning Board Approval: Yes _____ No _____ Date: _____
 Conditional Use: _____ Variance _____ Site Plan _____ Subdivision _____
 Shoreland Zoning Yes _____ No _____ Floodplain Yes _____ No _____
 Special Exception _____
 Other (Explain): OK W/DH 5-15-91

Foundation:
 1. Type of Soil: _____
 2. Set Backs - Front _____ Rear _____ Side(s) _____
 3. Footings Size: _____
 4. Foundation Size: _____
 5. Other _____

Floor:
 1. Sills Size: _____ Sills must be anchored.
 2. Girder Size: _____
 3. Lally Column Spacing: _____ Size: _____
 4. Joists Size: _____ Spacing 16" O.C.
 5. Bridging Type: _____ Size: _____
 6. Floor Sheathing Type: _____ Size: _____
 7. Other Material: _____

Exterior Walls:
 1. Studding Size _____ Spacing _____
 2. No. windows _____
 3. No. Doors _____
 4. Header Sizes _____
 5. Bracing: Yes _____ No _____ Span(s) _____
 6. Corner Posts Size _____
 7. Insulation Type _____ Size _____
 8. Sheathing Type _____ Size _____
 9. Siding Type _____
 10. Masonry Materials _____ Weather Exposure _____
 11. Metal Materials _____

Interior Walls:
 1. Studding Size _____ Spacing _____
 2. Header Sizes _____ Span(s) _____
 3. Wall Covering Type _____
 4. Fire Wall if required _____
 5. Other Materials _____

Ceiling:
 1. Ceiling Joists Size: _____
 2. Ceiling Strapping Size _____ Spacing _____
 3. Type Ceilings: _____
 4. Insulation Type _____ Size _____
 5. Ceiling Height: _____

Roof:
 1. Truss or Rafter Size _____ Span _____
 2. Sheathing Type _____ Size _____
 3. Roof Covering Type _____ Size _____

Chimneys:
 Type: _____ Number of Fire Places _____ Date: _____
 Heating: _____ Type of Heat: _____

Electrical:
 Service Entrance Size: _____ Smoke Detector Required Yes _____ No _____

Plumbing:
 1. Approval of soil test if required Yes _____ No _____
 2. No. of Tubs or Showers _____
 3. No. of Flushes _____
 4. No. of Lavatories _____
 5. No. of Other Fixtures _____

Swimming Pools:
 1. Type: _____
 2. Pool Size: _____ x _____ Square Footage _____
 3. Must conform to National Electrical Code and State Law.

Permit Received By: _____
 Signature of Applicant: _____ Date: 5/6/91
 Signature of CEO: _____ Date: 5/14/91
 Inspection Dates: _____

White-Tax Assessor Yellow-GPCOG White Tag - CEO [2] MRS. LOWE
 Copyright GPCOG 1988

9 PERMIT # 6877 CITY OF Portland BUILDING PERMIT APPLICATION MAP # 1017

Please fill out any part which applies to job. Proper plans must accompany form.

Owner: Lee Dodge

Address: 191 Alverside, Portland, Me. 04101

LOCATION OF CONSTRUCTION: Same

CONTRACTOR: Maine Bay Canvas SUBCONTRACTORS: 773-2261

ADDRESS: 977 Brighton Avenue, Portland, Me 04102

Est. Construction Cost: _____ Type of Use: 2 Tents/Car sales

Part Use: _____

Building Dimensions: L _____ W _____ Sq. Ft. _____ # Stories: _____ Lot Size: _____

In Proposed Use: Statement _____ Condominium _____ Apartment _____

Conversion - Explain: To erect 2 40 x 100 tents for car
COMPLETE ONLY IF THE NUMBER OF UNITS WILL CHANGE Flame resistance of
residential building only # C' New Dwelling Units _____

Foundation: _____

1. Type of Soil: _____
 2. Soil Backer - Front: _____ Rear: _____ Sides: _____
 3. Footings Size: _____
 4. Foundation Size: _____
 5. Other: _____

Floors: _____
 1. Sills Size: _____ Sills must be anchored.
 2. Girder Size: _____
 3. Lally Column Spacing: _____ Size: _____
 4. Joist Size: _____ Size: _____ Spacing: 16" O.C.
 5. Bridging Type: _____ Size: _____
 6. Floor Sheathing Type: _____ Size: _____
 7. Other Materials: _____

Exterior Walls: _____
 1. Studding Size: _____ Spacing: _____
 2. No. windows: _____
 3. No. Doors: _____
 4. Header Size: _____ Spacing: _____
 5. Bracing: Yes _____ No _____
 6. Corner Posts Size: _____
 7. Insulation Type: _____ Size: _____
 8. Sheathing Type: _____ Size: _____
 9. Siding Type: _____ Weather Exposure: _____
 10. Masonry Materials: _____
 11. Metal Materials: _____

Interior Walls: _____
 1. Studding Size: _____ Spacing: _____
 2. Header Size: _____ Spacing: _____
 3. Wall Covering Type: _____
 4. Fire Wall if required: _____
 5. Other Materials: _____

Date: <u>June 9, 1988</u>	Subdivision: Yes / No _____
Inside Fire Limits: _____	Name: _____
Blig Code: _____	Lot: _____
Time Limit: _____	Block: _____
Estimated Cost: _____	Permit Expiration: _____
Value/Structure: _____	Ownership: _____
Fee \$35.00	Public/Private _____

Permit Issued: _____

City of Portland

Roof: _____
 1. Truss or Rafters Size: _____ Spacing: _____
 2. Sheathing Type: _____ Size: _____
 3. Roof Covering Type: _____
 4. Other: _____

Chimneys: _____
 Type: _____ Number of Fire Places: _____

Heating: _____
 Type of Heat: _____

Electrical: _____
 Service Entrance Size: _____ Smoke Detector Required Yes _____ No _____

Plumbing: _____
 1. Approval of soil test if required Yes _____ No _____
 2. No. of Toilets or Showers _____
 3. No. of Sinks _____
 4. No. of Lavatories _____
 5. No. of Other Fixtures _____

Swimming Pools: _____
 1. Type: _____
 2. Pool Size: _____ square footage _____
 3. Must conform to National State Law _____

Zoning: _____
 District: _____ Street Etc: _____
 Required Setbacks: Front _____ Side _____
 Review Required: _____
 Zoning Board Approval: Yes _____ No _____ Date: _____
 Planning Board Approval: Yes _____ No _____ Date: _____
 Conditional Use: _____ Variance _____ Site Plan _____ Subdivision _____
 Shore and Floodplain Mgmt: _____ Special Exception _____
 Other: (Explain) _____
 Date Approved: _____

Permit Received By: Nancy L. Dzema
 Signature of Applicant: _____ Date: 6/9/88
 Signature of CEO: _____ Date: _____

Inspection Dates: _____
 White-Tax Assessor _____ Yellow-GPCOG _____
 White Tag-CEO _____
 © Copyright GPCOG 1987

930545

Permit # _____ City of Portland BUILDING PERMIT APPLICATION Fee 20.00 Zone B4 Map # _____ Lot# _____
Please fill out any part which applies to job. Proper plans must accompany form.

Owner: Lee Dodge/Fletcher Brown Phone # _____
 Address: _____
 LOCATION OF CONSTRUCTION 191 Riverside St
 Contractor: Pollution Control Services
 Address: Box 117 Gorham, ME 04038 Phone # 829-0884
 Est. Construction Cost: _____ Proposed Use: Auto Sales w/o Tanks
 Past Use: Auto Sales
 # of Existing Res. Units _____ # of New Res. Units _____
 Building Dimensions L _____ W _____ Total Sq. Ft. _____
 # Stories: _____ # Bedrooms _____ Lot Size: _____
 Is Proposed Use: Seasonal _____ Condominium _____ Conversion _____
 Explain Conversion Removal of 2 underground tanks

For Official Use Only

Date June 25, 1993 Subdivision: _____
 Inside Fire Limits: _____ Name: JUN 28 1993
 Bldg Code: _____ Lot: _____
 Time Limit: _____ Ownership: _____
 Estimated Cost: _____

CITY OF PORTLAND

Zoning: _____
 Street Frontage Provided: _____
 Provided Setbacks: Front _____ Back _____ Side _____
 Review Required:
 Zoning Board Approval: Yes _____ No _____ Date: _____
 Planning Board Approval: Yes _____ No _____ Date: _____
 Conditional Use: _____ Variance _____ Site Plan _____ Subdivision _____
 Shoreland Zoning Yes _____ No _____ Floodplain Yes _____ No _____
 Special Exception _____
 Other (Explain) _____

Foundation:
 1. Type of Soil: _____
 2. Set Backs - Front _____ Rear _____ Side(s) _____
 3. Footings Size: _____
 4. Foundation Size: _____
 5. Other _____

Floor:
 1. Sills Size: _____ Sill must be anchored.
 2. Girder Size: _____
 3. Lally Column Spacing: _____ Size: _____
 4. Joists Size: _____ Spacing 16" O.C.
 5. Bridging Type: _____ Size: _____
 6. Floor Sheathing Type: _____ Size: _____
 7. Other Material: _____

Exterior Walls:
 1. Studding Size _____ Spacing _____
 2. No. windows _____
 3. No. Doors _____
 4. Header Sizes _____ Span(s) _____
 5. Bracing: Yes _____ No _____
 6. Corner Posts Size _____
 7. Insulation Type _____ Size _____
 8. Sheathing Type _____ Size _____
 9. Siding Type _____ Weather Exposure _____
 10. Masonry Materials _____
 11. Metal Materials _____

Interior Walls:
 1. Studding Size _____ Spacing _____
 2. Header Sizes _____ Span(s) _____
 3. Wall Covering Type _____
 4. Fire Wall if required _____
 5. Other Materials _____

Ceiling:
 1. Ceiling Joists Size: _____
 2. Ceiling Strapping Size _____ Spacing _____
 3. Type Ceiling: _____
 4. Insulation Type _____ Size _____
 5. Ceiling Height: _____

Roof:
 1. Truss or Rafter Size _____ Span _____
 2. Sheathing Type _____ Size _____
 3. Roof Covering Type _____

Chimneys:
 Type: _____ Number of Fire Places _____

Heating:
 Type of Heat: _____

Electrical:
 Service Entrance Size: _____ Smoke Detector Required Yes _____ No _____

Plumbing:
 1. Approval of soil test if required Yes _____ No _____
 2. No. of Tubs or Showers _____
 3. No. of Flushes _____
 4. No. of Lavatories _____
 5. No. of Other Fixtures _____

Swimming Pools:
 1. Type: _____
 2. Pool Size: _____ x _____ if Equipped Footage
 Must conform to National Electrical Code and State Law.

Permit Received By Mary Gresik
 Signature of Applicant Peter Reynolds Date June 25, 1993
 Signature of CEO _____ Date _____
 Inspection Dates _____

PERMIT ISSUED WITH REQUIREMENTS

White-Tax Assessor Yellow-GPCOG White Tag -CEO 14/11/93 Copyright GPCOG 1988

930772

Permit # _____ City of Portland BUILDING PERMIT APPLICATION Fee 300.00 Zone _____ Map # _____ Lot# _____
Please fill out any part which applies to job. Proper plans must accompany form.

Owner: Fletcher Brown-Keenan Auction Phone # _____
Address: Keenan - P.O. Box 288 Main St Kingsfield, ME 04947
LOCATION OF CONSTRUCTION 191 Riverside St 258-XX-001X
Contractor: Keenan Auction Sub: _____
Address: _____ Phone # 877-0900
Est. Construction Cost: _____ Proposed Use: Retail/Auction Center
Past Use: Auto Dealership
of Existing Res. Units _____ # of New Res. Units _____
Building Dimensions L _____ W _____ Total Sq. Ft. _____
Stories: _____ # Bedrooms _____ Lot Size: _____
Is Proposed Use: Seasonal _____ Condominium _____ Conversion _____
Explain Conversion Change of Use - with renovations

For Official Use Only
Date April 13, 1993
Inside Fire Limits _____
Bldg Code _____
Time Limit _____
Estimated Cost _____
Subdivision Name: 258-XX-001X
Ownership: _____
City of **PORTLAND**
PERMIT ISSUED
Date: APR 30 1993
Other: (E) 8-26-93

Foundation: ***building permit fee paid 8/6/93
1. Type of Soil: #93-0697
2. Set Backs - Front _____ Rear _____ Side(s) _____
3. Footings Size: & dump permit
4. Foundation Size: _____
5. Other: _____

Floor:
1. Sills Size: _____ Sills must be anchored.
2. Girder Size: _____
3. Lally Column Spacing: _____ Size: _____
4. Joists Size: _____ Spacing 16" O.C.
5. Bridging Type: _____ Size: _____
6. Floor Sheathing Type: _____ Size: _____
7. Other Material: _____

Exterior Walls:
1. Studding Size _____ Spacing _____
2. No. windows _____
3. No. Doors _____
4. Header Sizes _____ Spacing _____
5. Bracing: Yes _____ No _____
6. Corner Posts Size _____
7. Insulation Type _____ Size _____
8. Sheathing Type _____ Size _____
9. Siding Type _____ Weather _____
10. Masonry Materials _____
11. Metal Materials _____

Interior Walls:
1. Studding Size _____ Spacing _____
2. Header Sizes _____ Spacing _____
3. Wall Covering Type _____
4. Fire Wall if required _____
5. Other Materials _____

Ceiling:
1. Ceiling Joists Size: _____
2. Ceiling Strapping Size _____ Spacing _____
3. Type Ceilings _____
4. Insulation Type _____ Size _____
5. Ceiling Height: _____
Roof:
1. Truss or Rafter Size _____ Span _____
2. Sheathing Type _____ Size _____
3. Roof Covering Type _____
Chimneys:
Type: _____ Number of Fire Places _____
Heating:
Type of Heat: _____
Electrical:
Service Entrance Size: _____ Smoke Detector Required Yes _____ No _____
Plumbing:
1. Approval of soil test if required Yes _____ No _____
2. No. of Tubs or Showers _____
3. No. of Flushes _____
4. No. of Lavatories _____
5. No. of Other Fixtures _____
Swimming Pools:
1. Type: _____
2. Pool Size: _____ x _____ Square Footage _____
3. Must conform to National Electrical Code _____

PERMIT ISSUED WITH LETTER

PERMIT ISSUED WITH LETTER

Permit Received By Mary Gresik
Signature of Applicant Stephen G. Doe (Agent) Date April 13, 1993
Signature of CEO Stephen Doe Date _____
Inspection Dates _____

930697

ALL FEES HAVE BEEN PAID Dump Permit Fee \$300.00

Permit # _____ City of Portland BUILDING PERMIT APPLICATION Fee \$770.00 Zone _____ Map # _____ Loc # _____

Please fill out any part which applies to job. Proper plans must accompany form.

Owner: Fletcher Brown Phone # 781-5878
 Address: 183 Foreside Rd. Falmouth, ME 04105
 *833*** Lessee: Keenan Auction Co. 75 Pearl St. Portland 04101
 LOCATION OF CONSTRUCTION: * 191 Riverside St.
 Contra. to: Keenan Auction Co. Sub: _____
 Address: 75 Pearl St. Portland Phone # 772-7420
 Est. Construction Cost: 150,000 Proposed Use: retail and auction
 Past Use: collision center
 # of Existing Res. Units _____ # of New Res. Units _____
 Building Dimensions L _____ W _____ Total Sq. Ft. _____
 # Stories: _____ # Bedrooms _____ Lot Size: _____
 Is Proposed Use: Seasonal _____ Condominium _____ Conversion _____
 Explain Conversion: demo interior walls, as per plans

For Official Use Only

Date: August 6, 1993
 (inside Fire Limits)
 Bldg Code: _____
 Time Limit: _____
 Estimated Cost: 150,000

Subdivisor: _____
 Date: AUG 10 1993
 City of PORTLAND

Zoning: _____
 Street Frontage Provided: _____
 Provided Setbacks: Front _____ Back _____ Side _____
 Review Required: _____
 Zoning Board Approval: Yes _____ No _____ Date: _____
 Planning Board Approval: Yes _____ No _____ Date: _____
 Conditional Use: _____ Variance _____ Site Plan _____ Subdivision _____
 Shoreland Zoning Yes _____ No _____ Floodplain Yes _____ No _____
 Special Exception: _____
 Other: (See plan)

Foundation: Dump Permit # 30-0141
 1. Type of Soil: _____
 2. Set Backs - Front _____ Rear _____ Side(s) _____
 3. Footings Size: _____
 4. Foundation Size: _____
 5. Other: _____

Floor: _____
 1. Sills Size: _____ Sills must be anchored.
 2. Girder Size: _____
 3. Lally Column Spacing: _____ Size: _____
 4. Joists Size: _____ Spacing 16" O.C.
 5. Bridging Type: _____ Size: _____
 6. Floor Sheathing Type: _____ Size: _____
 7. Other Material: _____

Exterior Walls: _____
 1. Studding Size _____ Spacing _____
 2. No. windows _____
 3. No. Doors _____
 4. Header Sizes _____ Span(s) _____
 5. Bracing: Yes _____ No _____
 6. Corner Posts Size _____
 7. Insulation Type _____ Size _____
 8. Sheathing type _____ Size _____
 9. Siding Type _____ Weather Exposure _____
 10. Masonry Materials _____
 11. Metal Materials _____

Interior Wall: _____
 1. Studding Size _____ Spacing _____
 2. Header Sizes _____ Span(s) _____
 3. Wall Covering Type _____
 4. Fire Wall if required _____
 5. Other Materials _____

Ceiling: _____
 1. Ceiling Joists Size: _____
 2. Ceiling Strapping Size _____ Spacing _____ Not in District nor Landmark
 3. Type Ceiling: _____ Does not require review
 4. Insulation Type _____ Size _____ Requires review
 5. Ceiling Height: _____

Roof: _____
 1. Truss or Rafter Size _____ Span _____ Action: Approved
 2. Sheathing Type _____ Size _____ Approved with conditions
 3. Roof Covering Type _____

Chimneys: _____
 Type: _____ Number of Fire Places _____ Date: _____
 Signature: _____

Heating: _____
 Type of Heat: _____

Electrical: _____
 Service Entrance Size: _____ Smoke Detector Required Yes _____ No _____

Plumbing: _____
 1. Approval of soil test if required Yes _____ No _____
 2. No. of Tubs or Showers _____
 3. No. of Flushes _____
 4. No. of Lavatories _____
 5. No. of Other Fixtures _____

Swimming Pools: _____
 1. Type: _____
 2. Pool Size: _____ x _____ Square Footage _____
 3. Must conform to National Electrical Code and State Law.

Permit Received By _____
 Signature of Applicant: Timothy D. How Date: 8/6/93

Signature of CEO: _____ Date: _____

Inspection Dates: _____

White-Tax Assesor Yellow-GPCOG White Tag -CEO 4 Copyright GPOC 1988

930806

City of Portland BUILDING PERMIT APPLICATION Fee 98.60 Zone Map

PERMIT ISSUED

Please fill out any part which applies to job. Proper plans must accompany form.

Owner: Keeman Auction Co. Phone # _____
 Address: 75 Pearl St 04101
 LOCATION OF CONSTRUCTION 191 Riverside St
 Contractor: Rockwell Burr Sub: _____
 Address: 184 Read St Portland, ME 04103 Phone # 761-3939
 Est. Construction Cost: _____ Proposed Use: _____
 UL#: E143239 Past Use: _____
 # of Existing Res. Units _____ # of New Res. Units _____
 Building Dimensions L _____ W _____ Total Sq Ft. _____
 # Stories: _____ # Bedrooms _____ Lot Size: _____
 Is Proposed Use: Seasonal _____ Condominium _____ Conversion _____
 Explain Change: Replace Sign Facing - 368 total sq ft

For Official Use Only
 Date: September 7, 1993
 Inside Fire Limits _____
 Bltg Code _____
 Time Limit _____
 Estimated Cost _____
 Subdivision: _____
 OF PORTLAND
 Public _____ Private _____
 Zoning: Street Frontage Provided: _____
 Provided Setbacks: Front _____ Back _____ Side _____ Side _____
 Review Required:
 Zoning Board Approval: Yes _____ No _____ Date: _____
 Planning Board Approval: Yes _____ No _____ Date: _____
 Conditional Use: _____ Variance _____ Site Plan _____ Subdivision _____
 Shoreland Zoning Yes _____ No _____ Floodplain Yes _____ No _____
 Special Exception _____
 Other: (Explain) _____

Foundations:
 1. Type of Soil: _____
 2. Set Backs - Front _____ Rear _____ Side(s) _____
 3. Footings Size: _____
 4. Foundation Size: _____
 5. Other: _____

Floor:
 1. Sill, Size: _____ Sills must be anchored.
 2. Girder Size: _____
 3. Lally Column Spacing: _____ Size: _____
 4. Joist Size: _____ Spacing 18" O.C.
 5. Bridging Type: _____ Size: _____
 6. Floor Sheathing Type: _____ Size: _____
 7. Other Material: _____

Exterior Walls:
 1. Studding Size _____ Spacing _____
 2. No. windows _____
 3. No. Doors _____
 4. Header Sizes _____ Spacing _____
 5. Bracing: Yes _____ No _____
 6. Corner Posts Size _____
 7. Insulation Type _____ Size _____
 8. Sheathing Type _____ Size _____
 9. Siding Type _____ Weather Exposure _____
 10. Masonry Materials _____
 11. Metal Materials _____

Interior Walls:
 1. Studding Size _____ Spacing _____
 2. Header Sizes _____ Spacing _____
 3. Wall Covering Type _____
 4. Fire Wall if required _____
 5. Other Materials _____

Ceiling:
 1. Ceiling Joist Size: _____
 2. Ceiling Strapping Size _____ Spacing _____
 3. Type Ceiling: _____
 4. Insulation Type _____ Size _____
 5. Ceiling Height: _____
 Roof:
 1. Truss or Rafter Size _____ Span Action: _____
 2. Sheathing Type _____ Size _____
 3. Roof Covering Type _____
 Chimneys:
 Type: _____ Number of Fire Places _____ Date: _____
 Heating:
 Type of Heat: _____
 Electrical:
 Service Entrance Size: _____ Smoke Detector Required Yes _____ No _____
 Plumbing:
 1. Approval of soil test if required Yes _____ No _____
 2. No. of Tubs or Showers _____
 3. No. of Flushes _____
 4. No. of Lavatories _____
 5. No. of Other Fixtures _____
 Swimming Pools:
 1. Type: _____
 2. Pool Size: _____ x _____ Square Footage _____
 3. Must conform to National Electrical Code and State Law.

Permit Received By: Mary Grestik
 Signature of Applicant: _____ Date: Sept 7, 1993
 Signature of CEO: _____ Date: _____
 Inspection Dates: _____

White-Tax Assessor Yellow-GPCOG White Tag-CEO Copyright GPCOG 1988



APPLICATION FOR PERMIT
DEPARTMENT OF BUILDING INSPECTIONS SERVICES
ELECTRICAL INSTALLATIONS

Date 7/29/93
 Receipt and Permit number 6374

To the CHIEF ELECTRICAL INSPECTOR, Portland, Maine:

The undersigned hereby applies for a permit to make electrical installations in accordance with the laws of Maine, the Portland Electrical Ordinance, the National Electrical Code and the following specifications:

LOCATION OF WORK: 191 Riverside St. - behind Lee/Dodge Collision ctr
 OWNER'S NAME: Keenan Auction CO. ADDRESS: _____

	FEES
OUTLETS:	
Receptacles _____ Switches _____ Plugmold _____ ft. TOTAL _____	
FIXTURES: (number of)	
Incandescent _____ Fluorescent _____ (not strip) TOTAL _____	
Strip Fluorescent _____ ft. _____	
SERVICES:	
Overhead _____ Underground _____ Temporary: <u>X</u> TOTAL amperes <u>100</u> ..	<u>15.00</u>
METERS: (number of) <u>1</u> ..	<u>1.00</u>
MOTORS: (number of)	
Fractional _____	
1 HP or over <u>X</u> ..	<u>2.00</u>
RESIDENTIAL HEATING:	
Oil or Gas (number of units) _____	
Electric (number of rooms) _____	
COMMERCIAL OR INDUSTRIAL HEATING:	
Oil or Gas (by a main boiler) _____	
Oil or Gas (by separate units) _____	
Electric Under 20 kws _____ Over 20 kws _____	
APPLIANCES: (number of)	
Ranges _____	Water Heaters _____
Cook Tops _____	Disposals _____
Wall Ovens _____	Dishwashers _____
Dryers _____	Compactors _____
Fans _____	Others (denote) _____
TOTAL ..	
MISCELLANEOUS: (number of)	
Branch Panels _____	
Transformers _____	
Air Conditioners Central Unit _____	
Separate Units (windows) _____	
Signs 20 sq. ft. and under _____	
Over 20 sq. ft. _____	
Swimming Pools Above Ground _____	
In Ground _____	
Fire/Burglar Alarms Residential _____	
Commercial _____	
Heavy Duty Outlets, 220 Volt (such as welders) 30 amps and under _____	
over 30 amps _____	
Circus, Fairs, etc. _____	
Alterations to wires _____	
Repairs after fire _____	
Emergency Lights, battery _____	
Emergency Generators _____	
FOR ADDITIONAL WORK NOT ON ORIGINAL PERMIT	INSTALLATION FEE DUE: _____
FOR REMOVAL OF A "STOP ORDER" (304-16.b)	DOUBLE FEE DUE: _____
	TOTAL AMOUNT DUE: <u>18.00</u>

INSPECTION:
 Will be ready on 7/30 - am, 1st; or Will Call _____
CONTRACTOR'S NAME: H C L Services
ADDRESS: 220 Indust Way - Ptd
TEL: 878-3325
MASTER LICENSE NO.: MC60016394 **SIGNATURE OF CONTRACTOR:**
LIMITED LICENSE NO.: _____ *Paul O. Landry*

INSPECTOR'S COPY — WHITE
 OFFICE COPY — CANARY
 CONTRACTOR'S COPY — GREEN

940030

Permit # _____ City of Portland BUILDING PERMIT APPLICATION Fee \$190 Zone _____ Map # _____ Lot# _____
Please fill out any part which applies to job. Proper plans must accompany form.

Owner: Keenan Auction Co Phone # 772-7420
Address: 75 Pearl St- Ptld, ME 04101
LOCATION OF CONSTRUCTION 191 Riverside St.
Contractor: OWNER Sub: _____
Address: _____ Phone # _____
Est. Construction Cost: 34,000 Proposed Use: office space
Past Use: XXXXXXXXXXXXXXXX Renovations
of Existing Res. Units _____ # of New Res. Units _____
Building Dimensions L _____ W _____ Total Sq. Ft. _____
Stories _____ # Bedrooms _____ Lot Size _____
Is Proposed Use: Seasonal _____ Condominium _____ Conversion _____
Explain Conversion interior renovations - XXXXXXXXXX

For Official Use Only
Date 1/10/94 Subdivision _____
Side Fire Limits _____ Name _____
Eldg. Code _____ Lot _____
Time Lin. _____ Ownership: _____ Public _____ Private _____
Estimated Cost 34,000
Zoning: Street Frontage Provided: _____
Provided Setback: Front _____ Back _____ Side _____ Side _____
Review Required: Zoning Board Approval: Yes _____ No _____ Date: _____
Planning Board Approval: Yes _____ No _____ Date: _____
Conditional Use: _____ Variance _____ Site Plan _____ Subdivision _____
Shoreland Zoning Yes _____ No _____ Floodplains Yes _____ No _____
Special Exception _____
Other (Explain) _____

Foundation:
1. Type of Soil: _____
2. Set Backs - Front _____ Rear _____ Side(s) _____
3. Footings Size: _____
4. Footing Size: _____
5. Other: Mail Permit: Sebago Technic Inc.
Box 1339
Westbrook, ME 04098
Sills must be anchored.
Floor:
1. Sills Size: _____
2. Girder Size: _____
3. Lally Column Spacing: _____ Size: _____
4. Joists Size: _____ Spacing 16" O.C.
5. Bridging Type: _____ Size: _____
6. Floor Sheathing Type: _____ Size: _____
7. Other Material: _____
Exterior Walls:
1. Studding Size _____ Spacing _____
2. No. windows _____
3. No. Doors _____
4. Header Sizes _____ Span(s) _____
5. Bracing Yes _____ No _____
6. Corner Posts Size _____
7. Insulation Type _____ Size _____
8. Sheathing Type _____ Size _____
9. Siding Type _____ Weather Exposure _____
10. Masonry Materials _____
11. Metal Materials _____
Interior Walls:
1. Studding Size _____ Spacing _____
2. Header Sizes _____ Span(s) _____
3. Wall Covering Type _____
4. Fire Wall if required _____
5. Other Materials _____

Ceiling:
1. Ceiling Joists Size: _____ Spacing _____
2. Ceiling Strapping Size _____
3. Type Ceiling: HISTORIC PRESERVATION
4. Insulation Type _____
5. Ceiling Height: _____
Roof:
1. Truss or Rafter Size _____ Does not require review
2. Sheathing Type _____ Requires review
3. Roof Covering Type _____
Chimneys:
Type: _____ Number of Fire Places: _____
Heating:
Type of Heat: _____
Electrical:
Date: 1/10/94
Service Entrance Size: _____
Plumbing:
1. Approval of soil test if required _____
2. No. of Tubs or Showers _____
3. No. of Flushes _____
4. No. of Lavatories _____
5. No. of Other Fixtures _____
Swimming Pools:
1. Type: _____
2. Pool Size: _____ Square Footage _____
3. _____ conform to National Electrical Code and State Law.
Permit Issued By Louise E. O'Brien
Signature of Applicant _____
James A. Thibodeau
CEO's District _____

PERMIT ISSUED WITH LETTER

CONTINUED TO REVERSE SIDE
Ivory Tag - CEO [Signature]

White - Tax Assessor



APPLICATION FOR PERMIT
 DEPARTMENT OF BUILDING INSPECTIONS SERVICES
 ELECTRICAL INSTALLATIONS

Date 8/10/93 19
 Receipt and Permit number 2614

To the CHIEF ELECTRICAL INSPECTOR, Portland, Maine:

The undersigned hereby applies for a permit to make electrical installations in accordance with the laws of Maine, the Portland Electrical Ordinance, the National Electrical Code and the following specifications:

LOCATION OF WORK: 191 Riverside St.
 OWNER'S NAME: Keenan Auction Co ADDRESS: _____

OUTLETS: 11 exit signs	11	FEEES	2.20
Receptacles <u>64</u> Switches <u>31</u> Plugmold _____ ft. TOTAL <u>95</u>			19.00
FIXTURES: (number of)			
Incandescent _____ Fluorescent <u>74</u> (not strip) TOTAL <u>74</u>			14.80
Strip Fluorescent <u>88</u> ft.			3.50
SERVICES:			
Overhead _____ Underground _____ Temporary _____ TOTAL amperes _____			
METERS: (number of) _____			
MOTORS: (number of)			
Fractional _____			
1 HP or over _____			
RESIDENTIAL HEATING:			
Oil or Gas (number of units) _____			
Electric (number of rooms) _____			
COMMERCIAL OR INDUSTRIAL HEATING:			
Oil or Gas (by a main boiler) _____			
Oil or Gas (by separate units) _____			
Electric Under 20 kws _____ Over 20 kws _____			
APPLIANCES: (number of)			
Ranges _____ Water Heaters _____			
Cook Tops _____ Disposals _____			
Wall Ovens _____ Dishwashers _____			
Dryers _____ Compactors _____			
Fans _____ Others (denote) _____			
TOTAL _____			
MISCELLANEOUS: (number of)			
Branch Panels _____			
Transformers _____			
Air Conditioners Central Unit <u>2</u> units _____			20.00
Separate Units (windows) _____			
Signs 20 sq. ft. and under _____			
Over 20 sq. ft. _____			
Swimming Pools Above Ground _____			
In Ground _____			
Fire/Burglar Alarms Residential _____			
Commercial <u>X</u> _____			15.00
Heavy Duty Outlets, 220 Vol: (such as welders) 30 amps and under _____			
over 30 amps _____			
Circus, Fairs, etc. _____			
Alterations to wires _____			
Repairs after fire _____			
Emergency Lights, battery <u>9</u> _____			9.00
Emergency Generators _____			
INSTALLATION FEE DUE: _____			
FOR ADDITIONAL WORK NOT ON ORIGINAL PERMIT DOUBLE FEE DUE: _____			
FOR REMOVAL OF A "STOP ORDER" (304-16.b) _____			
TOTAL AMOUNT DUE: <u>83.50</u>			

INSPECTION:
 Will be ready on _____, 19__; or Will Call X
 CONTRACTOR'S NAME: Seabee Elect
 ADDRESS: Anderson St- Ptd
 TEL: 774-4880
 MASTER LICENSE NO.: Wm Gagnon #3014 SIGNATURE OF CONTRACTOR: William Gagnon
 LIMITED LICENSE NO.: _____

INSPECTOR'S COPY — WHITE
 OFFICE COPY — CANARY
 CONTRACTOR'S COPY — GREEN

REVIEWED FOR
BARRIER - FREE
COMPLIANCE

STATE OF MAINE
DEPARTMENT OF PUBLIC SAFETY
OFFICE OF STATE FIRE MARSHAL
AUGUSTA
CONSTRUCTION PERMIT



Permit No. 6404

PERMISSION IS HEREBY GIVEN TO:
Keenan Auction Co
75 Pearl Street
Portland, ME 04101

Location of project:

191 Riverside St.
Portland, ME

PROJECT TITLE:

Keenan Auction Center

OCCUPANCY CLASSIFICATION:

Mercantile

To construct or alter the afore referenced building according to the plans hitherto filed with the Commissioner and now approved. No departure from such plans shall be made without prior approval in writing.

This permit will expire at midnight on October 4, 1994.

This permit is issued under the provisions of Title 25, Chapter 317, Section 2448

Nothing herein shall excuse the holder of this permit for the failure to comply with local ordinances, zoning laws, or other pertinent legal restrictions.

Dated the 5th day of April A.D. 1994

FEE \$ 100.00/25.00

NOT SPRINKLED

A handwritten signature in dark ink, appearing to read "John R. [unclear]".

Commissioner - Public Safety

MAIL PERMIT TO Michael O'Connell Children's Museum of Maine 746 Stevens Ave. Portland, 04103
Permit # _____ City of Portland BUILDING PERMIT APPLICATION Fee \$25.00 Zone _____ Map # _____ Lot# _____

Please fill out any part which applies to job. Proper plans must accompany form.

Owner: Lee Dodge Phone # 912608
Address: 191 Riverside St. Portland, Maine
LOCATION OF CONSTRUCTION 191 Riverside St.
Contractor: self Sub: _____
Address: _____ Phone # _____
Est. Construction Cost: \$500.00 Proposed Use: Childrens Museum
Past Use: Auto showroom
of Existing Res. Units _____ # of New Res. Units _____
Building Dimensions L _____ W _____ Total Sq. Ft. _____
of Stories: _____ # Bedrooms _____ Lot Size: _____
Is Proposed Use: Seasonal _____ Condominium _____ Conversion _____
Explain Conversion Change of Use as above with renovations as per plan

For Official Use Only
Date May 6, 1991 Subdivision: _____
Inside Fire Limits _____ Name: _____
Bldg Code _____ Lot: _____
Time Limit _____ Ownership: _____
Estimated Cost _____
PERMIT ISSUE
MAY 16 1991
CITY OF PORTLAND

Zoning: _____
Street Frontage Provided: _____
Provided Setbacks: Front _____ Back _____ Side _____ Side _____
Review Required:
Zoning Board Approval: Yes _____ No _____ Date: _____
Planning Board Approval: Yes _____ No _____ Date: _____
Conditional Use: _____ Variance: _____ Site Plan _____ Subdivision _____
Shoreland Zoning Yes _____ No _____ Floodplain Yes _____ No _____
Special Exemption _____
Other (Explain) OK W/CD - 205-15-91

Foundation:
1. Type of Soil: _____
2. Set Backs - Front _____ Rear _____ Side(s) _____
3. Footings Size: _____
4. Foundation Size: _____
5. Other _____

Ceiling:
1. Ceiling Joists Size: _____
2. Ceiling Strapping Size _____ Spacing _____
3. Type Ceilings: _____
4. Insulation Type _____ Size _____
5. Ceiling Height: _____
HISTORIC PRESERVATION
Not in District nor Landmark
Does not require review
Requires Review

Floor:
1. Sills Size: _____ Sills must be anchored.
2. Girder Size: _____
3. Lally Column Spacing: _____ Size: _____
4. Joists Size: _____ Spacing 16" O.C.
5. Bridging Type: _____ Size: _____
6. Floor Sheathing Type: _____ Size: _____
7. Other Material: _____

Roof:
1. Truss or Rafter Size _____
2. Sheathing Type _____ Span _____ Size _____ Action: Approved
3. Roof Covering Type _____
Chimneys:
Type: _____ Number of Fire Places _____ Date: 5/6/91
Signature: _____

Exterior Walls:
1. Studding Size _____ Spacing _____
2. No. windows _____
3. No. Doors _____
4. Header Sizes _____ Span(s) _____
5. Bracing: Yes _____ No _____
6. Corner Posts Size _____
7. Insulation Type _____ Size _____
8. Sheathing Type _____ Size _____
9. Siding Type _____ Weather Exposure _____
10. Masonry Materials _____
11. Metal Materials _____

Heating:
Type of Heat: _____
Electrical:
Service Entrance Size: _____ Smoke Detector Required Yes _____ No _____
Plumbing:
1. Approval of soil test if required _____
2. No. of Tubs or Showers _____
3. No. of Flushes _____
4. No. of Lavatories _____
5. No. of Other Fixtures _____

Interior Walls:
1. Studding Size _____ Spacing _____
2. Header Sizes _____ Span(s) _____
3. Wall Covering Type _____
4. Fire Wall if required _____
5. Other Materials _____

Swimming Pools:
1. Type: _____
2. Pool Size: _____ x _____ Square Footage _____
3. Must conform to National Electrical Code and State Law.

Permit Received By _____
Signature of Applicant _____ Date 5/6/91
Signature _____ Date 5/14/91
Inspection Dates _____

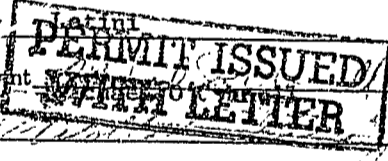



PLOT PLAN

Done w/out insp.

FEES (Breakdown From Front)

Base Fee \$ 25.00

Subdivision Fee \$ _____

Site Plan Review Fee \$ _____

Other Fees \$ _____

(Explain) _____

Late Fee \$ _____

Type	Inspection Record	Date
_____	_____	____/____/____
_____	_____	____/____/____
_____	_____	____/____/____
_____	_____	____/____/____
_____	_____	____/____/____

COMMENTS change of use with renovations

Signature of Applicant *Michael P. O'Connell* Date May 6, 1991



CITY OF PORTLAND, MAINE

389 CONGRESS STREET
PORTLAND, MAINE 04101
(207) 874-8300

DEPARTMENT OF PLANNING & URBAN DEVELOPMENT

P. SAMUEL HOFFSES, CHIEF
INSPECTION SERVICES DIVISION

May 16, 1991

RE: 191 Riverside Street

Lee Dodge
191 Riverside Street
Portland, Maine 04103

Dear Sir:

Your application to change the use from auto showroom to children's museum, has been reviewed and a permit is herewith issued subject to the following requirements:

1. Occupant load shall be limited to 150 maximum.
2. F.P.B. shall be provided with documentation of treatment of interior finish and treatment materials in accordance with Section 8-3.2.1.11 of N.F.P.A. 101 Life Safety Code.
3. Any lights or other potential heat sources used as a part of the display shall be secured in a safe manner to prevent tipping over or other contact with cloth, vegetation or other similar effects.

If you have any questions regarding these requirements, please do not hesitate to contact this office.

Sincerely,

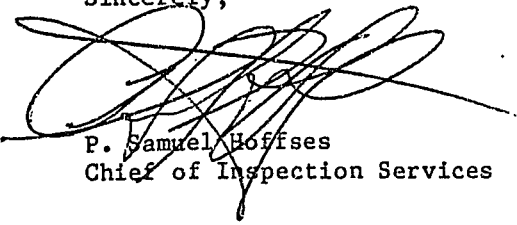
P. Samuel Hoffses
Chief of Inspection Services

/el

cc: LT. Wallace Garroway, Fire Prevention Bureau