

**SIMPSON ASSOCIATES**

ARCHITECT  
3280 Edgewood Park Dr.  
Commerce, Michigan 48382  
248-360-7821

David R. Gebhardt Architect  
205 W. Michigan Ave., Seline, MI 48176  
(734) 426-5130



**DUNHAM**  
Dunham Associates, Inc.  
80 South State Street / Suite 1100  
Marquette, Michigan 49855  
Phone: 616-465-3550 Fax: 616-465-3551  
www.dunhaminc.com  
mechanical & electrical consulting engineering



Construction Manager  
**Frank Baxter General Contractor, Inc.**  
3225 Avenue N  
Fort Madison, IA 52627  
319-372-7285

**PROJECT :**



EXECUTIVE OFFICE LAYOUT  
191 RIVERSIDE  
PORTLAND, MAINE

DATE:	ISSUED FOR:
11-12-07	90% REVIEW
11-16-07	PERMIT

**SHEET TITLE :**

**MISCELLANEOUS DETAILS**

SHEET NO. :

**A-05**

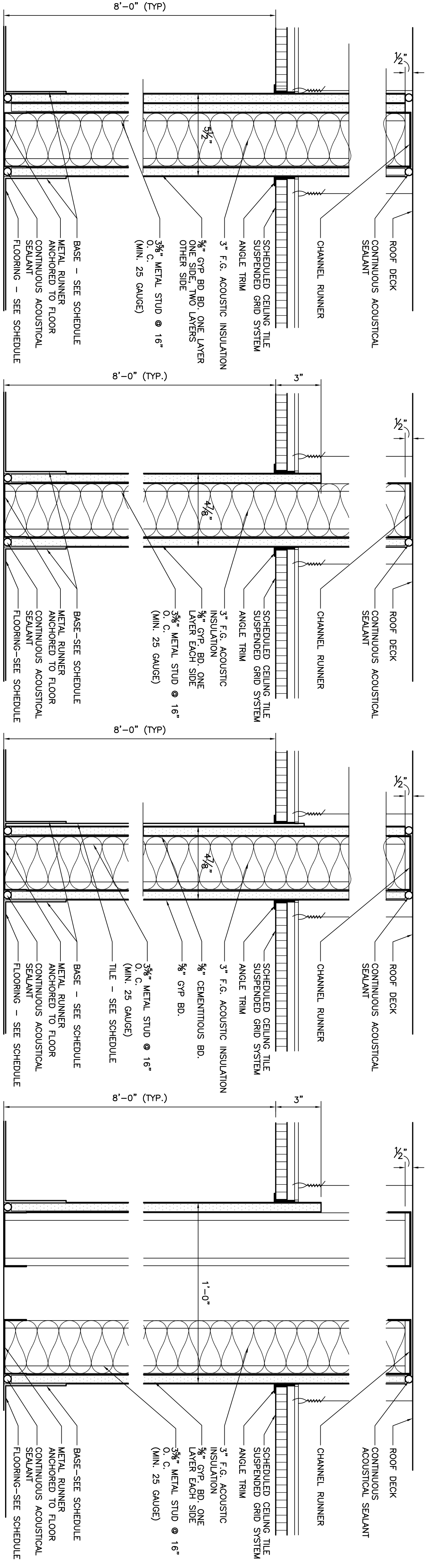

**WALL TYPES**

#1 - ONE (1) LAYER 3/8" GYP BD ONE SIDE, TWO (2) LAYERS 5/8" GYP BD OTHER SIDE TO EXTEND TO UNDERSIDE OF ROOF DECK. INSULATE WALL FULL HEIGHT WITH 3" ACOUSTIC BATT INSULATION

#2 - ONE (1) LAYER 3/8" GYP BD EACH SIDE OF 3/8" METAL STUDS, STUDS & GYP BD ON ONE SIDE TO EXTEND TO UNDERSIDE OF ROOF DECK. GYP BD ON OTHER SIDE TO EXTEND TO JUST ABOVE CEILING GRID. INSULATE WALL FULL HEIGHT WITH 3" ACOUSTIC BATT INSULATION

#3 - ONE (1) LAYER 3/8" GYP BD ONE SIDE, TILE ON ONE (1) LAYER 3/8" CEMENTITIOUS BD OTHER SIDE OF 3/8" METAL STUDS, STUDS & GYP BOARD TO EXTEND TO UNDERSIDE OF ROOF DECK. INSULATE WALL FULL HEIGHT WITH 3" ACOUSTIC BATT INSULATION

#4 - SAME AS #3 ABOVE, EXCEPT WITH CEMENTITIOUS BOARD & TILE ON BOTH SIDES OF METAL STUDS

#5 - SAME AS #4 ABOVE, EXCEPT WITH 6" METAL STUDS

#6 - DOUBLE 3/8" METAL STUDS TO UNDERSIDE OF ROOF DECK/ONE. (1) LAYER 5/8" GYP BD ON ONE SIDE OF EACH 3/8" METAL STUDS WALL. GYP BD ON ONE SIDE TO EXTEND TO UNDERSIDE OF ROOF DECK. GYP BD ON OTHER SIDE TO EXTEND TO JUST ABOVE CEILING GRID. INSULATE WALL FULL HEIGHT WITH 3" ACOUSTIC BATT INSULATION

#7 - SAME AS #6 ABOVE, EXCEPT WITH 5/8" CEMENTITIOUS WALL BOARD & TILE, BOTH SIDES

