

**KEY PLAN**

**CWS Architects**  
 Architecture  
 Space Planning  
 Value Design

434 Cumberland Avenue  
 Portland, ME 04101  
 Phone: (207)774-4441  
 Fax: (207)774-4016  
[www.CWSarch.com](http://www.CWSarch.com)

Owner:

Client:

**MAINE MALL MOTORS**  
 256 MAINE MALL ROAD  
 SOUTH PORTLAND, MAINE 04066  
 (207) 774 4774

**MAINE MALL MOTORS  
 TOYOTA / LEXUS**  
 EXIT 8  
 RIVERSIDE STREET  
 PORTLAND, MAINE

Project No: 03409 M/LT

Drawing Title:

**REVISION TO  
 DWG A1.1A  
 Door & Door Tags**

- Scale: 1/8" = 1'-0"
- Date: JUNE 30, 2004
- Revisions:
- 1. Addendum 04 (3/30/04) to Phong SH
  - 2. Addendum 05 (3/17/04) to Phong SH
  - 3. Addendum 08 (4/01/04) to Phong SH
  - 4. Addendum 09 (4/26/04) Issued For Construction

Drawing Number:

**SK-19**

ISSUED FOR CONSTRUCTION

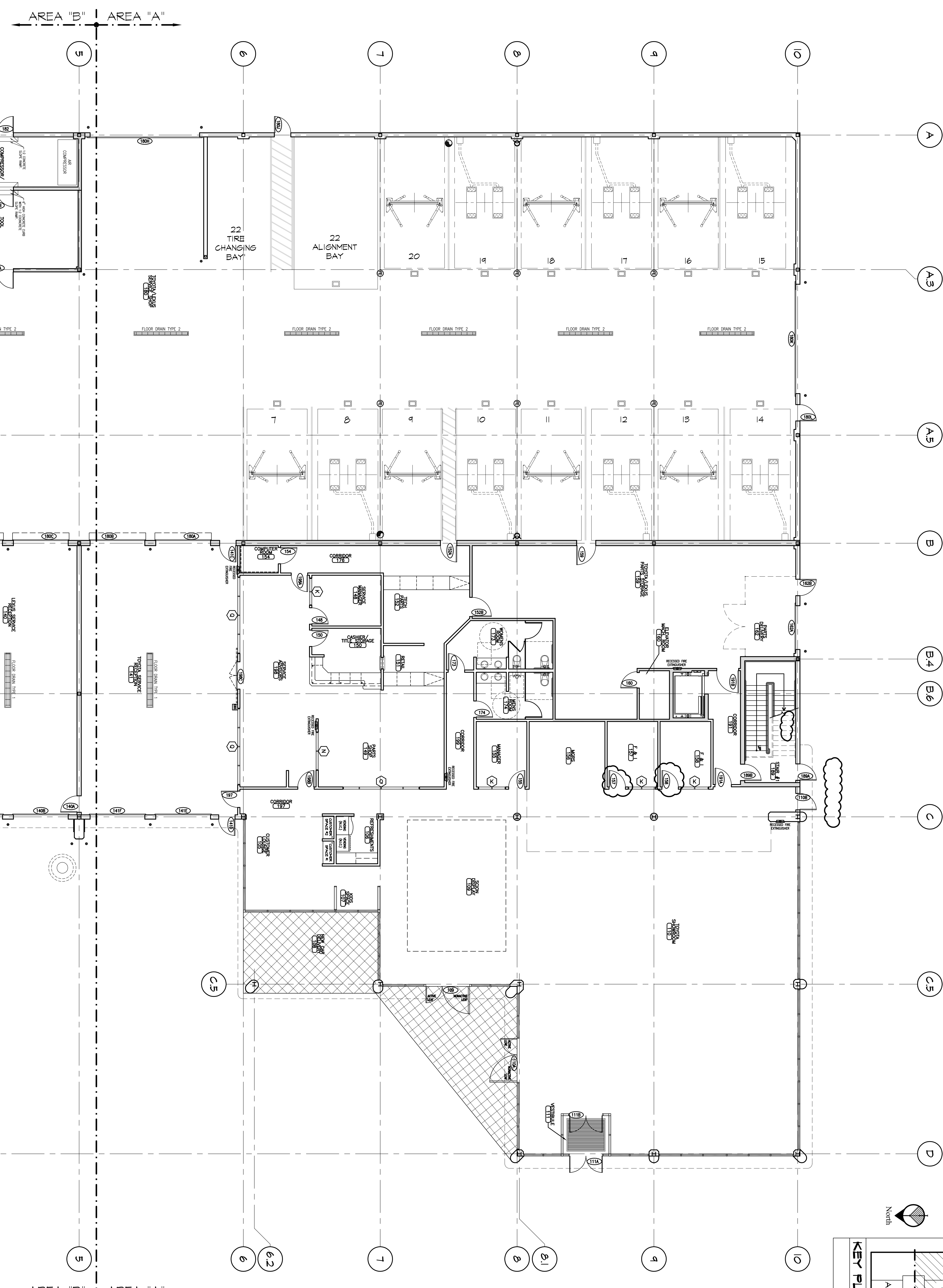

**A** REMEMBERED FROM: SCALE: 1/8" = 1'-0"