

DISPLAY THIS CARD ON PRINCIPAL FRONTAGE OF WORK

CITY OF PORTLAND

Please Read Application And Notes, If Any, Attached

BUILDING INSPECTION

PERMIT

PERMIT ISSUED
Permit Number: 051040
OCT 3 2004
CITY OF PORTLAND

This is to certify that K & R Properties Inc /Sign Design Inc

has permission to Install a 48 sf sign

AT 200 Riverside St

267 A015001

provided that the person or persons, firm or corporation accepting this permit shall comply with all of the provisions of the Statutes of Maine and of the ordinances of the City of Portland regulating the construction, maintenance and use of buildings and structures, and of the application on file in this department.

Apply to Public Works for street line and grade if nature of work requires such information.

Notification of inspection must be given and written permission procured before this building or part thereof is altered or closed-in. HEAVY NOTICE IS REQUIRED.

A certificate of occupancy must be procured by owner before this building or part thereof is occupied.

OTHER REQUIRED APPROVALS

Fire Dept
Health Dept
Appeal Board
Other
Department Name

Handwritten signature and date 9/23/05
Director - Building & Inspection Services

PENALTY FOR REMOVING THIS CARD

City of Portland, Maine - Building or Use Permit Application

389 Congress Street, 04101 Tel: (207) 874-8703, Fax: (207) 874-8716

Permit No: 05-1040	Issue Date: PERMIT ISSUED OCT 2004	City: 0415001
-----------------------	---	------------------

Location of Construction: 200 Riverside St	Owner Name: K & R Properties Inc	Owner Address: 800 Bush River Rd Ste B	Phone: 207 874 6600
Business Name:	Contractor Name: Sign Design Inc	Contractor Address: PO Box 207 Westbrook	Phone: 207 874 6600
Lessee/Buyer's Name	Phone:	Permit Type: Signs - Permanent	Zone: B-4

Past Use: Commercial	Proposed Use: Commercial Install a 48 sf sign	Permit Fee: \$126.00	Cost of Work: \$126.00	CEO District: 3
--------------------------------	---	--------------------------------	----------------------------------	---------------------------

FIRE DEPT: <input type="checkbox"/> Approved <input type="checkbox"/> Denied <i>N/A</i>	INSPECTION: Use Group: U Type: Sign IBC 2003
---	---

Proposed Project Description: Install a 48 sf sign - Removing Existing Sign over front entry per sign Co. 9/21/05	Signature: <i>[Signature]</i>	Signature: <i>[Signature]</i>
---	---	---

Permit Taken By: dmartin	Date Applied For: 08/01/2005	Zoning Approval
------------------------------------	--	------------------------

<ol style="list-style-type: none"> This permit application does not preclude the Applicant(s) from meeting applicable State and Federal Rules. Building permits do not include plumbing, septic or electrical work. Building permits are void if work is not started within six (6) months of the date of issuance. False information may invalidate a building permit and stop all work.. 	Special Zone or Reviews <input type="checkbox"/> Shoreland <input type="checkbox"/> Wetland <input type="checkbox"/> Flood Zone <input type="checkbox"/> Subdivision <input type="checkbox"/> Site Plan Maj <input type="checkbox"/> Minor <input type="checkbox"/> MM <input type="checkbox"/> <i>ok with conditions</i> Date: <i>9/21/05</i>	Zoning Appeal <input type="checkbox"/> Variance <input type="checkbox"/> Miscellaneous <input type="checkbox"/> Conditional Use <input type="checkbox"/> Interpretation <input type="checkbox"/> Approved <input type="checkbox"/> Denied	Historic Preservation <input checked="" type="checkbox"/> Not in District or Landmark <input type="checkbox"/> Does Not Require Review <input type="checkbox"/> Requires Review <input type="checkbox"/> Approved <input type="checkbox"/> Approved w/Conditions Denied Date: <i>[Signature]</i>
---	---	--	--

CERTIFICATION

I hereby certify that I am the owner of record of the named property, or that the proposed work is authorized by the owner of record and that I have been authorized by the owner to make this application as his authorized agent and I agree to conform to all applicable laws of this jurisdiction. In addition, if a permit for work described in the application is issued, I certify that the code official's authorized representative shall have the authority to enter all areas covered by such permit at any reasonable hour to enforce the provision of the code(s) applicable to such permit.

SIGNATURE OF APPLICANT ADDRESS DATE PHONE

RESPONSIBLE PERSON IN CHARGE OF WORK, TITLE DATE PHONE

City of Portland, Maine - Building or Use Permit

389 Congress Street, 04101 Tel: (207) 874-8703, Fax: (207) 874-8716

Permit No: 05-1040	Date Applied For: 07/25/2005	CBL: 267 A015001
--------------------	------------------------------	------------------

Location of Construction: 200 Riverside St K & R Properties Inc Owner Name: 800 Bush River Rd Ste B Owner Address: Phone:		Business Name: Sign Design Inc Contractor Name: PO Box 207 Westbrook Contractor Address: Phone (207) 856-2600		Lessee/Buyer's Name Phone:	
Proposed Use: Commercial Install a 48 sf sign - to remove existing sign over front entry Proposed Project Description: Install a 48 sf sign					

Dept: Zoning **Status:** Approved with Conditions **Reviewer:** Marge Schmuckal **Approval Date:** 09/21/2005 **Note:** 8/9/05 I need to go by & take a look - nothing on plans showing where the new sign is to be placed - platinum **OK to Issue:**

plus
 9/2/05 Doug from Sign Design said they could remove the existing sign over the front entryway - will check with the owners
 9/21/05 Doug from Sign Design confirmed that the "Donut Shop" sign over the front entry will be removed with the placement of this new sign

1) This permit is being approved on the basis of plans submitted. Any deviations shall require a separate approval before starting that work.
 2) It is understood that the existing "Donut Shop" over the front entry way will be removed to allow the installation of this sign.

Dept: Building **Status:** Approved with Conditions **Reviewer:** Tammy Munson **Approval Date:** 09/23/2005 **Note:** **OK to Issue:**

1) Signage Installation to comply with Chapter 31 of the IBC 2003 building code.



Sign Contractors

P.O. Box 207
Washbrook, ME 04098
(207) 856-2600 • FAX: (207) 856-7600
1-800-949-9037
signdesi@maine.com
A Full Service Sign Company

RE:

To Whom It May Concern:

As the owner (or owner representative) of the property located at:

100 Lauriston St
Bethel ME
04918

I authorize Sign Design Inc. to install signs/sign face replacements as detailed on attached paperwork.

Signature

Print Name
William L. Ellis

Date
6/28/05

Table 2.10

Commercial Corridor (B-4) Zone - Single Tenant Lots



Freestanding Signs	Facing street frontage < 200'	Facing street frontage ≥ 200'
Height	25 ft.	35 ft.
Setback	5 ft.	same
# permitted per lot	1 (a)	same

(a) If lot fronts on more than one street, one freestanding sign is permitted for each additional frontage, provided such signs are not readily concurrently visible.

Building Signs

	Bldg. face < 150 linear feet
Maximum cumulative area of all building signs	na
Sq. ft. per linear ft. of bldg. facade on which sign will be placed - or -	2 sq. ft. - or -
Maximum % of wall area on which sign(s) is(are) to be placed	6%
# bldg. signs permitted per lot	1 per bldg. facade facing an abutting street and 1 additional

G = Minimum 4 sq. ft. +/-

F Planning 36 sq. ft. +/-

E existing Fls sign 112 sq. ft. +/-

D = 105' +/- = Bid Depth

C = 81' +/- = Bid Frontage

B = 900' +/- = Lot Depth

A: 300' +/- = Road Easement

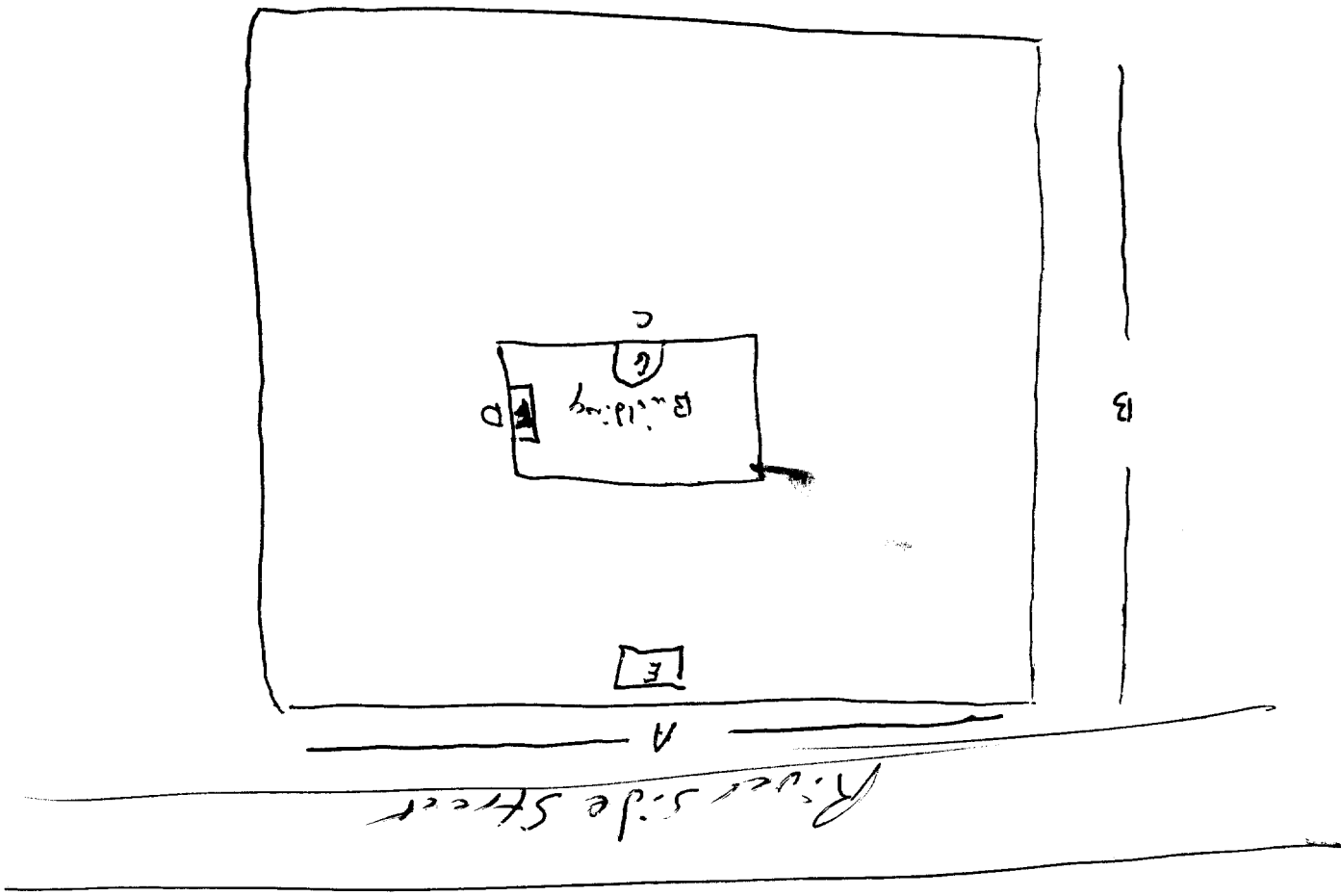

Platinum Plus
300 River Side Street

This Design Is The Property Of:

Sign Design Inc.

306 Warren Ave. Portland, ME
Phone: 207-856-2600 Fax: 207-856-7600

28" Tall Primary W/ 18" Tall Secondary Neon Channel Letters

PLATINUM PLUS

Line Length Approx. 267"

Overall Length Approx. 278"

Customer: Platinum Plus
Job Name: platinum2 comp. 1
Date: 7-22-05
Approval:

Signage/Awning Permit Application

If you or the property owner owes real estate or personal property taxes or user charges on any property within the City, payment arrangements must be made before permits of any kind are accepted.

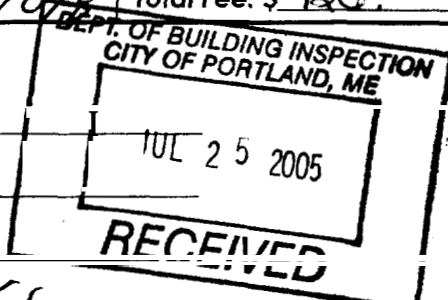
Location/Address of Construction: <u>200 Riverside Street</u>		
Total Square Footage of Proposed Structure <u>48 sq. ft.</u>	Square Footage of Lot <u>2704</u>	
Tax Assessor's Chart, Block & Lot Chart# <u>267</u> Block# <u>A</u> Lot# <u>015</u>	Owner:	Telephone:
Lessee/Buyer's Name (if Applicable) <u>Platinum Plus 200 Riverside St. Portland ME 04101</u>	Applicant name, address & telephone: <u>Syn Design Inc. 170 Box 207 Westbrook ME 04090</u>	Total s.f. of signage x \$2.00 per s.f. plus \$30.00/\$65.00 for H.D. signage = Total Fee: \$ <u>96</u> Awning Fee = Cost Of Work: \$ <u>30</u> Total Fee: \$ <u>126.00</u>
Current use: <u>SPACE night club</u>		
If the location is currently vacant, what was prior use: <u>N/A</u>		
Approximately how long has it been vacant: <u>N/A</u>		
Proposed use:		
Project description: <u>new additional signs</u>		
Contractor's name, address & telephones: <u>Syn Design Inc.</u>		
Whom should we contact when the permit is ready: <u>Doug 856-2600</u>		
Mailing address:		
We will contact you by phone when the permit is ready. You must come in and pick up the permit and review the requirements before starting any work, with a Plan Reviewer. A STOP WORK ORDER will be issued and a \$100.00 fee if any work starts before the permit is picked up. PHONE: <u>856-2600</u>		

IF THE REQUIRED INFORMATION IS NOT INCLUDED IN THE SUBMISSIONS THE PERMIT WILL BE AUTOMATICALLY DENIED AT THE DISCRETION OF THE BUILDING/PLANNING DEPARTMENT. WE MAY REQUIRE ADDITIONAL INFORMATION IN ORDER TO APPROVE THIS PERMIT.

I hereby certify that I am the Owner of record of the named property, or that the owner of record authorizes the proposed work and that I have been authorized by the owner to make this application as his/her authorized agent. I agree to conform to all applicable laws of this jurisdiction. In addition, if a permit for work described in this application is issued, I certify that the Code Official's authorized representatives shall have the authority to enter all areas covered by this permit at any reasonable hour to enforce the provisions of the codes applicable to this permit.

Signature of applicant:  Date: 7/25/05

This is NOT a permit, you may not commence ANY work until the permit is issued.

1116

CERTIFICATE OF INSURANCE

ISSUE DATE (MM/DD/YY)

07/19/05

PRODUCER

M EKIMBRELL COMPANY
1300 INDIAN WELLS COURT
MURRELL'S INLET, SC 29576

THIS CERTIFICATE IS ISSUED AS A MATTER OF INFORMATION ONLY AND CONFERS NO RIGHTS UPON THE CERTIFICATE HOLDER. THIS CERTIFICATE DOES NOT AMEND, EXTEND OR ALTER THE COVERAGE AFFORDED BY THE POLICIES BELOW.

COMPANIES AFFORDING COVERAGE

COMPANY LETTER	A	ASPEN SPECIALTY
COMPANY LETTER	B	
COMPANY LETTER	C	
COMPANY LETTER	D	
COMPANY LETTER	E	

INSURED

KENWOOD ENTERPRISES
DBA KEN-KEV, INC
800 BUSH RIVER ROAD
COLUMBIA, SC 29210

COVERAGES

THIS IS TO CERTIFY THAT THE POLICIES OF INSURANCE LISTED BELOW HAVE BEEN ISSUED TO THE INSURED NAMED ABOVE FOR THE POLICY PERIOD INDICATED, NOTWITHSTANDING ANY REQUIREMENT, TERM OR CONDITION OF ANY CONTRACT OR OTHER DOCUMENT WITH RESPECT TO WHICH THIS CERTIFICATE MAY BE ISSUED OR MAY PERTAIN. THE INSURANCE AFFORDED BY THE POLICIES DESCRIBED HEREIN IS SUBJECT TO ALL THE TERMS, EXCLUSIONS AND CONDITIONS OF SUCH POLICIES.

CO LTR	TYPE OF INSURANCE	POLICY NUMBER	POLICY EFFECTIVE DATE (MM/DD/YY)	POLICY EXPIRATION DATE (MM/DD/YY)	LIMITS OF INSURANCE	
A	GENERAL LIABILITY <input checked="" type="checkbox"/> COMMERCIAL GENERAL LIABILITY <input type="checkbox"/> CLAIMS MADE <input checked="" type="checkbox"/> OCCURRENCE <input type="checkbox"/> OWNER'S & CONTRACTORS PROTECTIVE	KL002034	06/16/05	06/15/06	GENERAL AGGREGATE	\$ 2,000.0
	PRODUCTS-COMP/OPS AGGREGATE				\$ 1,000.0	
					PERSONAL & ADVERTISING INJURY	\$ 1,000.0
					EACH OCCURRENCE	\$ 1,000.0
					FIRE DAMAGE (ANY ONE FIRE)	\$ 50.0
					MEDICAL EXPENSE (ANY ONE PERSON)	\$ EXCLUD
	AUTOMOBILE LIABILITY <input type="checkbox"/> ANY AUTO <input type="checkbox"/> ALL OWNED AUTOS <input type="checkbox"/> SCHEDULED AUTOS <input type="checkbox"/> HIRED AUTOS <input type="checkbox"/> NON-OWNED AUTOS <input type="checkbox"/> GARAGE LIABILITY				CSL	\$
					BODILY INJURY (PER PERSON)	\$
					BODILY INJURY (PER ACCIDENT)	\$
					PROPERTY DAMAGE	\$
	EXCESS LIABILITY <input type="checkbox"/> OTHER THAN UMBRELLA FORM				EACH OCCURRENCE	\$
					AGGREGATE	\$
	WORKER'S COMPENSATION AND EMPLOYER'S LIABILITY				STATUTORY	
					\$	(EACH ACCIDENT)
					\$	(DISEASE-POLICY LIMIT)
					\$	(DISEASE-EACH EMPLOYER)
A	OTHER LIQUOR LIABILITY	KL002034	05/16/05	06/16/06	\$1,000,000 LIQUOR LIABILITY AGG \$1,000,000 LIQUOR LIABILITY EACH COMMON CAUSE	

DESCRIPTION OF OPERATIONS/ LOCATIONS/ VEHICLES/ RESTRICTIONS/ SPECIAL ITEMS

LOCATION
PLATINUM PLUS
200 RIVERSIDE STREET
PORTLAND MAINE

CERTIFICATE OF HOLDER

CITY OF PORTLAND
CITY HALL, 3RD FLOOR
CONGRESS STREET
PORTLAND, MAINE 04101

CANCELLATION

SHOULD ANY OF THE ABOVE DESCRIBED POLICIES BE CANCELLED BEFORE THE EXPIRATION DATE THEREOF, THE ISSUING COMPANY WILL ENDEAVOR TO MAIL 10 DAYS WRITTEN NOTICE TO THE CERTIFICATE HOLDER NAMED TO THE LEFT, BUT FAILURE TO MAIL SUCH NOTICE SHALL IMPOSE NO OBLIGATION OF LIABILITY OF ANY KIND UPON THE COMPANY, ITS AGENTS OR REPRESENTATIVES.

AUTHORIZED REPRESENTATIVE

John K. Coates

DLM