

Permit # **940501** City of Portland BUILDING PERMIT APPLICATION Fee \$35 Zone _____ Map # _____ Lot # _____
 Please fill out any part which applies to job. Proper plans must accompany form.

Owner: V I P Discount AUTO CTR Phone # 728-4711
 Address: 35 Riverside Ave - Pld, ME 04103
 LOCATION OF CONSTRUCTION 35 Riverside Ave
 Contractor: u/k Sub: _____
 Address: _____ Phone # _____
 Est. Construction Cost: 1600 Proposed Use: retail auto/parts
 Past Use: w shed
 # of Existing Res. Units _____ # of New Res. Units _____
 Building Dimensions L _____ W _____ Total Sq. Ft. _____
 # Stories _____ # Bedrooms _____ Lot Size: _____
 Is Proposed Use: Seasonal _____ Condominium _____ Conversion _____
 Explain Conversion construct shed - 12'x16' (for storage)

For Official Use Only
 Date: 5/10/94 Subdivision: _____
 Inside Fire Limits _____ Name: _____
 Bldg Code _____ Lot: _____
 Time Limit _____ Ownership: _____
 Estimated Cost: 1600 Public _____
 CITY OF PORTLAND
 Zoning: Street Frontage Provided: _____
 Provided Setbacks: Front _____ Back _____ Side _____
 Review Required: _____
 Zoning Board Approval: Yes _____ No _____ Date: _____
 Planning Board Approval: Yes _____ No _____ Date: _____
 Conditional Use _____ Variance _____ Site Plan _____ Subdivision _____
 Shoreland Zone _____ No _____ Floodplain: Yes _____ No _____
 Special Exempt _____
 Other (Explain) 25-23-94

Foundations:
 1. Type of Soil: _____
 2. Set Backs - Front _____ Rear _____ Side(s) _____
 3. Footings Size: _____
 4. Foundation Size: _____
 5. Other _____

Floor:
 1. Sills Size: _____ Sills must be anchored.
 2. Girder Size: _____
 3. Lally Column Spacing: _____ Size: _____
 4. Joists Size: _____ Spacing 16" O.C.
 5. Bridging Type: _____ Size: _____
 6. Floor Sheathing Type: _____ Size: _____
 7. Other Material: _____

Exterior Walls:
 1. Studding Size _____ Spacing _____
 2. No. windows _____
 3. No. Doors _____
 4. Header Sizes _____ Spar(s) _____
 5. Bracing: Yes _____ No _____
 6. Corner Posts Size _____
 7. Insulation Type _____ Size _____
 8. Sheathing Type _____ Size _____
 9. Siding Type _____ Weather Exposure _____
 10. Masonry Materials _____
 11. Metal Materials _____

Interior Walls:
 1. Studding Size _____ Spacing _____
 2. Header Sizes _____ Spar(s) _____
 3. Wall Covering Type _____
 4. Fire Wall if required _____
 5. Other Materials _____

Celling:
 1. Ceiling Joists Size: _____
 2. Ceiling Scaffolding Size _____ Spacing _____
 3. Type Ceil. g.: _____
 4. Insulation Type _____
 5. Cell _____

Roof:
 1. T: _____ Spacing: _____
 2. S: _____ Size: _____
 3. R: _____

Chimneys:
 Type: _____ Number of Fire Places _____

Heating:
 Type of Heat: _____

Electrical:
 Service Entrance Size: _____ Smoke Detector Required Yes _____ No _____

Plumbing:
 1. Approval of soil test if required Yes _____ No _____
 2. No. of Toilets or Showers _____
 3. No. of Fixtures _____
 4. No. of Lavatories U.S. Group U Type 5B
 5. No. of C.J. Fixtures _____

Swimming Pool: _____

Permit Issued By Quise Date 5-10-94
 Signature of Applicant _____
 CEO's District _____
 CONTINUED TO REVERSE SIDE
 Ivory Tag - CEO MR. Carroll

White - Tax Assessor

PLOT PLAN

N

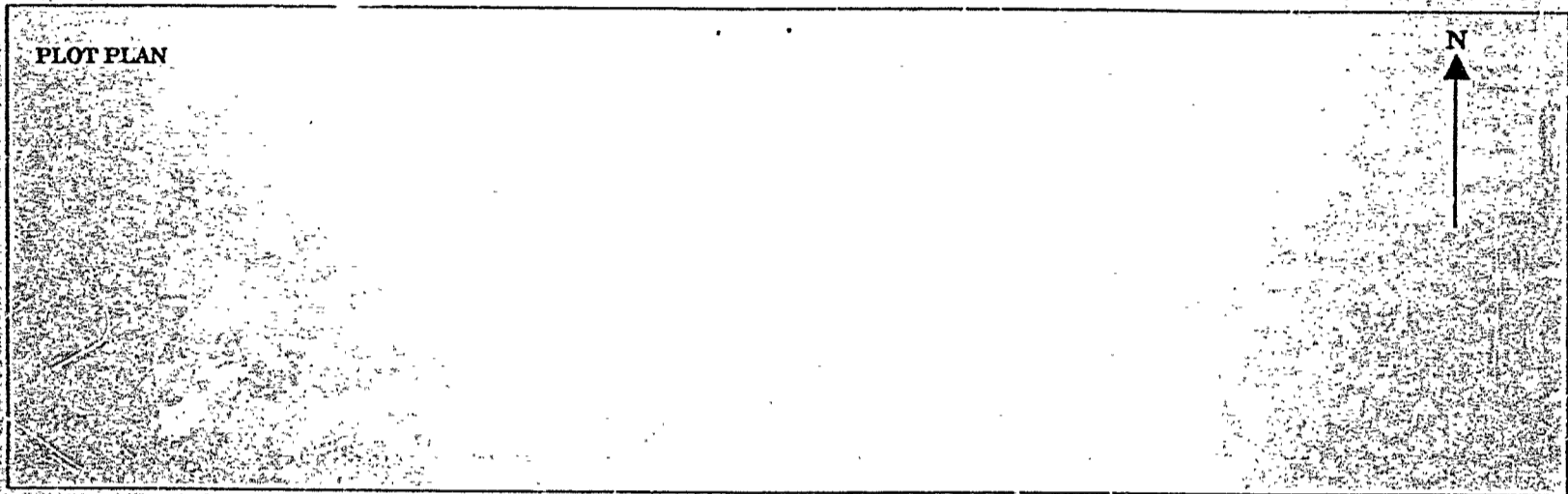
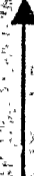

FEES (Breakdown From Front)

Base Fee \$ 30
Subdivision Fee \$ _____
Site Plan Review Fee \$ _____
Other Fees \$ _____
(Explain) _____
Late Fee \$ _____

Type	Inspection Record	Date
_____	_____	____/____/____
_____	_____	____/____/____
_____	_____	____/____/____
_____	_____	____/____/____

COMMENTS

asked to see plan

CERTIFICATION

I hereby certify that I am the owner of record of the named property, or that the proposed work is authorized by the owner of record and that I have been authorized by the owner to make this application as has authorized agent and I agree to conform to all applicable laws of this jurisdiction. In addition, if a permit described in this application is issued, I certify that the code official or the code official's authorized representative shall have the authority to enter areas covered by such permit at any reasonable hour to enforce the provisions of the code(s) applicable to such permit.

B. J. Bonds

SIGNATURE OF APPLICANT

ADDRESS

PHONE NO.

RESPONSIBLE PERSON IN CHARGE OF WORK, TITLE

PHONE NO.

Inspection Services
Samuel P. Hoffses
Chief



Planning and Urban Development
Joseph E. Gray Jr.
Director

CITY OF PORTLAND

June 1, 1994

VIP Discount Auto Ctr.
35 Riverside Street
Portland, Maine 04103

RE: 35 Riverside St.
Portland, Maine

Dear Sir,

Your application to construct a 12'x 16' shed (for storage) has been reviewed a permit is herewith issued subject to the following requirements: This permit doesn't preclude the applicant from meeting applicable State and Federal laws.

1. Your fire alarm system shall be extended to the proposed shed.
2. The proposed shed shall meet all required setbacks.

If you have any questions, please give this office a call.

Sincerely,

P. Samuel Hoffses
Chief of Inspection Services

cc: Lt. MacDougall - Fire Prevention Bureau

VIP DISCOUNT AUTO CENTER

12 Lexington Street
Lewiston, Maine 04240
(207) 784-5423

135 RIVERSIDE ST.
PORTLAND, ME.
-04103

DATE 5/16/94 URGENT
 SOON AS POSSIBLE
 NO REPLY NEEDED

FILE NO. _____

ATTENTION _____

SUBJECT 15' x 16' out building
behind VIP Riverside St.
for old tires & exhaust.

TO City of Portland Bldg.
Inspector

MESSAGE

FLOOR: 2x10 DECKING - PRESSURE TREATED w/ 3/4 CD UNDERLAY JOISTS: 2x4
24" ON CTR. - 3/4 TEXT. 1x1. ROOF: 5' 12" PITCH, PRE-FAB TRUSSES 12'
w/ 1' OVERHANG, 2' ON CTR. DOOR: 36" STEEL BRDX. COST OF MATERIALS
\$1,600. CONTENTS OLD TIRES & MUFFERS & SIGNED BOB MORROWELL GEN. MGR.

REPLY

(PICKED UP 5 TIMES PER WEEK!) ^{PHONES} 858-4711
DATE OF REPLY _____

SIGNED _____

City of Portland, Maine - Building or Use Permit Application 38th Congress Street, 04101, Tel: (207) 874-8703, FAX: 874-8716

Location of Construction: 35 Riverside St		Owner: VLT Auto Center	Phone:	Permit No: 950108
Owner Address:	Leasee/Buyer's Name:	Phone:	Business Name:	PERMIT ISSUED FEB - 7 1995 CITY OF PORTLAND
Contractor Name: Balley Sign, Inc.	Address: 9 Thomas Drive Westbrook, ME 04092	Phone:		
Past Use: Comm/Retail	Proposed Use: Sign w/sign	COST OF WORK: \$	PERMIT FEE: \$ 27.40	Zoning: 4 CBL: 266-A-004
		FIRE DEPT. <input type="checkbox"/> Approved <input type="checkbox"/> Denied	INSPECTION: "u" Use Group: Type: BOCA 93	
Proposed Project Description: Erect Sign as per plans 3 x 4 = 12 sq ft		Signature: _____		Zoning Approval: 2/3/95 Comments: THAT THE VENDOR AND LOCAL SIGN AREA TO BE SPECIAL ZONE OF REVIEWS: AND INCIDENTAL
		PEDESTRIAN ACTIVITIES DISTRICT (P.A.D.) Action: <input type="checkbox"/> Approved <input type="checkbox"/> Approved with Conditions <input type="checkbox"/> Denied		
Permit Taken By: Mary Gresik	Date Applied For: 30 Jan 95			Zoning Appeal <input type="checkbox"/> Variance <input type="checkbox"/> Miscellaneous <input type="checkbox"/> Conditional Use <input type="checkbox"/> Interpretation <input type="checkbox"/> Approved <input type="checkbox"/> Denied <input checked="" type="checkbox"/> Historic Preservation <input type="checkbox"/> Not in District or Landmark <input type="checkbox"/> Does Not Require Review <input type="checkbox"/> Requires Review

1. This permit application doesn't preclude the Applicant(s) from meeting applicable State and Federal rules.
2. Building permits do not include plumbing, septic or electrical work.
3. Building permits are void if work is not started within six (6) months of the date of issuance. False information may invalidate a building permit and stop all work..

PERMIT ISSUED WITH LETTER

CERTIFICATION

I hereby certify that I am the owner of record of the named property, or that the proposed work is authorized by the owner of record and that I have been authorized by the owner to make this application as his authorized agent and I agree to conform to all applicable laws of this jurisdiction. In addition, if a permit for work described in the application issued, I certify that the code official's authorized representative shall have the authority to enter all areas covered by such permit at any reasonable hour to enforce the provisions of the code(s) applicable to such permit

SIGNATURE OF APPLICANT: Rodney Benn ADDRESS: _____ DATE: **30 Jan 95** PHONE: **774-2145**

RESPONSIBLE PERSON IN CHARGE OF WORK, TITLE: _____ PHONE: _____
 White-Permit Desk Green-Assessor's Canary-D.P.W. Pink-Public File Ivory Card-Inspector

CEO DISTRICT **4**
 MR. CARROLL

Action:
 Approved
 Approved with Conditions
 Denied
 Date: **1/31/95**

Inspection Services
P. Samuel Hoffses
Chief



Planning and Urban Development
Joseph E. Gray Jr.
Director

CITY OF PORTLAND

February 3, 1995

RE: 35 Riverside Street (VIP Auto Center)

Bailey Sign Inc.
9 Thomas Drive
Westbrook, ME 04092

Dear Sir:

Your application to erect sign (3 X 4) 12 sq. ft. has been reviewed and a permit is herewith issued subject to the following requirement. This permit does not preclude the applicant from meeting applicable State and Federal laws.

The VIP name and logo lettering must be smaller than the "entrance" lettering so that this sign may qualify for an incidental directional sign.

If you have any questions regarding this requirement, please do not hesitate to contact this office.

Sincerely,

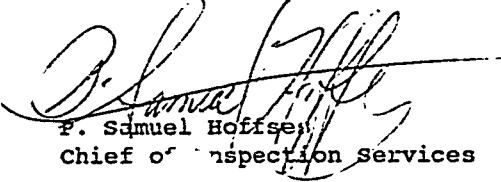
P. Samuel Hoffses
Chief of Inspection Services

/el

cc: M. Schmuckal, Asst. Chief of Inspection Services

SIGNAGE APPLICATION

ADDRESS: _____

Zone B-4

OWNER: _____

APPLICANT: _____

ASSESSORS NO.: _____

SINGLE TENANT LOT? YES: _____ NO: _____

MULTI-TENANT LOT? YES: _____ NO: _____

FREESTANDING SIGN? YES: NO: _____

to be an incidental directional sign

DIMENSIONS: ↓

MORE THAN ONE SIGN? *(major one is existing)*

DIMENSIONS: 1' x 3' = 12"

BLDG. WALL SIGN? YES: _____ NO: _____

DIMENSIONS: _____

MORE THAN ONE SIGN?

DIMENSIONS: _____

LIST ALL EXISTING SIGNAGE, INCLUDING THEIR DIMENSIONS:

Condition: - The VIP Name and logo must be smaller than the "entrance" lettering

LOT FRONTAGE (IN FEET): _____

BLDG FRONTAGE (IN FEET): _____

AWNING? YES: _____ NO: _____ IS AWNING BACKLIT? YES: _____ NO: _____

HEIGHT OF AWNING: _____

IS THERE ANY COMM. MESSAGE, TRADEMARK, OR SYMBOL ON IT? _____

PLEASE PROVIDE A SITE SKETCH AND A BUILDING SKETCH, SHOWING EXACTLY WHERE EXISTING AND NEW SIGNAGE IS LOCATED.

WE WILL NEED SKETCHES AND/OR PICTURES OF THE PROPOSED SIGNS INCLUDING STRUCTURAL COMPONENTS.

incidental signs (directional)

No sign with commercial message legible from a position off the lot on which the sign is located shall be considered incidental

A: SIGNLIST

ART NORMAL 1

CAMERA READY ART
ON FILE REQUIRED
RECEIVED DATE _____

PLEASE NOTE
THIS IS A PROGRESS PRINT - FIELD MEASUREMENTS
MAY OR MAY NOT NEED TO BE VERIFIED.
THIS DESIGN IS THE EXCLUSIVE PROPERTY OF BAILEY
SIGN CORPORATION AND ALL RIGHTS TO ITS USE OR
REPRODUCTION ARE RESERVED.
COLORS SHOWN HERE ARE FOR DISTRIBUTION ONLY
COLOR MATCH NUMBERS WILL BE NEEDED.
IF AN ELECTRIC SIGN, THEN INSTALLATION MUST BE
ACCOMPLISHED IN TOTAL COMPLIANCE WITH THE
NATIONAL ELECTRICAL CODE, THE REQUIREMENTS OF
LOCAL PERMITS/AGENCY/CITY/CANADIAN STANDARDS
ASSOCIATION AND APPLICABLE LOCAL CODES.

Bailey Sign
11 Small Pine Lane
Portland, ME 04107
207 774 2411 / 800 538 5444
© COPYRIGHT

CUSTOMER
VIP
LOCATION
EXIT 8
PORTLAND, ME
SALESPERSON: R. BENN

DRAWN BY: L.W. MERRIFIELD

ACCEPTANCE SIGNATURE _____ DATE _____
BAILEY SIGN

PS # D-621 WO #
SCALE 1" = 1' DATE 12/27/94

REVISION: _____

DRAWING NO 03043
SHEET _____

3' 4' 3'

6'-0" O.A.H.I.

3'-0"

3'-0"



1 - D.F. 3'-0" X 4'-0" X ____" INTERN. ILLUM. SIGN CAB.

1 1/2" LOGO TYPE

CAB. / 1 1/2" RET / 3" X 4" POST = MATTE BLACK
FACE = _____
B.G. = WHITE
COPY 'VIP' = 3-14 CARDINAL RED VINYL
ALL OTHER COPY / ARROW / FLAG = BLACK VINYL

5" EUROSTYLE (BOLD)

5/8" ARROWHEAD



COPY FOR OPPOSITE FACE

PLOT PLAN N.T.S.

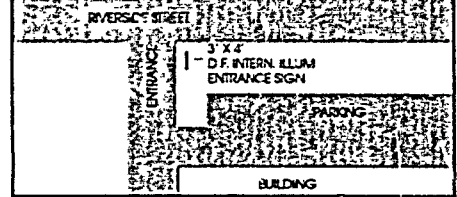

VOLTAGE 120





EXISTING

City of Portland, Maine - Building or Use Permit Application 389 Congress Street, 04101, Tel: (207) 874-8703. FAX: 874-8716

Location of Construction: 35 Riverside St		Owner: VIP Auto Center		Phone:	Permit No: 950108
Owner Address:		Leasee/Buyer's Name:	Phone:	Business Name:	PERMIT ISSUED FEB - 7 1995 CITY OF PORTLAND
Contract Name: Sign, Inc.		Address: 9 Thomas Drive Westbrook, ME 04092		Phone:	
Past Use: Comm/Retail	Proposed Use: Same w/ sign	COST OF WORK: \$		PERMIT FEE: \$ 27.40	Zoning Approval: 2/3/95 Conditions that the V.P. Name and Location in Allentown and Special Zoning Reviews: <input type="checkbox"/> Shoreland and Wetland <input type="checkbox"/> Flood Zone Entrance 4 <input type="checkbox"/> Subdivision lettering h3 <input type="checkbox"/> Site Plan major minor <input type="checkbox"/> <input type="checkbox"/>
Proposed Project Description: Erect Sign as per plans 3 x 4 = 12 sq ft		FIRE DEPT. <input type="checkbox"/> Approved <input type="checkbox"/> Denied	INSPECTION: Use Group: Type: Signature: <i>Holler</i>		
Permit Taken By: Mary Gresik		Date Applied For: 30 Jan 95		Signature: _____ Date: _____	

- This permit application doesn't preclude the Applicant(s) from meeting applicable State and Federal rules.
- Building permits do not include plumbing, septic or electrical work.
- Building permits are void if work is not started within six (6) months of the date of issuance. False information may invalidate a building permit and stop all work.

PERMIT ISSUED WITH LETTER

- Zoning Appeal**
- Variance
 - Miscellaneous
 - Conditional Use
 - Interpretation
 - Approved
 - Denied
- Historic Preservation**
- Not in District or Landmark
 - Does Not Require Review
 - Requires Review

Action:

- Approved
- Approved with Conditions
- Denied

Date: *2/3/95*

[Signature]

CERTIFICATION

I hereby certify that I am the owner of record of the named property, or that the proposed work is authorized by the owner of record and that I have been authorized by the owner to make this application as his authorized agent and I agree to conform to all applicable laws of this jurisdiction. In addition, if a permit for work described in the application issued, I certify that the code official's authorized representative shall have the authority to enter all areas covered by such permit at any reasonable hour to enforce the provisions of the code(s) applicable to such permit.

SIGNATURE OF APPLICANT: *Mary Gresik* DATE: 30 Jan 95 PHONE: 774-2843

RESPONSIBLE PERSON IN CHARGE OF V.P. FILE: _____ PHONE: _____

GEO DISTRICT **4**

M.A. Carroll

White-Permit Desk Green-Assessor's Canary-D.P.W. Pink-Public File Ivory Card-Inspector