

WATER RISER DIAGRAM
N.T.S.

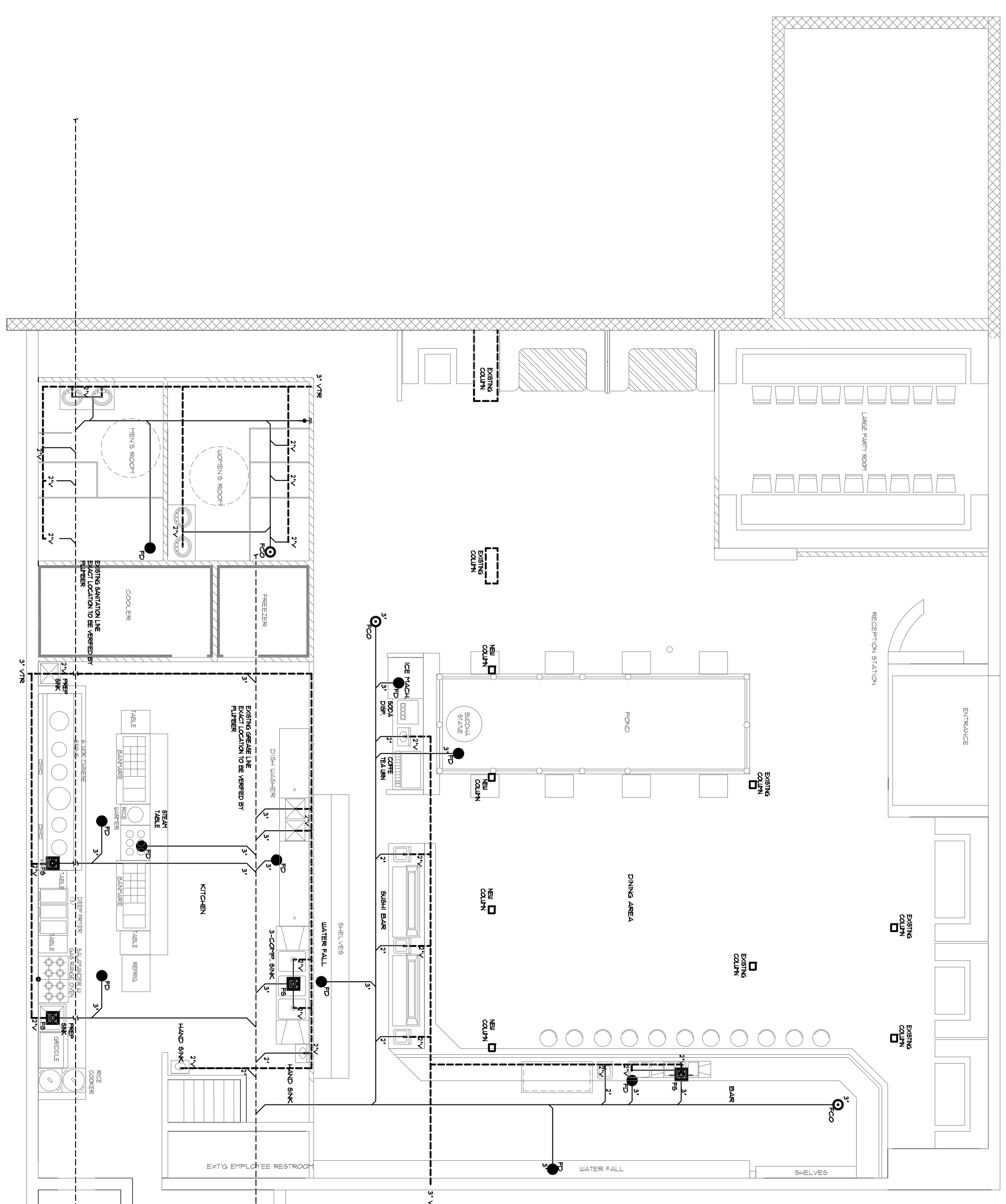

- LEGEND
- FLOOR DRAIN
 - FLOOR CLEAN OUT
 - FLOOR SINK
 - ▲ FLOOR DRAIN

- PLUMBING REQUIREMENTS
1. ALL PLUMBING SHALL COMPLY WITH THE LOCAL PLUMBING/HEALTH DEPARTMENT
 2. INSULATE ALL HOT/COLD WATER LINES ABOVE GRADE WITH 3/4" FIBERGLASS PIPE INSULATION
 3. WITH VAPOUR BARRIER SECTION TO KITCHEN EQUIPMENT WITH KITCHEN SUPPLIER VERIFY MATERIALS SHALL BE AS FOLLOWS
 4. WATER PIPING TO BE TYPE K COPPER BELOW GRADE TYPE IV COPPER ABOVE GRADE
 5. WATER PIPING TO BE TYPE K COPPER ABOVE GRADE
 6. GAS PIPING TO BE SCHEDULE 40 BLACK STEEL PIPE PROVIDE AUTOMATIC GAS SHUT-OFF
 7. ALL INDIRECT WASTES EXCEEDING 24" IN LENGTH SHALL BE EQUIPPED WITH PROTECTION SYSTEM VERIFY & COORDINATE WITH KITCHEN EQUIPMENT SUPPLIER
 8. ALL MATERIALS USED WITHIN BELIEVE AIR PLUMBING SHALL BE APPROVED FOR SUCH USE
 9. PROVIDE FLOOR STOPS AT ALL PLUMBING FIXTURES
 10. PROVIDE FLOOR STOPS & ACCESSORIES AS REQUIRED FOR A COMPLETE INSTALLATION
 11. HAND/CAPE PLUMBING FIXTURES SHALL BE INSTALLED IN ACCORDANCE WITH THE ADA REQUIREMENTS & LOCAL STATE BARRIER FREE REQUIREMENTS
 12. VERIFY ALL EXISTING JOB CONDITIONS REQUIRED FOR A COMPLETE INSTALLATION

PLUMBING RISER DIAGRAM
N.T.S.

