

GENERAL BUILDING DATA
 INTERNATIONAL BUILDING CODE 2003 EDITION
 INTERNATIONAL FIRE CODE 2003 EDITION
 INTERNATIONAL MECHANICAL CODE 2003 EDITION
 INTERNATIONAL ELECTRICAL CODE 2003 EDITION
 INTERNATIONAL PLUMBING CODE 2000 EDITION
 ANSI A117 ACCESSIBILITY CODE CURRENT EDITION
 ANSI A117 ACCESSIBILITY CODE 2003 EDITION
 INTERNATIONAL MECHANICAL CODE 2003 EDITION
 INTERNATIONAL FIRE CODE 2003 EDITION

USE GROUP OR OCCUPANCY: A-2 ASSEMBLY - RESTAURANT

CONSTRUCTION TYPE CLASSIFICATION:

THE EXISTING CONSTRUCTION CONSISTS OF VARIOUS BUILDING COMPONENTS (CHU STEEL BAR JOISTS WOOD TRUSSES METAL FRAMING ECT) AND AS SUCH WE ARE UNCLEAR AS TO THE EXISTING CONSTRUCTION CLASSIFICATION. WE HAVE MAINTAIN A NON-COMBUSTIBLE CLASSIFICATION IN THE NEW CONSTRUCTION UNDER WORK OF THIS PROJECT. THE BUILDING IS FULLY SPRINKLED.

PROJECT DATA:

KON ASIAN BISTRO,
 1140 BRIGHTON AVENUE
 PORTLAND, ME 04102

-INTERIOR ALTERATION PLAN ONLY
 CONSTRUCTION TYPE: Fully Sprinkler Building

-USE GROUP: A-2 RESTAURANT

-TOTAL FLOOR AREA: approx. 6600 sq. ft.

-OCCUPANCY LOAD:

- 1. Dining Area Sushi Area Lounge Area Bar Area: 2030 sq. ft. 2030/135 = 135 occupants
- Actual provided: 60 movable seats and 60 fixed seats
- Cafe Area, Wait/Bar Waiting Area: 215 sq. ft. 215/15 = 15 occupants
- Total amount: 60+60+15 = 135 occupants
- 2. Service / Kitchen AREA:
 Kitchen Area: 1260 sq. ft. (1260/200 = 6.3 occupants)
 Sushi Area: 182 sq. ft. Bar Area: 285 sq. ft. Water Station: 125 sq. ft.
 Tavern Area: 25 sq. ft. 1630/200 = 8.15 provide 12)
 Total amount: 1145+124 = 2069.
- 3. Total Occupants: 182+224 = 2069.

NOTES: 1. Sprinkler and Fire alarm contractor shall submit drawing to State Fire Marshal for approval before upgrading the existing system.
 Building shall be sprinkled and supervised.

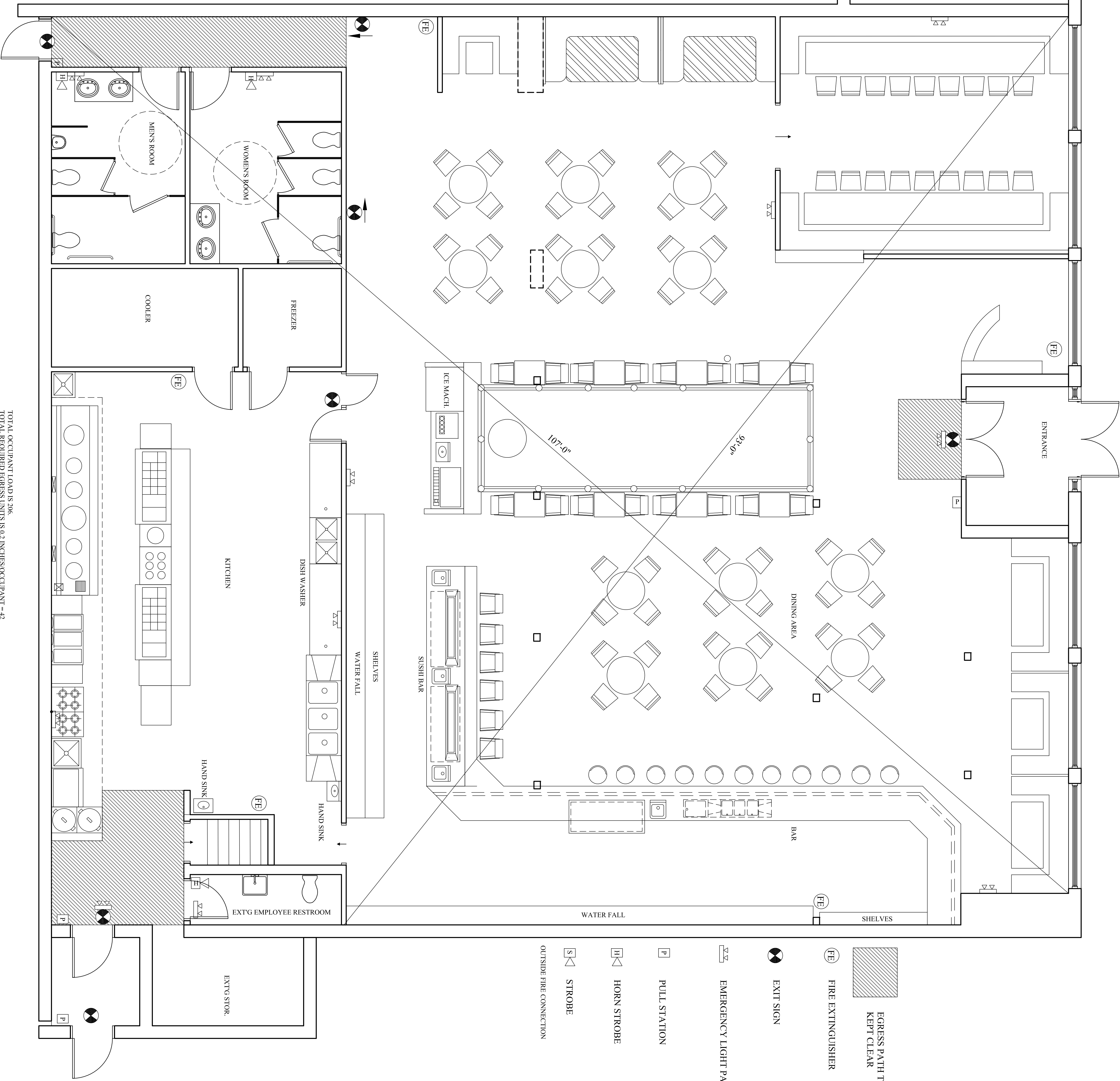

- EGRESS PATH TO BE KEPT CLEAR
- FIRE EXTINGUISHER
- EXIT SIGN
- EMERGENCY LIGHT PACK
- PULL STATION
- HORN STROBE
- STROBE
- OUTSIDE FIRE CONNECTION

TOTAL OCCUPANT LOAD IS 206.
 TOTAL REQUIRED EGRESS UNITS IS 0.2 INCH/OCCUPANT = 42
 TOTAL EGRESS UNITS PROVIDED IS 44
 NUMBER OF EGRESS IS 3

LIFE SAFETY PLAN
 SHEET 1/4 OF 1-9

