

1 DUMPSTER ENCLOSURE: FRONT AND SIDE ELEVATIONS
NOT TO SCALE

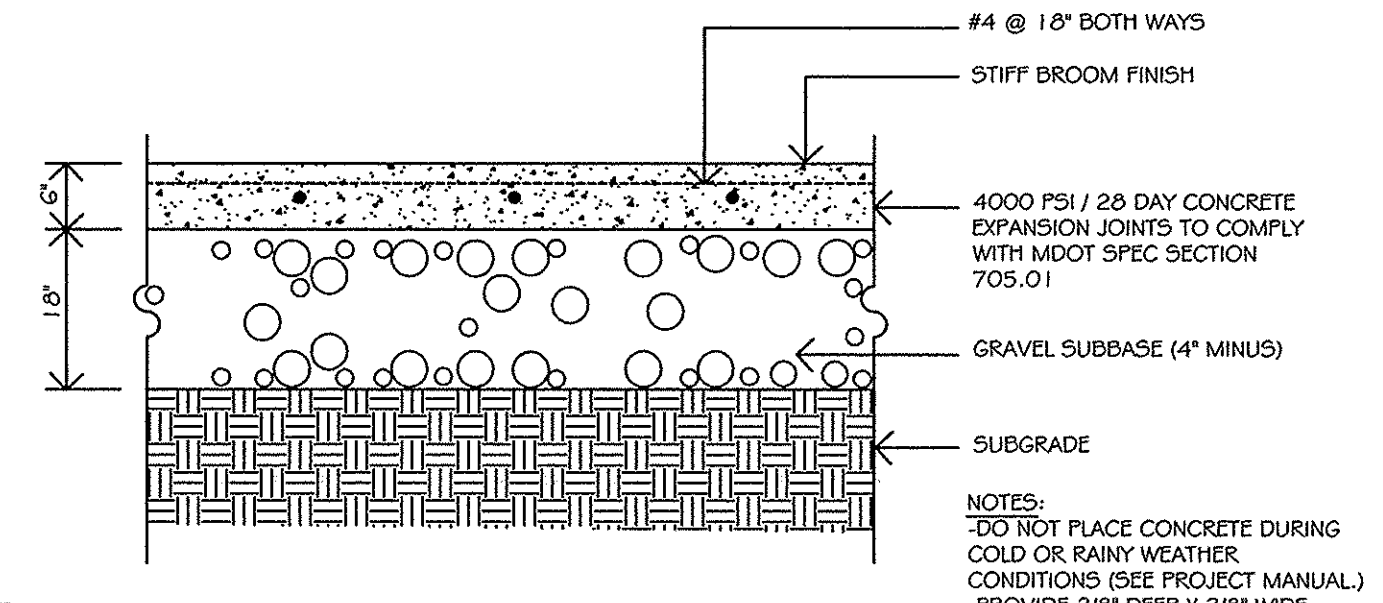

2 CONCRETE PAD AT DUMPSTER PAD
NOT TO SCALE

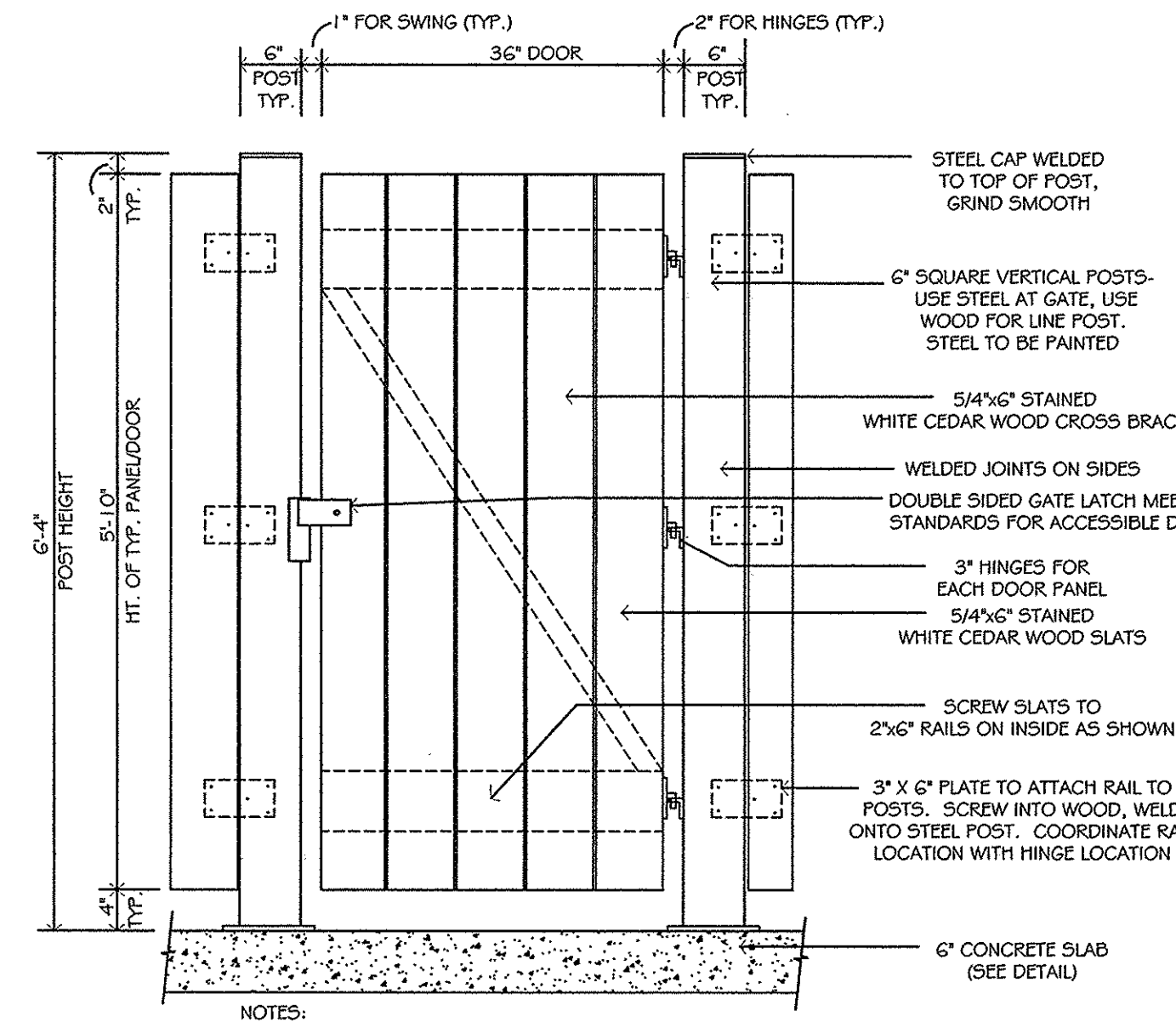

3 DUMPSTER ENCLOSURE MAN-DOOR ELEVATION
NOT TO SCALE

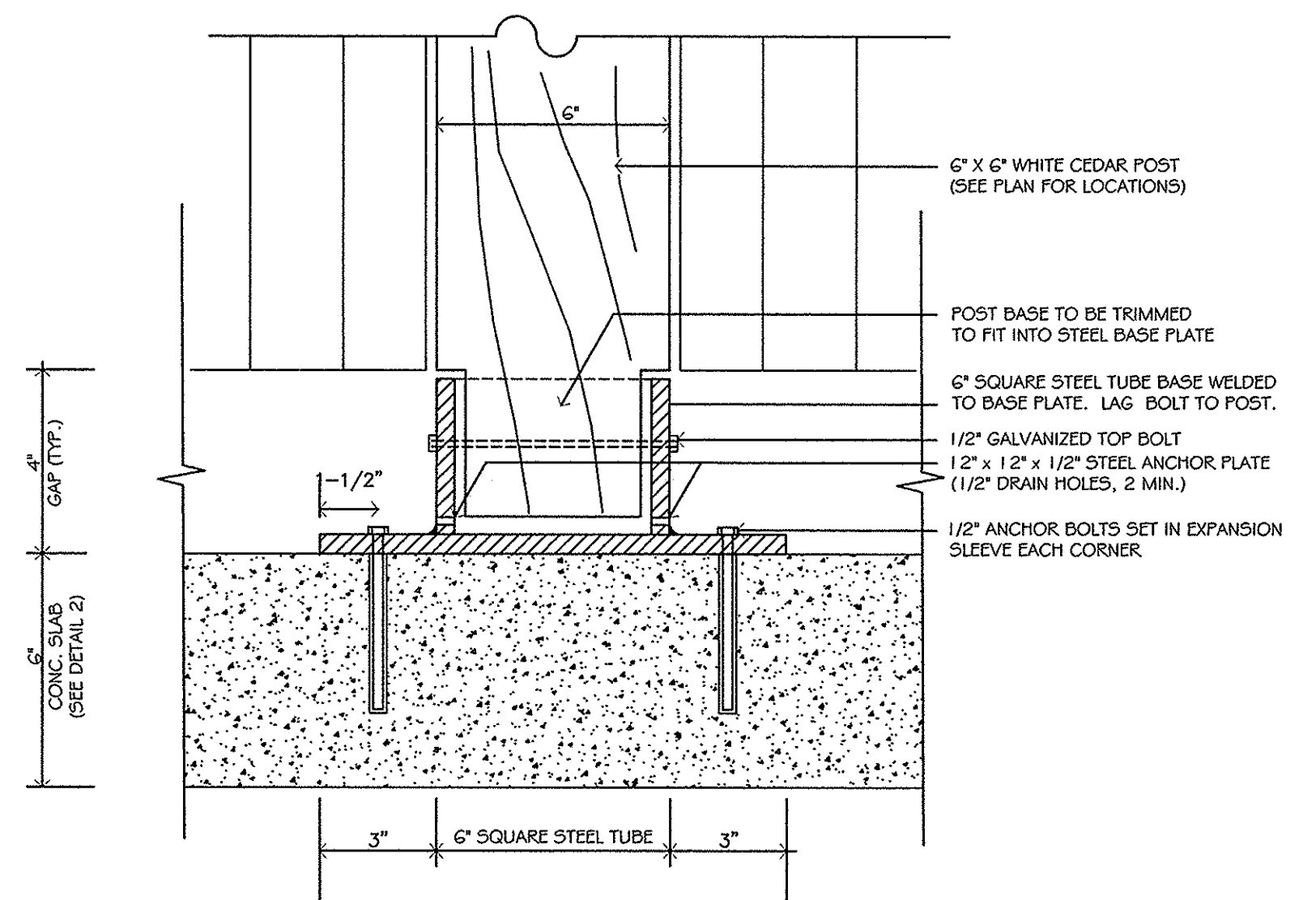

4 BASE PLATE / WOOD POST DETAIL
NOT TO SCALE

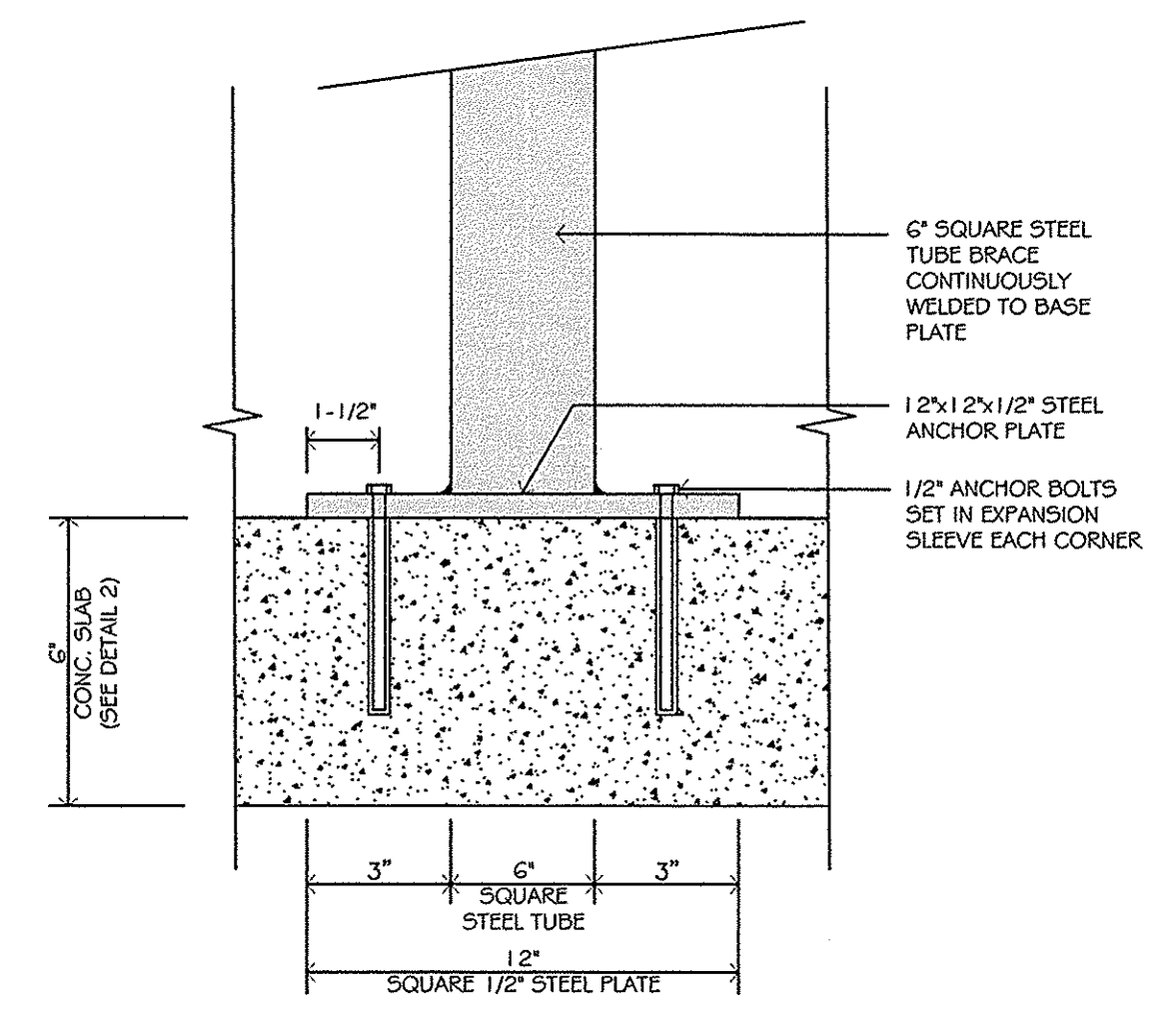

5 BASE PLATE / STEEL POST DETAIL
NOT TO SCALE

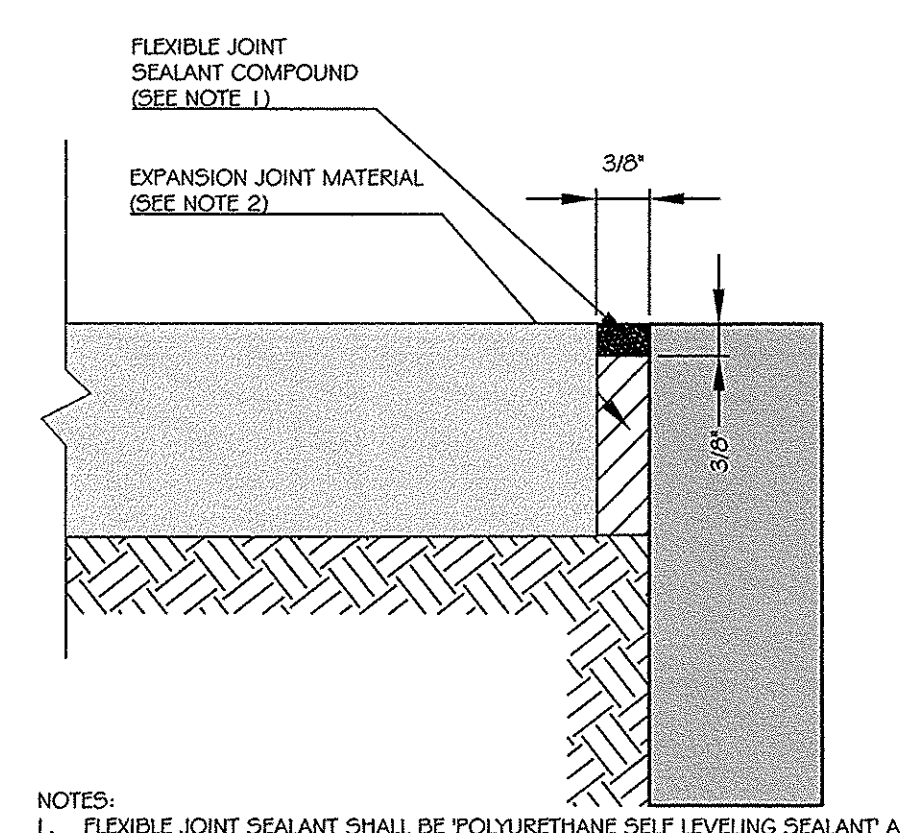

6 EXPANSION JOINT DETAIL
NOT TO SCALE

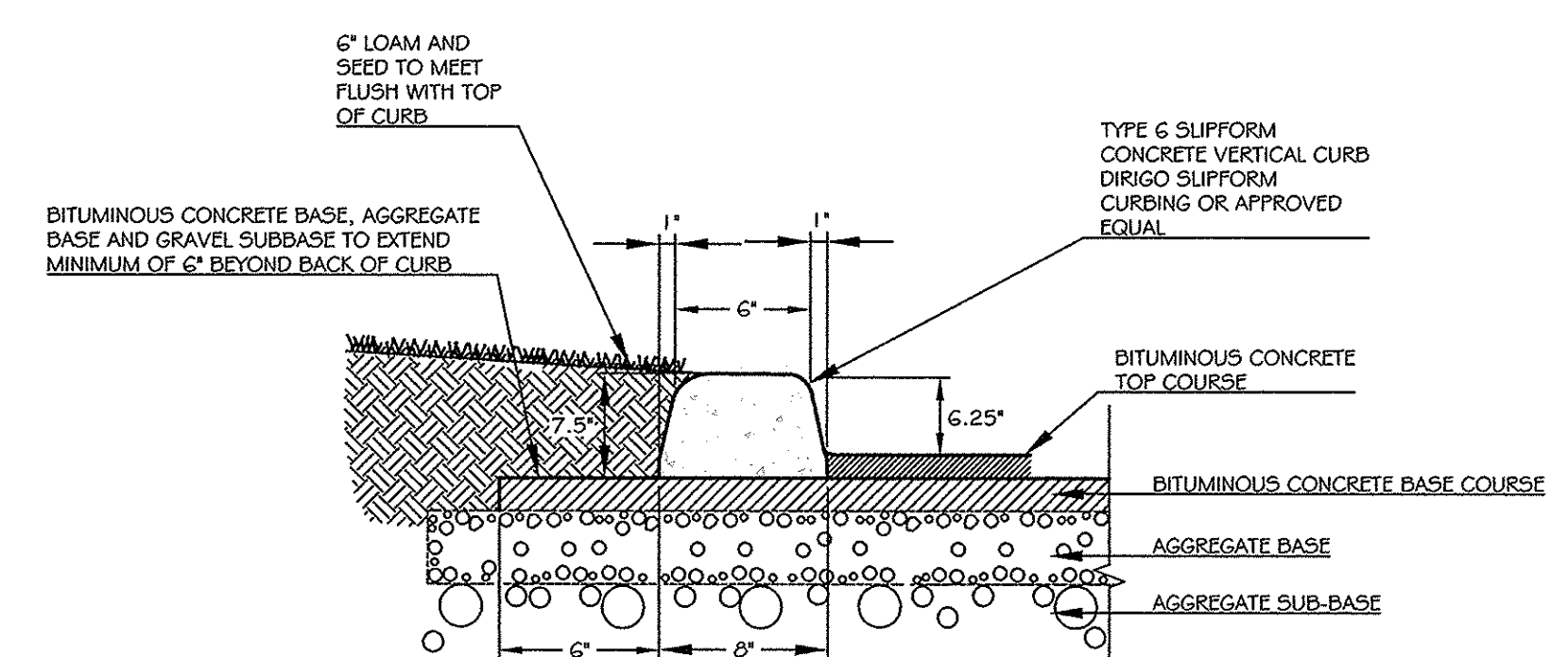

7 VERTICAL CURB DETAIL (SLIPFORM CONCRETE OR BIT. CONCRETE)
NOT TO SCALE

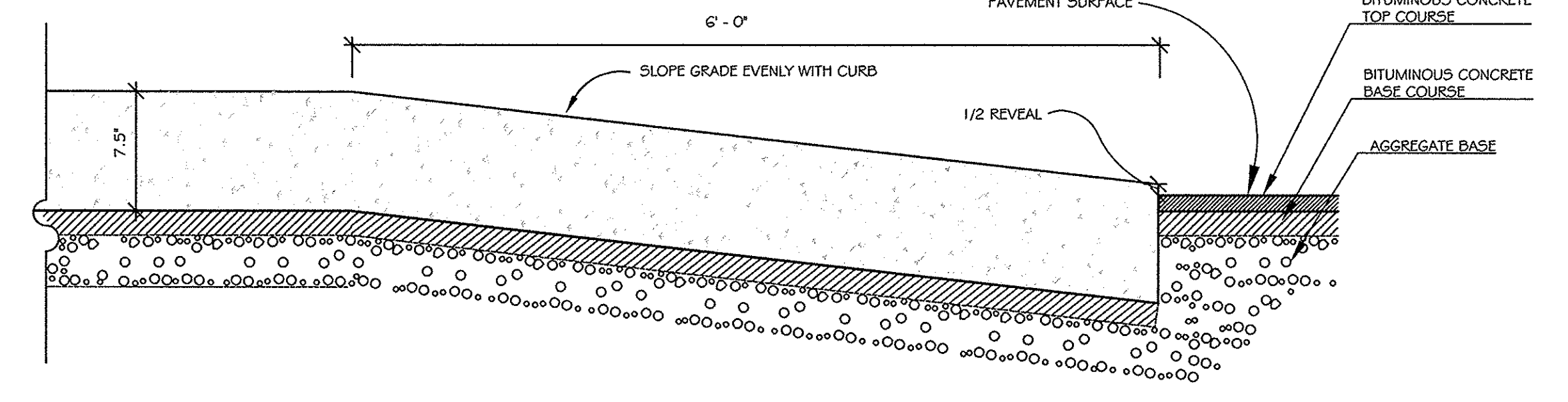

8 CURB TIPDOWN DETAIL (SLIPFORM CONCRETE OR BIT. CONCRETE)
NOT TO SCALE

REV.	DATE	DESCRIPTION

PORTLAND HOTELS, INC.
1200 BRIGHTON AVENUE
PORTLAND, MAINE

SCALE: AS SHOWN
DATE: APRIL 4, 2017
PROJECT: 16186

DRN BY: JDC
DESG BY: TSG
CHK BY: TSG

HOTEL REDEVELOPMENT
1210 BRIGHTON AVENUE
PORTLAND, MAINE

SITE DETAILS

C7.3