

**HOTEL REDEVELOPMENT**  
1210 Brighton Avenue  
Portland, Maine

Portland Hotels, Inc.  
1200 Brighton Avenue  
Portland, Maine 04102

Rev.	Date	Description	Drawn	Check
1	11/14/14	Submitted for Prelim. Level II Site Plan Application	SWC	WRW
2	11/18/14	Revised Cover Sheet and Zoning Summary	SWC	WRW
3	2/17/15	Revised Per City Staff Review Comments	SWC	WRW
4	3/6/15	Revised Per City Staff Review Comments	SWC	WRW

Sheet Title:  
**Post Development  
Drainage Plan**

Job No.:	257	Sheet No.:	
Date:	Nov. 14, 2014		
Scale:	1"=30'		
Drawn:	SWC		
Checked:	WRW		

**D2.0**

ISSUED FOR PERMITTING - NOT FOR CONSTRUCTION

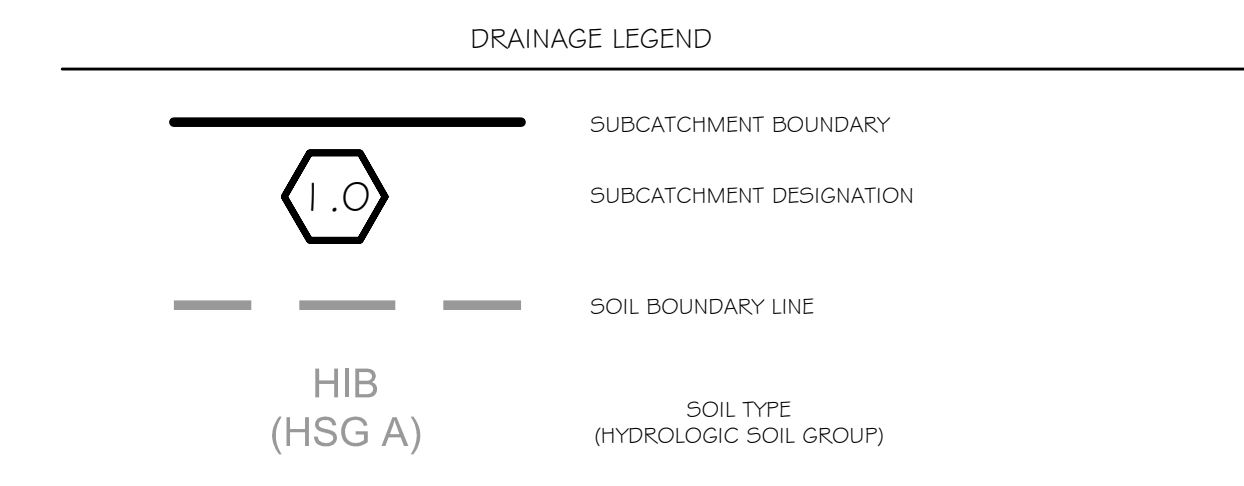

**NOTES**

- ALL TIME OF CONCENTRATION LINES ARE 5 MINUTE MINIMUM.
- SOIL INFORMATION OBTAINED FROM USDA ONLINE WEBSOIL SURVEY, ACCESSED NOVEMBER 13, 2014.

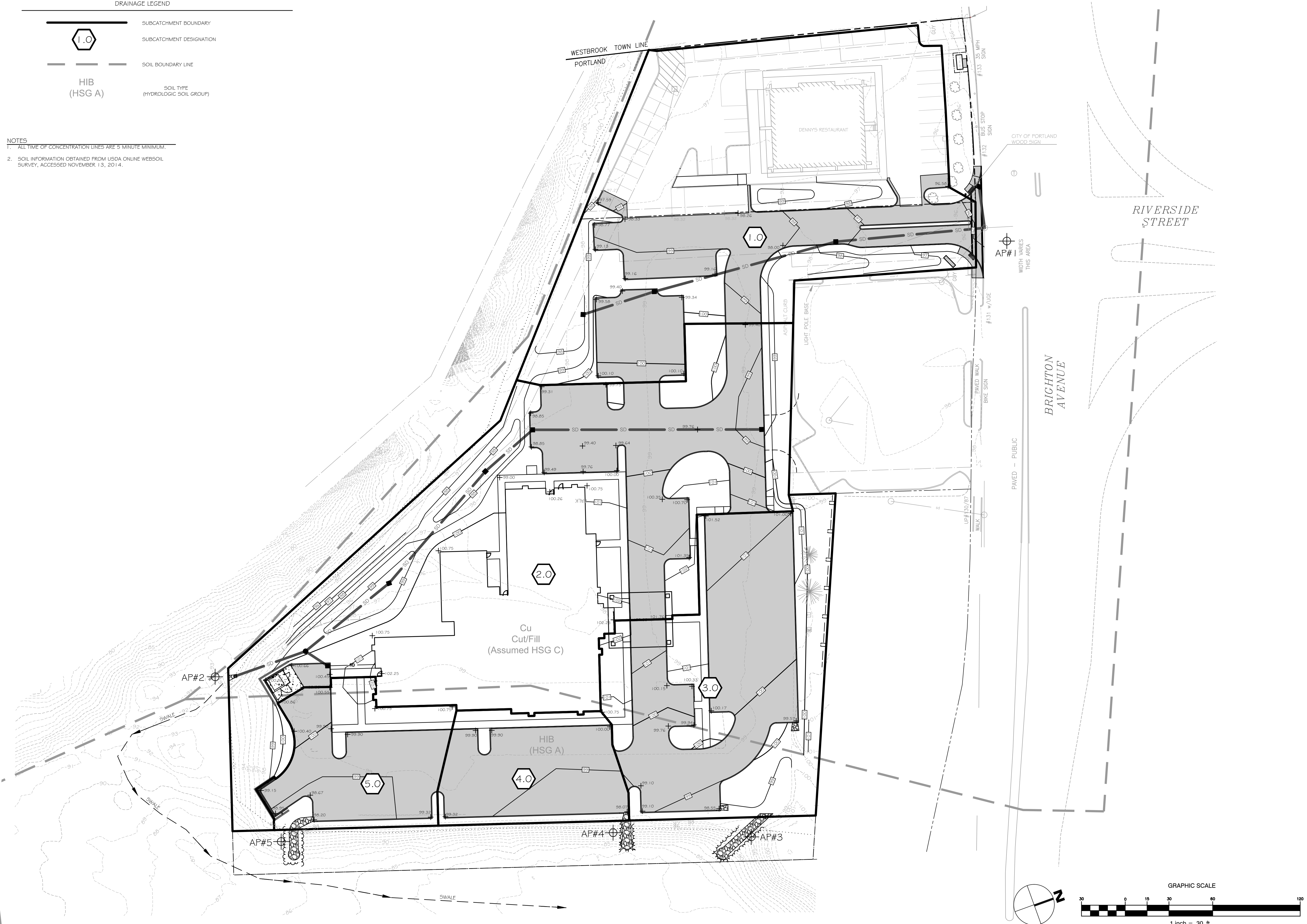

D:\2014\1210 Brighton Avenue\1210 Brighton Avenue.dwg, 11/14/14