

DASHED LINES INDICATES 2X6 @ 16" O.C. FRAMED RAISED PARAPET WALL W/ 2X6 @ 16" O.C. 45° SLOPED FRAMING @ BACKSIDE ATTACHED W/ 2X PLATE @ ROOF & WALL.

5/8" ROOF SHEATHING TO CONTINUE @ 'BUMP OUT' - TYP.

FRAMING PLAN SYMBOLS KEY	
□	WOOD POST
○	STEEL COLUMN
⊙	NUMBER OF WOOD STUDS IN POST BELOW
△	COLUMNS ABOVE THIS LEVEL
⊕	COLUMNS CONTINUOUS THROUGH THIS LEVEL
↔	JOIST BEARING
↔	CONTINUOUS JOIST WITH INTERMEDIATE BEARING
↔	FLUSH FRAMED JOIST BEARING WITH HANGER
↔	WOOD STUD BEARING WALL BELOW
⊕	NUMBER OF TRIM STUDS UNDER HEADER
⊕	NUMBER OF KING STUDS ADJACENT TO HEADER

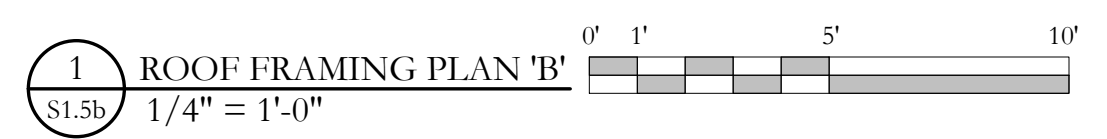

- NOTES:**
- SEE SHEET S1.0 FOR GENERAL STRUCTURAL NOTES.
 - ALL WOOD COLUMNS IN 2x6 WALLS SHALL BE (5) 2x6 AND IN 2x4 WALLS SHALL BE (3) 2x4 UNLESS NOTED OTHERWISE ON PLANS.
 - ALL BEAMS ARE FLUSH UNO.
 - ALL HEADERS IN 2x BEARING WALLS ARE (2) 9 1/4" LVL UNO.
 - ALL FLOOR JOIST TO BE 16" P.E. FLOOR TRUSSES @ 16" W/ LSL RIM - TYP UNO.
 - FLOOR SHEATHING TO BE 3/4" T+G, SEE GENERAL NOTES FOR ADDITIONAL INFORMATION - TYP.
 - ALL TRUSS TO TRUSS CONNECTIONS BY MANUFACTURER - TYP UNO.
 - TRUSS DESIGNER TO COORDINATE TRUSS LAYOUT WITH FLOOR OPENING, PLUMBING, AND UTILITY REQUIREMENTS - TYP.

Prepared For: Consultant: Architect:	PORTLAND HOTEL, INC ARCHETYPE architects <small>48 Union Wharf Portland, Maine 04101 (207) 772-6022 ARCHETYPE@ARCHETYPEPA.COM</small>
Project:	HAMPTON INN Address: City, State
Revisions:	PERMIT SET
Date:	Scale:
02/09/2016	1/4" = 1'-0" ROOF FRAMING PLAN 'B'
S1.5b 2/10/16	