

Prepared For:
PORTLAND HOTEL, INC.

Consultant:
ARCHETYPE architects
48 Union Wharf Portland, Maine 04101
(207) 772-0022 ARCHETYPE@ARCHETYPEA.COM

Project:
HAMPTON INN & SUITES
1200 Brighton Ave
Portland, ME

Revisions:
2 10 FEB 2016
SUB TO CITY

Date:
12-23-2015
Scale:
As indicated
UPPER FLOOR RCP

A7.02

RCP LEGEND

GYP CEILING HEIGHT AS NOTED IN PLAN

ACT CEILING

LIGHTING

THE FOLLOWING IS FOR REFERENCE SEE ELECTRICAL DRAWINGS FOR LIGHTING CALLOUTS

OVERHEAD PROJECTOR AND SCREEN

LIGHTS

PENDANT

RECESSED LIGHTING

CEILING MOUNTED POOL AREA

LIFE SAFETY EQUIPMENT

WALL PACK

EXIT SIGN

NOTE: PROVIDE GYP CEILINGS AT THE BOTTOM OF ALL STAIR RISERS AND LANDINGS AS SHOWN IN STAIR DRAWINGS

SEE INTERIOR GUESTROOM DRAWINGS FOR GUESTROOM RCP INFORMATION

PROVIDE SEPARATE DIMMING SYSTEMS FOR THE PENDANT FIXTURES OVER THE COMMUNAL TABLE. FOR THE RECESSED WALL WASHERS OVER THE LIBRARY SHELVES ON THE FOCAL WALL AND IN THE PANTRY AREA.

RCP LEGEND
1/8" = 1'-0"



NOTE: GUESTROOM BATHROOM SWITCHES ON TIMER

1 | SECOND FLOOR - CEILING PLAN
3/32" = 1'-0"

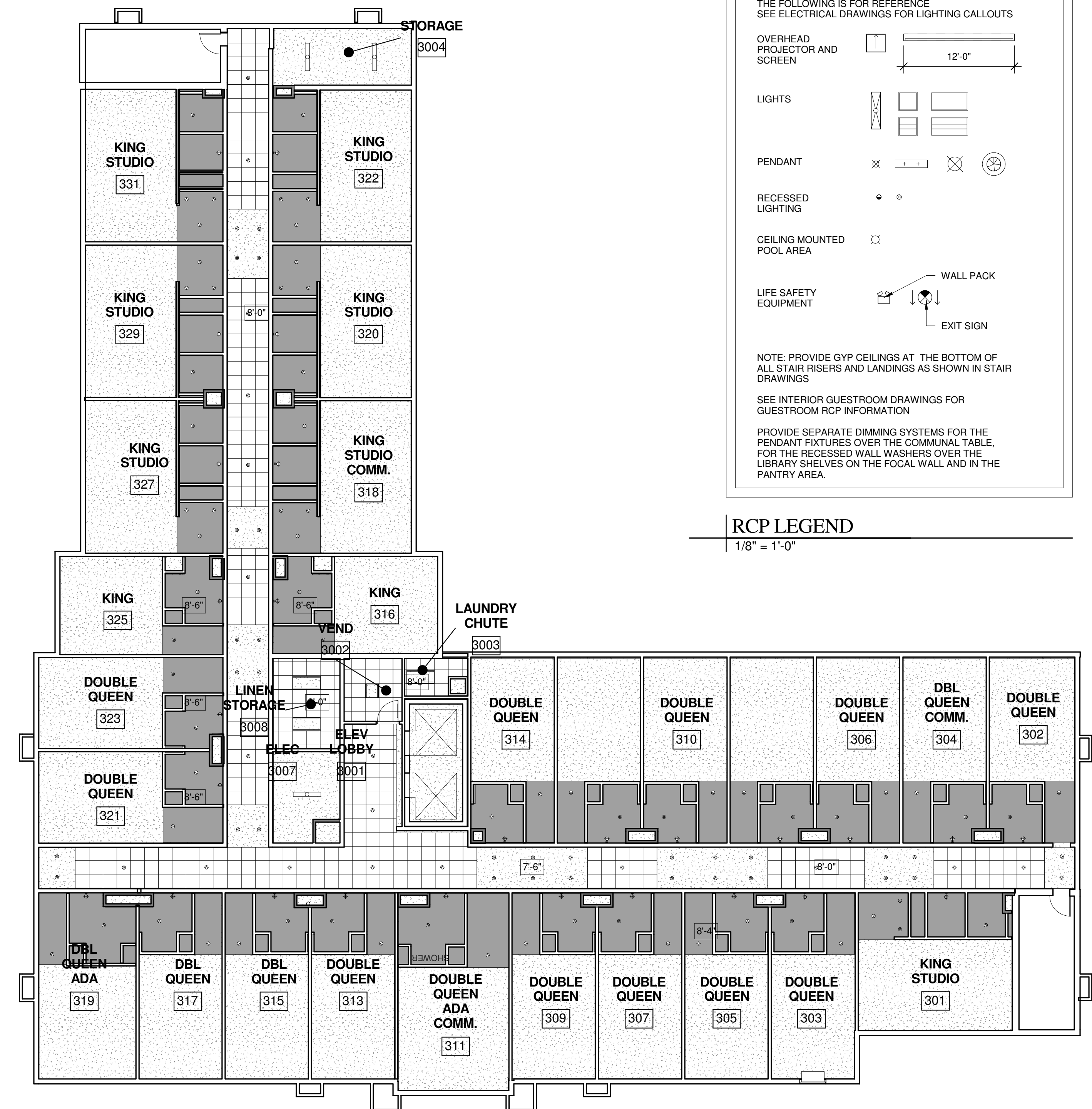

2 | THIRD & FOURTH FLOOR CEILING PLAN
3/32" = 1'-0"