

DEMARC EXTENSION WORK PER DETAIL ON SHEET 3 OF 6 TO BE COMPLETED ON THE FIRST DAY OF CONSTRUCTION. COORDINATE WITH BOARD AND CONDUITS TO COORDINATE INSTALL OF CATSE LINES WITH INC. EMAIL PHOTO TO LEASING COORDINATOR TO CONFIRM WORK COMPLETION.

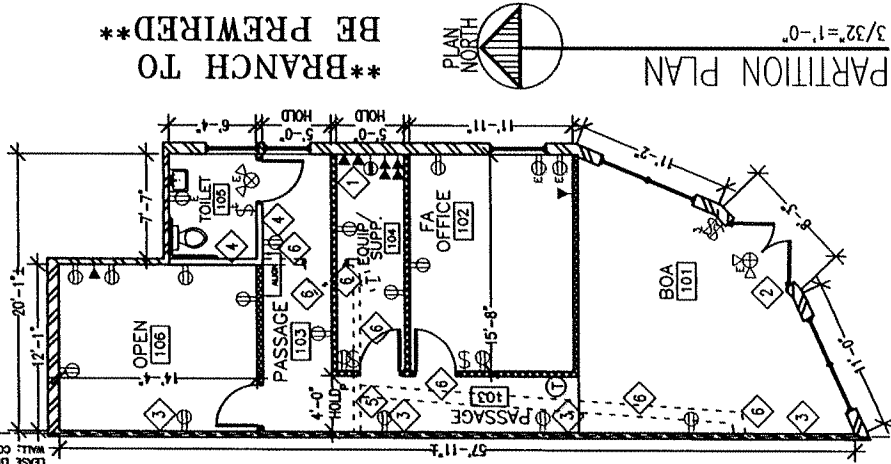

**** BRANCH TO BE PREWIRED ****

KEYED NOTES:

1. PHONE COMPANY SERVICE TO BE INSTALLED AT BOB LOCATION PER DETAIL ON SHEET 6 OF 6 AND PER SPECIFICATIONS ON 1ST DAY OF CONSTRUCTION. EMAIL PHOTO TO LEASING COORDINATOR TO CONFIRM WORK ASAP.
2. INSTALL DOOR CHIME AT ENTRY DOOR. CHIME TO BE LOCATED IN 103. HEALTH ZENITH WIRELESS PLUG-IN DOOR CHIME WITH WHITE COVER & HORIZONTAL LINES - HOME DEPOT MODEL #DL-6168 OR COMPARABLE ALTERNATIVE.
3. CONSTRUCT NEW INSULATED DEMISING PARTITION TO DECK & PREP FOR NEW FINISHES. IF PROPERTY UTILIZES A PLENUM RETURN FOR ENTIRE BUILDING, TAKE NEW DEMISING PARTITION TO UNDERSIDE OF CEILING & INSTALL SECURITY FENCING FROM TOP OF PARTITION TO DECK TO PROVIDE A SECURE DEMISING PARTITION.
4. CONFIRM EXISTING PARTITION IS INSULATED; INSTALL/BLOW IN INSULATION AS REQUIRED.
5. DEMO & CAP EXISTING PLUMBING; PATCH & REPAIR ADJACENT SURFACES FOR NEW FINISHES.
6. DEMO EXISTING PARTITION/DOOR/SOFTFIT AS INDICATED ON PLAN; PATCH & REPAIR ADJACENT SURFACES FOR NEW FINISHES.

CONTRACTOR (SITE SPECIFIC) NOTES:

1. LANDLORD TO DELIVER SPACE IN AS-IS CONDITION.
2. ALL ITEMS TO BE COMPLETED PER EDWARD JONES SPECIFICATIONS, SEE PAGES 4-6 UNLESS OTHERWISE NOTED.
3. CONTRACTOR TO FIELD VERIFY ALL DIMENSIONS & WINDOW MULLION PLACEMENT PRIOR TO CONSTRUCTION. IF YOU ARE UNABLE TO VERIFY DIMENSIONS, IF A DISCREPANCY OCCURS, NOTIFY DESIGNER IMMEDIATELY.
4. BRANCH TO BE PREWIRED PER LOCAL CODES AND DUE TO CEILING HEIGHT AT 10'-0". PREWIRED TO BE COMPLETED BY INC- GC TO COORDINATE; INC TO INSTALL ** CATSE PHONE LINES IN 3/4" CONDUIT PROVIDED BY GC FROM BUILDING SOURCE TO BOB LOCATION IN EQUIP/SUPP 104. SEE DETAIL ON SHEET 6 OF 6.
5. DEMO EXISTING OUTLETS OVER 18" A.F.F. INSTALL NEW ELECTRICAL PER PLAN UNLESS WITHIN 36" OF EXISTING RECEPTACLE. INSTALL NEW 120/208V ELECTRIC PANEL ALONG REAR EXTERIOR WALL AS SHOWN ON PLAN. LLD TO PROVIDE ELECTRIC FEEDERS TO PANEL AS NOTED. SIZE OF SERVICE TO BE DETERMINED AS NOTED IN LEASE.
6. EXISTING ROOFTOP HVAC UNIT SHALL REMAIN FOR EDU USE. ANY TRUNK LINES SERVICING THE ADJACENT TENANT SHALL BE CUT AND CAPPED BY LANDLORD; EDU TO MODIFY ALL EXISTING DUCTWORK AND EQUIPMENT REMAINING IN EDU PREMISES. INSTALL/RELOCATE SUPPLY & RETURN GRILLES, INCLUDING DUCTWORK, AS REQUIRED FOR COMPLETE & BALANCED WORKING SYSTEM AND TO ACHIEVE ONE SUPPLY & ONE RETURN AT MINIMUM IN EACH ROOM. CLEAN & CHECK HVAC UNIT; INSTALL NEW DIGITAL PROGRAMMABLE THERMOSTAT AS SHOWN ON PLAN IN PASSAGE 103.
7. INSTALL NEW 2'x4' ACOUSTICAL CEILING GRID & TILES AT 10'-0" A.F.F. WITH 2'x4' LAY-IN FLUORESCENT LIGHT FIXTURES TO MEET EDWARD JONES LIGHTING SPECIFICATIONS. (2) NIGHT LIGHTS TO BE HARDWIRED AT 101 & 103. INSTALL COMMERCIAL 6" RECESSED SPOTLIGHT TO ILLUMINATE INTERIOR INSULATION ABOVE CEILING AT ROOM 102.
8. PATCH, REPAIR, & PREP EXISTING PARTITIONS AS REQUIRED FOR NEW FINISHES; REMOVE EXISTING WALL COVERING AND CHAIR RAIL AS REQUIRED.
9. VERIFY LOCATION OF ALL EXISTING DEMISING PARTITIONS. VERIFY THAT THEY EXTEND TO THE DECK & ARE INSULATED; EXTEND & ADD INSULATION AS REQUIRED.
10. REMOVE EXISTING FLOORING & BASE THROUGHOUT EXCEPT IN 104; DEMO EXISTING FLOOR OUTLETS. ENSURE ALL FLOORING SURFACES ARE LEVEL, SMOOTH, & READY TO ACCEPT NEW FINISHES PER FINISH SCHEDULE. LLD SHALL PARTIALLY DEMO FINISHES NECESSARY TO INSTALL DEMISING WALL THROUGHOUT SPACE; VERIFY EXISTING EXHAUST FAN IS VENTED TO EXTERIOR AND FUNCTIONS; COMMUNICATE CONDITION OF EXHAUST FAN TO ARCHITECT IMMEDIATELY.
11. DEMO ALL ABANDONED PIPING & VOICE/DATA WIRING.
12. INSTALL NEW 3'-0" 6-PANEL SOLID CORE WOOD DOORS THROUGHOUT; PAINT DOORS AND FRAMES WHITE. PROVIDE & INSTALL STORE ROOM LOCKSET & DOOR CLOSER AT 104. PROVIDE & INSTALL PRIVACY LOCKSET & DOOR CLOSER AT 105.
14. MODIFY EXISTING SPRINKLER SYSTEM/FIRE ALARM AS REQUIRED BY LOCAL CODES.

ISSUES/REVISIONS

NO.	DATE	DESCRIPTION
1	11.7.2016	PERMIT SET

CONTRACTOR MUST HAVE ALL 6 PAGES OF THESE DESIGN INTENT DRAWINGS. IF YOU ARE MISSING ANY OF THESE 6 PAGES, PLEASE CONTACT DESIGNER AT PHONE NUMBER LISTED IN TITLEBLOCK. SEE PAGE 1 OF 6 FOR ADDITIONAL NOTES.



64 HIGH STREET
PORTLAND, ME 04106
PHONE: 603.766.7774
FAX: 603.766.7774

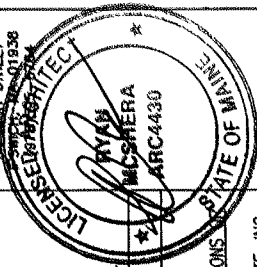

1042 BRIGHTON AVE
STF 200
PORTLAND, ME 04102

SQUARE FOOTAGE 1060

Edward Jones
BRANCH FACILITIES
BRANCH OFFICE 99079
DATE: 11.7.2016

EXHIBIT A
SHEET 2 of 6