

# DISPLAY THIS CARD ON PRINCIPAL FRONTAGE OF WORK CITY OF PORTLAND

Please Read Application And Notes, if Any, Attached

## BUILDING INSPECTION PERMIT

Permit Number: 091130

This is to certify that CENTRO HERITAGE SPE 4 LLC /Barlo Signs  
has permission to New 89" x 112" Pylon Sign for Aspen Denial Bangor Savings, Red EX  
AT 1056 BRIGHTON AVE CBL 263A-A007001

provided that the person or persons, firm or corporation accepting this permit shall comply with all the provisions of the Statutes of Maine and of the Ordinances of the City of Portland regulating the construction, maintenance and use of buildings and structures, and of the application on file in this department.

Apply to Public Works for street line and grade if nature of work requires such information.

Notification of inspection must be given and written permission procured before this building or part thereof is lathed or otherwise closed-in. 24 HOUR NOTICE IS REQUIRED.

A certificate of occupancy must be procured by owner before this building or part thereof is occupied.

### OTHER REQUIRED APPROVALS

Fire Dept. \_\_\_\_\_  
Health Dept. \_\_\_\_\_  
Appeal Board \_\_\_\_\_  
Other Allyson... Department Name

*[Signature]*  
Director - Building & Inspection Services

### PENALTY FOR REMOVING THIS CARD

*OK to close at 5:00 PM*

PERMIT ISSUED

OCT 19 2009

City of Portland

SCANNED



CITY OF PORTLAND, MAINE  
Department of Building Inspection

# Certificate of Occupancy

Issued to Centro Heritage Spe 4 Llc /Vance Construction

LOCATION 1040 BRIGHTON AVE

CBL 263A A007001

Date of Issue 02/22/2011

**This is to certify** that the building, premises, or part thereof, at the above location, built — altered — changed as to use under Building Permit No. 10-1170, has had final inspection, has been found to conform substantially to requirements of Zoning Ordinance and Building Code of the City, and is hereby approved for occupancy or use, limited or otherwise, as indicated below.

PORTION OF BUILDING OR PREMISES

Entire

APPROVED OCCUPANCY

Optometrist Office  
Use Group B  
Type 2B  
IBC-2003

Limiting Conditions:

None

This certificate supersedes  
certificate issued

Approved:

(Date)

Inspector

Inspector of Buildings

Notice: This certificate identifies lawful use of building or premises, and ought to be transferred from owner to owner when property changes hands. Copy will be furnished to owner or lessee for one dollar.

**City of Portland, Maine - Building or Use Permit Application**

389 Congress Street, 04101 Tel: (207) 874-8703, Fax: (207) 874-8716

Permit No: 09-1130	Issue Date:	CBL: 263A A07001
-----------------------	-------------	---------------------

Location of Construction: 1056 BRIGHTON AVE	Owner Name: CENTRO HERITAGE SPE 4 LLC	Owner Address: 131 DARTMOUTH ST	Phone:
Business Name:	Contractor Name: Barlo Signs	Contractor Address: 158 Greeley Street Hudson	Phone 6038808949
Lessee/Buyer's Name	Phone:	Permit Type: Signs - Permanent	Zone: B-2

Past Use: Commercial -	Proposed Use: Commercial - New 89" x 112" Pylon Sign for Aspen Dental, Bangor Savings, FedEx	Permit Fee: \$170.00	Cost of Work: \$170.00	CEO District: 3
		FIRE DEPT: <input type="checkbox"/> Approved <input checked="" type="checkbox"/> Denied <i>N/A</i>	INSPECTION: Use Group: <i>U</i> Type: <i>Sign</i> <i>IBC 2003</i>	

Proposed Project Description:  
New 89" x 112" Pylon Sign for Aspen Dental, Bangor Savings, FedEx

Signature: \_\_\_\_\_  
Signature: \_\_\_\_\_  
PEDESTRIAN ACTIVITIES DISTRICT (P.A.D.)  
Action:  Approved  Approved w/Conditions  Denied  
Signature: \_\_\_\_\_ Date: \_\_\_\_\_

Permit Taken By: Ldobson	Date Applied For: 10/09/2009	<b>Zoning Approval</b>
-----------------------------	---------------------------------	------------------------

<p>1. This permit application does not preclude the Applicant(s) from meeting applicable State and Federal Rules.</p> <p>2. Building permits do not include plumbing, septic or electrical work.</p> <p>3. Building permits are void if work is not started within six (6) months of the date of issuance. False information may invalidate a building permit and stop all work..</p>	<p><b>Special Zone or Reviews</b></p> <p><input type="checkbox"/> Shoreland</p> <p><input type="checkbox"/> Wetland <i>Grants to Planning under section 14-36(5)(b)</i></p> <p><input type="checkbox"/> Flood Zone</p> <p><input type="checkbox"/> Subdivision</p> <p><input type="checkbox"/> Site Plan <i>Approved w/ conditions.</i></p> <p>Maj <input type="checkbox"/> Minor <input type="checkbox"/> MM <input type="checkbox"/></p> <p><i>Alexander Jaeger</i></p> <p>Date: <i>10/19/09</i></p>	<p><b>Zoning Appeal</b></p> <p><input type="checkbox"/> Variance</p> <p><input type="checkbox"/> Miscellaneous</p> <p><input type="checkbox"/> Conditional Use</p> <p><input type="checkbox"/> Interpretation</p> <p><input type="checkbox"/> Approved</p> <p><input type="checkbox"/> Denied</p> <p>Date: _____</p>	<p><b>Historic Preservation</b></p> <p><input checked="" type="checkbox"/> Not in District or Landmark</p> <p><input type="checkbox"/> Does Not Require Review</p> <p><input type="checkbox"/> Requires Review</p> <p><input type="checkbox"/> Approved</p> <p><input type="checkbox"/> Approved w/Conditions</p> <p><input type="checkbox"/> Denied</p> <p><i>ATM</i></p> <p>Date: _____</p>
---	--	--	---

**PERMIT ISSUED**

**CERTIFICATION**

I hereby certify that I am the owner of record of the named property, or that the proposed work is authorized by the owner of record and that I have been authorized by the owner to make this application as his authorized agent and I agree to conform to all applicable laws of this jurisdiction. In addition, if a permit for work described in the application is issued, I certify that the code official's authorized representative shall have the authority to enter all areas covered by such permit at any reasonable hour to enforce the provisions of the code(s) applicable to such permit.

OCT 19 2009

\_\_\_\_\_  
SIGNATURE OF APPLICANT ADDRESS DATE PHONE

\_\_\_\_\_  
RESPONSIBLE PERSON IN CHARGE OF WORK, TITLE DATE PHONE

**City of Portland, Maine - Building or Use Permit Application**

389 Congress Street, 04101 Tel: (207) 874-8703, Fax: (207) 874-8716

Permit No: 09-1130	Issue Date:	CBL: 263A A007001
-----------------------	-------------	----------------------

Location of Construction: 1056 BRIGHTON AVE	Owner Name: CENTRO HERITAGE SPE 4 LLC	Owner Address: 131 DARTMOUTH ST	Phone:
Business Name:	Contractor Name: Barlo Signs	Contractor Address: 158 Greeley Street Hudson	Phone: 6038808949
Lessee/Buyer's Name	Phone:	Permit Type: Signs - Permanent	Zone: B-2

Past Use: Commercial -	Proposed Use: Commercial - New 89" x 112" Pylon Sign for Aspen Dental, Bangor Savings, FedEX	Permit Fee: \$170.00	Cost of Work: \$170.00	CEO District: 3
		FIRE DEPT: <input type="checkbox"/> Approved <input type="checkbox"/> Denied <i>N/A</i>	INSPECTION: Use Group: <i>U</i> Type: <i>Sign</i> <i>IBC 2003</i>	

Proposed Project Description: New 89" x 112" Pylon Sign for Aspen Dental, Bangor Savings, FedEX	Signature:	Signature:
PEDESTRIAN ACTIVITIES DISTRICT (P.A.D.)		
Action: <input type="checkbox"/> Approved <input type="checkbox"/> Approved w/Conditions <input type="checkbox"/> Denied		
Signature:	Date:	

Permit Taken By: Ldobson	Date Applied For: 10/09/2009	<b>Zoning Approval</b>		
-----------------------------	---------------------------------	------------------------	--	--

<p>1. This permit application does not preclude the Applicant(s) from meeting applicable State and Federal Rules.</p> <p>2. Building permits do not include plumbing, septic or electrical work.</p> <p>3. Building permits are void if work is not started within six (6) months of the date of issuance. False information may invalidate a building permit and stop all work..</p>	<p>Special Zone or Reviews</p> <p><input type="checkbox"/> Shoreland</p> <p><input type="checkbox"/> Wetland <i>Private Planning under section 14-34.5(b)</i></p> <p><input type="checkbox"/> Flood Zone</p> <p><input type="checkbox"/> Subdivision</p> <p><input type="checkbox"/> Site Plan <i>Approved w/ conditions</i></p> <p>Maj <input type="checkbox"/> Minor <input type="checkbox"/> MM <input type="checkbox"/></p> <p><i>Alexander Davog</i></p> <p>Date: <i>10/19/09</i></p>	<p>Zoning Appeal</p> <p><input type="checkbox"/> Variance</p> <p><input type="checkbox"/> Miscellaneous</p> <p><input type="checkbox"/> Conditional Use</p> <p><input type="checkbox"/> Interpretation</p> <p><input type="checkbox"/> Approved</p> <p><input type="checkbox"/> Denied</p> <p>Date:</p>	<p>Historic Preservation</p> <p><input checked="" type="checkbox"/> Not in District or Landmark</p> <p><input type="checkbox"/> Does Not Require Review</p> <p><input type="checkbox"/> Requires Review</p> <p><input type="checkbox"/> Approved</p> <p><input type="checkbox"/> Approved w/Conditions</p> <p><input type="checkbox"/> Denied</p> <p><i>ABM</i></p> <p>Date:</p>
---	--	---	--

**PERMIT ISSUED**

**CERTIFICATION**

I hereby certify that I am the owner of record of the named property, or that the proposed work is authorized by the owner of record and that I have been authorized by the owner to make this application as his authorized agent and I agree to conform to all applicable laws of this jurisdiction. In addition, if a permit for work described in the application is issued, I certify that the code official's authorized representative shall have the authority to enter all areas covered by such permit at any reasonable hour to enforce the provisions of the code(s) applicable to such permit.

SIGNATURE OF APPLICANT \_\_\_\_\_ ADDRESS \_\_\_\_\_ DATE \_\_\_\_\_ PHONE \_\_\_\_\_

RESPONSIBLE PERSON IN CHARGE OF WORK, TITLE \_\_\_\_\_ DATE \_\_\_\_\_ PHONE \_\_\_\_\_



# CITY OF PORTLAND, MAINE

Department of Building Inspections

## Original Receipt

\_\_\_\_\_ 10-9 20 09 \_\_\_\_\_

Received from Paula Jones

Location of Work 1100 Brighton

Cost of Construction \$ \_\_\_\_\_ Building Fee: \_\_\_\_\_

Permit Fee \$ \_\_\_\_\_ Site Fee: \_\_\_\_\_

Certificate of Occupancy Fee: \_\_\_\_\_

**Total:** 170

Building (IL) \_\_\_\_\_ Plumbing (I5) \_\_\_\_\_ Electrical (I2) \_\_\_\_\_ Site Plan (U2) \_\_\_\_\_

Other \_\_\_\_\_

CBL: 263-AA 7

Check #: 1631 **Total Collected \$** 170

**No work is to be started until permit issued.  
Please keep original receipt for your records.**

Taken by: [Signature]

WHITE - Applicant's Copy  
YELLOW - Office Copy  
PINK - Permit Copy

**City of Portland, Maine - Building or Use Permit**

389 Congress Street, 04101 Tel: (207) 874-8703, Fax: (207) 874-8716

<b>Permit No:</b> 09-1130	<b>Date Applied For:</b> 10/09/2009	<b>CBL:</b> 263A A007001
------------------------------	--	-----------------------------

<b>Location of Construction:</b> 1056 BRIGHTON AVE	<b>Owner Name:</b> CENTRO HERITAGE SPE 4 LLC	<b>Owner Address:</b> 131 DARTMOUTH ST	<b>Phone:</b>
<b>Business Name:</b>	<b>Contractor Name:</b> Barlo Signs	<b>Contractor Address:</b> 158 Greeley Street Hudson	<b>Phone</b> (603) 880-8949
<b>Lessee/Buyer's Name</b>	<b>Phone:</b>	<b>Permit Type:</b> Signs - Permanent	

<b>Proposed Use:</b> Commercial - New 89" x 112" Pylon Sign for Aspen Dental, Bangor Savings, FedEx	<b>Proposed Project Description:</b> New 89" x 112" Pylon Sign for Aspen Dental, Bangor Savings, FedEx
--	---

<b>Dept:</b> Zoning	<b>Status:</b> Approved with Conditions	<b>Reviewer:</b> Ann Machado	<b>Approval Date:</b> 10/19/2009
<b>Note:</b> Approved by the planning division on 10/19/2009.			<b>Ok to Issue:</b> <input checked="" type="checkbox"/>
<b>Dept:</b> Building	<b>Status:</b> Approved with Conditions	<b>Reviewer:</b> Tammy Munson	<b>Approval Date:</b> 10/21/2009
<b>Note:</b>			<b>Ok to Issue:</b> <input checked="" type="checkbox"/>
1) Signage Installation to comply with Chapters 31 & 32 of the IBC 2003 building code.			
<b>Dept:</b> Planning	<b>Status:</b> Approved with Conditions	<b>Reviewer:</b> Alex Jagerman	<b>Approval Date:</b> 10/19/2009
<b>Note:</b>			<b>Ok to Issue:</b> <input checked="" type="checkbox"/>
1) This permit is being issued with the condition that no additional pylon sign is allowed at the Rand Road entrance without approval from the planning division.			

<b>Comments:</b>
10/13/2009-amachado: Spoke to Jen at Barlo Signs. Told her that there were already three pylon signs and the ordinance only allows two with special criteria. Jen said that it was her understanding that Planning had approved it. I have sent an email to Barbara.
10/15/2009-amachado: Gave permit to Alex to sign off on.
10/19/2009-amachado: Permit #07-0103 was issued to put a pylon sign at the Rand Road entrance. This permit has expired and the sign was never installed. It is the understanding from the planning division that there will be no sign at the Rand Road entrance and this sign will be allowed on Brighton Ave. instead.

PERMIT ISSUED

OCT 19 2009

City of Portland

**BUILDING PERMIT INSPECTION PROCEDURES**

**Please call 874-8703 or 874-8693 (ONLY )**

**to schedule your inspections as agreed upon**

**Permits expire in 6 months, if the project is not started or ceases for 6 months.**

The Owner or their designee is required to notify the inspections office for the following inspections and provide adequate notice. Notice must be called in 48-72 hours in advance in order to schedule an inspection:

**By initializing at each inspection time, you are agreeing that you understand the inspection procedure and additional fees from a "Stop Work Order" and "Stop Work Order Release" will be incurred if the procedure is not followed as stated below.**

**A Pre-construction Meeting will take place upon receipt of your building permit.**

  X   **Final inspection required at completion of work.**

Certificate of Occupancy is not required for certain projects. Your inspector can advise you if your project requires a Certificate of Occupancy. All projects DO require a final inspection.

**If any of the inspections do not occur, the project cannot go on to the next phase, REGARDLESS OF THE NOTICE OR CIRCUMSTANCES.**

**CERIFICATE OF OCCUPANICES MUST BE ISSUED AND PAID FOR, BEFORE THE SPACE MAY BE OCCUPIED.**

\_\_\_\_\_  
Signature of Applicant/Designee

\_\_\_\_\_  
Date

\_\_\_\_\_  
Signature of Inspections Official

\_\_\_\_\_  
Date

**PERMIT ISSUED**

OCT 19 2009

City of Portland



# Signage/Awning Permit Application

If you or the property owner owes real estate or personal property taxes or user charges on any property within the City, payment arrangements must be made before permits of any kind are accepted.

Location/Address of Construction: <u>1100 BRIGHTON AVE</u>		
Tax Assessor's Chart, Block & Lot Chart#      Block#      Lot#	Owner: <u>NEW ENGLAND DEVELOPMENT PORTLAND PINE TREE LLC</u>	Telephone: <u>607-965-8700</u>
Lessee/Buyer's Name (If Applicable) <u>New England Development Portland Pine Tree LLC One Wells Ave Newton MA 02459</u>	Contractor name, address & telephone: <u>Barvo Signs 158 Greeley St Hudson MA 03051 800-227-5674(333)</u>	Total s.f. of signage x \$2.00 Per s.f. plus \$30.00/\$65.00 For H.D. signage= Total Fee: \$ <u>170-</u> Awning Fee= cost of work <u>---</u> Total Fee: \$ <u>170-</u>
Who should we contact when the permit is ready: <u>Jenn@Barvo</u> phone: <u>800-227-5674(333)333</u>		
Tenant/allocated building space frontage (feet): Length: _____ Height: _____ Lot Frontage (feet) _____ Single Tenant or <u>Multi Tenant Lot</u> _____		
Current Specific use: <u>Retail</u> If vacant, what was prior use: _____ Proposed Use: <u>New Sign</u>		
Information on proposed sign(s): Freestanding (e.g., pole) sign? Yes <input checked="" type="checkbox"/> No _____ Dimensions proposed: <u>89" x 112"</u> Height from grade: <u>16'</u> Bldg. wall sign? (attached to bldg) Yes _____ No _____ Dimensions proposed: _____		
Proposed awning? Yes _____ No <input checked="" type="checkbox"/> Is awning backlit? Yes _____ No _____ Height of awning: _____ Length of awning: _____ Depth: _____ Is there any communication, message, trademark or symbol on it? Yes _____ No _____ If yes, total s.f. of panels w/communications, message, trademark or symbol: _____ s.f.		
Information on existing and previously permitted sign(s): Freestanding (e.g., pole) sign? Yes _____ No _____ Dimensions: _____ Bldg. wall sign? (attached to bldg) Yes _____ No _____ Dimensions: _____ Awning? Yes _____ No _____ Sq. ft. area of awning w/communication: _____		
A site sketch and building sketch showing exactly where existing and new signage is located must be provided. Sketches and/or pictures of proposed signage and existing building are also required.		

Please submit all of the information outlined in the Sign/Awning Application Checklist.  
Failure to do so may result in the automatic denial of your permit.

In order to be sure the City fully understands the full scope of the project, the Planning and Development Department may request additional information prior to the issuance of a permit. For further information visit us on-line at [www.portlandmaine.gov](http://www.portlandmaine.gov), stop by the Building Inspections office, room 315 City Hall or call 874-8703.

I hereby certify that I am the Owner of record of the named property, or that the owner of record authorizes the proposed work and that I have been authorized by the owner to make this application as his/her authorized agent. I agree to conform to all applicable laws of this jurisdiction. In addition, if a permit for work described in this application is issued, I certify that the Code Official's authorized representative shall have the authority to enter all areas covered by this permit at any reasonable hour to enforce the provisions of the codes applicable to this permit.

Signature of applicant:	Date: <u>10-06-09</u>
-------------------------	-----------------------

This is not a permit; you may not commence ANY work until the permit is issued.



**JOB#:**

**SCOPE OF WORK - BARLOMEX**  
 MFG & SHIP ONE (1) D/F  
 NON-ILLUMINATED DIRECTORY SIGN

**SCOPE OF WORK - BARLO**  
 REC. & INST.

**SCOPE OF WORK - SIGM/SUB**

**GENERAL NOTES**  
 POSSIBLE LEDGE MAY BE  
 ENCOUNTERED

**COLORS**  
 SIGN  
 TENANT PANELS: WHITE W/  
 FINAL TENANT COPY BY OTHERS  
 STRUCTURE: PTM PWS WARM GRAY

**SIGN DISPOSITION**  
 ALL COLORS ARE FOR REPRESENTATION ONLY  
 SEE ACTUAL SAMPLES FOR COLOR MATCH.

**GENERAL INFO**  
 Qty: 1  
 Date: 6/22  
 S/W (D/F) (U/L) (Non-Ill)

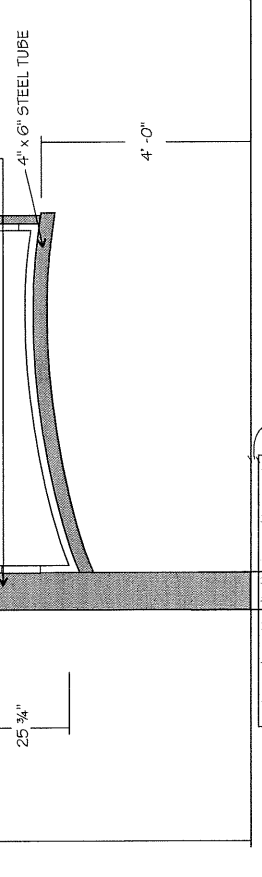
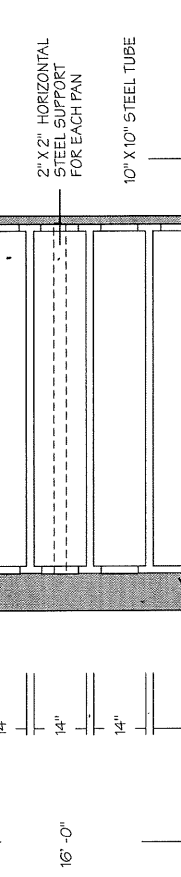
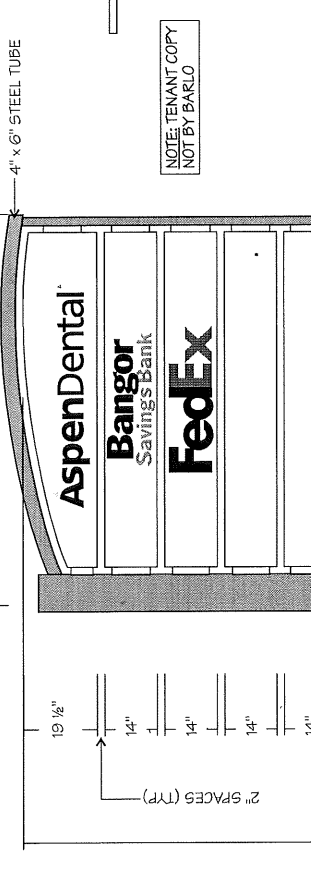
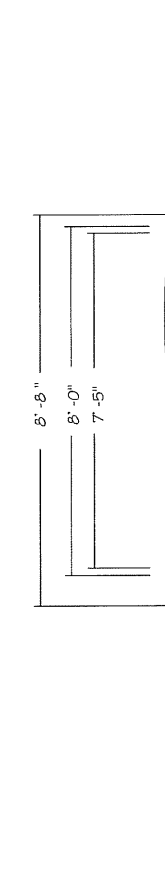
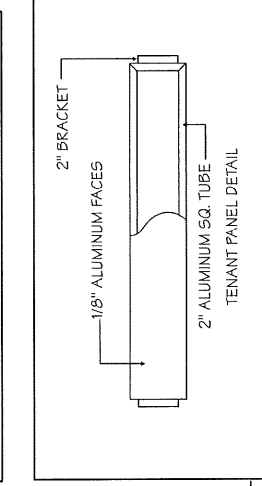
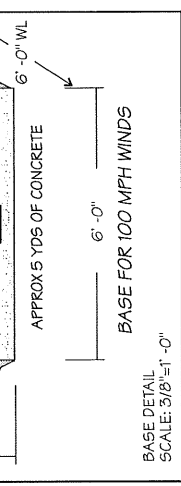
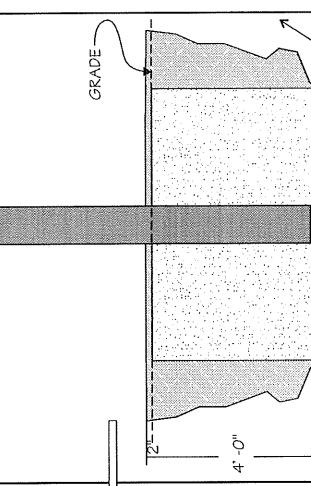
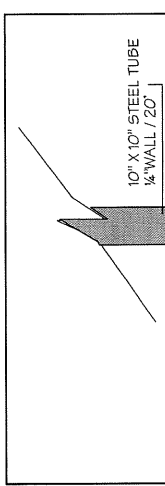

Size	Existing	Required
Length		
W. Thickness		
Stub Size		
Stub Length		
W. Thickness		

PLATE	W	L	Th
GUSSETS	W	L	Th
ANCHOR BOLTS	L	HBK	Dia

**MATERIAL OPTIONS & ESTIMATE**

Date	Comment
9/23	ADJUST PANEL SIZES
10/01	ADJUST DIMENSIONS

0-Art/Eng.	1-Pat/Vin.	2-Let. Fab.	3-Screen	4-Met. Fab.	5-Neon	6-Finish	7-Paint	8-Install	9-Misc.
Art/Ingeneria	Patentes/Vinyl	Letras Fabricacion	Pantalla	Fabricacion	Neon	Acabado	Pinura	Instalacion	Miscelaneas

**TIME SUMMARY**

Job Name:	Location:	Client:	Landlord:
PINE TREE SHOPPING CENTER	100 BRIGHTON AVE. PORTLAND, ME	Design Specifications Accepted By: DJR	10/5/09

**BARLO SIGNS**  
 158 Greeley St., Hudson, NH 03051  
 (603) 882-6538 Fax (603) 882-7880

File Name: PINE TREE 09092901 (J)  
**B-09-09-2901**  
 R-2 SHEET 1 OF 1

Exhibit "C"

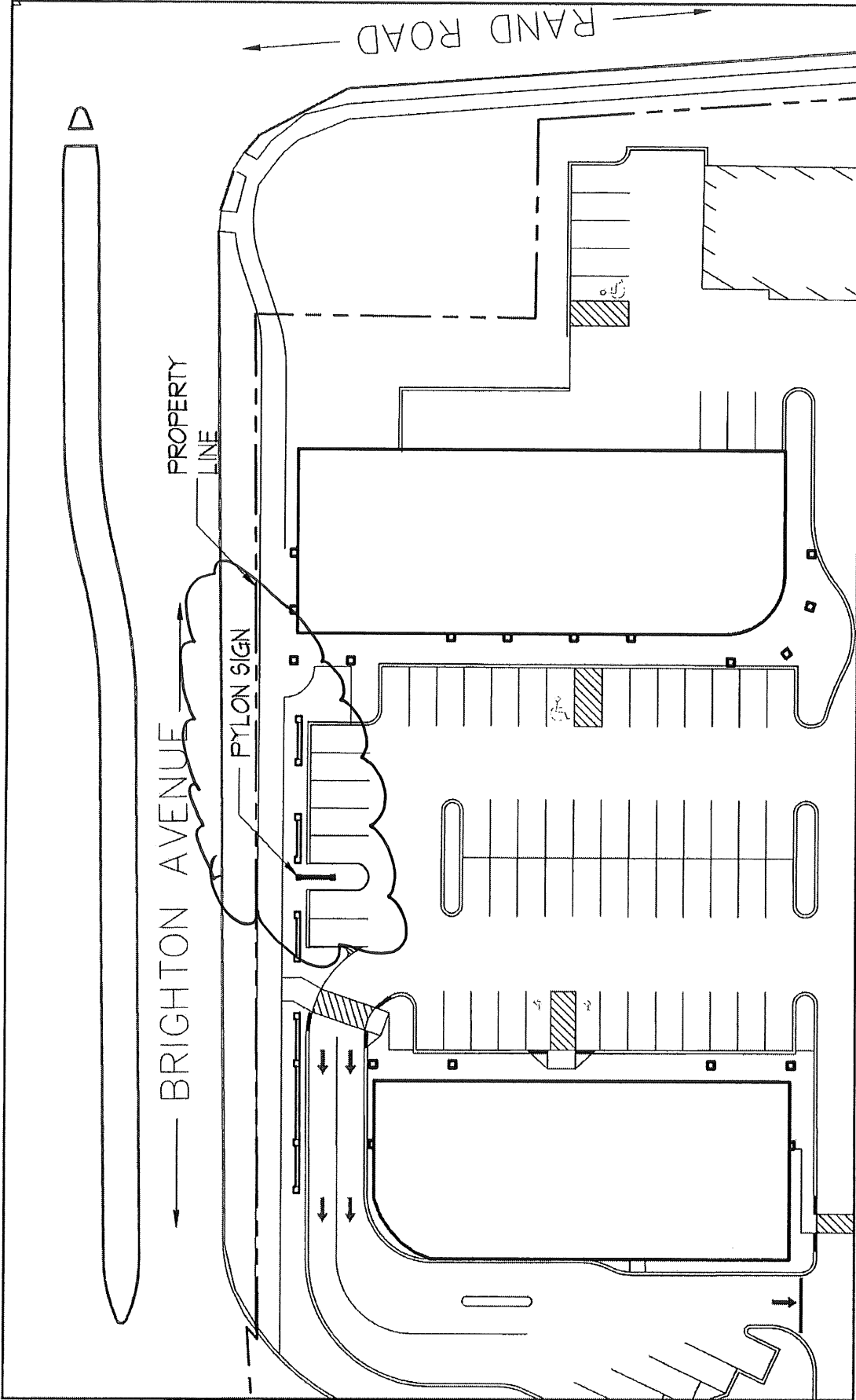

PINE TREE SHOPPING CENTER  
PYLON SIGN STUDY

SITE PLAN

**PACKARD**  
DEVELOPMENT

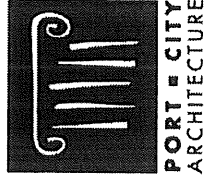

# Memo

Date: 10/6/2009

To: Portland Code/Planning and Zoning  
From: Jenn Robichaud  
Subject: 1100 Brighton St/ New England Development

Hello,

Enclosed pls find application for new signage for 1100 Brighton Ave. I am in the process of insuring an insurance certificate which I will forward ASAP.

If you have any questions or concerns, please don't hesitate to contact me,



Jenn Robichaud  
Barlo Signs  
jenn@barlosigns.com  
800 227 5674 x 333

158 Greeley St.  
Hudson NH 03051

**RECEIVED**  
OCT - 8 2009  
Dept of Building Inspection  
City of Portland/Maine

## **Ann Machado - Pylon Sign for 1056 Brighton**

---

**From:** Ann Machado  
**To:** Alex Jaegerman  
**Date:** 10/15/2009 2:13 PM  
**Subject:** Pylon Sign for 1056 Brighton

---

Alex -

I spoke to Barbara about this and she said to talk to you.

1056 Brighton Ave., the Aspen Denatal & Bangor Savings buldings at Pine Tree, have applied to put up a pylon sign on Brighton Ave. There is already a pylon sign on Brighton Ave at the main entrance. The sign ordinance only allows one pylon sign for each street that the shopping center fronts on.

On Feb. 9, 2007 a pylon sign was approved to go up on the Rand Road entrance for Lowes and the tenants in thes two buildings. This had to be approved by planning because there is already a pylon sign for Firestone Tire on Rand Road. My understanding from Barbara is that this pylon sign was never installed. She said that someone had spoken to you about installing a pylon sign in front of the two buildings on Brighton Ave., in lieu of installing the pylon sign on Rand Road.

Barlo Signs has applied to install the second pylon sign. Zoning can't sign off on it. Barbara said to give it to you for your approval. She aslo said that there should be a condition that there not be a pylon sign installed at the Rand Road entrance.

Please let me know if you have any questions. I have put the permit in your box in planning for your dsign off. Could you give it back to me when yuo have signed off?

I will not be in tomorrow, but I'll be in on Monday.

Ann

Date:	10/12/09	City, State:	Portland, ME	SHEET:	1 OF 6
Client:	Barlo Signs	Overall Height:	16'-6"	Sean M. McFarland, PE	
Sign:	Pine Tree Shopping	Wind Speed:	90 mph	McFarland Engineering	

<b>Sign Description</b>	<b>1100 Brighton Ave.</b>	<b>Table of Contents</b>
# Columns: 1	<b>Content:</b>	<b>Page</b>
ME Job: 09-16828	Design Loads. . . . .	1
Height: 12'-0"	Support Design. . . . .	1-2
Width: 8'-8"	Foundation Design / General Notes . . . . .	3-4
	Design Drawing. . . . .	5-6

**Structural Variables and Code Loading Specifications**

Cabinet Type:	Miscellaneous	Code:	2006 IBC
Structural Section:	Steel Pipe - 35000psi	Wind Speed:	90
Number of Zones:	4	Wind Exposure:	C

Wind Loads Per ASCE 7-05

OCT 12 2009

**Sign Sections:**

Zone	Cabinet Wt. Per Sq. Ft.	Weight Per Foot	Transition (Y or N)
1	15	32.6 #/FT	
2	15	32.6 #/FT	
3	15	32.6 #/FT	
4	0	32.6 #/FT	y
5	0		
6	0		
7	0		
8	0		

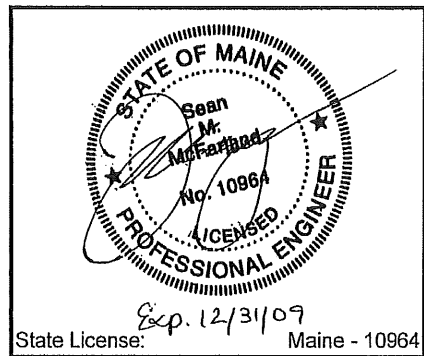

**Geometry:**

Zone	Top Elevation	Height	* Approx. Width	Pressure	Force	Approx. Weight
1	16.00 FT	0.75 FT	4.33 FT*	27.13 PSF	0.09 K	73 #
2	15.25 FT	1.00 FT	8.67 FT	26.89 PSF	0.23 K	163 #
3	14.25 FT	2.00 FT	5.75 FT	26.81 PSF	0.31 K	238 #
4	12.25 FT	12.25 FT	0.83 FT	20.11 PSF	0.20 K	400 #
5						
6						
7						
8						

Total Wind Force = 0.83 K 873 #

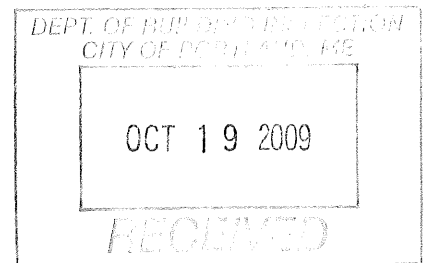

Sean M. McFarland, P.E. ♦ Phone (281) 813-7439  
5555 Fellowship Lane ♦ Spring, TX 77379

Date:	10/12/09	City, State:	Portland, ME	SHEET:	2 OF 6
Client:	Barlo Signs	Overall Height:	16'-6"	Sean M. McFarland, PE	
Sign:	Pine Tree Shopping	Wind Speed	90 mph	McFarland Engineering	

**Moments at Transitions:**

Zone	Lateral Force	Mom. Arm
1	0.09 K	15.63 FT
2	0.23 K	14.75 FT
3	0.31 K	13.25 FT
4	0.20 K	6.13 FT
5		
6		
7		
8		

10.2 K-FT

**Section Properties:** 5.27 IN<sup>3</sup>

**Structural Sections to be used:**

Zone	Option	Tube Dim.	Wall t.	Weight	Sxx	d/t	Sxx Req'd
4	Tube	10.00 IN	0.250 IN	33 #/FT	30.10 IN <sup>3</sup>	40.00	5.27 IN <sup>3</sup>

**Structure Required**

# Req'd	Size	Wall Thickness
1	10.00 IN	0.250 IN

Date: 10/12/09	City, State: Portland, ME	SHEET: 3 OF 6
Client: Barlo Signs	Overall Height: 16'-6"	Sean M. McFarland, PE
Sign: Pine Tree Shopping	Wind Speed: 90 mph	McFarland Engineering

**Block Footing**

**Pier Footing Design:**

Select the footing and soil type:

$$d = A / 2 * (1 + (1 + (4.36 * h) / A)^{1/2})$$

where  $A = (2.34 * P) / (S1 * b)$

Footing:	Square	▼
Vert. Soil Bearing (psf):	1500	▼
Lat. Soil Bearing (psf):	150	▼

Mmax = 10,153 #-FT  
 Pmax (Lateral) = 834 #  
 LSBP = 150 PCF  
 S1 = 400 PCF X d  
 b = 4.500 FT

*For use with Square or Rectangular Footing*

A = 0.77 FT<sup>2</sup>  
 h = 12.174 FT  
 d = 3.596 FT

USE: 4.50 FT. RND. X 4.00 FT DEEP FOOTING (BLOCK)

**Soil Bearing Check:**

DLmax = 873 LBS  
 Area of Footing = 20.25 FT<sup>2</sup>  
 Actural SBP = 43 PSF  
 Allowable SBP = 900 PSF (Includes code allowed 20% increase for every foot of footing below 12" into natural grade.)

---

43 PSF < 900 PSF THEREFORE OK

**General Notes**

- 1 Contractor shall verify all dimensions and conditions on job site
- 2 Structural steel pipe shall conform to ASTM A53 grade B type E or S, Fy=35 ksi min.
- 3 Structural steel tube shall conform to ASTM A500 grade B, Fy=46 ksi min.
- 4 Structural steel shapes and plates shall conform to ASTM A36.
- 5 Welding shall conform to AISC specs or local codes and performed by certified welder using arc process E70XX electrodes.
- 6 Isolate Aluminum from Steel
- 7 All bolt holes to be drilled or punched.
- 8 2500 psi (min) 28-day Concrete Compressive Strength
- 9 All electrical work to conform to the requirements of UL48 and section 600 of NEC.
- 10 UL and Data labels required
- 11 Sign to be a minimum of 6-ft horizontal & 12-ft vertical from high voltage wires.
- 12 If there is no stub pipe to be used in the top cabinet, the supporting member immediately below the stub pipe shown can be extended to the top of the uppermost cabinet.
- 13 All Pipe sizes shown are minimum sizes. Pipe with a larger diameter and/or greater Sxx may be substituted
- 14 All structural lengths required are approximations only. Actual length may vary slightly depending on sign cabinet conditions.

Date:	10/12/09	City, State:	Portland, ME	SHEET:	4 OF 6
Client:	Barlo Signs	Overall Height:	16'-6"		Sean M. McFarland, PE
Sign:	Pine Tree Shopping	Wind Speed	90 mph		McFarland Engineering

**SPREAD FOOTING DESIGN**                      One Spread Footing

<b>Loads:</b>	P(DL) =	1,747 #	
	P(LL) =	0 #	
	M(WL) =	20,305 FT-#	
<b>Footing:</b>	CONCRETE	WIDTH =	6.50 FT
		LENGTH =	6.50 FT
		DEPTH =	2.00 FT
		WEIGHT =	12,675 LBS
	SURCHARGE PEDESTAL =	6.50 FT X	
		6.50 FT X	
		0.50 FT (6" Soil Surcharge)	
	WEIGHT =	2,324 LBS	
<b>Overturning:</b>	OTM =	20,305 FT-LBS	
	RM =	54,423 FT-LBS	
	FS =	2.680	>1.5 THEREFORE OK
<b>Soil Pressure:</b>	q(DL+LL) =	41.34 PSF	NET
	q(ALLOW) =	1500 PSF	OK
	FOR DL+WL:		
	e=M/P =	1.21 FT	
	L/6 =	1.08 FT	(Resultant Outside Middle 3rd)
	q(DL+WL) =	487.97 PSF	NET
	q(ALLOW)=	2000 PSF	OK
<b>Reinforcing:</b>	M(DL+LL)=	218 FT-LBS/FT	
	0.75 * M(DL+WL)=	1,356 FT-LBS/FT	DL+WL CONTROLS
	DL+WL CONTROLS		
	ASSUME: f <sub>c</sub> =3000 PSI, F <sub>y</sub> =40000 PSI (minimal)		
	d=	20.63 IN	
	As(REQ'D)=	0.05 IN <sup>2</sup>	
	As(PROV.)=	0.20 IN <sup>2</sup>	
	USE #5's AT 12"O.C. T&B, EACH WAY		
<b>Check Concrete Volume:</b>			
	3.13 Cubic Yards		
<b>Depth Check for Direct Burial:</b>			
	h= (6 M / .35 f <sub>c</sub> b) <sup>1/2</sup>		
M = Max Moment			
b = Diam. Of Base Pipe	b=	10.00 IN	
f <sub>c</sub> = Minimal Concrete Strengt	f <sub>c</sub> =	2500 PSI	
h = Minimal Embedment Deptl of Steel pipe	h=	1.08 FT	
	REQUIRED h <	2.00 FT	DEPTH THEREFORE OK



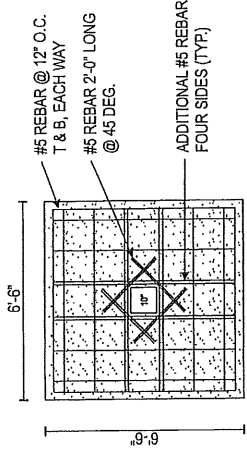

FOUNDATION PLAN VIEW SCALE: 1/4"=1'-0"

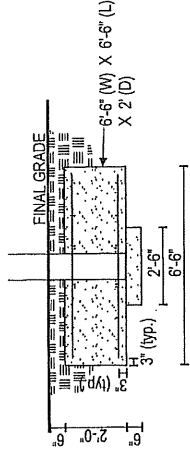

FOUNDATION SECTION SCALE: 1/4"=1'-0"

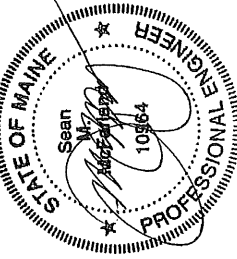
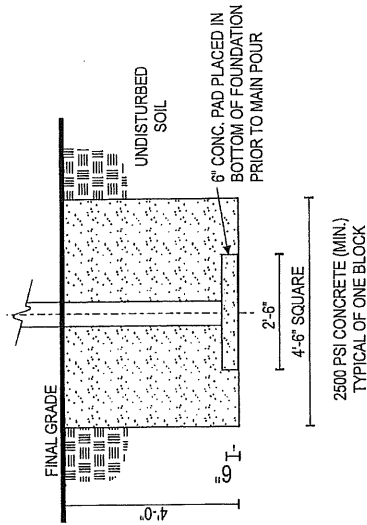

OCT 17 2009

McFarland Engineering  
 Texas Firm Registration: F-5686  
 Maine License Number: 10864  
 Maine Expiration Date: 12/31/2009

Pay careful attention to all text boxes with light grey shaded backgrounds. These text boxes contain important engineering information.

Sheet 6 of 6  
 ME #09-16829  
 10/12/2009

<b>BARLO SIGNS</b>	
156 Greeley St., Hudson, NH 03051 (603) 882-2638 Fax (603) 882-7680	
File Name: PINE TREE 09092901 (J)	
Job Name: PINE TREE SHOPPING CENTER	Location: 1100 BRIGHTON AVE. PORTLAND, ME
Design Specifications Accepted By: [Signature]	Drawn By: DJR
Client: [Signature]	Sales Rep: PK
Landlord: [Signature]	Date: 10/15/09
© COPYRIGHT 2009 THE BARLO GROUP <small>THIS DESIGN IS THE PROPERTY OF THE BARLO GROUP. ALL PROVISIONS AND SPECIFICATIONS ARE SUBJECT TO THE BARLO GROUP'S STANDARD TERMS AND CONDITIONS AS CONTAINED IN AIF PROJECT. THE USER ASSUMES FULL RESPONSIBILITY FOR THE USE OF THIS DESIGN FOR ANY PURPOSES OTHER THAN THAT FOR WHICH IT WAS DESIGNED BY THE BARLO GROUP.</small>	

**- PROPERTY OWNER AUTHORIZATION -  
MUST BE SIGNED BY OWNER OF PROPERTY**

(This shows the town that you are authorizing Barlo Signs to submit an application for permits ON BEHALF OF the owner of the property.)

As owner of 1100 Brighton Avenue, Portland, ME  
*Agent* (Fill in Property Address)

I hereby authorize Jennifer Robichaud or \_\_\_\_\_, as an authorized representative of Barlo Signs of Hudson, N.H., to APPLY FOR SIGN PERMITS for this site.

Owner's <sup>AGENT</sup> Signature: *[Handwritten Signature]*

Printed Name: Howard J. Mintz c/o New England Development

Address: One Wells Ave  
Newton MA 02459  
Portland Pine Tree LLC

Phone#: 617-965-8700

As owner of \_\_\_\_\_  
(Fill in Property Address)

I hereby authorize Jenn Robichaud or Authorized Representative of Barlo Signs of Hudson, N.H., to APPEAR BEFORE THE PLANNING BOARD and/or SIGN REVIEW BOARD and/or the ZBA for this site.

Owner's Signature: \_\_\_\_\_

Printed Name: \_\_\_\_\_

Address: \_\_\_\_\_  
\_\_\_\_\_  
\_\_\_\_\_

Phone#: \_\_\_\_\_

***We cannot apply for permits or hearings until we receive your authorization.***

Please FAX this completed & signed form to 603-882-7680, attn: Jenn L and MAIL ORIGINAL to Barlo Signs, 158 Greeley Street, Hudson, NH 03051.

If you have any questions, please call me at 1-800-227-5674 ext. 341 THANK YOU! Date: October 6, 2009

Reference JOB NAME: Pine Tree Shopping Center Job No: Q2901

**ACORD™ CERTIFICATE OF LIABILITY INSURANCE** DATE (MM/DD/YYYY)  
10/8/2009

PRODUCER (617)330-5700 FAX: (617)439-3752  
Risk Strategies Company  
160 Federal Street

THIS CERTIFICATE IS ISSUED AS A MATTER OF INFORMATION ONLY AND CONFERS NO RIGHTS UPON THE CERTIFICATE HOLDER. THIS CERTIFICATE DOES NOT AMEND, EXTEND OR ALTER THE COVERAGE AFFORDED BY THE POLICIES BELOW.

Boston MA 02110

INSURERS AFFORDING COVERAGE NAIC #

INSURED  
Portland Pine Tree LLC  
c/o New England Development, LLC  
One Wells Avenue, 4th Floor  
Newton MA 02459

INSURER A: ACE USA  
INSURER B:  
INSURER C:  
INSURER D:  
INSURER E:

**COVERAGES**

THE POLICIES OF INSURANCE LISTED BELOW HAVE BEEN ISSUED TO THE INSURED NAMED ABOVE FOR THE POLICY PERIOD INDICATED. NOTWITHSTANDING ANY REQUIREMENT, TERM OR CONDITION OF ANY CONTRACT OR OTHER DOCUMENT WITH RESPECT TO WHICH THIS CERTIFICATE MAY BE ISSUED OR MAY PERTAIN, THE INSURANCE AFFORDED BY THE POLICIES DESCRIBED HEREIN IS SUBJECT TO ALL THE TERMS, EXCLUSIONS AND CONDITIONS OF SUCH POLICIES. AGGREGATE LIMITS SHOWN MAY HAVE BEEN REDUCED BY PAID CLAIMS.

INSR	ADD'L LTR	INSRD	TYPE OF INSURANCE	POLICY NUMBER	POLICY EFFECTIVE DATE (MM/DD/YY)	POLICY EXPIRATION DATE (MM/DD/YY)	LIMITS
A			GENERAL LIABILITY	PMIG24651575	11/1/2008	11/1/2009	EACH OCCURRENCE \$ 1,000,000
			<input checked="" type="checkbox"/> COMMERCIAL GENERAL LIABILITY <input type="checkbox"/> CLAIMS MADE <input checked="" type="checkbox"/> OCCUR <input checked="" type="checkbox"/> Includes Liquor Liability GEN'L AGGREGATE LIMIT APPLIES PER: <input checked="" type="checkbox"/> POLICY <input type="checkbox"/> PRO-JECT <input type="checkbox"/> LOC				DAMAGE TO RENTED PREMISES (Ea occurrence) \$ 1,000,000 MED EXP (Any one person) \$ 2,500 PERSONAL & ADV INJURY \$ 1,000,000 GENERAL AGGREGATE \$ 2,000,000 PRODUCTS - COMP/OP AGG \$ 2,000,000 Employee Benefits 1,000,000
			AUTOMOBILE LIABILITY				COMBINED SINGLE LIMIT (Ea accident) \$ BODILY INJURY (Per person) \$ BODILY INJURY (Per accident) \$ PROPERTY DAMAGE (Per accident) \$
			GARAGE LIABILITY				AUTO ONLY - EA ACCIDENT \$ OTHER THAN EA ACC \$ AUTO ONLY: AGG \$
			EXCESS/UMBRELLA LIABILITY				EACH OCCURRENCE \$ AGGREGATE \$ \$ \$ \$
			WORKERS COMPENSATION AND EMPLOYERS' LIABILITY				WC STATU-TORY LIMITS OTH-ER E.L. EACH ACCIDENT \$ E.L. DISEASE - EA EMPLOYEE \$ E.L. DISEASE - POLICY LIMIT \$
			OTHER				

DESCRIPTION OF OPERATIONS/LOCATIONS/VEHICLES/EXCLUSIONS ADDED BY ENDORSEMENT/SPECIAL PROVISIONS  
 Issued as Evidence of Insurance. The City of Portland is included as Additional Insured in relation to signs being installed at Pine Tree Shopping Center, Brighton Avenue, Portland, ME 04102.

**CERTIFICATE HOLDER**  
  
 City of Portland  
 Attn: Building Department  
 389 Congress Street  
 Portland, ME 04101

**CANCELLATION**  
  
 SHOULD ANY OF THE ABOVE DESCRIBED POLICIES BE CANCELLED BEFORE THE EXPIRATION DATE THEREOF, THE ISSUING INSURER WILL ENDEAVOR TO MAIL 30 DAYS WRITTEN NOTICE TO THE CERTIFICATE HOLDER NAMED TO THE LEFT, BUT FAILURE TO DO SO SHALL IMPOSE NO OBLIGATION OR LIABILITY OF ANY KIND UPON THE INSURER, ITS AGENTS OR REPRESENTATIVES.  
  
 AUTHORIZED REPRESENTATIVE  
 Michael Christian/HE *Michael Christian*