

JOHN T. BRENNAN & ASSOCIATES  
ARCHITECTS  
PO Box 4285, Windham, NH 03087  
PHONE: 603-893-4693 FAX: 603-894-5548  
EMAIL: jtbrennan@jtbrennan.com

APPLICANT/TENANT  
SULLIVAN TIRE OF MAINE, LLC  
41 ACCORD PARK DRIVE  
NORWELL, MA 02061  
PHONE: 781-982-1550

LIFE SAFETY PLAN

DATE: NOV 19, 2012  
SCALE: 1/4"=1'-0"

BUILDING RENOVATION  
**SULLIVAN TIRE**  
RETAIL CENTER  
1100 BRIGHTON AVE., PORTLAND, ME

F1

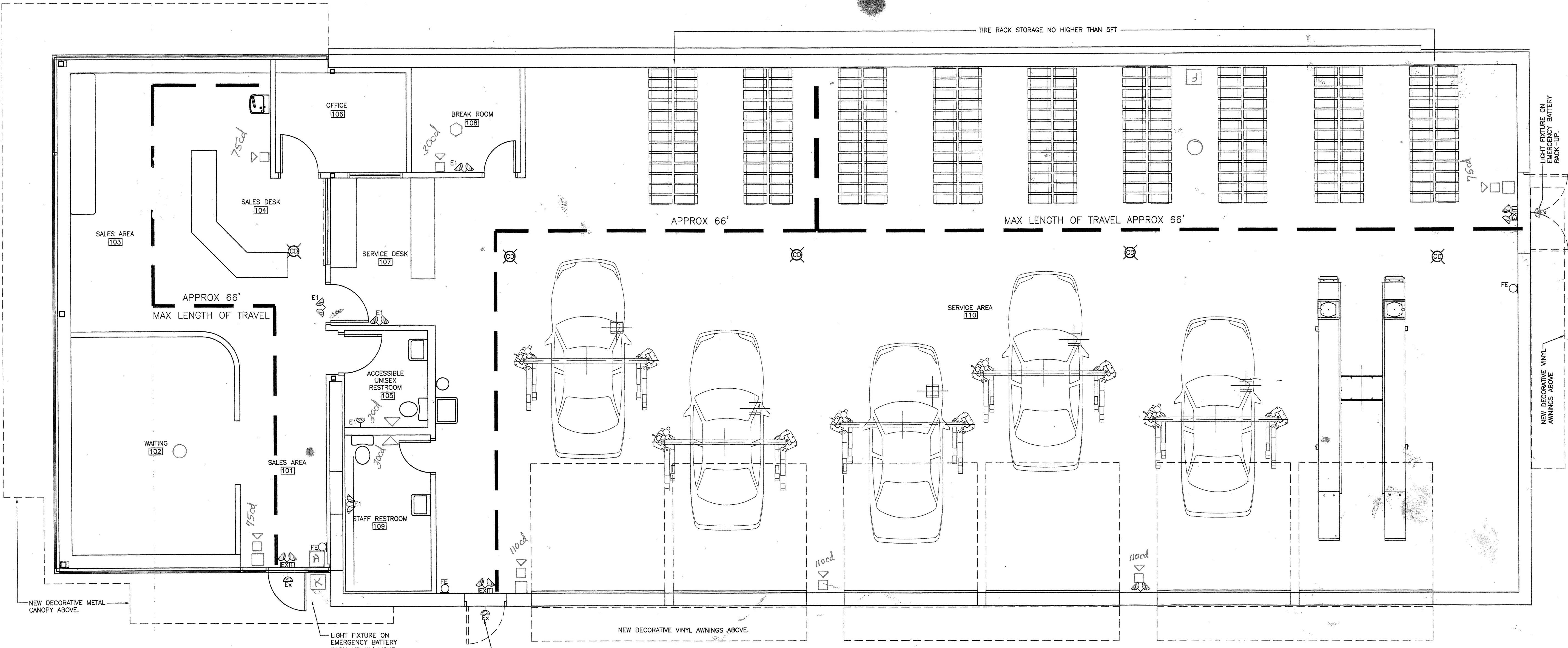

REFLECTED CEILING PLAN

- Heat Detector
- Ⓚ Knop Box
- ⓐ Annunciator
- ⓔ Fire Alarm Panel
- Smoke Detector
- Pull Station
- ◁ strobe only
- ◁◁ horn/strobe

**EMERGENCY FIXTURE LEGEND**

	CEILING MTD STROBE/FIRE ALARM. CONTRACTOR TO CONFIRM LOCATION WITH CODE REQUIREMENTS AND LOCAL FIRE DEPT.
	LED EMERGENCY EXIT FIXTURE. WALL/CEILING MOUNT AS APPROPRIATE.
	COMBINATION EMERGENCY LIGHT FIXTURE AND EXIT FIXTURE ON REMOTE BATTERY BACKUP.
	WALL MTD EMERGENCY LIGHTING, 7'-6" AFF W/REMOTE BATTERY UNIT.
	WALL MOUNTED TV RECEPTACLE. CONFIRM HEIGHT/LOCATION W/ OWNER. INCLUDE APPROPRIATE POWER SERVICE.
	WALL MTD EXTERIOR EMERGENCY LIGHTING W/REMOTE BATTERY UNIT.
	CARBON MONOXIDE DETECTOR MOUNTED FROM ROOF FRAME OR SUSPENDED CEILING AS APPROPRIATE.
	CHEMICAL FIRE EXTINGUISHER

**PORTLAND FIRE DEPARTMENT REQUIREMENTS**

Name /Address & Phone Number of Applicant & Project Architect: See Title, this sheet.

Proposed Use of Structure: See Code Review, this sheet.

Square footage of proposed Structure: 4,798sf

Existing and Proposed Fire Protection of structure:  
Existing, no Fire Protection except fire extinguishers are present.  
Proposed: No additional protection required. See Code review this sheet.

Separate Plans Shall be submitted for Fire Protection System: N/A

A separate Life Safety Plan must include: (This Sheet)  
a) Fire Resistance rating of all means of egress. N/A  
b) Travel Distance from most remote point to exit discharge: 66ft (See plan this sheet)  
c) Location of any required Fire extinguishers: See plan this sheet.  
d) Location of emergency lighting: See plan this sheet.  
e) Location of exit signs: See Plan this sheet  
f) NFPA 101 Code Summary: See Code review this sheet.

**CODE REVIEW:**

**Applicable Codes:**  
Building: International Building Code 2009  
Plumbing: The Maine State Plumbing Code 10-144 CMR 238  
Electrical: NFPA/NEC 70 - National Electrical Code  
Energy: Uniform Energy Code, 2009  
International Mechanical Code, 2009  
Accessibility: ICC/ANSI A117.1-2003  
NFPA 30A, 2008 - Motor Fuel Dispensing Facilities & Repair Garages.

**NFPA 101, 2009 LIFE SAFETY CODE**  
PROPOSED USE OF STRUCTURE: SPECIAL-PURPOSE INDUSTRIAL OCCUPANCY PER NFPA 101 SECTION 40.1.4.1.2 (1) & NFPA 30A, SECTION 7.4.1.  
MOST RESTRICTIVE USE GROUP = S1 "STORAGE GROUP" MOTOR VEHICLE REPAIR GARAGES, PER IBC SECTION 311.2.

PROPOSED OCCUPANCY IS A CONTINUATION OF THE EXISTING OCCUPANCY, VEHICLE REPAIR GARAGE. USE CLASSIFICATION "INDUSTRIAL" PER NFPA 101 SECTION 40.1.1.2. W/ INCIDENTAL MERCANTILE USE PER SECTION 6.1.14.1.3. MERCANTILE USE IS PERMITTED TO BE CONSIDERED PART OF THE PREDOMINANT OCCUPANCY, "INDUSTRIAL". NO FIRE SEPARATION REQUIRED BETWEEN MIXED OCCUPANCIES.

NO AUTOMATIC SPRINKLER PROTECTION SYSTEM REQUIRED PER NFPA 30A-7.4.6 (2) ONE STORY BUILDING LESS THAN 12,000SF.

NO FIRE ALARM SYSTEM REQUIRED PER NFPA 101 SECTION 40.3.4.1. TOTAL BUILDING OCCUPANCY LESS THAN 100.

BUILDING CONSTRUCTION TYPE IIB PER IBC 602.2 & 603.1 AND TABLE 601.  
EXTERIOR WALL FIRE-RESISTANCE RATING = 0. PER IBC TABLE 602.

MAX INDUSTRIAL TRAVEL DISTANCE IS 300FT PER NFPA 101 TABLE 40.2.6  
MAX MERCANTILE TRAVEL DISTANCE IS 150FT PER SECTION 37.2.6.1. ACTUAL MAXIMUM DISTANCE IS 66FT IN BOTH THE MERCANTILE AND INDUSTRIAL SPACES.

ONLY ONE EXIT REQUIRED FOR EXISTING MERCANTILE AREA PER NFPA SECTION 37.2.4.3. MAX DISTANCE TO EXIT EGRESS IS LESS THAN 75FT. CLASS C, MERCANTILE USE, MERCANTILE AREA LESS THAN 3000 SF PER SECTION 37.1.4.2.1(3).

BUILDING IS ACCESSIBLE PER ICC/ANSI A117.1-2003  
2 EXITS REQUIRED PER IBC SECTION 1015.1.1 AND TABLE 1015.1  
EXIT SIGNS IDENTIFYING MEANS OF EGRESS PER IBC SECTION 1011  
EMERGENCY LIGHTING REQUIRED AT EXTERIOR EXIT EGRESS ADJACENT TO EXIT DOORS PER IBC 1006.3.5