

DISPLAY THIS CARD ON PRINCIPAL FRONTAGE OF WORK

CITY OF PORTLAND

BUILDING INSPECTION

PERMIT

Please Read
Application And
Notes, If Any,
Attached

Permit Number: 081043

PERMIT ISSUED

This is to certify that CENTRO HERITAGE SPECIALTY LLC /Burr Signs
has permission to Big Lots One 17"x120" Pole Sign and 9'x12' Bldg Wall Sign

AT 1064 BRIGHTON AVE 263A A005001

provided that the person or persons who apply for and accept this permit shall comply with all of the provisions of the Statutes of Maine and of the Ordinances of the City of Portland regulating the construction, maintenance and use of buildings and structures, and of the application on file in this department.

Apply to Public Works for street line and grade if nature of work requires such information.

Notification of inspection must be given and when permission is procured before this building or part thereof is occupied or service is closed-in. 4 HOUR NOTICE REQUIRED.

A certificate of occupancy must be procured by owner before this building or part thereof is occupied.

OTHER REQUIRED APPROVALS

Fire Dept. _____
Health Dept. _____
Appeal Board _____
Other _____

Department Name

Director - Building & Inspection Services

PENALTY FOR REMOVING THIS CARD

City of Portland, Maine - Building or Use Permit Application

389 Congress Street, 04101 Tel: (207) 874-8703, Fax: (207) 874-8716

| | | | | | | | |
|---|--|---|--|---|--|---|--|
| Permit No: 08-1043 | | Issue Date: | | CBL: 263A A005001 | | | |
| Location of Construction: 1064 BRIGHTON AVE | | Owner Name: CENTRO HERITAGE SPE 4 LLC | | Owner Address: 131 DARTMOUTH ST | | | |
| Business Name: | | Contractor Name: Burr Signs | | Phone: 617-247-2200 | | | |
| Contractor Address: 50 DownEast Drive Yarmouth | | Phone: 2077991183 | | | | | |
| Lessee/Buyer's Name | | Phone: | | Permit Type: Signs - Permanent | | | |
| | | | | Zone: B-2 | | | |
| Past Use: Commercial/Retail Big Lots | | Proposed Use: Commercial/Retail - Big Lots One 17"x120" Pole Panel Sign, One 9'7"x14" Bldg Wall Sign | | Permit Fee: \$342.00 | | | |
| | | | | Cost of Work: \$0.00 | | | |
| | | | | CEO District: 3 | | | |
| Proposed Project Description: Big Lots One 17"x120" Pole Panel Sign, One 9'7"x14" Bldg Wall Sign | | FIRE DEPT: <input type="checkbox"/> Approved <input checked="" type="checkbox"/> Denied Signature: <i>[Signature]</i> | | INSPECTION: Use Group: <i>U</i> Type: <i>Sign</i> <i>IBC 2003</i> Signature: <i>[Signature]</i> | | | |
| | | PEDESTRIAN ACTIVITIES DISTRICT (P.A.D.) Action: <input type="checkbox"/> Approved <input type="checkbox"/> Approved w/Conditions <input checked="" type="checkbox"/> Denied Signature: _____ Date: _____ | | | | | |
| Permit Taken By: lmd | | Date Applied For: 08/19/2008 | | Zoning Approval | | | |
| <ol style="list-style-type: none">This permit application does not preclude the Applicant(s) from meeting applicable State and Federal Rules.Building permits do not include plumbing, septic or electrical work.Building permits are void if work is not started within six (6) months of the date of issuance. False information may invalidate a building permit and stop all work. <div style="border: 1px solid black; padding: 5px; text-align: center;">CITY OF PORTLAND</div> | | Special Zone or Reviews <input type="checkbox"/> Shoreland <input type="checkbox"/> Wetland <input type="checkbox"/> Flood Zone <input type="checkbox"/> Subdivision <input type="checkbox"/> Site Plan Maj <input type="checkbox"/> Minor <input type="checkbox"/> MM <input type="checkbox"/> Date: <i>8/28/08</i> <i>[Signature]</i> | | Zoning Appeal <input type="checkbox"/> Variance <input type="checkbox"/> Miscellaneous <input type="checkbox"/> Conditional Use <input type="checkbox"/> Interpretation <input type="checkbox"/> Approved <input type="checkbox"/> Denied Date: _____ | | Historic Preservation <input checked="" type="checkbox"/> Not in District or Landmark <input type="checkbox"/> Does Not Require Review <input type="checkbox"/> Requires Review <input type="checkbox"/> Approved <input type="checkbox"/> Approved w/Conditions <input type="checkbox"/> Denied Date: <i>[Signature]</i> | |

CERTIFICATION

I hereby certify that I am the owner of record of the named property, or that the proposed work is authorized by the owner of record and that I have been authorized by the owner to make this application as his authorized agent and I agree to conform to all applicable laws of this jurisdiction. In addition, if a permit for work described in the application is issued, I certify that the code official's authorized representative shall have the authority to enter all areas covered by such permit at any reasonable hour to enforce the provision of the code(s) applicable to such permit.

SIGNATURE OF APPLICANT

ADDRESS

DATE

PHONE

RESPONSIBLE PERSON IN CHARGE OF WORK, TITLE

DATE

PHONE

City of Portland, Maine - Building or Use Permit

389 Congress Street, 04101 Tel: (207) 874-8703, Fax: (207) 874-8716

| | | | | | |
|--|--|---|--|---|--|
| Permit No: 08-1043 | | Date Applied For: 08/19/2008 | | CBL: 263A A005001 | |
| Location of Construction: 1064 BRIGHTON AVE | | Owner Name: CENTRO HERITAGE SPE 4 LLC | | Owner Address: 131 DARTMOUTH ST | |
| Business Name: | | Contractor Name: Burr Signs | | Phone: 617-247-2200 | |
| Contractor Address: 50 DownEast Drive Yarmouth | | Phone (207) 799-1183 | | | |
| Lessee/Buyer's Name | | Phone: | | Permit Type: Signs - Permanent | |
| Proposed Use: Commercial/Retail - Big Lots One 17"x120" Pole Panel Sign, One 9'7"x14' Bldg Wall Sign | | | Proposed Project Description: Big Lots One 17"x120" Pole Panel Sign, One 9'7"x14' Bldg Wall Sign | | |
| Dept: Zoning | | Status: Approved | | Reviewer: Ann Machado | |
| Note: | | | | Approval Date: 08/28/2008 | |
| | | | | Ok to Issue: <input checked="" type="checkbox"/> | |
| Dept: Building | | Status: Approved with Conditions | | Reviewer: Tammy Munson | |
| Note: | | | | Approval Date: 09/03/2008 | |
| | | | | Ok to Issue: <input checked="" type="checkbox"/> | |
| 1) Signage Installation to comply with Chapter 31 of the IBC 2003 building code. | | | | | |



Signage/Awning Permit Application

If you or the property owner owes real estate or personal property taxes or user charges on any property within the City, payment arrangements must be made before permits of any kind are accepted.

| | | |
|---|--|--|
| Location/Address of Construction: <u>1100 BRIGHTON AVE</u> ^{AUG 13 2008} | | |
| Tax Assessor's Chart, Block & Lot Chart# Block# Lot# | Owner: <u>CENTRO PROPERTIES GROUP</u> | Telephone: <u>617-247-2200</u> |
| Lessee/Buyer's Name (If Applicable) <u>BIG LOTS</u> <u>2634 ADOES</u> | Contractor name, address & telephone: <u>BURR SIGNS</u> <u>50 DOWNEAST DR</u> <u>YARMOUTH, ME</u> <u>04096</u> | Total s.f. of signage x \$2.00 Per s.f. plus \$30.00/\$65.00 For H.D. signage= Total Fee: <u>\$342.00</u> Awning Fee= cost of work _____ Total Fee: <u>\$342.00</u> |
| Who should we contact when the permit is ready: <u>RAUDY BURR</u> phone: <u>846-7622</u> | | |
| Tenant/allocated building space frontage (feet): Length: <u>191'-4"</u> Height: <u>20'</u> Lot Frontage (feet) <u>7500</u> Single Tenant or Multi Tenant Lot <u>11</u> | | |
| Current Specific use: <u>VACANT</u> If vacant, what was prior use: <u>RETAIL</u> Proposed Use: <u>RETAIL</u> | | |
| Information on proposed sign(s): <u>TENANT PANELS ONLY</u> Freestanding (e.g., pole) sign? Yes <input checked="" type="checkbox"/> No <input type="checkbox"/> Dimensions proposed: <u>17" x 120"</u> Height from grade: _____ Bldg. wall sign? (attached to bldg) Yes <input checked="" type="checkbox"/> No <input type="checkbox"/> Dimensions proposed: <u>9'-7" x 14'-10"</u> | | |
| Proposed awning? Yes <input type="checkbox"/> No <input checked="" type="checkbox"/> Is awning backlit? Yes <input type="checkbox"/> No <input type="checkbox"/> Height of awning: _____ Length of awning: _____ Depth: _____ Is there any communication, message, trademark or symbol on it? Yes <input type="checkbox"/> No <input type="checkbox"/> If yes, total s.f. of panels w/communications, message, trademark or symbol: _____ s.f. | | |
| Information on existing and previously permitted sign(s): Freestanding (e.g., pole) sign? Yes <input type="checkbox"/> No <input checked="" type="checkbox"/> Dimensions: _____ Bldg. wall sign? (attached to bldg) Yes <input type="checkbox"/> No <input checked="" type="checkbox"/> Dimensions: _____ Awning? Yes <input type="checkbox"/> No <input checked="" type="checkbox"/> Sq. ft. area of awning w/communication: _____ | | |
| A site sketch and building sketch showing exactly where existing and new signage is located must be provided. Sketches and/or pictures of proposed signage and existing building are also required. | | |

Please submit all of the information outlined in the Sign/Awning Application Checklist.
Failure to do so may result in the automatic denial of your permit.

In order to be sure the City fully understands the full scope of the project, the Planning and Development Department may request additional information prior to the issuance of a permit. For further information visit us on-line at www.portlandmaine.gov, stop by the Building Inspections office, room 315 City Hall or call 874-8703.

I hereby certify that I am the Owner of record of the named property, or that the owner of record authorizes the proposed work and that I have been authorized by the owner to make this application as his/her authorized agent. I agree to conform to all applicable laws of this jurisdiction. In addition, if a permit for work described in this application is issued, I certify that the Code Official's authorized representative shall have the authority to enter all areas covered by this permit at any reasonable hour to enforce the provisions of the codes applicable to this permit.

Signature of applicant: [Signature]

Date: 08/14/08

B2 - mlt-h-kmt.

This is not a permit; you may not commence ANY work until the permit is issued.

SIGNAGE/AWNING PRE-APPLICATION QUESTIONNAIRE

PLEASE ANSWER ALL QUESTIONS

ADDRESS: 1100 BRIGHTON AVE ZONE: B-2

CBL: _____

SINGLE TENANT LOT? YES _____ NO X MULTI TENANT LOT? YES X NO _____

MORE THAN ONE SIGN TOTAL WITH PROPOSED SIGN? YES X NO _____

INFORMATION ON PROPOSED SIGN(S):

FREESTANDING (e.g., pole) SIGN? YES X NO _____ DIMENSIONS PROPOSED: 17" x 120" 14.2 ft

BLDG. WALL SIGN? (attached to bldg) YES X NO _____ DIMENSIONS PROPOSED: 9'-7" x 14'-10" 142 ft

INFORMATION ON ALREADY EXISTING AND PERMITTED SIGN(S):

FREESTANDING (e.g., pole) SIGN? YES _____ NO X DIMENSIONS: _____

BLDG. WALL SIGN(attached to bldg) ? YES _____ NO X DIMENSIONS: _____

AWNING? YES _____ NO X DIMENSIONS: _____

LOT FRONTAGE (FEET): 7500

TENANT/ALLOCATED BUILDING SPACE FRONTAGE (FEET): 141'-4"

AWNING YES _____ NO X IS AWNING BACKLIT? YES _____ NO _____

HEIGHT OF AWNING: _____ LENGTH OF AWNING: _____ DEPTH: _____

IS THERE ANY COMMUNICATION, MESSAGE, TRADEMARK OR SYMBOL ON IT? YES _____ NO _____

IF YES, TOTAL S.F. OF PANELS WITH COMMUNICATIONS/MESSAGE/TRADEMARK/SYMBOL? _____ s.f.

A SITE SKETCH AND BUILDING SKETCH SHOWING EXACTLY WHERE EXISTING AND NEW SIGNAGE IS LOCATED MUST BE PROVIDED. SKETCHES AND/OR PICTURES OF PROPOSED SIGNAGE ARE ALSO REQUIRED.

SIGNATURE OF APPLICANT: [Signature] DATE: 09/14/08

***** FOR OFFICE USE ONLY *****

B2 - multi tenant

freestanding sign

replac panel - sign permitted 07-1332

Ok.

tenant - 1.5 x 141'4" = 212.1 sq ft

9'7" x 14'10"

115" x 178" = 20,470 sq ft = 142.15 sq ft

Ok

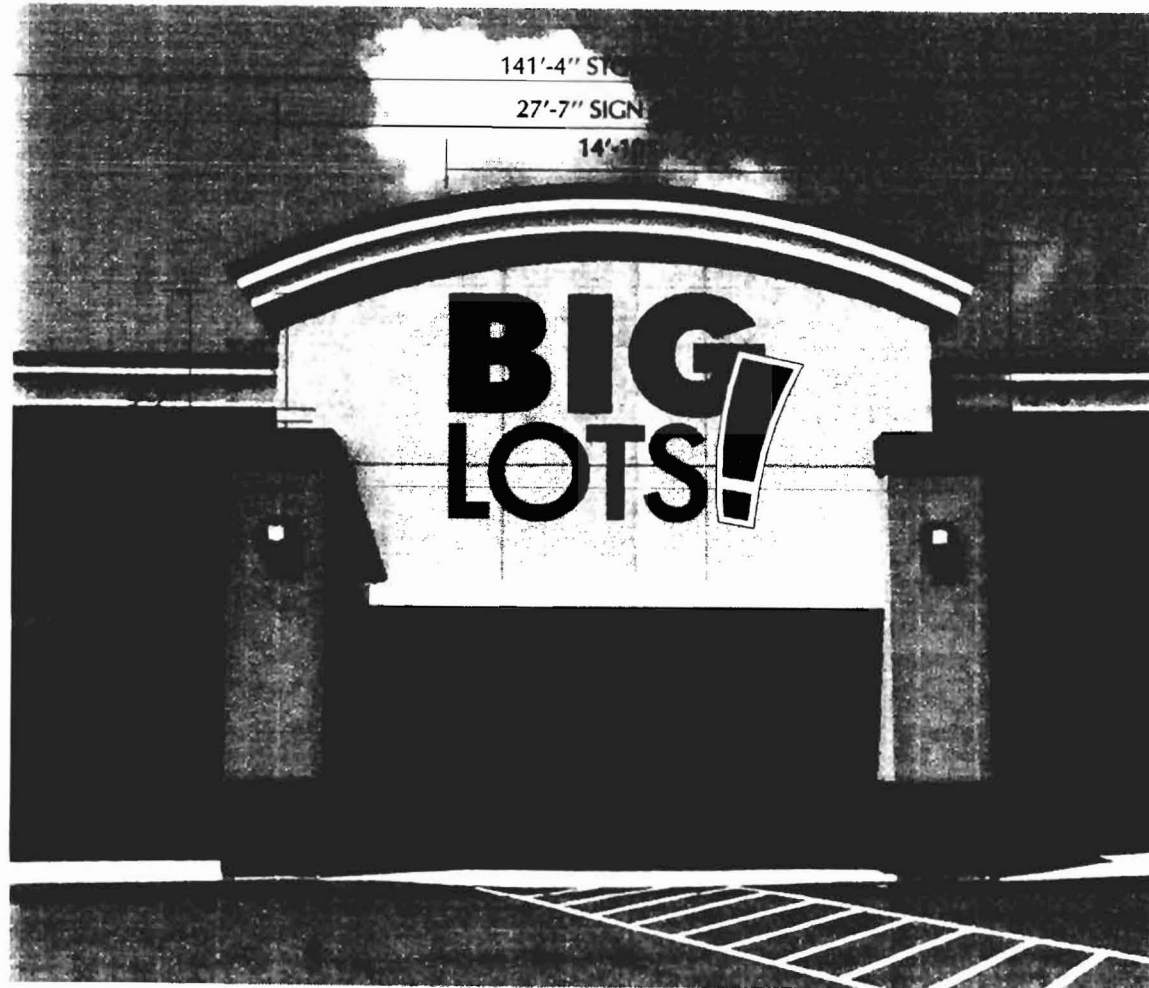

STOREFRONT ELEVATION SCALE 1/8" = 1'-0"

SIGN SPECIFICATIONS: BIG LOTS

CUSTOM FABRICATED 7" ALUMINUM CHanneled LETTERS FINISHED BLACK
 FACES .150" ACRYSTEEL #2119 ORANGE WITH 2" ORANGE TRIM CAP RETAINERS
 INTERNALLY ILLUMINATED WITH RED LED LIGHTING SYSTEM
 LED POWER SOURCE REMOTE BEHIND WALL.
 LETTERS INSTALLED FLUSH MOUNTED TO FASCIA

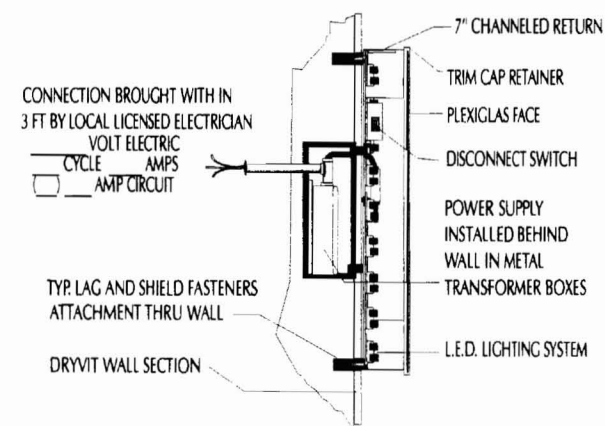
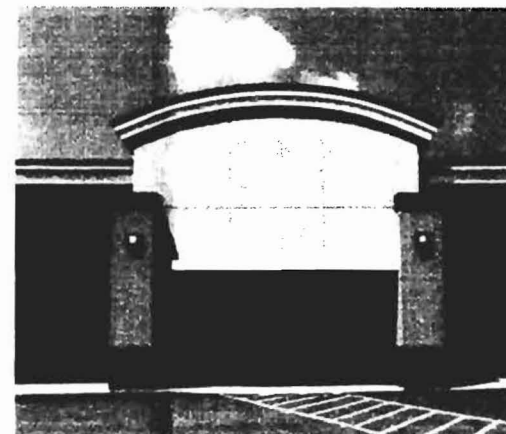

SIGN SPECIFICATIONS: EXCLAMATION

CUSTOM FABRICATED 7" ALUMINUM CHanneled LETTERS FINISHED BLACK
 FACES .150" ACRYSTEEL #2119 ORANGE WITH OPAQUE WHITE VINYL OUTLINE AND WHITE TRIM CAP RETAINER
 INTERNALLY ILLUMINATED WITH RED LED LIGHTING SYSTEM
 LED POWER SOURCE INSTALLED REMOTE BEHIND WALL.
 EXCLAMATION TO MOUNTED SAME AS ABOVE

NOTE: FABRICATION AND INSTALLATION PER UL SPECIFICATIONS. INSTALL IN ACCORDANCE WITH THE NEC. ALL SIGNS EQUIPT WITH DISCONNECT SWITCHES.

**ALL STAR
SIGNS**

112 South Glenwood Columbus, Ohio 43222 (614) 461-9052 Fax (614) 461-0620
 CUSTOM DESIGN • FABRICATION • INSTALLATION • QUALITY SERVICE

BIG LOTS #
 1100 BRIGHTON AVE
 PORTLAND, ME

DATE: JULY 16, 2008
 SALESMAN: WAYNE HOINACKI
 DESIGNER: SANDI DANIEL
 DRAWING # 2008-117

FILE: B18117

REVISED AUGUST 4, 2008

TENANT STREET SIGN REPLACEMENT FACES
HP DIE CUT VINYL COPY APPLIED TO EXISTING
SIGN PANEL
WHITE FACE BACKGROUNDS WITH BLACK
COPY AND TRANSLUCENT ORANGE EXCLAMATION

USE EXISTING SIGN
PANEL

120" VO

16'-7/8"
VO

