

DRAWING TITLE:
DEMO PLAN
PROJECT NAME:
BREAKWATER CODE + TOILETS
856 BRIGHTON AVE, PORTLAND MAINE 04102

THIS DRAWING IS THE PROPERTY OF
SCOTT SIMONS ARCHITECTS AND IS
NOT TO BE COPIED OR REPRODUCED
IN PART OR WHOLE. 2015 © SCOTT
SIMONS ARCHITECTS, LLC

DATE OF ISSUE:
04.19.17
DESCRIPTION:
PERMIT SET
SCALE:

PROJECT NUMBER:
2016-0030

AD102

GENERAL DEMOLITION NOTES:

1. G.C. shall coordinate extent of all demolition work with new construction. Refer to complete drawing set to coordinate demolition work with all trades.
2. All work to be sequenced and scheduled with owner.
3. G.C. to protect adjacent areas not affected by construction and to field verify all conditions prior to bidding and construction.
4. All existing materials noted to be removed shall be properly disposed of by G.C. unless otherwise noted. Owner reserves the right to retain an item noted for demolition.
5. All electrical, plumbing and mechanical located in walls and ceilings noted to be removed shall be either removed back to source or located out of harms way for relocation in new construction, G.C. to coordinate.
6. GC to protect adjacent spaces not affected by construction. Areas occupied during construction to have adequate exits to comply with all codes.
7. Limit of work lines included as general reference line only. Some MEP work will require intervention beyond limit of work lines.
8. Lower level floor slab is conditioned by radiant floor heating. Avoid slab demolition or penetrations if possible.
9. Provide dust partitions and exhaust s required.

LEGEND:

- REMOVE ITEM
- REMOVE AREA

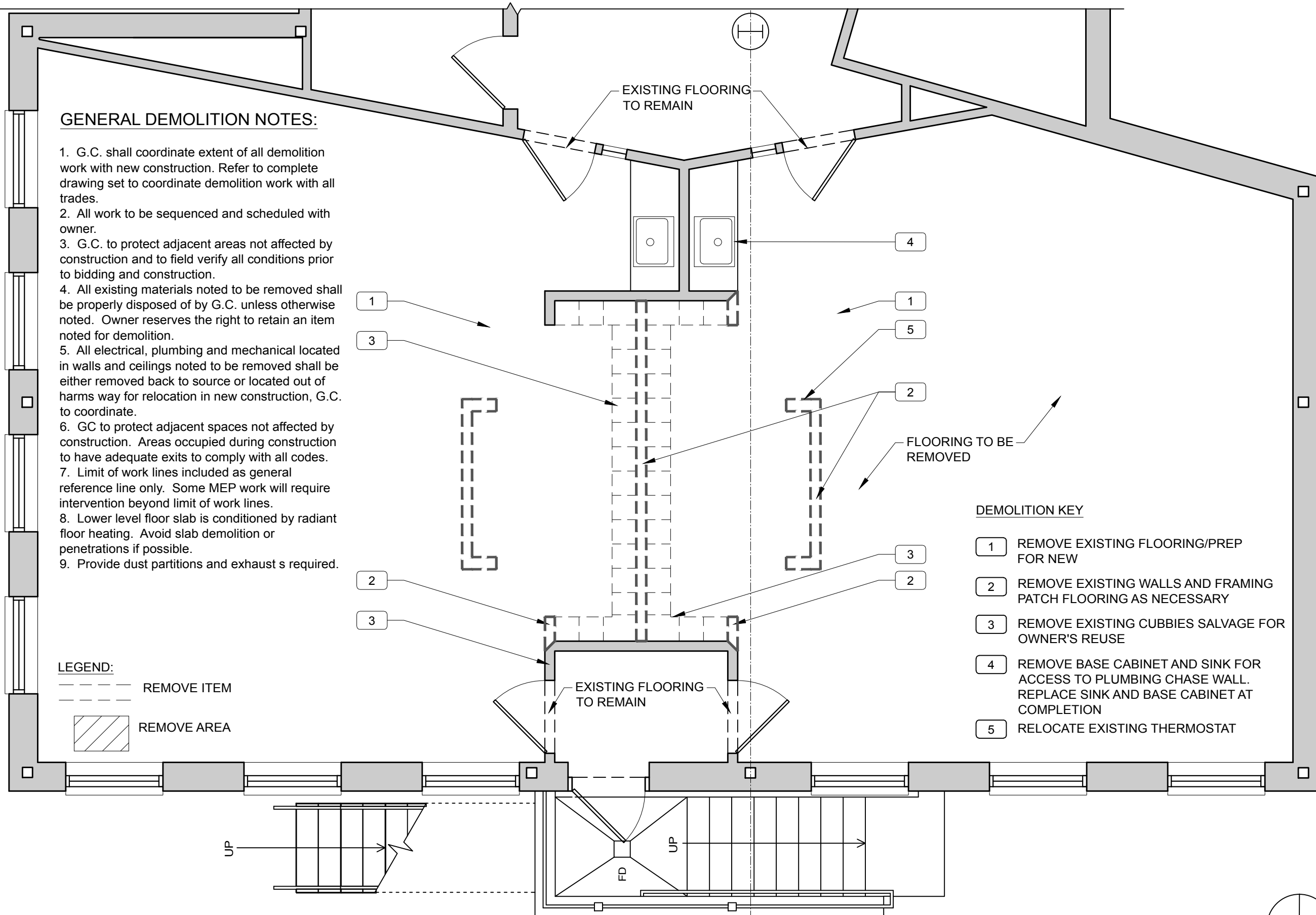

DEMOLITION KEY

- REMOVE EXISTING FLOORING/PREP FOR NEW
- REMOVE EXISTING WALLS AND FRAMING PATCH FLOORING AS NECESSARY
- REMOVE EXISTING CUBBIES SALVAGE FOR OWNER'S REUSE
- REMOVE BASE CABINET AND SINK FOR ACCESS TO PLUMBING CHASE WALL. REPLACE SINK AND BASE CABINET AT COMPLETION
- RELOCATE EXISTING THERMOSTAT

1 LOWER LEVEL DEMOLITION PLAN
SCALE: 1/4" = 1'-0"

