

HILLCREST AVENUE SITE AND UTILITY PLAN
1"=20'

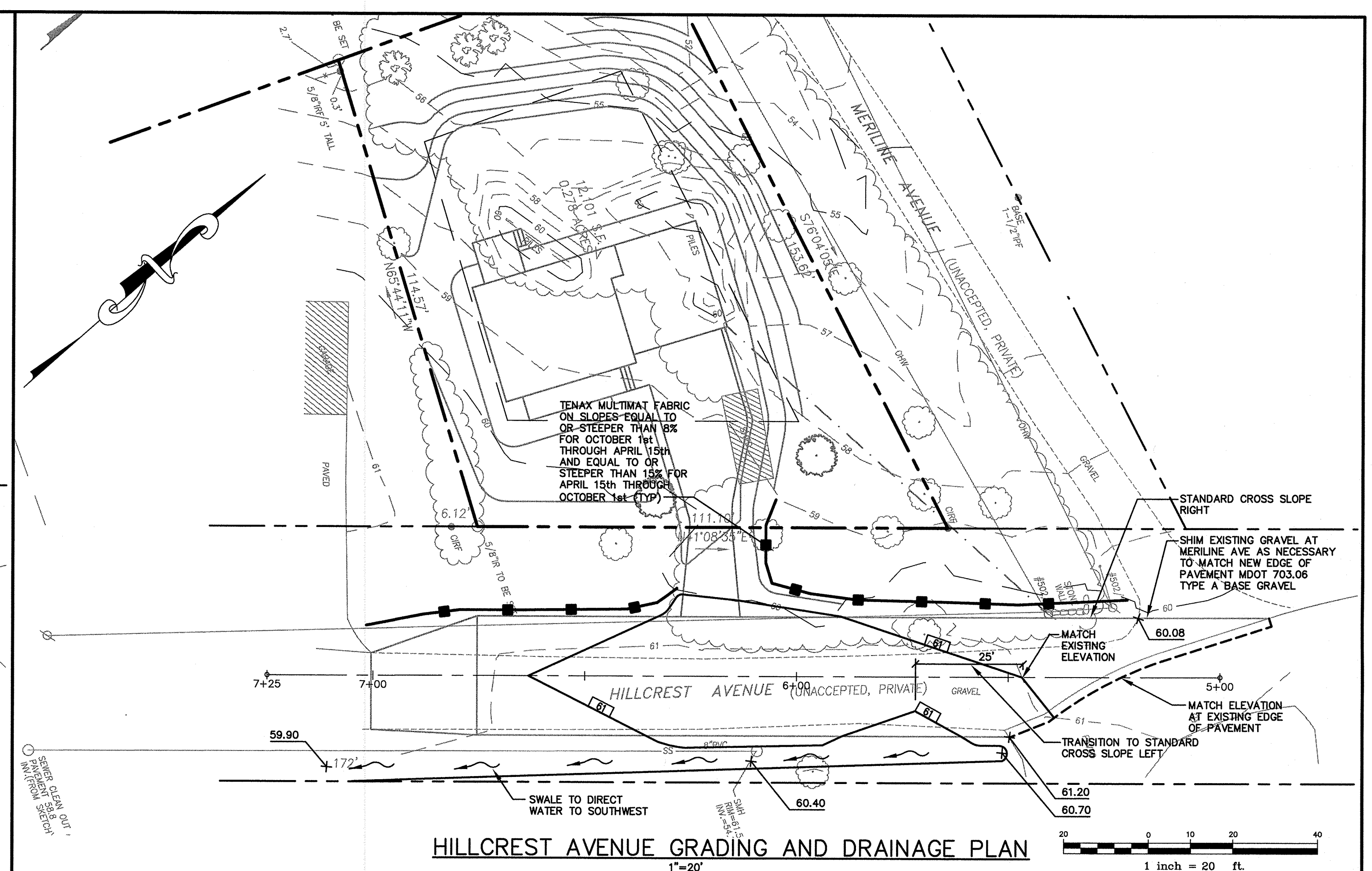

HILLCREST AVENUE GRADING AND DRAINAGE PLAN
1"=20'

GENERAL NOTES

1. TOPOGRAPHIC DATA AND EXISTING CONDITIONS ARE BASED UPON A GROUND SURVEY CONDUCTED BY OWEN HASKELL ON MAY 24, 2013.
2. THE CONTRACTOR IS SPECIFICALLY CAUTIONED THAT THE LOCATION AND/OR THE ELEVATION OF THE EXISTING UTILITIES AS SHOWN ON THESE PLANS IS BASED ON RECORDS OF THE VARIOUS UTILITY COMPANIES AND WHERE POSSIBLE MEASUREMENTS TAKEN IN THE FIELD. THIS INFORMATION IS NOT TO BE RELIED ON AS BEING EXACT OR COMPLETE. THE CONTRACTOR MUST CALL THE APPROPRIATE UTILITY COMPANY AND DIG SAFE AT LEAST 72 HOURS PRIOR TO ANY EXCAVATION TO REQUEST EXACT FIELD LOCATION OF UTILITIES. IT SHALL BE THE RESPONSIBILITY OF THE CONTRACTOR TO RELOCATE ALL EXISTING UTILITIES WHICH CONFLICT WITH THE PROPOSED IMPROVEMENTS SHOWN ON THE PLANS.
3. MAINTENANCE OF EROSION CONTROL MEASURES IS OF PARAMOUNT IMPORTANCE TO THE OWNER AND THE CONTRACTOR IS RESPONSIBLE FOR COMPLYING WITH ALL EROSION CONTROL MEASURES SHOWN ON THE PLANS. ADDITIONAL EROSION CONTROL MEASURES SHALL BE INSTALLED IF DEEMED NECESSARY BY ON-SITE INSPECTIONS OF THE OWNER OR THEIR REPRESENTATIVES AT NO ADDITIONAL COST TO THE OWNER.
4. ALL WATER UTILITY MATERIALS AND INSTALLATION METHODS SHALL CONFORM TO PORTLAND WATER DISTRICT STANDARDS. DISINFECTION OF WATER LINES SHALL CONFORM TO AWWA STANDARD C651, LATEST REVISION.
5. ALL SEWER MATERIALS SHALL CONFORM TO THE REQUIREMENTS OF THE CITY OF PORTLAND TECHNICAL AND DESIGN STANDARDS AND GUIDELINES.
6. ALL MATERIALS AND CONSTRUCTION METHODS SHALL CONFORM TO MAINE DEPARTMENT OF TRANSPORTATION SPECIFICATIONS, AND CITY OF PORTLAND TECHNICAL AND DESIGN STANDARDS AND GUIDELINES.
7. SEWER AND WATER SERVICES SHALL BE INSTALLED BY THE DEVELOPER 5' INTO THE PROPERTY. CONNECTION TO THE HOUSE WILL BE THE RESPONSIBILITY OF THE LOT OWNER.
8. ANY CURBING REMOVED WITHIN THE RIGHT-OF-WAY IS THE PROPERTY OF THE CITY OF PORTLAND AND SHALL BE DELIVERED TO THE PUBLIC WORKS FACILITY ON OUTER CONGRESS STREET.

GRADING AND DRAINAGE NOTES:

1. ALL DISTURBED AREAS THAT ARE NOT PAVED RECEIVE 4" LOAM & SEED.
2. COMMON BORROW SHALL MEET MDOT SPECIFICATION 703.18.

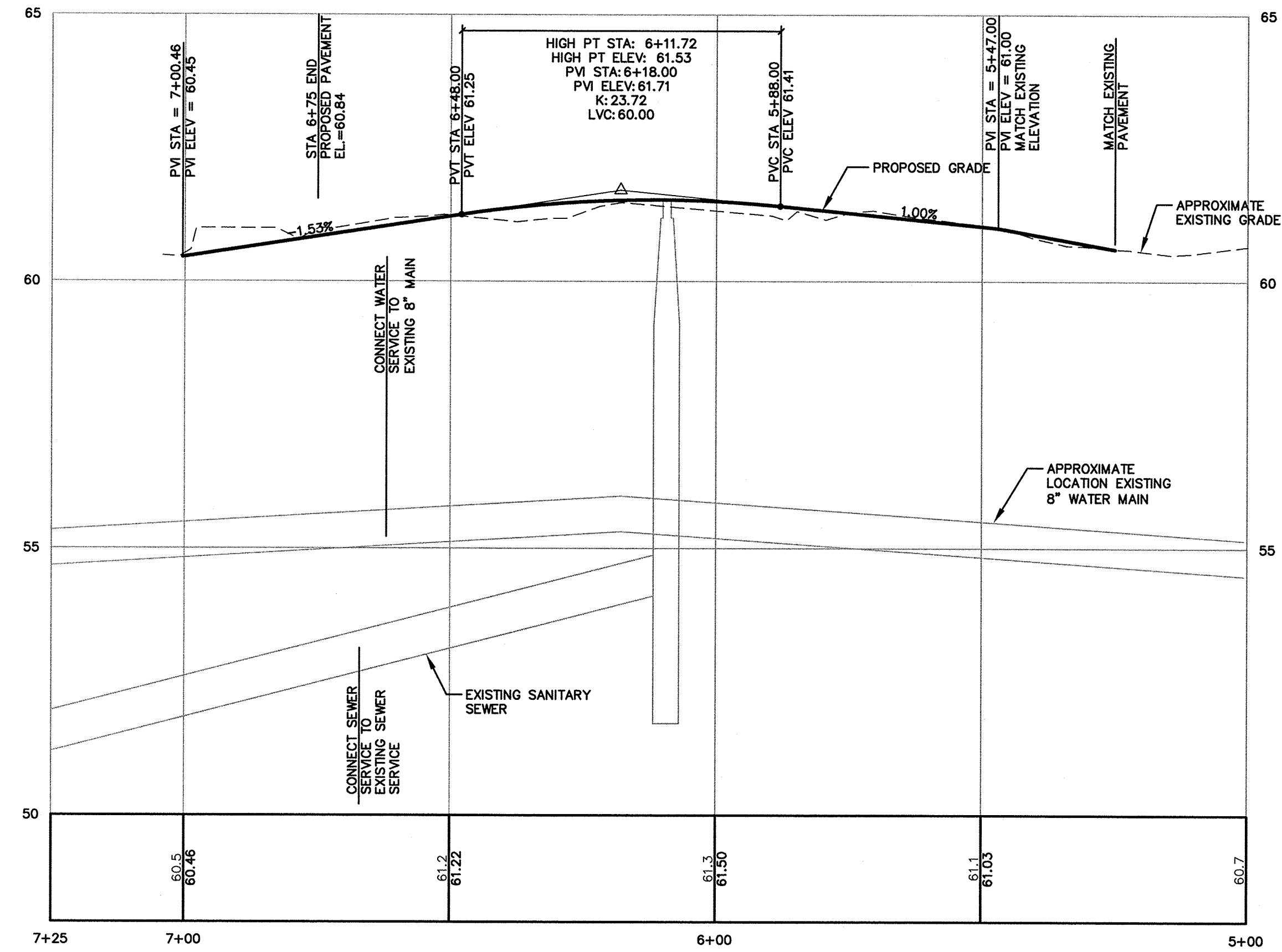

HILLCREST AVENUE SITE AND UTILITY PROFILE
1"=20' HORIZ.
1"=2' VERT.

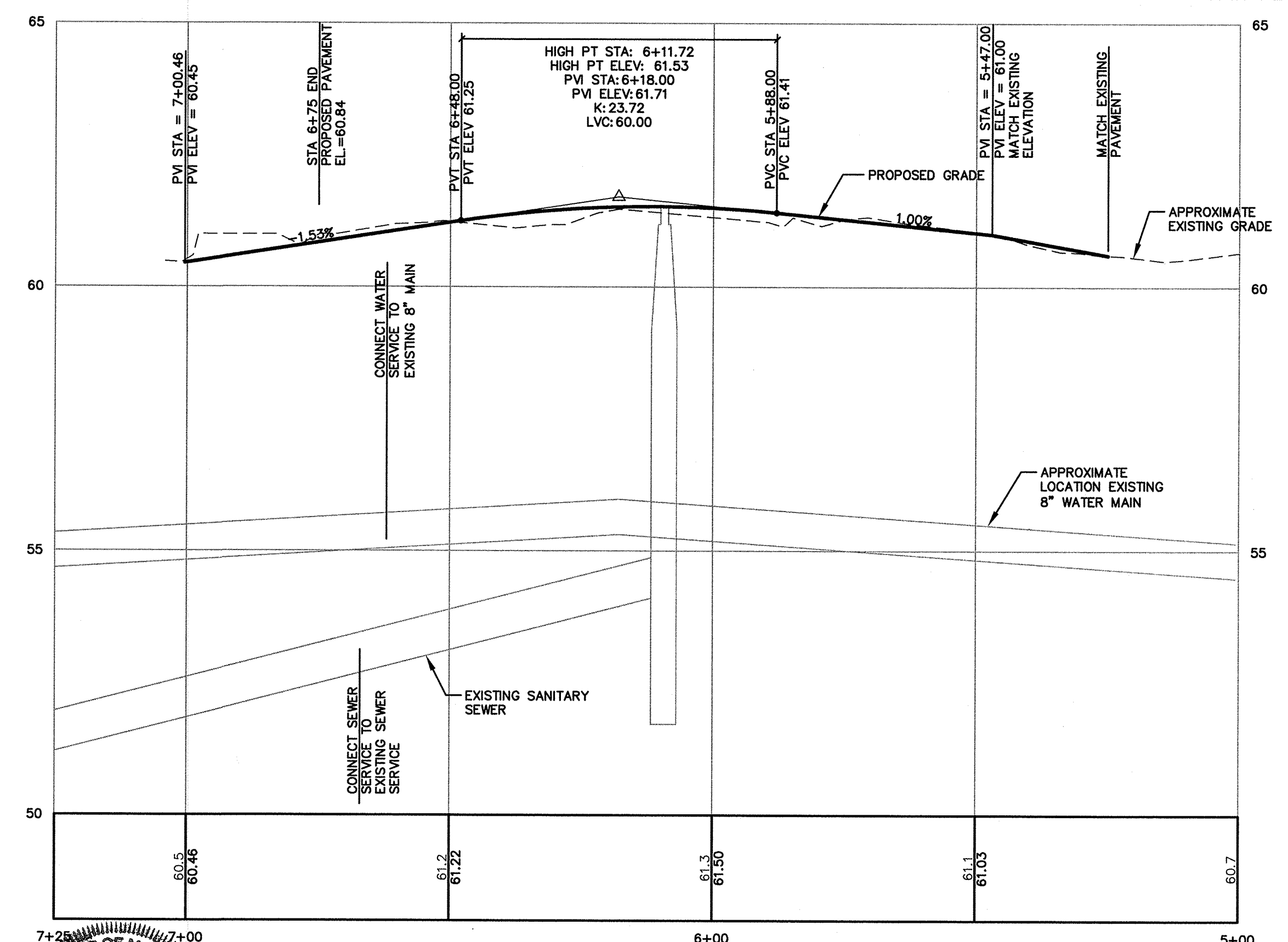

HILLCREST AVENUE GRADING AND DRAINAGE PROFILE
1"=20' HORIZ.
1"=2' VERT.

NOTE: THIS PLAN SET IS ISSUED FOR PERMITTING PURPOSES AND SHALL NOT BE USED FOR CONSTRUCTION.

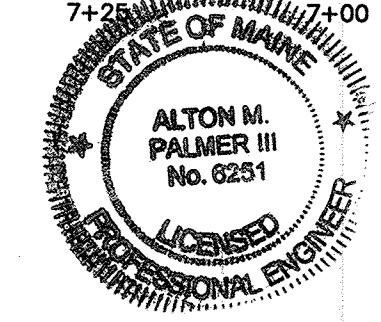

U:\2790 Hillcrest Ave - Higgins\Z - CAD\DWG\2790-ROAD-PP.dwg 7/5/2013 4:28 PM

Rev.	Date	Revision

MUNICIPAL REVIEW	Date	By
	7/8/13	AMP
Issued For		

Design: JWA	Draft: CG	Date: JUNE 2013
Checked: AMP	Scale: 1"=20'	Job No.: 2790
File Name: 2790-ROAD-PP.dwg		
This plan shall not be modified without written permission from Gorrill-Palmer Consulting Engineers, Inc.(GPCEI). Any alterations, authorized or otherwise, shall be at the user's sole risk and without liability to GPCEI.		

GP Gorrill-Palmer Consulting Engineers, Inc.
Engineering Excellence Since 1998
 PO Box 1237 207-657-6910
 15 Shaker Road FAX: 207-657-6912
 Gray, ME 04039 E-Mail: mailbox@gorrillpalmer.com

Drawing Name:	Hillcrest Avenue Plan and Profile
Project:	Hillcrest Avenue Portland, Maine
Client:	Timothy Higgins 83 Bay Street, Portland Maine 04104

Drawing No.
2