

Handwritten signature and date: 9-26-03

BOOK No. N/A	JOB No. 203720	SHEET No. 1 of 1
RECORD OWNER: Monument Properties, LLC 918 Brighton Avenue Portland, Maine 04102	CHKD BY: JPB/JDN	SCALE: 1" = 20'
DRAWN BY: JDN	DATE: Sept. 20, 2003	

NADEAU & LODGE
PROFESSIONAL LAND SURVEYORS
918 BRIGHTON AVENUE
PORTLAND, MAINE 04102
(207) 878-7870

Plan Showing The Location Of A Proposed Addition
Made For
Monument Properties, LLC
918 Brighton Avenue
PORTLAND, MAINE

Location Of This Dwelling Per Scaling From Plan Reference

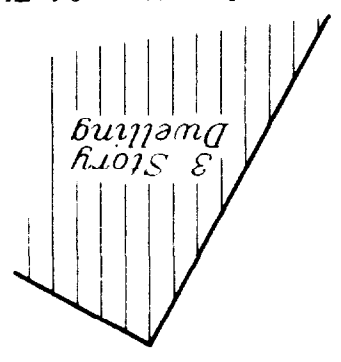

Reference site

- 1 Parcel is depicted as Lot 13 of Block B on Map 260 per City of Portland Assessor's Maps.
- 2 Total area of parcel equals 7,500 square feet, more or less.
- 3 Garage used for equipment storage only.
- 4 The elevations in ~~are~~ are proposed.
- 5 Apparent R/W per Plan Reference and monumentation found in the field.
- 6 This plan is invalid without the embossed seal of the Professional Land Surveyor who prepared this plan.
- 7 Reference is made to "Letter Of Confirmation" between Nadeau & Lodge, Inc and Monument Properties, LLC for exceptions made from Chapter 90, Part 2, "Technical Standards Of Practice".
- 8 The parcel does not horizontally fall within a Special Flood Hazard Zone per Federal Emergency Management Agency Flood Insurance Rate Map Community Panel Number 230051 0006C, under dated December 8, 1998. The parcel falls in Zone X.
- 9 Elevations depicted hereon are based on an assumed datum.
- 10 Existing basement, first floor, & second floor elevations are 96.5', 103.9', & 113.09', respectively. Elevations on proposed addition shall be the same for each respective floor.
- 11 No underground utilities are known to exist on-site.
- 12 No new utilities will be added. Heat, electric, sewer, & water shall tie into existing lines.
- 13 Site will be loamed and seeded, and paved.
- 14 Solid waste will be removed via curbside pick-up.
- 15 If blasting is required, the contractor shall obtain the necessary permits from the City of Portland Fire Department.

General Notes:

"Standard Boundary Survey And Location Plan For Archelle, Inc., South Portland, Maine
Portland, ME", dated August 27, 1990 by Owen Haskell.

Plan Reference:

