

PLAN  
NORTH

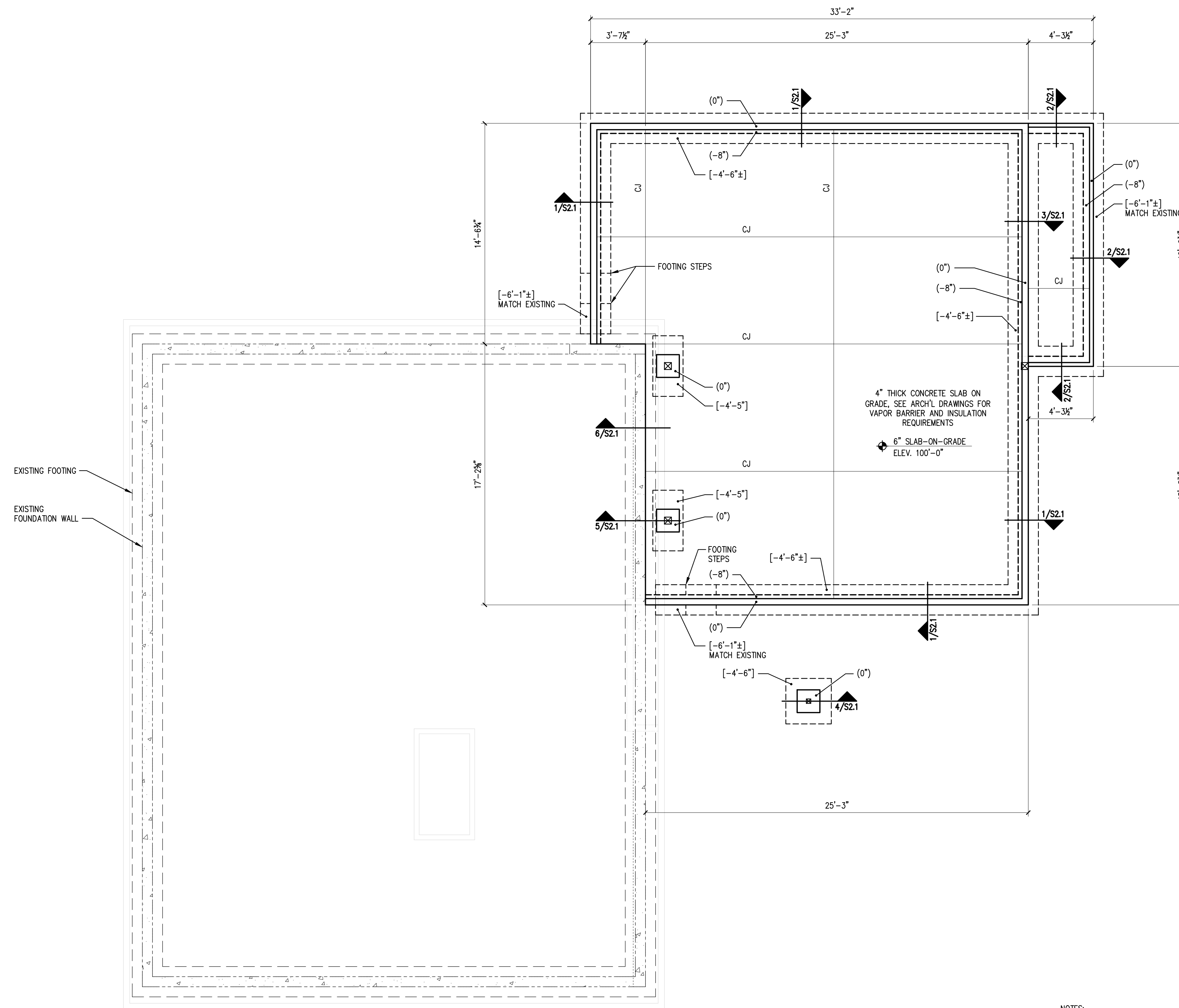

EXISTING FOOTING  
EXISTING FOUNDATION WALL

4" THICK CONCRETE SLAB ON GRADE. SEE ARCH'L DRAWINGS FOR VAPOR BARRIER AND INSULATION REQUIREMENTS  
6" SLAB-ON-GRADE ELEV. 100'-0"

- NOTES:
- SEE S2.1 FOR TYPICAL SLAB-ON-GRADE, TYPICAL WALL REINFORCING AND TYPICAL FOOTING DETAILS.
  - REFERENCE FINISH FLOOR ELEVATION = 100'-0"
  - TOP OF CONCRETE ELEVATIONS ARE NOTED (+X") FROM SLAB-ON-GRADE ELEVATION.
  - TOP OF FOOTING ELEVATIONS ARE NOTED [-X"-X"] FROM SLAB-ON-GRADE ELEVATION.

FOUNDATION PLAN

SCALE: 1/4" = 1'-0"

PLAN LEGEND

	BEARING WALL
	SHEAR WALL
	BEAM
	HSS COLUMN
	COLUMN FROM ABOVE
	COLUMN BELOW
	COLUMN ABOVE AND BELOW
	HOLD-DOWN

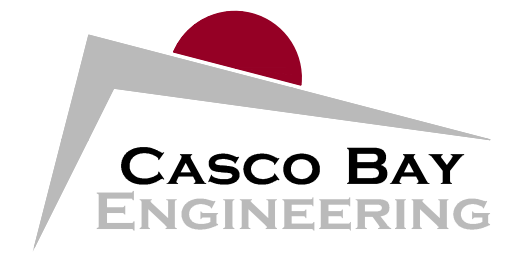

424 Fore Street  
Portland, ME 04101  
Phone 207.842.2800  
Fax 207.842.2828  
www.cascobayengineering.com

CLIENT:  
RICHARD RENNER  
ARCHITECTS  
35 PLEASANT AVE.  
PORTLAND, MAINE

REDMAN RESIDENCE : STUDIO ADDITION  
480 CAPSIC STREET  
PORTLAND, MAINE  
BUILDING ADDITION

No.	DESCRIPTION	ISSUED FOR PERMIT	CHKD.	DATE
			BY	
A			PR	6-22-15

SHEET TITLE:

FOUNDATION PLAN

DESIGNED: PR  
DRAWN: PR  
DATE: 3-24-15  
PROJECT NUMBER: 15-048

S1.0

PRINTED: Jun 22, 2015