

Contractor:
DF Chase, Inc.
3001 Armory Drive
Suite 225
Nashville, TN 37204



OFFICE RENOVATION & DOCK ADDITION:
OLD DOMINION FREIGHT LINE
ODFL PORTLAND, ME
185 RAND ROAD
PORTLAND, ME 04102

CONSTRUCTION PERMIT 4/25/2014
DRAWINGS FOR PERMIT
SITE LIGHTING CHG 5/21/14
REVIEW COMMENTS 6/10/14
REVIEW COMMENTS 7/17/14

Project No. 13061.00
The Architect hereby reserves its common law copyright and other property rights in these plans, items and designs which are not to be reproduced, changed or copied in any form or manner whatsoever, nor are they to be assigned in any third party without first obtaining the express written permission from the Architect. The drawing is not final or to be used for construction until signed by the Architect.

Sheet Name: SITE PHOTOMETRICS

Sheet Number:

ES1.1A

ORA JOB# 01014

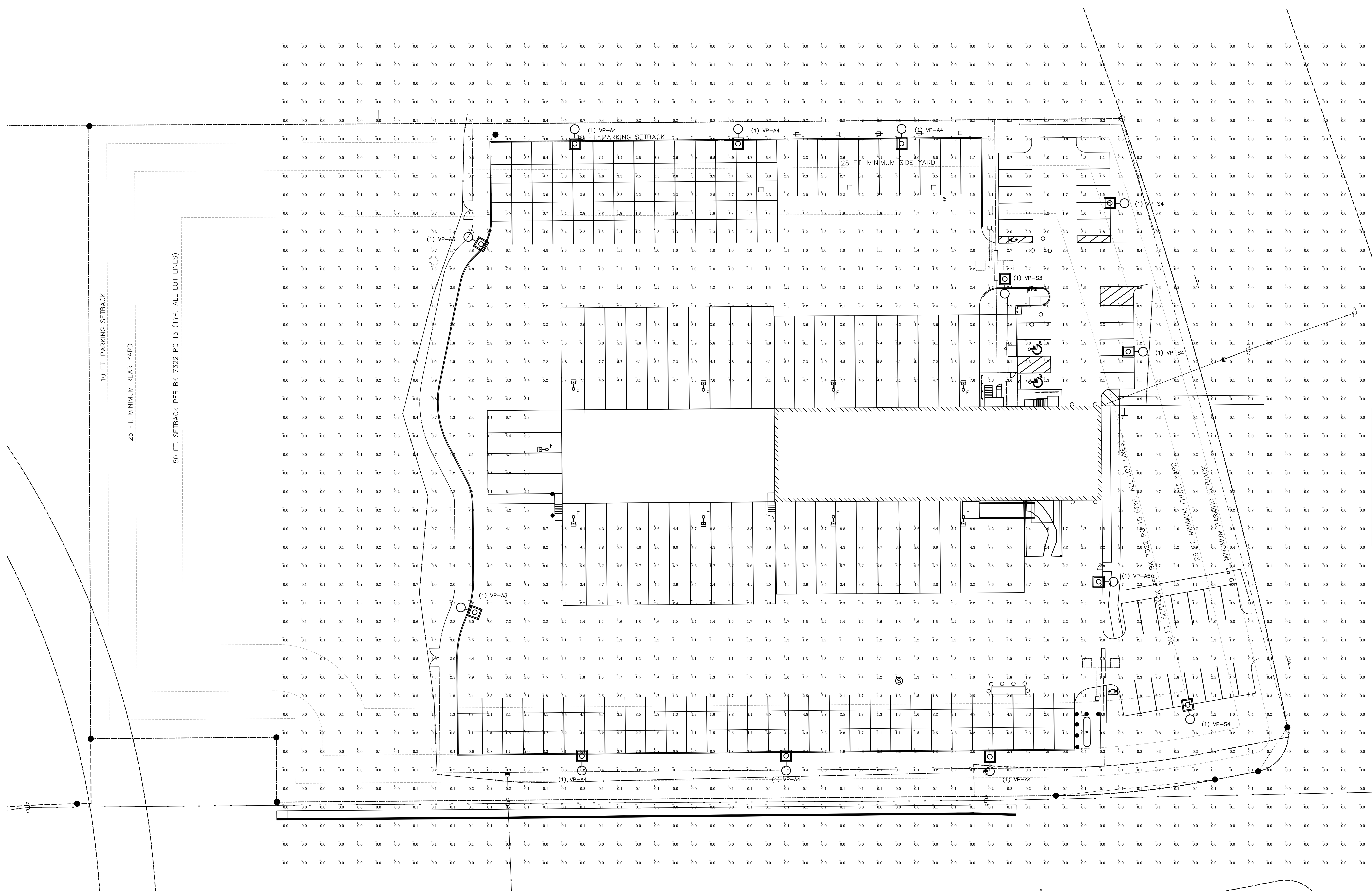

Calculation Summary

Label	CalcType	Units	Avg	Max	Min	Avg/Min	Max/Min
Employee Parking	Illuminance	Fc	1.66	3.4	0.5	3.32	6.80
Overall Area	Illuminance	Fc	1.35	9.1	0.0	N.A.	N.A.
Property Line	Illuminance	Fc	0.13	1.3	0.0	N.A.	N.A.
Terminal Lot	Illuminance	Fc	3.22	9.1	1.0	3.22	9.10

FIXTURE SCHEDULE

TYPE	MANUFACTURER	CATALOG #	LAMPS	VOLTAGE	MOUNTING	TYPE/REMARKS
VP-A3	BEACON	VP-L-96NB-280-5K-T3-208-BZ	LED	208	POLE.	SITE LIGHTING, MOUNTED 20' AFG.
VP-A4	BEACON	VP-L-96NB-280-5K-T4-208-HSS-BZ	LED	208	POLE.	SITE LIGHTING, MOUNTED 20' AFG.
VP-A5	BEACON	VP-L-96NB-280-5K-T5W-208-PK2-BZ	LED	208	POLE.	SITE LIGHTING, MOUNTED 20' AFG.
VP-S4	BEACON	VP-S-30NB-90-5K-T4-208-PK2-	LED	208	POLE.	SITE LIGHTING, MOUNTED 20' AFG.
F	BEACON	VP-L-96NB-5K-T4-UNV-RA-BZ	LED	120V	POLE.	BUILDING MOUNTED AT 19' AFG.
VP-S3	BEACON	VP-S-30NB-90W-5K-T3-208-PK2-BZ	LED	120V	POLE.	SITE LIGHTING, MOUNTED 20' AFG.

TBM

NEW PHOTOMETRICS CALCULATIONS BASED ON NEW SITE LIGHTING LAYOUT.

SITE PHOTOMETRICS PLAN
SCALE: 1"=20'

NORTH