

OCCUPANT LOADS - TERMINAL BUILDING		
Automatic Fire Sprinkler:	Existing: No / Proposed: No	
Occupant Load:	Shop	1,096/500 = 3 occ
	Dock	10,881/300 = 37 occ
	Office	2,335/100 = 24 occ
	Total Occupant Load	64 occ
Required Egress Width:	64 x 0.2" = 13"	
Provided Egress Width:	128"	
Max Travel Distance Allowed:	200'-0"	

LIFE SAFETY LEGEND	
	Exit Sign
	Maximum Travel Distance
	Point of Egress
	Maximum Exit Capacity (Number of People)
	Fire Extinguisher (Wall Mount) FE
	Fire Extinguisher (Recessed Wall Cabinet) FEC
	Emergency Overhead Lighting
	Emergency Outdoor Lighting

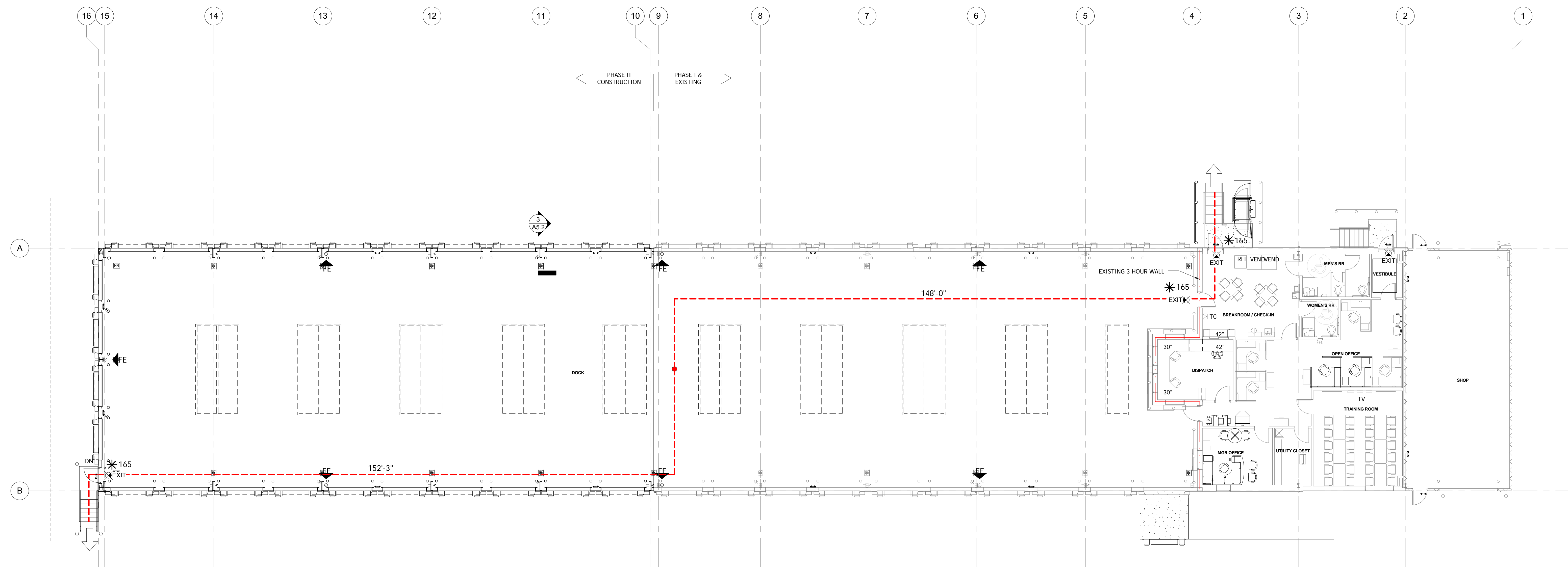

1 LIFE SAFETY PLAN

 1" = 10'-0"

Phase II Terminal Addition for:

Old Dominion Freight Line

ODFL PORTLAND, ME

 185 RAND ROAD,

 PORTLAND, ME 04102

PERMIT ISSUE 04/16/2014

Project No. 13061.00

The Architect hereby reserves its common law copyright and other property rights in these plans, ideas, and designs which are not to be reproduced, changed or copied in any form or manner whatsoever, nor are they to be assigned to any third party without first obtaining the express written permission from the Architect. The drawing is not final or to be used for construction until signed by the Architect.

Sheet Name:

 ADDITION LIFE SAFETY

 PLAN

Sheet Number:

A0.5