

[Print a product detail sheet](#)
[Email a product detail sheet](#)

Select Nearest WS Branch:



Or Toll Free: 800-782-1500



- 
- 

[View Floorplan](#)

Photos and diagrams are representational, actual products may vary.

Many additional Williams Scotsman products, accessories, services and parts are available at the branch offices, and not included on this search. Products are shown with all available features. Products shown are not guaranteed to be in stock. Contact a Williams Scotsman sales representative for a listing of products and features available.

[View myQuote Request](#)
[Request a Quote](#)

Quantity:

myQuote Worksheet

Currently there are no items in your Worksheet. You can work up a Request for Quote by adding items as you are browsing...

[Finalize myQuote Request](#)



An ALGECO SCOTSMAN Company

C0208 GROUND OFFICE

(TRAILER #2)

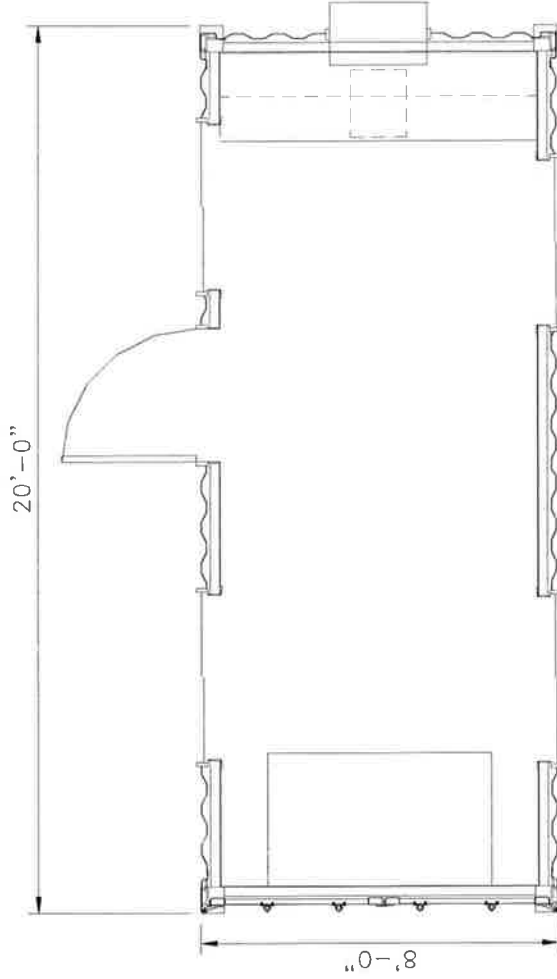

Additional floor plans available. Floor plans and specifications may vary from those shown, and are subject to in-stock availability.

SPECIFICATIONS

General

- ISO Container w/ Office

Size(s)

- 20' Long
- 8' Wide
- 7'-6" Ceiling height

Interior Finish

- Pre-finished walls
- Tile floor w/ vinyl wall base
- Pre-finished interior ceiling panel
- Optional interior partition w/door

Electric

- Fluorescent ceiling lights
- Breaker panel
- Duplex receptacles
- Phone/Data Rough-In

Windows/Door

- Horizontal sliding window w/ steel window guard
- Commercial steel door w/ deadbolt

Heating/Cooling

- Environmentally controlled w/heat and A/C

Furniture

- Built-in desk w/ overhead shelf & filing cabinet
- Folding plan table

Exterior Finish

- Steel ribbed panel, colonial white/green

THE USE OF THIS DRAWING FOR ANY MEANS OTHER THAN THAT INTENDED IS STRICTLY PROHIBITED WITHOUT PRIOR WRITTEN CONSENT OF AN AUTHORIZED WILLIAMS SCOTSMAN REPRESENTATIVE.