

City of Portland, Maine - Building or Use Permit Application
 389 Congress Street, 04101 Tel: (207) 874-8703, FAX: (207) 8716

PERMIT ISSUED
 FEB 14 2011
 CITY OF PORTLAND

Job No: 2011-01-322-HVAC	Date Applied: 1/21/2011	CBL: 253 - - A - 004 - 001 - - - - -	
Location of Construction: 111 PINE TREE IND	Owner Name: REALTY MEGCO	Owner Address: 75 PINE TREE INDUSTRIAL PKW PORTLAND, ME - MAINE 04102	Phone: CITY OF PORTLAND
Business Name:	Contractor Name: Southern Maine Refrigeration Inc, Southern Maine Refrigeration Inc	Contractor Address: 172 NEW RD KENNEBUNKPORTMAINE04046	Phone: 1553
Lessee/Buyer's Name:	Phone:	Permit Type: HVAC - HVAC	Zone: I-M
Past Use: Warehouse & Distribution (Good Shepherd Food Bank)	Proposed Use: Same: Warehouse & Distribution (Good Shepherd) To install exterior condensing unit	Cost of Work: 8000.000000	CEO District:
		Fire Dept: <input checked="" type="checkbox"/> Approved <input type="checkbox"/> Denied <input type="checkbox"/> N/A	Inspection: Use Group: S-2 Type: HVAC
		Signature: <i>[Signature]</i> (58)	Signature: <i>[Signature]</i>
Proposed Project Description: Good Shephard Food Bank #100666- exterior condenser unit		Pedestrian Activities District (P.A.D.)	

Permit Taken By:	Zoning Approval						
1. This permit application does not preclude the Applicant(s) from meeting applicable State and Federal Rules. 2. Building Permits do not include plumbing, septic or electrical work. 3. Building permits are void if work is not started within six (6) months of the date of issuance. False informatin may invalidate a building permit and stop all work.	<table style="width: 100%;"> <tr> <th style="text-align: left;">Special Zone or Reviews</th> <th style="text-align: left;">Zoning Appeal</th> <th style="text-align: left;">Historic Preservation</th> </tr> <tr> <td> <input type="checkbox"/> Shoreland <input type="checkbox"/> Wetlands <input type="checkbox"/> Flood Zone <input type="checkbox"/> Subdivision <input type="checkbox"/> Site Plan <input type="checkbox"/> Maj <input type="checkbox"/> Min <input type="checkbox"/> MM Date: <i>OK with conditions</i> <i>[Signature]</i> 1/25/11 </td> <td> <input type="checkbox"/> Variance <input type="checkbox"/> Miscellaneous <input type="checkbox"/> Conditional Use <input type="checkbox"/> Interpretation <input type="checkbox"/> Approved <input type="checkbox"/> Denied Date: </td> <td> <input checked="" type="checkbox"/> Not in Dist or Landmark <input type="checkbox"/> Does not Require Review <input type="checkbox"/> Requires Review <input type="checkbox"/> Approved <input type="checkbox"/> Approved w/Conditions <input type="checkbox"/> Denied Date: <i>9</i> </td> </tr> </table>	Special Zone or Reviews	Zoning Appeal	Historic Preservation	<input type="checkbox"/> Shoreland <input type="checkbox"/> Wetlands <input type="checkbox"/> Flood Zone <input type="checkbox"/> Subdivision <input type="checkbox"/> Site Plan <input type="checkbox"/> Maj <input type="checkbox"/> Min <input type="checkbox"/> MM Date: <i>OK with conditions</i> <i>[Signature]</i> 1/25/11	<input type="checkbox"/> Variance <input type="checkbox"/> Miscellaneous <input type="checkbox"/> Conditional Use <input type="checkbox"/> Interpretation <input type="checkbox"/> Approved <input type="checkbox"/> Denied Date:	<input checked="" type="checkbox"/> Not in Dist or Landmark <input type="checkbox"/> Does not Require Review <input type="checkbox"/> Requires Review <input type="checkbox"/> Approved <input type="checkbox"/> Approved w/Conditions <input type="checkbox"/> Denied Date: <i>9</i>
	Special Zone or Reviews	Zoning Appeal	Historic Preservation				
<input type="checkbox"/> Shoreland <input type="checkbox"/> Wetlands <input type="checkbox"/> Flood Zone <input type="checkbox"/> Subdivision <input type="checkbox"/> Site Plan <input type="checkbox"/> Maj <input type="checkbox"/> Min <input type="checkbox"/> MM Date: <i>OK with conditions</i> <i>[Signature]</i> 1/25/11	<input type="checkbox"/> Variance <input type="checkbox"/> Miscellaneous <input type="checkbox"/> Conditional Use <input type="checkbox"/> Interpretation <input type="checkbox"/> Approved <input type="checkbox"/> Denied Date:	<input checked="" type="checkbox"/> Not in Dist or Landmark <input type="checkbox"/> Does not Require Review <input type="checkbox"/> Requires Review <input type="checkbox"/> Approved <input type="checkbox"/> Approved w/Conditions <input type="checkbox"/> Denied Date: <i>9</i>					
CERTIFICATION							

I hereby certify that I am the owner of record of the named property, or that the proposed work is authorized by the owner of record and that I have been authorized by the owner to make this application as his authorized agent and I agree to conform to all applicable laws of this jurisdiction. In addition, if a permit for work described in the appication is issued, I certify that the code official's authorized representative shall have the authority to enter all areas covered by such permit at any reasonable hour to enforce the provision of the code(s) applicable to such permit.

SIGNATURE OF APPLICANT	ADDRESS	DATE	PHONE
RESPONSIBLE PERSON IN CHARGE OF WORK, TITLE		DATE	PHON



FILL IN AND SIGN WITH INK

APPLICATION FOR PERMIT HEATING OR POWER EQUIPMENT

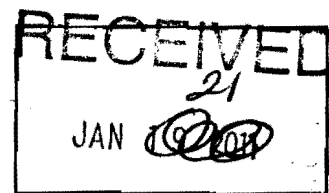

Dept. of Building Inspections
City of Portland Maine

To the INSPECTOR OF BUILDINGS, PORTLAND, ME.

The undersigned hereby applies for a permit to install the following heating, cooking or power equipment in accordance with the Laws of Maine, the Building Code of the City of Portland, and the following specifications:

Location / CBL Good Shepherd Food-Bank Use of Building Warehouse Date _____
111 Pine Tree Industrial Pkwy
 Name and address of owner of appliance Good Shepherd Food Bank
111 Pine Tree Industrial Pkwy, Portland, Maine 04102
 Installer's name and address Southern Maine Refrigeration Inc.
172 New Road Arundel, Maine 04046 Telephone 207-282-1553

Location of appliance: (outdoor)
 Basement Floor
 Attic Roof

Type of Fuel:
 Gas Oil Solid

Appliance Name: Condensing Unit #1
 U.L. Approved Yes No Condensing Unit #2

Will appliance be installed in accordance with the manufacture's installation instructions? Yes No

IF NO Explain: _____

The Type of License of Installer:
 Master Plumber # _____
 Solid Fuel # _____
 Oil # _____
 Gas # _____
 Other N/A (EPA certification)

Type of Chimney:
 Masonry Lined
 Factory built _____

Metal
 Factory Built U.L. Listing # _____

Direct Vent
 Type _____ UL# _____

Type of Fuel Tank
 Oil
 Gas

Size of Tank _____

Number of Tanks _____

Distance from Tank to Center of Flame _____ feet.

Cost of Work: \$17520

Permit Fee: \$ 100

Approved
 Fire: _____
 Ele.: _____
 Bldg.: _____

Approved with Conditions
 See attached letter or requirement

Inspector's Signature _____ Date Approved _____

Signature of Installer Keith Russell

White - Inspection Yellow - File Pink - Applicant's Gold - Assessor's Copy

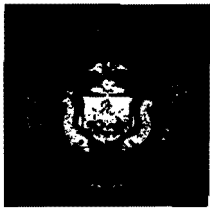

PORTLAND MAINE

Strengthening a Remarkable City, Building a Community for Life • www.portlandmaine.gov

Director of Planning and Urban Development
Penny St. Louis Littell

Job ID: 2011-01-322-HVAC

Located At: 111 PINE TREE IND

CBL253 - - A - 004 - 001 - - - -

Conditions of Approval:

Zoning

1. This permit is being approved on the basis of plans submitted. Any deviations shall require a separate approval before starting that work.
2. This property shall remain a warehouse and distributions (Good Shepherd Food Bank). Any change of use shall require a separate permit application for review and approval.
3. The maximum allowed noise requirements must be met at all times. If a noise complaint is validated, the unit SHALL be made to come into compliance with the I-M Zone requirements with approved mitigating measures.

Building

1. Application approval based upon information provided by applicant. Any deviation from approved plans requires separate review and approval prior to work.

BUILDING PERMIT INSPECTION PROCEDURES

Please call 874-8703 or 874-8693 (ONLY)

or email: buildinginspections@portlandmaine.gov

With the issuance of this permit, the owner, builder or their designee is required to provide adequate notice to the city of Portland Inspections Services for the following inspections. Appointments must be requested 48 to 72 hours in advance of the required inspection. The inspection date will need to be confirmed by this office.

- **Please read the conditions of approval that is attached to this permit!! Contact this office if you have any questions.**
- **Permits expire in 6 months. If the project is not started or ceases for 6 months.**
- **If the inspection requirements are not followed as stated below additional fees may be incurred due to the issuance of a "Stop Work Order" and subsequent release to continue.**

1. Final - Commercial

The project cannot move to the next phase prior to the required inspection and approval to continue, REGARDLESS OF THE NOTICE OF CIRCUMSTANCES.

IF THE PERMIT REQUIRES A CERTIFICATE OF OCCUPANCY, IT MUST BE PAID FOR AND ISSUED TO THE OWNER OR DESIGNEE BEFORE THE SPACE MAY BE OCCUPIED.

Outdoor, Air Cooled Pre-Assembled Remote
Qty (1) Model #: DLD6M44E Condensing Unit, 6 HP, Medium

Temp, Discus Semi-Hermetic, R-404A/R-507, Suction
Temp: +22.7, 67,832 BTUH, Ambient: 95 deg,
208-230/3Ph, MCA: 47.00, Shp Wgt: 1075

Standard Components:

Weather Cover
Filter/Drier & Sight Glass
Liq. Line Solenoid (loose)
Thermostat (Loose)
Air Defrost Timer
Suction Vibrasorber
Suction Filter
Crank. Heater S.H.

Cost \$ 4,347.00

Total Cost

\$7,520.00

Southern Maine Refrigeration Inc.
172 New Road
Arundel, Maine 04046

Job Name: Good Sheppard Food Bank

Refrigeration equipment:

Outdoor, Air cooled Pre-Assembled Remote
QTY (1) Model #: DLD3L44E Condensing unit, 3 HP, Low Temp,
Discus Semi-Hermetic, R-404A/R-507, Suction temp: -
20, 19,416 BTUH, Ambient: 100 deg, 208-230/3Ph,
MCA: 26.00 Shp Wgt: 710
Standard Components:
Weather Cover
Filter/Drier & Sight Glass
Liq. Line Solenoid (loose)
Thermostat (loose)
Electrical Defrost Timer
Suction Vibrasorber
Suction Filter
Crank. Heater S.H.
Headmaster Control
ED-11 Electric Defrost

Cost \$3,173.00

somerefrigeration

From: Dave Carriero [Dave.Carriero@htpgusa.com]
Sent: Thursday, January 20, 2011 1:35 PM
To: somerefrigeration@roadrunner.com
Subject: Unit sound data

Karen,
DLD3L44-E is approx. 66 dba @ 20'
DLD6M44-E is approx. 70 dba @ 20'

Regards
Dave C

14-252 Noise MAX Allowance



Russell

HTPG, a division of Carrier
Commercial Refrigeration Inc.

D Series

**Air Cooled
Condensing Units**

3 to 22 HP

Brochure 530.9

February, 2007

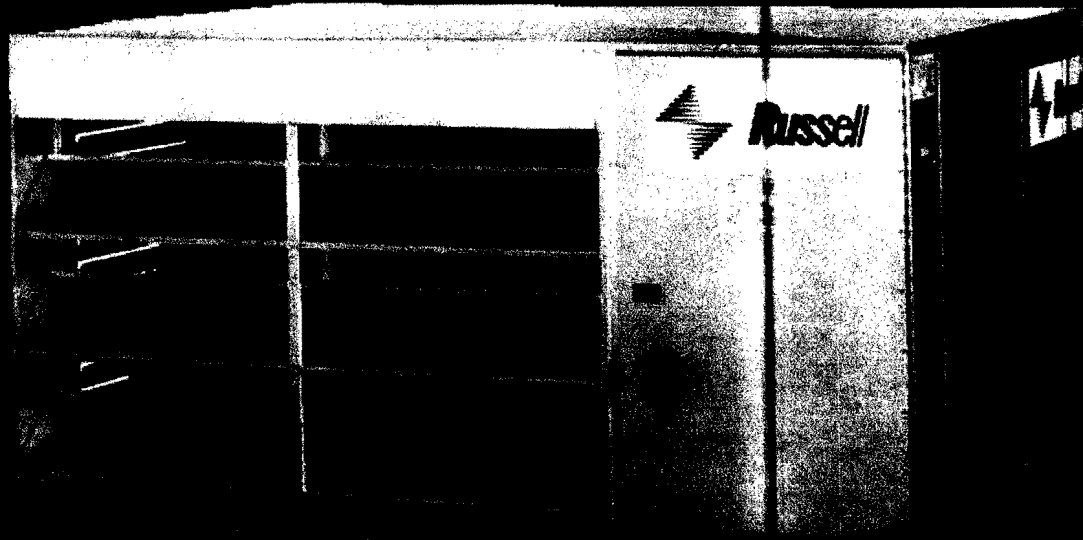

© 2007 Carrier Refrigeration, Inc. • 10000 North Central Expressway • Dallas, TX 75243 • 972-376-1000 • www.russellcoil.com

MODEL NUMBER NOMENCLATURE

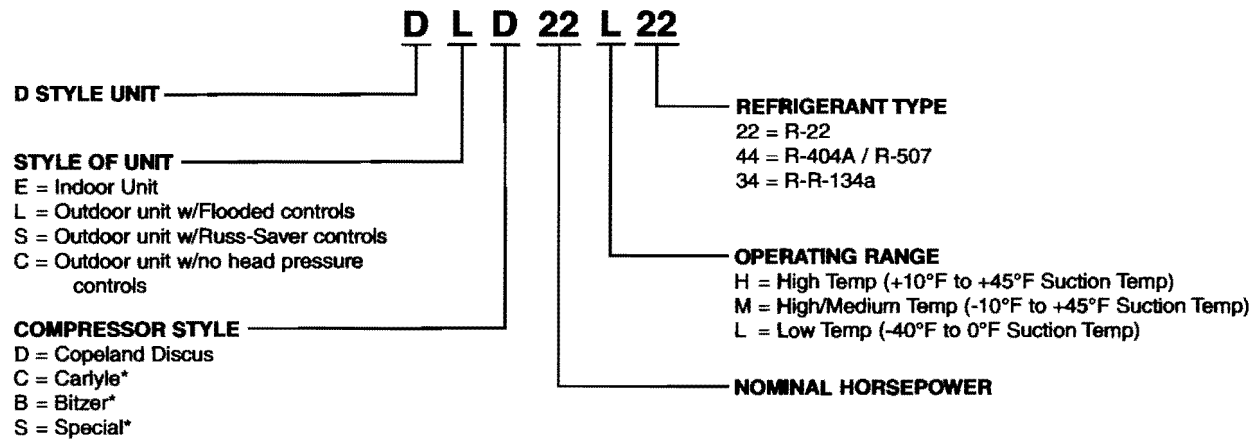

FEATURES AT A GLANCE		MODEL		
		DE	DC	DS
ELECTRICAL COMPONENTS	Crankcase heater	OPTION	STD	STD
	Oil failure control - as required	STD	STD	STD
	High-Low pressure control - manual(high)/automatic(low)rest	STD	STD	STD
	Compressor contactor	STD	STD	STD
	Control circuit fuses - standard 230/1	STD	STD	STD
	Power terminal block	OPTION	STD	STD
CONDENSER	Copper tubes with Aluminum fins	STD	STD	STD
	Subcooling circuit	STD	STD	STD
	Fan motor - PSC overload protection	STD	STD	STD
	Fan blade - individually balanced	STD	STD	STD
	Fan guard - split for easy motor access: UL listed	STD	STD	STD
PIPING COMPONENTS	Suction line filter	OPTION	STD	STD
	Suction line vibration eliminator	OPTION	STD	STD
	Liquid line filter/drier	OPTION	STD	STD
	Sight glass/moisture indicator	OPTION	STD	STD
	Discharge line vibration eliminator	STD	STD	STD
RECEIVER	Inlet and outlet isolation valves	STD	STD	STD
	Fusible plug	STD	STD	STD
HOUSING	All weather housing	OPTION	STD	STD
	Control panel - with hinged door	STD	STD	STD
	Raised galvanized steel base	STD	STD	STD
LOW AMBIENT CONTROLS	Russ-Saver - all ambient energy saver	N/A	N/A	STD
	Pressure fan cycling control-not available on 3HP-6HP low temps.	OPTION	OPTION	STD
	Flooded condenser	OPTION	OPTION	N/A
TESTING	UL/cUL listed all models	STD	STD	STD
	Leak detection, Dielectric & Run test	STD	STD	STD
	Dry nitrogen holding charge	STD	STD	STD

OPTIONS:

- 4 year extended compressor warranty
- Air defrost time clock
- Compressor unloading
- Copper or coated condenser fins
- Crankcase pressure regulator
- Electric Defrost with heater contactors, timer, block out relay
- Evap sub circuit fusing
- Fused disconnect
- Heated and insulated receiver - not UL

- Hot Gas Defrost components
- Liquid line solenoid valve
- Oil separator
- Oversized receiver
- Phase loss monitor
- Sentronic oil safety control
- Spring loaded relief valve
- Stainless steel hoses
- Suction line accumulator
- Non-Fused Disconnect

* Contact factory for details.



Russell

HTPG, a division of Carrier Commercial Refrigeration Inc.

The outdoor housing of our condensing units have completely re-engineered. Access to all components is now more convenient than ever. Quick removal of top and side panels allows quick access to everything. The hinged control panel door swings wide open for maximum clearance while the unit is being serviced.

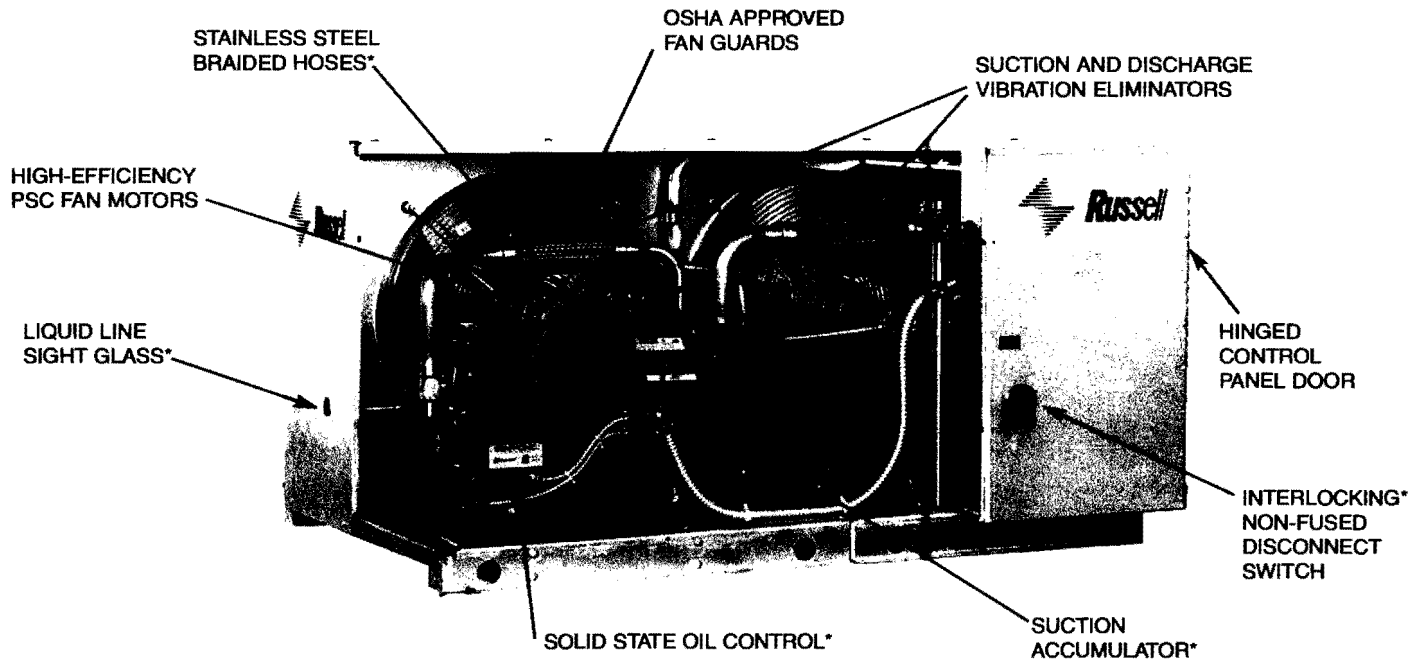

The large control panel has abundant space for the controls you choose. They are intelligently arranged and laid out in a logical fashion which is easy to understand and work with. Each control and wire is clearly marked with a name or number as shown on the wiring diagram which is conveniently affixed to the control panel door.

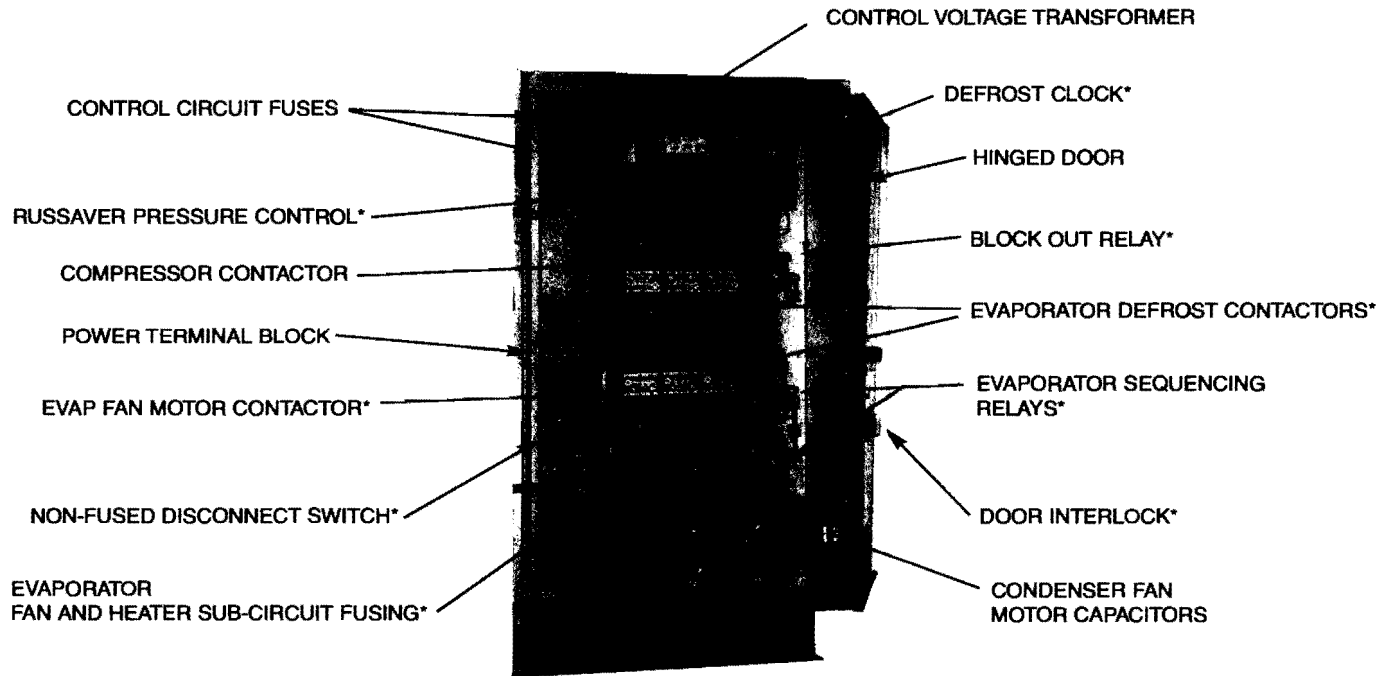

S ← I-95 → N

* Embankment

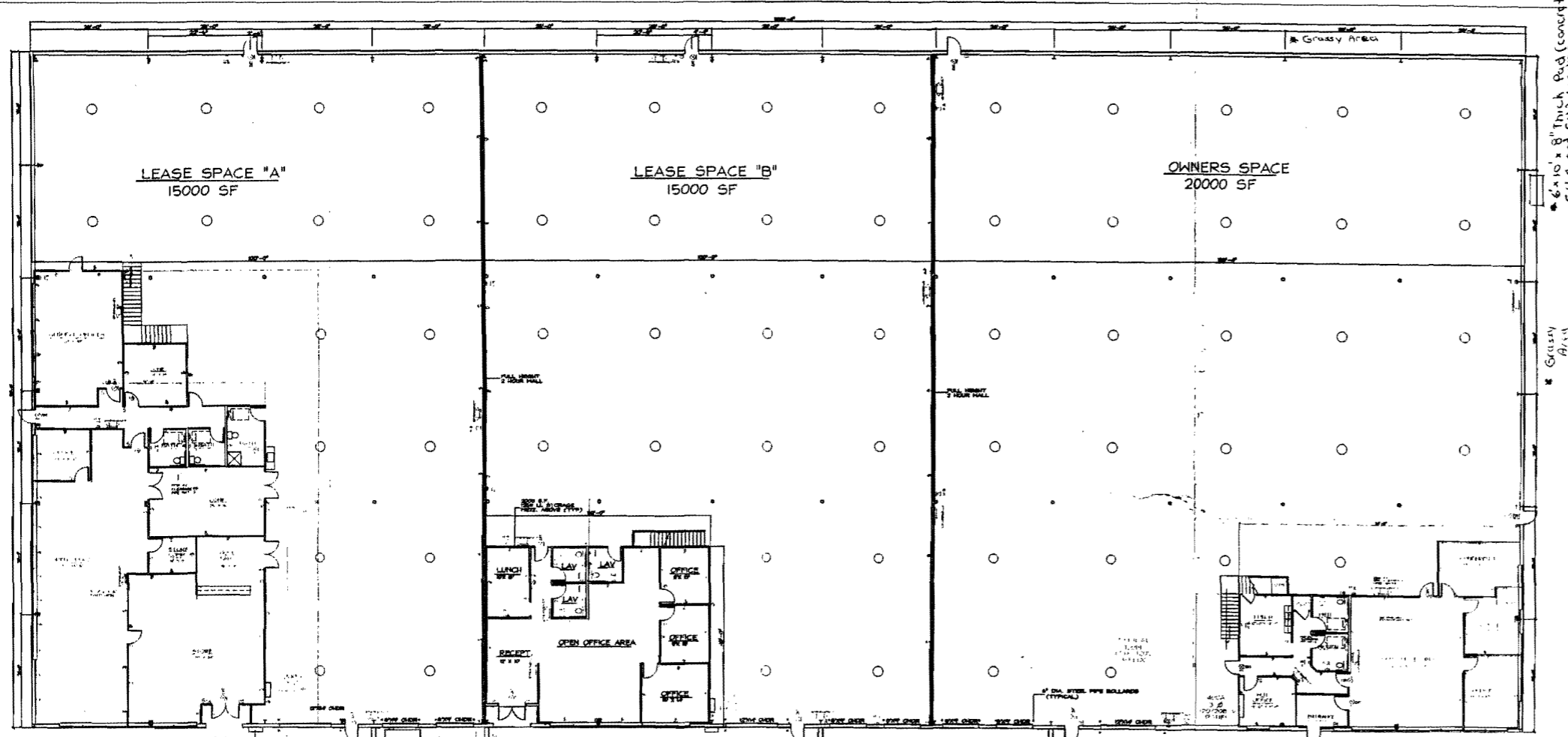

Parking Lot
Entire Length of
Structure

GENERAL NOTE
AND EMERGENCY LIGHTING AS REQUIRED
FROM SITE TO THE FINISHED LEVEL
TERMINATED

NO.	DESCRIPTION	DATE
1	REVISION	
2	REVISION	
3	REVISION	
4	REVISION	
5	REVISION	

- DESIGNER'S NOTES:
- 1) ALL DIMENSIONS ARE UNLESS OTHERWISE SPECIFIED BY THE ARCHITECT. DIMENSIONS ARE NOT TO BE PRELIMINARY AND SHALL BE SUBJECT TO THE REQUIREMENTS OF THE CONTRACTOR.
 - 2) THE OPERATIONAL USE IS SPECIFIED BY THE OWNER AND SUBJECT TO THE APPROVAL OF THE LOCAL AGENCIES AND THE ENGINEER.
 - 3) ALL MATERIALS AND CONSTRUCTION SHALL BE SUBJECT TO THE APPROVAL OF THE LOCAL AGENCIES AND THE ENGINEER.
 - 4) ALL MATERIALS AND CONSTRUCTION SHALL BE SUBJECT TO THE APPROVAL OF THE LOCAL AGENCIES AND THE ENGINEER.
 - 5) ALL MATERIALS AND CONSTRUCTION SHALL BE SUBJECT TO THE APPROVAL OF THE LOCAL AGENCIES AND THE ENGINEER.
 - 6) REMOVE HEADS EXCEPT PER LOCAL CODES.

ALLEN & COLE'S
ARCHITECTS

REGISTERED ARCHITECTS
SINCE 1911

PATCO
REGISTERED PROFESSIONAL ENGINEERS

DATE: 02/04	REVISION: REVISION	SHEET: E-1
SCALE: 1/8" = 1'-0"	PROJECT: REVISION	
DRAWN BY: [Name]	DESIGN: [Name]	
CHECKED BY: [Name]	APPROVED BY: [Name]	



CITY OF PORTLAND, MAINE

Department of Building Inspections

Original Receipt

1-21 20 11

Received from Southern Maine Ref.

Location of Work 111 Pine Tree

Cost of Construction \$ _____ Building Fee: _____

Permit Fee \$ _____ Site Fee: _____

Certificate of Occupancy Fee: _____

Total: 100

Building (IL) _____ Plumbing (IS) _____ Electrical (I2) _____ Site Plan (U2) _____

Other _____

CBL: _____

Check #: 3076 Total Collected \$ 100

**No work is to be started until permit issued.
Please keep original receipt for your records.**

Taken by: [Signature]

WHITE - Applicant's Copy
YELLOW - Office Copy
PINK - Permit Copy