

PERMIT ISSUED

City of Portland, Maine - Building or Use Permit Application
 389 Congress Street, 04101 Tel: (207) 874-8703, Fax: (207) 874-8716

Permit No: 05-089	Issue Date: JUL 6 2005	CBL: 250 C011001
----------------------	---------------------------	---------------------

Location of Construction: 1535 Westbrook St	Owner Name: Kelly Carbone & Bob Whiting	Owner Address: 1535 Westbrook St	Phone: 338-3076
Business Name:	Contractor Name: self	Contractor Address: CITY OF PORTLAND Portland	Phone:
Lessee/Buyer's Name	Phone:	Permit Type: Swimming Pools	Zone: R-1

Past Use: Single Family	Proposed Use: Single Family w/18' x 48" inflatable pool	Permit Fee: \$30.00	Cost of Work: \$300.00	CEO District: 3
Proposed Project Description: Install a 18' x 48" inflatable pool		FIRE DEPT: <input type="checkbox"/> Approved <input type="checkbox"/> Denied	INSPECTION: Use Group: R3 Type: POOL Signature: JMB 7/6/05	
		PEDESTRIAN ACTIVITIES DISTRICT (P.A.D.) Action: <input type="checkbox"/> Approved <input type="checkbox"/> Approved w/Conditions <input type="checkbox"/> Denied Signature: Date:		

Permit Taken By: jmb	Date Applied For: 07/06/2005	Zoning Approval	
-------------------------	---------------------------------	------------------------	--

1. This permit application does not preclude the Applicant(s) from meeting applicable State and Federal Rules. 2. Building permits do not include plumbing, septic or electrical work. 3. Building permits are void if work is not started within six (6) months of the date of issuance. False information may invalidate a building permit and stop all work..	Special Zone or Reviews <input type="checkbox"/> Shoreland <input type="checkbox"/> Wetland <input type="checkbox"/> Flood Zone <input type="checkbox"/> Subdivision <input type="checkbox"/> Site Plan Maj <input type="checkbox"/> Minor <input type="checkbox"/> MM <input type="checkbox"/> Date: JMB 7/6/05	Zoning Appeal <input type="checkbox"/> Variance <input type="checkbox"/> Miscellaneous <input type="checkbox"/> Conditional Use <input type="checkbox"/> Interpretation <input type="checkbox"/> Approved <input type="checkbox"/> Denied Date:	Historic Preservation <input checked="" type="checkbox"/> Not in District or Landmark <input type="checkbox"/> Does Not Require Review <input type="checkbox"/> Requires Review <input type="checkbox"/> Approved <input type="checkbox"/> Approved w/Conditions <input type="checkbox"/> Denied Date: JMB
--	--	---	--

CERTIFICATION

I hereby certify that I am the owner of record of the named property, or that the proposed work is authorized by the owner of record and that I have been authorized by the owner to make this application as his authorized agent and I agree to conform to all applicable laws of this jurisdiction. In addition, if a permit for work described in the application is issued, I certify that the code official's authorized representative shall have the authority to enter all areas covered by such permit at any reasonable hour to enforce the provision of the code(s) applicable to such permit.

SIGNATURE OF APPLICANT	ADDRESS	DATE	PHONE
RESPONSIBLE PERSON IN CHARGE OF WORK, TITLE		DATE	PHONE

DISPLAY THIS CARD ON PRINCIPAL FRONTAGE

CITY OF PORTLAND

BUILDING DEPARTMENT

PERMIT

PERMIT ISSUED

JUL 6 2005

Permit Number: 050891

CITY OF PORTLAND

Please Read
Application And
Notes, If Any,
Attached

This is to certify that Kelly Carbone & Bob Whiting self

has permission to Install a 18' x 48" inflatable p

AT 1535 Westbrook St

250 C011001

provided that the person or persons, firm or corporation accepting this permit shall comply with all of the provisions of the Statutes of Maine and of the ordinances of the City of Portland regulating the construction, maintenance and use of buildings and structures, and of the application on file in this department.

Apply to Public Works for street line and grade if nature of work requires such information.

Notification of inspection must be given and work on permit must be completed before this building or part thereof is closed or enclosed. 24 HOUR NOTICE IS REQUIRED.

A certificate of occupancy must be procured by owner before this building or part thereof is occupied.

OTHER REQUIRED APPROVALS

- Fire Dept. _____
- Health Dept. _____
- Appeal Board _____
- Other _____

Department Name

Deanne Burke 7/6/05
Director - Building & Inspection Services

PENALTY FOR REMOVING THIS CARD

City of Portland, Maine - Building or Use Permit

389 Congress Street, 04101 Tel: (207) 874-8703, Fax: (207) 874-8716

Permit No: 05-0891	Date Applied For: 07/06/2005	CBL: 250 C011001
-----------------------	---------------------------------	---------------------

Location of Construction: 1535 Westbrook St	Owner Name: Kelly Carbone & Bob Whiting	Owner Address: 1535 Westbrook St.	Phone: () 838-3076
Business Name:	Contractor Name: self	Contractor Address: Portland	Phone:
Lessee/Buyer's Name	Phone:	Permit Type: Swimming Pools	

Proposed Use: Single Family w/18' x 48" inflatable pool	Proposed Project Description: Install a 18' x 48" inflatable pool
--	--

Dept: Zoning	Status: Approved	Reviewer: Jeanine Bourke	Approval Date: 07/06/2005
Note:			Ok to Issue: <input checked="" type="checkbox"/>

Dept: Building	Status: Approved with Conditions	Reviewer: Jeanine Bourke	Approval Date: 07/06/2005
Note:			Ok to Issue: <input checked="" type="checkbox"/>
1) Spec sheet on the height of the pool must be submitted to this office			
2) A bill of sale or deed to verify ownership shall be submitted to this office			

All Purpose Building Permit Application

If you or the property owner owes real estate or personal property taxes or user charges on any property within the City, payment arrangements must be made before permits of any kind are accepted.

Location/Address of Construction: <u>1535 Westbrook</u>		
Total Square Footage of Proposed Structure <u>55775</u>	Square Footage of Lot <u>18' X 48' Pool</u>	
Tax Assessor's Chart, Block & Lot Chart# <u>250</u> Block# <u>C</u> Lot# <u>11</u>	Owner: <u>Kelly Carbone / Bob Whiting</u>	Telephone: <u>207-838-3076</u>
Lessee/Buyer's Name (If Applicable)	Applicant name, address & telephone: <u>Bob Whiting</u> <u>1535 Westbrook St.</u> <u>Portland Me 04102</u>	Cost Of Work: \$ <u>300.00</u> Fee: \$ <u>30.00</u>
Current use: <u>Single Family Home</u>		
If the location is currently vacant, what was prior use: _____		
Approximately how long has it been vacant: _____		
Proposed use: <u>Same</u> <u>18x48 inlectable pool</u>		
Project description:		
Contractor's name, address & telephone: <u>Bob Whiting</u>		
Who should we contact when the permit is ready: _____		
Mailing address:		
We will contact you by phone when the permit is ready. You must come in and pick up the permit and review the requirements before starting any work, with a Plan Reviewer. A stop work order will be issued and a \$100.00 fee if any work starts before the permit is picked up. PHONE: <u>207-838-3076</u>		

IF THE REQUIRED INFORMATION IS NOT INCLUDED IN THE SUBMISSIONS THE PERMIT WILL BE AUTOMATICALLY DENIED AT THE DISCRETION OF THE BUILDING/PLANNING DEPARTMENT, WE MAY REQUIRE ADDITIONAL INFORMATION IN ORDER TO APPROVE THIS PERMIT.

I hereby certify that I am the Owner of record of the named property, or that the owner of record authorizes the proposed work and that I have been authorized by the owner to make this application as his/her authorized agent. I agree to conform to all applicable laws of this jurisdiction. In addition, if a permit for work described in this application is issued, I certify that the Code Official's authorized representative shall have the authority to enter all areas covered by this permit at any reasonable hour to enforce the provisions of the codes applicable to this permit.

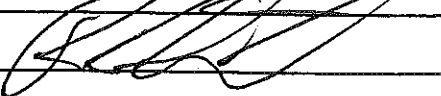
Signature of applicant: 	Date: <u>7/10/03</u>
---	----------------------

This is NOT a permit, you may not commence ANY work until the permit is issued. If you are in a Historic District you may be subject to additional permitting and fees with the Planning Department on the 4th floor of City Hall

This page contains a detailed description of the Parcel ID you selected. Press the **New Search** button at the bottom of the screen to submit a new query.

10AM
7/6
B5B
Pool

Current Owner Information

Card Number 1 of 1
 Parcel ID 250 C011001
 Location 1535 WESTBROOK ST
 Land Use SINGLE FAMILY
 Owner Address PECK LISA B
 36 FAIRLAWN DR
 CENTRAL ISLIP NY 11722
 Book/Page 14417/347
 Legal 250-C-11-10 256-B-9-8
 WESTBROOK ST 1535
 PENOBSCOT ST
 55775 SF

891
R1

Current Valuation Information

Land	Building	Total
\$51,670	\$57,020	\$108,690

New Estimated Valuation Information

Land	Building	Total	Phase-In Value
\$77,300	\$100,900	\$178,200	\$143,545

Property Information

Year Built 1920	Style Old Style	Story Height 2	Sq. Ft. 1248	Total Acres 1.28
Bedrooms 3	Full Baths 1	Half Baths	Total Rooms 6	Attic Unfin
				Basement Full

Outbuildings

Type SHED-FRAME	Quantity 1	Year Built 1920	Size 10X10	Grade C	Condition A
--------------------	---------------	--------------------	---------------	------------	----------------

Sales Information

Date	Type	Price	Book/Page
12/01/1998	LAND + BLDING	\$15,000	14417-347
08/28/1992	LAND + BLDING	\$93,125	10253-052

Picture and Sketch

[Picture](#) [Sketch](#) [Tax Map](#)

[Click here to view Tax Roll Information.](#)
 Any information concerning tax payments should be directed to the Treasury office at 874-8490 or [e-mailed](#).

[Click here](#) to view comparable sales or below to view by:



old ditch - Gully

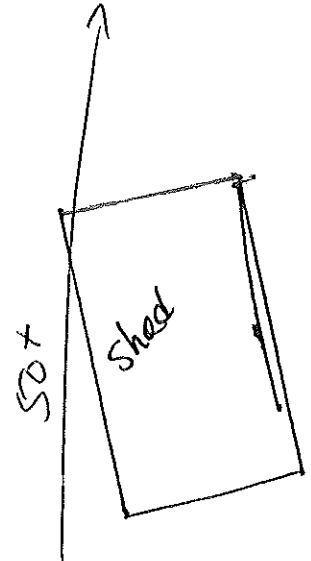

Double Lot

R1 Zone
10' min to
PLines
&
Principal Structure

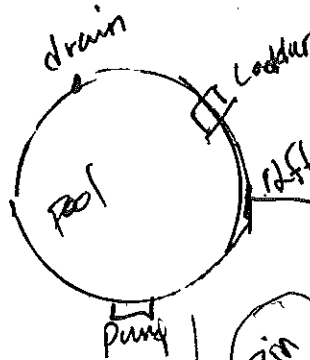

Apple Trees

75'

Pettis Prop. Line

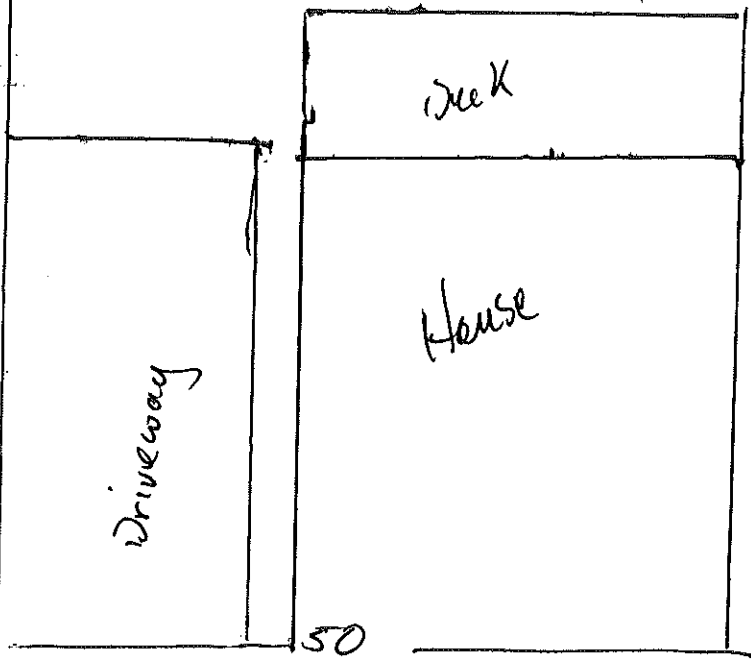
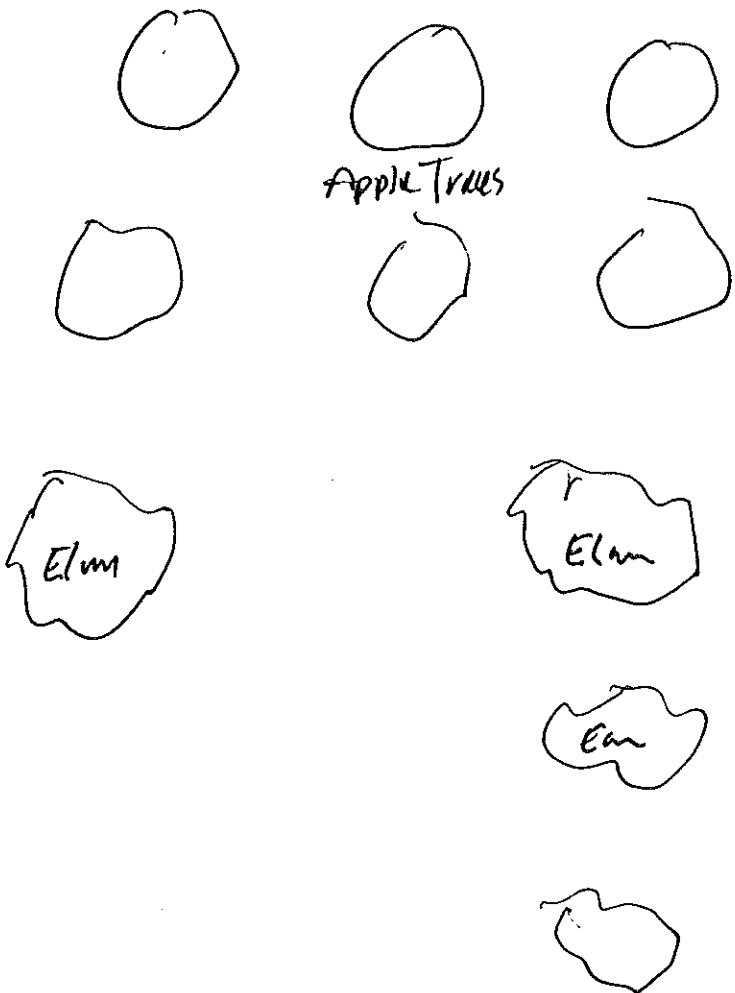

50

50

Westbrook St.



18" x 48"

portable pump

Removable ladder

BUILDING PERMIT INSPECTION PROCEDURES

Please call 874-8703 or 874-8693 to schedule your inspections as agreed upon

Permits expire in 6 months, if the project is not started or ceases for 6 months.

The Owner or their designee is required to notify the inspections office for the following inspections and provide adequate notice. Notice must be called in 48-72 hours in advance in order to schedule an inspection:

By initializing at each inspection time, you are agreeing that you understand the inspection procedure and additional fees from a "Stop Work Order" and "Stop Work Order Release" will be incurred if the procedure is not followed as stated below.

A Pre-construction Meeting will take place upon receipt of your building permit.

- Footing/Building Location Inspection: Prior to pouring concrete
- Re-Bar Schedule Inspection: Prior to pouring concrete
- Foundation Inspection: Prior to placing ANY backfill
- Framing/Rough Plumbing/Electrical: Prior to any insulating or drywalling
- Final/Certificate of Occupancy: Prior to any occupancy of the structure or use. NOTE: There is a \$75.00 fee per inspection at this point.

Certificate of Occupancy is not required for certain projects. Your inspector can advise you if your project requires a Certificate of Occupancy. All projects DO require a final inspection

If any of the inspections do not occur, the project cannot go on to the next phase, REGARDLESS OF THE NOTICE OR CIRCUMSTANCES.

NA **CERIFICATE OF OCCUPANICES MUST BE ISSUED AND PAID FOR, BEFORE THE SPACE MAY BE OCCUPIED**

[Signature]
Signature of Applicant/Designee

Date

[Signature]
Signature of Inspections Official

7/6/05
Date

CBL: 250-C-11

Building Permit #: 05-0891

1. The first part of the document is a list of names and addresses.

2. The second part is a list of names and addresses.

3. The third part is a list of names and addresses.

4. The fourth part is a list of names and addresses.

5. The fifth part is a list of names and addresses.

6. The sixth part is a list of names and addresses.

7. The seventh part is a list of names and addresses.

8. The eighth part is a list of names and addresses.

9. The ninth part is a list of names and addresses.

10. The tenth part is a list of names and addresses.

11. The eleventh part is a list of names and addresses.

12. The twelfth part is a list of names and addresses.

13. The thirteenth part is a list of names and addresses.

14. The fourteenth part is a list of names and addresses.

15. The fifteenth part is a list of names and addresses.

16. The sixteenth part is a list of names and addresses.

17. The seventeenth part is a list of names and addresses.

18. The eighteenth part is a list of names and addresses.

19. The nineteenth part is a list of names and addresses.

20. The twentieth part is a list of names and addresses.