

DISPLAY THIS CARD ON PRINCIPAL FRONTAGE OF WORK

**CITY OF PORTLAND**

BU **LD** ION

**PERMIT**

Permit Number: 081338

Please Read Application And Notes, If Any, Attached

This is to certify that MCKAY MICHAEL A

has permission to new 8' x 10' shed

OCT 23 2008

AT 1683 WESTBROOK ST CH 249 A004001

provided that the person or persons, firm or corporation accepting this permit shall comply with all of the provisions of the Statutes of Maine and of the Ordinances of the City of Portland regulating the construction, maintenance and use of buildings and structures, and of the application on file in this department.

Apply to Public Works for street line and grade if nature of work requires such information.

Notification of inspection must be given and written permission procured before this building or part thereof is lath or other closed-in. 2 HOURLY NOTICE IS REQUIRED.

A certificate of occupancy must be procured by owner before this building or part thereof is occupied.

OTHER REQUIRED APPROVALS

- Fire Dept. \_\_\_\_\_
- Health Dept. \_\_\_\_\_
- Appeal Board \_\_\_\_\_
- Other \_\_\_\_\_  
Department Name

*Thomas H. MacLean* 10/23/08  
Director - Building & Inspection Services

**PENALTY FOR REMOVING THIS CARD**

**City of Portland, Maine - Building or Use Permit Application**

389 Congress Street, 04101 Tel: (207) 874-8703, Fax: (207) 874-8716

Permit No: 08-1338	Issue Date:	CBL: 249 A004001
-----------------------	-------------	---------------------

Location of Construction: 1683 WESTBROOK ST	Owner Name: MCKAY MICHAEL A	Owner Address: 1683 WESTBROOK ST	Phone:
Business Name:	Contractor Name:	Contractor Address:	Phone:
Lessee/Buyer's Name	Phone:	Permit Type: Sheds	Zone: R25

Past Use: Single Family Home	Proposed Use: Single Family Home - new 8' x 10' shed	Permit Fee: \$50.00	Cost of Work: \$2,500.00	CEO District: 3
Proposed Project Description: new 8' x 10' shed		FIRE DEPT: <input type="checkbox"/> Approved <input type="checkbox"/> Denied	INSPECTION: Use Group: R23 Type: SB  IRC 2003	
		Signature: <i>Jm 10/23/08</i>		Signature: <i>Jm 10/23/08</i>
PEDESTRIAN ACTIVITIES DISTRICT (P.A.D.)				
Action: <input type="checkbox"/> Approved <input type="checkbox"/> Approved w/Conditions <input type="checkbox"/> Denied				
Signature: _____ Date: _____				

Permit Taken By: ldobson	Date Applied For: 10/23/2008	<b>Zoning Approval</b>		
-----------------------------	---------------------------------	------------------------	--	--

<p>1. This permit application does not preclude the Applicant(s) from meeting applicable State and Federal Rules.</p> <p>2. Building permits do not include plumbing, septic or electrical work.</p> <p>3. Building permits are void if work is not started within six (6) months of the date of issuance. False information may invalidate a building permit and stop all work..</p>	<p><b>Special Zone or Reviews</b></p> <input type="checkbox"/> Shoreland <input type="checkbox"/> Wetland <input type="checkbox"/> Flood Zone <i>OK</i> <input type="checkbox"/> Subdivision <input type="checkbox"/> Site Plan Maj <input type="checkbox"/> Minor <input type="checkbox"/> MM <input type="checkbox"/> Date: <i>Jm 10/22/08</i>	<p><b>Zoning Appeal</b></p> <input type="checkbox"/> Variance <input type="checkbox"/> Miscellaneous <input type="checkbox"/> Conditional Use <input type="checkbox"/> Interpretation <input type="checkbox"/> Approved <input type="checkbox"/> Denied Date: _____	<p><b>Historic Preservation</b></p> <input checked="" type="checkbox"/> Not in District or Landmark <input checked="" type="checkbox"/> Does Not Require Review <input type="checkbox"/> Requires Review <input type="checkbox"/> Approved <input type="checkbox"/> Approved w/Conditions <input type="checkbox"/> Denied Date: <i>Jm 10/23/08</i>
	OCT 23 2008		

**CERTIFICATION**

I hereby certify that I am the owner of record of the named property, or that the proposed work is authorized by the owner of record and that I have been authorized by the owner to make this application as his authorized agent and I agree to conform to all applicable laws of this jurisdiction. In addition, if a permit for work described in the application is issued, I certify that the code official's authorized representative shall have the authority to enter all areas covered by such permit at any reasonable hour to enforce the provision of the code(s) applicable to such permit.

SIGNATURE OF APPLICANT	ADDRESS	DATE	PHONE
RESPONSIBLE PERSON IN CHARGE OF WORK, TITLE		DATE	PHONE

**City of Portland, Maine - Building or Use Permit**

389 Congress Street, 04101 Tel: (207) 874-8703, Fax: (207) 874-8716

<b>Permit No:</b> 08-1338	<b>Date Applied For:</b> 10/23/2008	<b>CBL:</b> 249 A004001
------------------------------	--	----------------------------

<b>Location of Construction:</b> 1683 WESTBROOK ST	<b>Owner Name:</b> MCKAY MICHAEL A	<b>Owner Address:</b> 1683 WESTBROOK ST	<b>Phone:</b>
<b>Business Name:</b>	<b>Contractor Name:</b>	<b>Contractor Address:</b>	<b>Phone:</b>
<b>Lessee/Buyer's Name</b>	<b>Phone:</b>	<b>Permit Type:</b> Sheds	

<b>Proposed Use:</b> Single Family Home - new 8' x 10' shed	<b>Proposed Project Description:</b> new 8' x 10' shed
--	---

<b>Dept:</b> Zoning	<b>Status:</b> Approved	<b>Reviewer:</b> Tom Markley	<b>Approval Date:</b> 10/23/2008
<b>Note:</b>			<b>Ok to Issue:</b> <input checked="" type="checkbox"/>
1) This is NOT an approval for an additional dwelling unit. You SHALL NOT add any additional kitchen equipment including, but not limited to items such as stoves, microwaves, refrigerators, or kitchen sinks, etc. Without special approvals.			
2) This property shall remain a single family dwelling. Any change of use shall require a separate permit application for review and approval.			
<b>Dept:</b> Building	<b>Status:</b> Approved with Conditions	<b>Reviewer:</b> Tom Markley	<b>Approval Date:</b> 10/23/2008
<b>Note:</b>			<b>Ok to Issue:</b> <input checked="" type="checkbox"/>
1) Application approval based upon information provided by applicant. Any deviation from approved plans requires separate review and approval prior to work.			



# General Building Permit Application

If you or the property owner owes real estate or personal property taxes or user charges on any property within the City, payment arrangements must be made before permits of any kind are accepted.

Location/Address of Construction: <u>1683 WESTBROOK ST</u>		
Total Square Footage of Proposed Structure/Area <u>8'x10'</u>	Square Footage of Lot	Number of Stories <u>1</u>
Tax Assessor's Chart, Block & Lot Chart#      Block#      Lot#	Applicant * <b>must be owner, Lessee or Buyer</b> * Name <u>MICHAEL MCKAY</u> Address <u>1683 WESTBROOK ST</u> City, State & Zip <u>PORTLAND ME 04102</u>	Telephone: <u>207-899-2368</u>
Lessee/DBA (If Applicable)	Owner (if different from Applicant) Name Address City, State & Zip	Cost Of Work: \$ <u>2500.00</u> C of O Fee: \$ _____ Total Fee: \$ <u>2500.00</u>
Current legal use (i.e. single family) _____ Number of Residential Units <u>2</u>		
If vacant, what was the previous use? _____		
Proposed Specific use: <u>SHED, GARDEN EQUIPMENT</u>		
Is property part of a subdivision? _____ If yes, please name _____		
Project description: <u>8'x10'</u>		
Contractor's name: <u>Sheds USA / Millstones</u>		
Address: <u>Payne Rd</u>		
City, State & Zip: <u>Scarborough</u>		Telephone: <u>866-616-2687</u>
Who should we contact when the permit is ready: <u>MICHAEL MCKAY</u>		Telephone: <u>899-2368</u>
Mailing address: <u>1683 Westbrook St, Portland ME 04102</u>		

**Please submit all of the information outlined on the applicable Checklist. Failure to do so will result in the automatic denial of your permit.**

In order to be sure the City fully understands the full scope of the project, the Planning and Development Department may request additional information prior to the issuance of a permit. For further information or to download copies of this form and other applications visit the Inspections Division on-line at [www.portlandmaine.gov](http://www.portlandmaine.gov), or stop by the Inspections Division office, room 315 City Hall or call 874-8703.

I hereby certify that I am the Owner of record of the named property, or that the owner of record authorizes the proposed work and that I have been authorized by the owner to make this application as his/her authorized agent. I agree to conform to all applicable laws of this jurisdiction. In addition, if a permit for work described in this application is issued, I certify that the Code Official's authorized representative shall have the authority to enter all areas covered by this permit at any reasonable hour to enforce the provisions of the codes applicable to this permit.

Signature: Richard Michel      Date: 10-23-08

**This is not a permit; you may not commence ANY work until the permit is issue**

10/22/08

Specifications for erection of an outbuilding:

1683 Westbrook Street  
Portland, Maine 04102  
Cumberland County

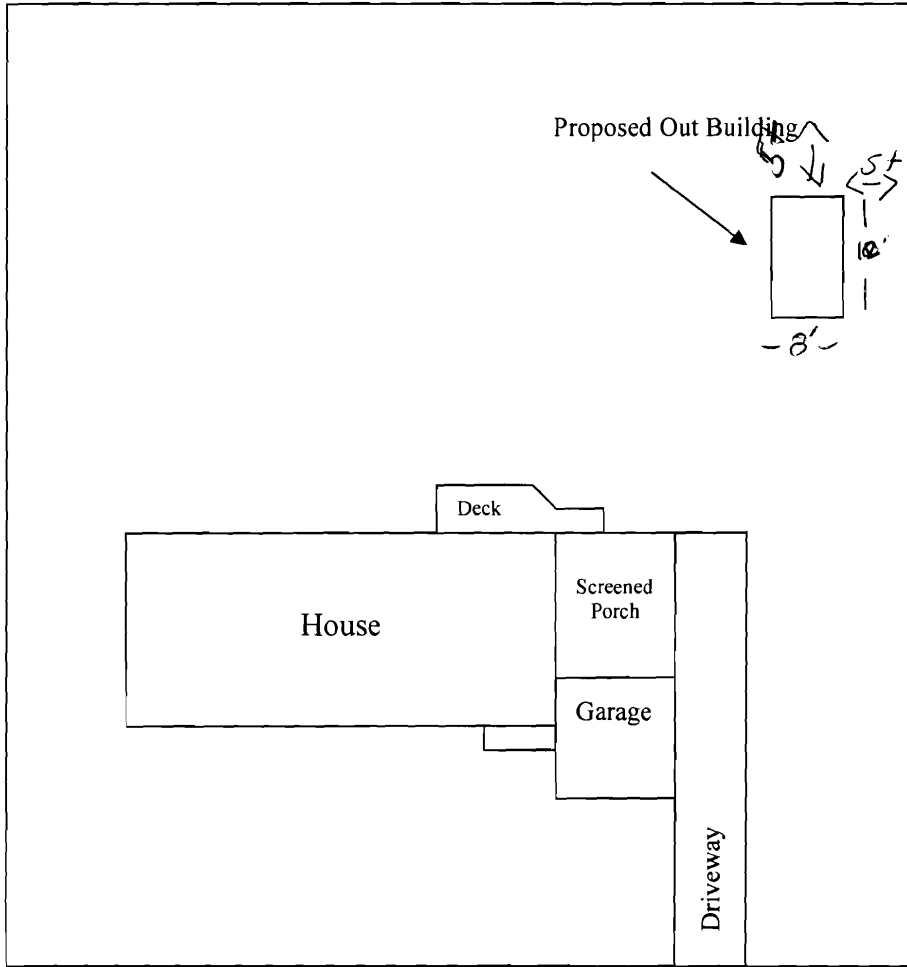
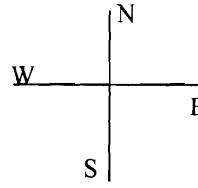

Westbrook Street

# Smart Siding

8' x 8' peak roof, black shingles

# Pine

8' x 12' extended peak roof  
white/gray shingles  
Options: gable vent



SMART SIDING SHED SIZE & PRICE



PINE SHED SIZE & PRICE

SIZE (WxD)	6' wall HEIGHT	7' wall HEIGHT
6' x 6'	\$1,239	\$1,399
6' x 8'	\$1,329	\$1,519
8' x 8'	\$1,459	\$1,659
8' x 10'	\$1,719	\$1,949
8' x 12'	\$1,979	\$2,229
8' x 14'	\$2,339	\$2,669
8' x 16'	\$2,639	\$2,929
10' x 10'	\$2,139	\$2,369
10' x 12'	\$2,479	\$2,819
10' x 14'	\$2,869	\$3,269
10' x 16'	\$3,129	\$3,569
10' x 18'	\$3,469	\$3,909
12' x 12'	\$2,869	\$3,269
12' x 14'	\$3,259	\$3,739
12' x 16'	\$3,489	\$3,999
12' x 18'	\$3,969	\$4,529
12' x 20'	\$4,439	\$5,049

## Why Smart Siding?

Our pre-primed engineered wood siding is tough on everything except your wallet. If you're looking for attractive durability at a value price we recommend Smart Siding.

- Pre-primed surface offers exceptional paint adhesion
- Smart Siding is knot free
- Trim and doors are unfinished pine
- All backed by **Sheds USA Lifetime Warranty**

*17% deposit*

SIZE (WxD)	6' wall HEIGHT	7' wall HEIGHT
6' x 6'	\$1,359	\$1,539
6' x 8'	\$1,449	\$1,639
8' x 8'	\$1,599	\$1,809
8' x 10'	\$1,839	\$2,029
8' x 12'	\$2,149	\$2,399
8' x 14'	\$2,459	\$2,699
8' x 16'	\$2,699	\$3,049
10' x 10'	\$2,199	\$2,459
10' x 12'	\$2,629	\$2,949
10' x 14'	\$2,939	\$3,279
10' x 16'	\$3,259	\$3,669
10' x 18'	\$3,569	\$4,029
12' x 12'	\$2,989	\$3,399
12' x 14'	\$3,339	\$3,809
12' x 16'	\$3,649	\$4,159
12' x 18'	\$4,089	\$4,639
12' x 20'	\$4,529	\$5,149

## Why Pine?

For generations builders have been using pine siding. It's a New England tradition that will answer all your storage needs and flatter your yard for a lifetime.

- New England's most popular wood siding
- Solid tongue and groove construction
- Paint or stain to match your house
- All backed by **Sheds USA Lifetime Warranty**

## Quality Construction

✓ **Best Shed Warranty** ✓ **FREE Delivery and Installation**



Most sheds are built within 3 hours of arrival.

**Call toll-free at 866.616.2687 or visit [www.millstores.com](http://www.millstores.com)**