

Project Design Notes –

DC System: 11.52 kW_{DC} Photovoltaic Array
 (36) 320-watt, 60-Cell Modules
 Module Type: LG315N1C-G4 NeON 2
 Dimensions: 64.57" x 39.37" x 1.57"

AC System: 9 kW_{AC}
 (1) SolarEdge 9kW Grid-tied Inverters
 (36) SolarEdge P320 DC Optimizers

Racking System: Top of Pole Mount
 Array Tilt: 40° Array Azimuth: 180°

Final Layout to be determined by the customer, but poles will be located on the Western edge of the parking lot



142 Presumpscot Street
 Portland, ME 04103
 (207) 221-6342

Customer Name:

Patrons Oxford Insurance
 97 Technology Park Drive
 Portland ME, 04102

System Type:

11.52 kW_{DC}
 Photovoltaic Array

Designed by: LB

Date: February 24, 2017

SITE PLAN

SHEET A01

© Copyright ReVision Energy

This diagram is provided as a service and is based on the understanding of the information supplied. It is subject to change based on actual conditions, applicable edition of the National Electric Code, and local governmental authorities.

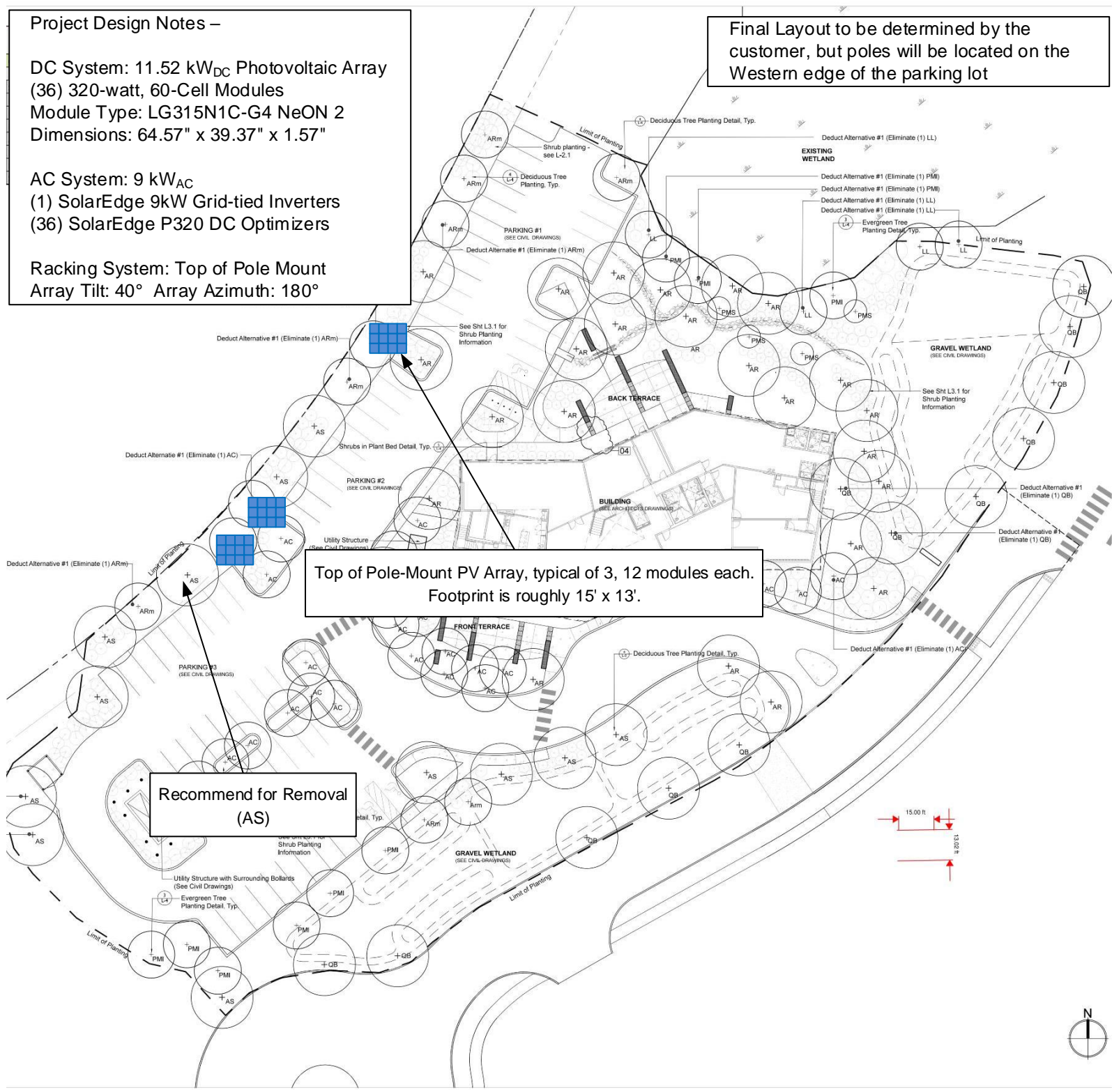

Top of Pole-Mount PV Array, typical of 3, 12 modules each.
 Footprint is roughly 15' x 13'.

Recommend for Removal
 (AS)