

- NOTES:**
1. COMPOSITE WET SET (REPLACEABLE) DETECTABLE WARNING PANELS SHALL BE AS MANUFACTURED BY ADA SOLUTIONS, INC. (WWW.ADATILE.COM), OR APPROVED EQUAL.
  2. CAST IN PLACE CONCRETE SHALL MEET SPECIFICATIONS FOR MAINE D.O.T. CLASS A STRUCTURAL CONCRETE, MINIMUM COMPRESSIVE STRENGTH 4,000 PSI. THE CONCRETE SHALL BE SEALED PRIOR TO SETTING PANELS.
  3. TRUNCATED DOMES SHALL BE ALIGNED IN ROWS, PARALLEL AND PERPENDICULAR TO THE PREDOMINANT DIRECTION OF TRAVEL. NO OTHER DETECTABLE WARNING DESIGN OR CONFIGURATION IS ALLOWED.
  4. FOR ALL DETECTABLE WARNING PANELS, WITHIN OR ABUTTING HISTORIC DISTRICTS AND HISTORIC LANDSCAPES, "DARK GRAY" COLORED (#36118) PANELS SHALL BE USED. FOLLOW MANUFACTURER'S INSTRUCTIONS FOR INSTALLATION.
  5. THE DETECTABLE WARNING PANEL SHALL HAVE ONE FULL COURSE OF PINEHALL PATHWAY PAVERS (THE CURRENT BRICK STANDARD) AROUND THE FULL PERIMETER OF THE PANEL. THIS PERIMETER COURSE SHALL BE SET USING PORTLAND MORTAR CEMENT TO CREATE A FLUSH SURFACE BETWEEN THE BRICK AND THE PANEL.
  6. SIZE: THE DETECTABLE WARNING PANEL(S) SHALL EXTEND 24 INCHES MINIMUM IN THE DIRECTION OF TRAVEL AND THE FULL WIDTH OF THE CURB RAMP, LANDING, OR BLENDED TRANSITION TO THE STREET.
  7. ORIENTATION: THE DETECTABLE WARNING PANEL SHALL BE LOCATED SO THAT THE EDGE NEAREST THE CURB LINE IS 8 INCHES MINIMUM AND 8 INCHES MAXIMUM FROM THE CURB LINE. THE PANEL SHALL BE ORIENTED TO THE DIRECTION OF TRAVEL AS IDENTIFIED BY THE POINT OF EGRESS.

**SIDEWALK RAMP DETECTABLE WARNING PANEL**  
N.T.S.

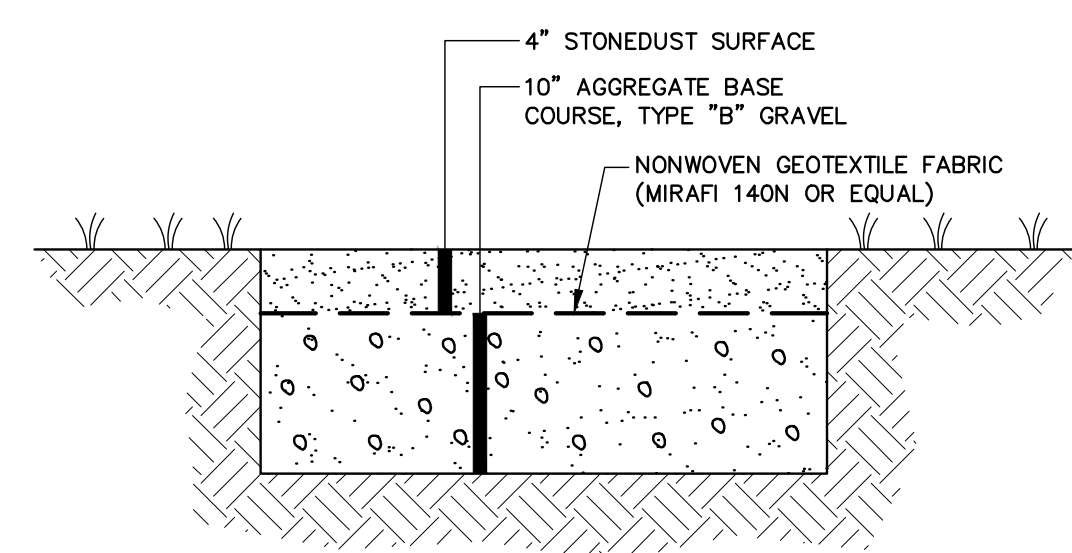

**STONE DUST WALKWAY**  
N.T.S.

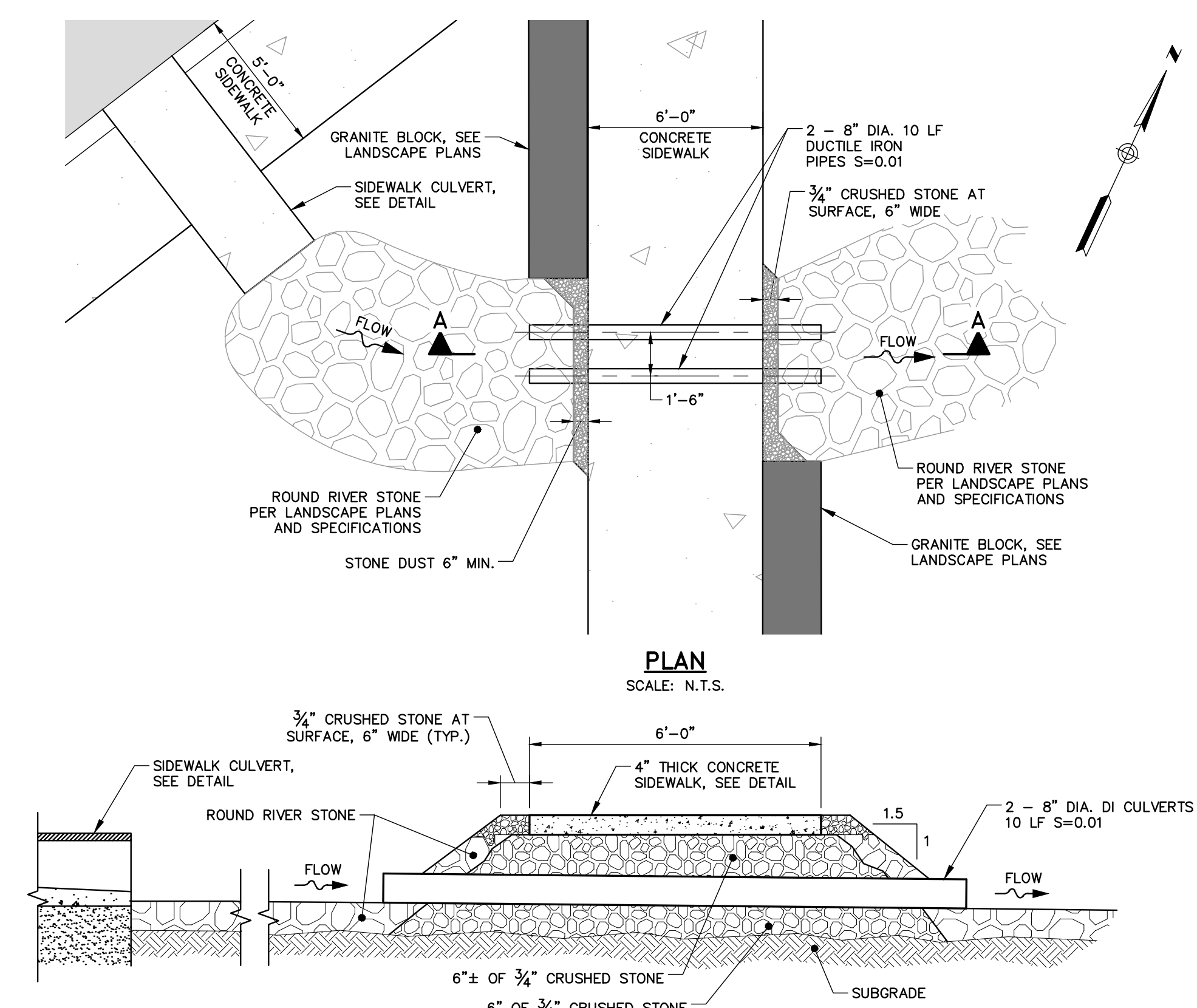

**SECTION A-A**  
SCALE: N.T.S.

**STORMWATER CROSSING**  
SCALE: N.T.S.

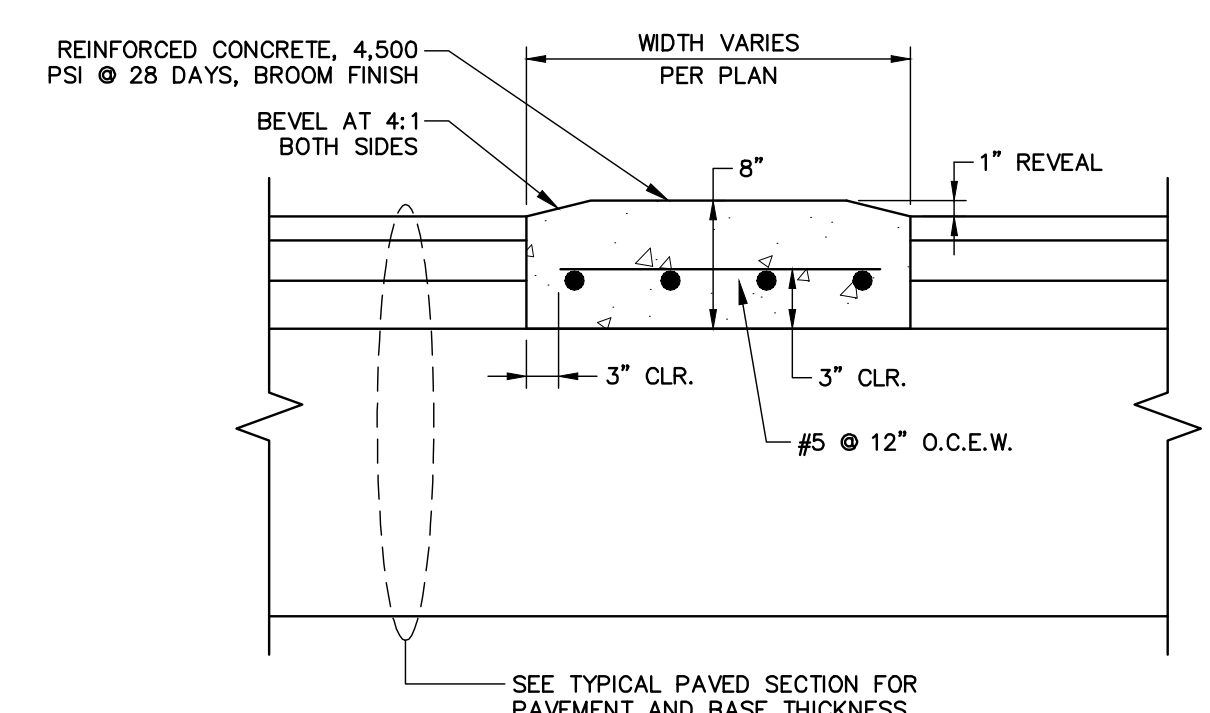

**RAISED CONCRETE ISLAND DETAIL**  
N.T.S.

**NOTE:**

1. PROVIDE PERPENDICULAR SAWCUT CONTROL JOINTS 2" DEEP EVERY 5', INFILL WITH BACKER ROD AND POLYURETHANE SEALANT.

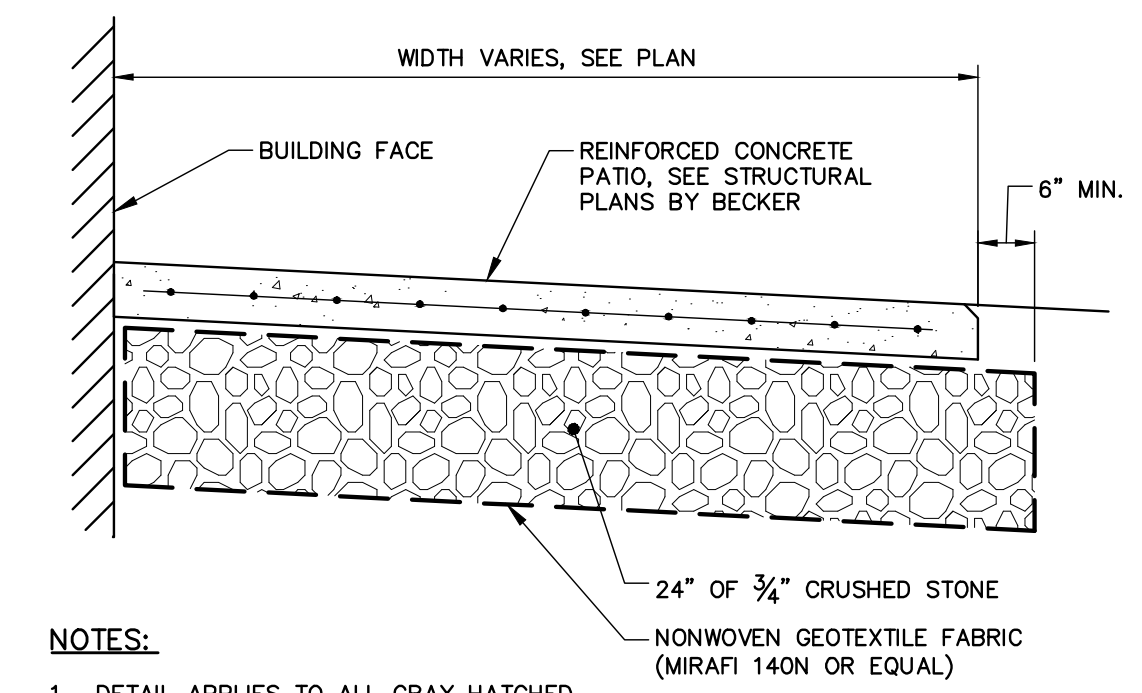

**CONCRETE PATIO DETAIL**  
N.T.S.

**NOTES:**

1. DETAIL APPLIES TO ALL GRAY HATCHED CONCRETE PATIO AND WALKWAY AREAS SHOWN ON C-02.
2. SEE STRUCTURAL PLANS FOR PATIO CONCRETE DESIGN AND ENTRANCE FROST WALL REQUIREMENTS.

PROJECT NAME:  
**PATRONS OXFORD OFFICES**  
97 TECHNOLOGY PARK DRIVE  
PORTLAND, MAINE 04102  
UNITED STATES OF AMERICA

SEAL:  
STATE OF MAINE  
DAVID A. SENUS  
10791  
01/14/2016

THIS DRAWING IS THE PROPERTY OF SCOTT SIMONS ARCHITECTS (SSA) AND IS NOT TO BE COPIED OR REPRODUCED IN PART OR WHOLE  
2018 © SCOTT SIMONS ARCHITECTS, LLC

REVISION:

1	
2	
3	
4	
5	
6	

DATE OF ISSUE: 14 JANUARY 2016  
PROJECT NUMBER: 2105-0100 PATRONS DXF DRD  
STATUS: CONSTRUCTION DOCUMENTS

CIVIL DETAILS 7