

PLAN

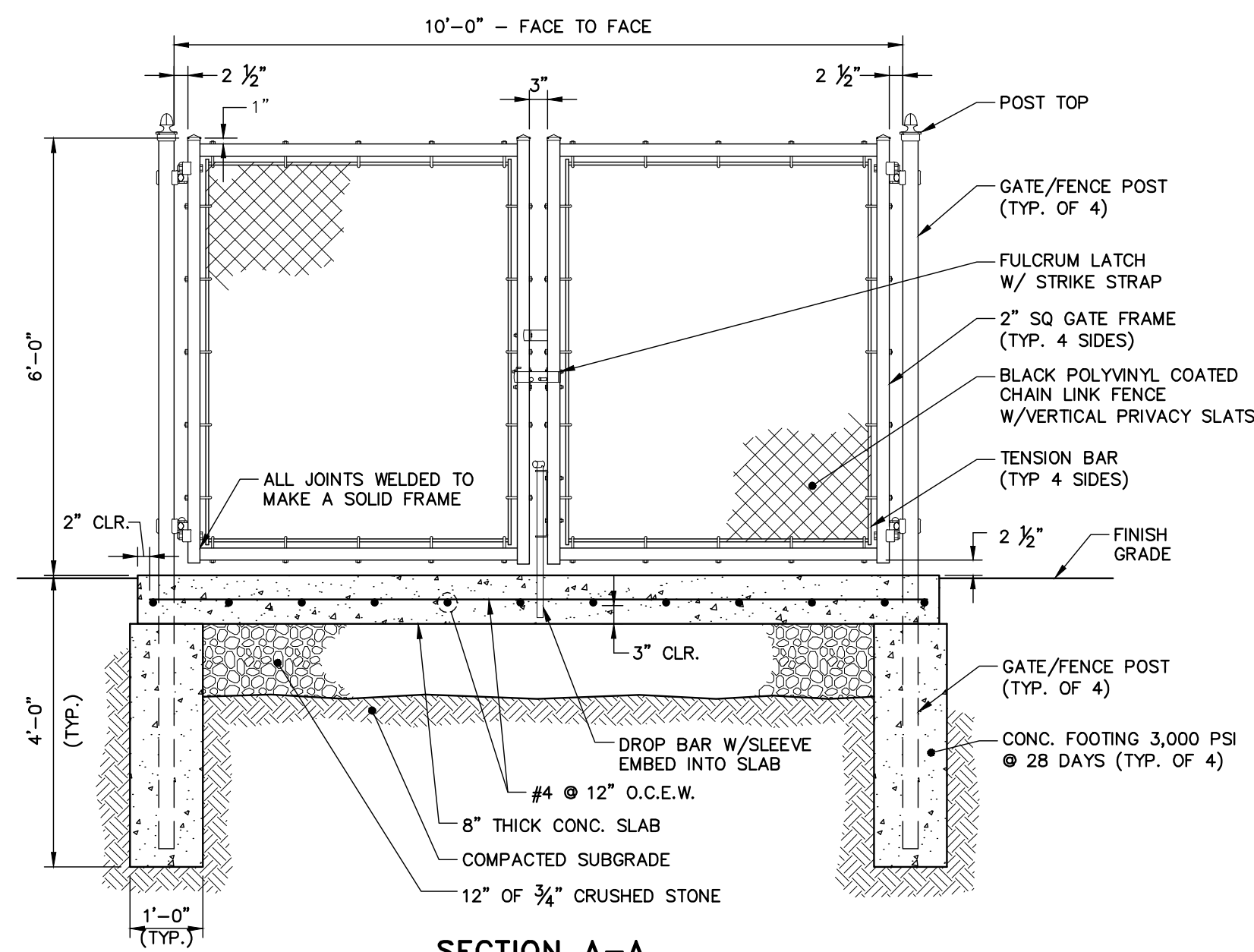

SECTION A-A

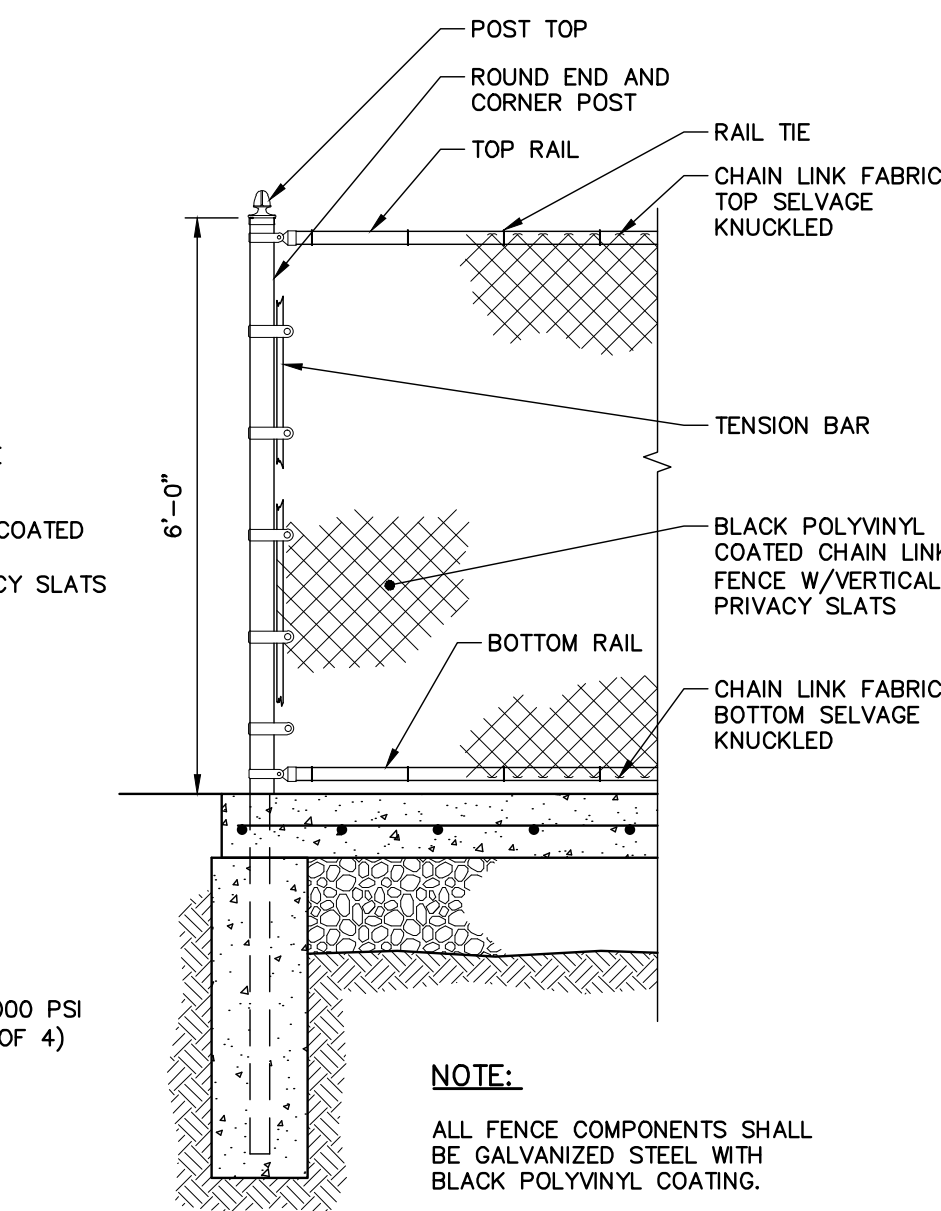

SECTION B-B

**DUMPSTER PAD DETAIL**

SCALE: 1/2" = 1'-0"

**Tools Needed for Installation**

- Tape Measure
- Marker or Pencil
- Masonry Drill Bit
- Drill (Hammer drill recommended)
- Wrench 9/16"
- Level
- Washers (for leveling if necessary)

**Recommended Base Materials:**

Solid concrete is the best base material for installation. Ask your Dero Rack representative which anchor is appropriate for your application to ensure the proper anchors are shipped with your rack. Be sure nothing is underneath the base material that could be damaged by drilling.

**Installation:**

3/8" anchors are shipped with the rack. Place the rack in the desired location. Use a marker or pencil to outline the holes of the base onto the base material. Drill the holes in accordance with the specifications shipped with the anchors. Make sure the holes are at least 6" away from any cracks in the base material.

**Tamper Resistant Fasteners**

The concrete spike is a permanent anchor. The top of the wedge anchor can also be pounded sideways after installation so that it cannot be removed. Other tamper resistant fasteners are also available for purchase.

When using the special tamper resistant nuts, always set and first tighten the anchors. Once the rack is installed, replace two nuts from the bucket (opposite sides from each other) with the tamper resistant fasteners. DO NOT OVERTIGHTEN the tamper resistant nut.

If you have any questions about installation or other features of the Dero Rack, please call us toll free at 1-800-298-4915

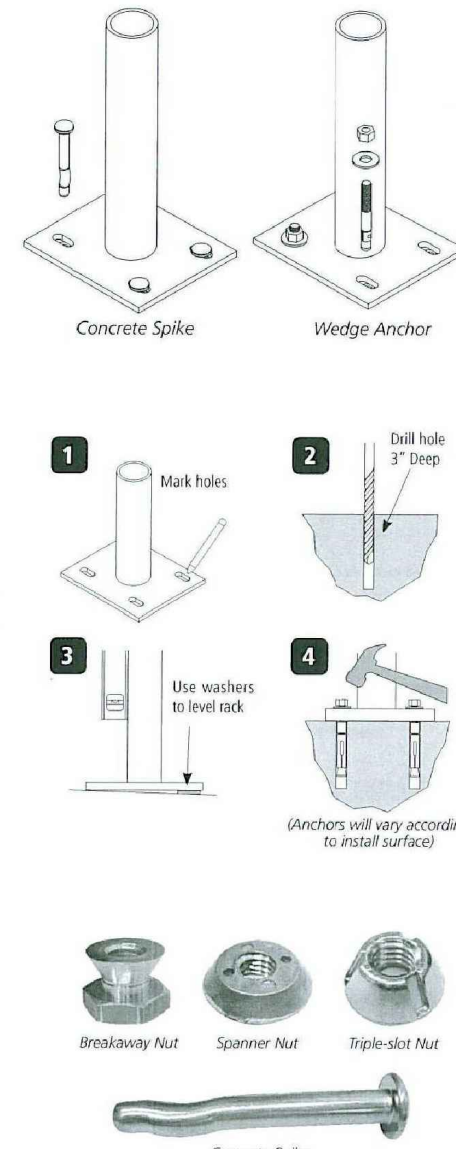

**TYPICAL BIKE RACK DETAIL**

N.T.S.

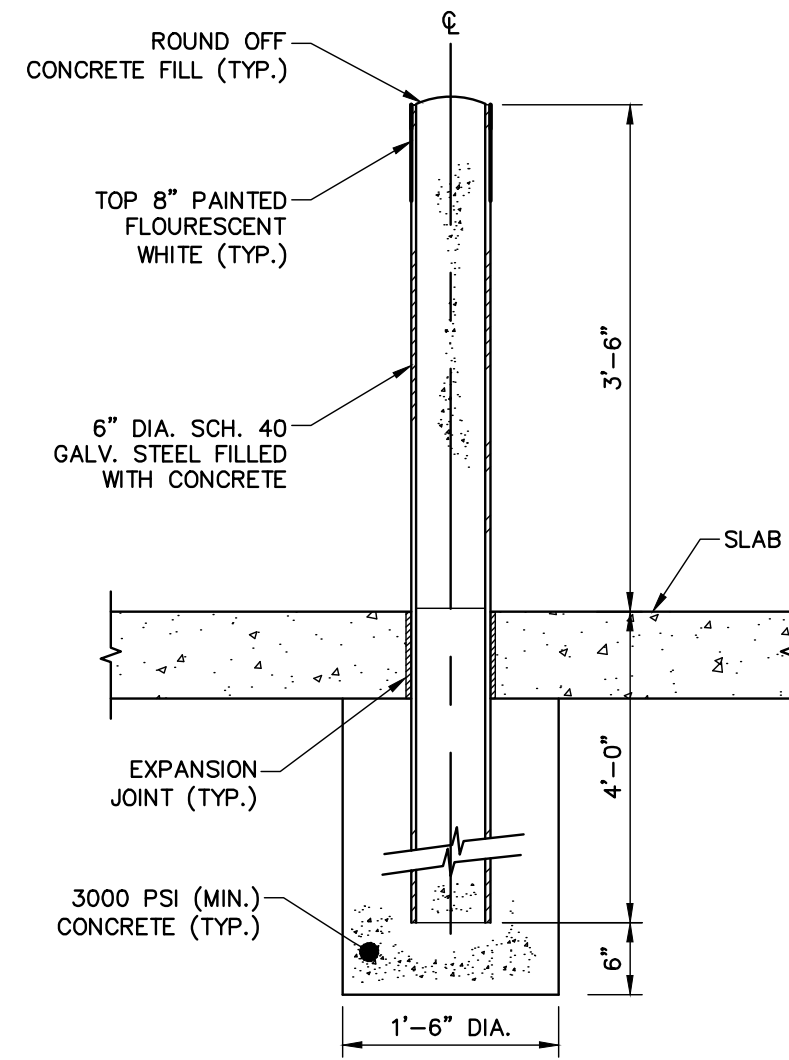

**BOLLARD DETAIL**

N.T.S.

**NOTE:**  
ALL BOLLARDS SHALL BE PAINTED. COLOR SELECTED BY OWNER.

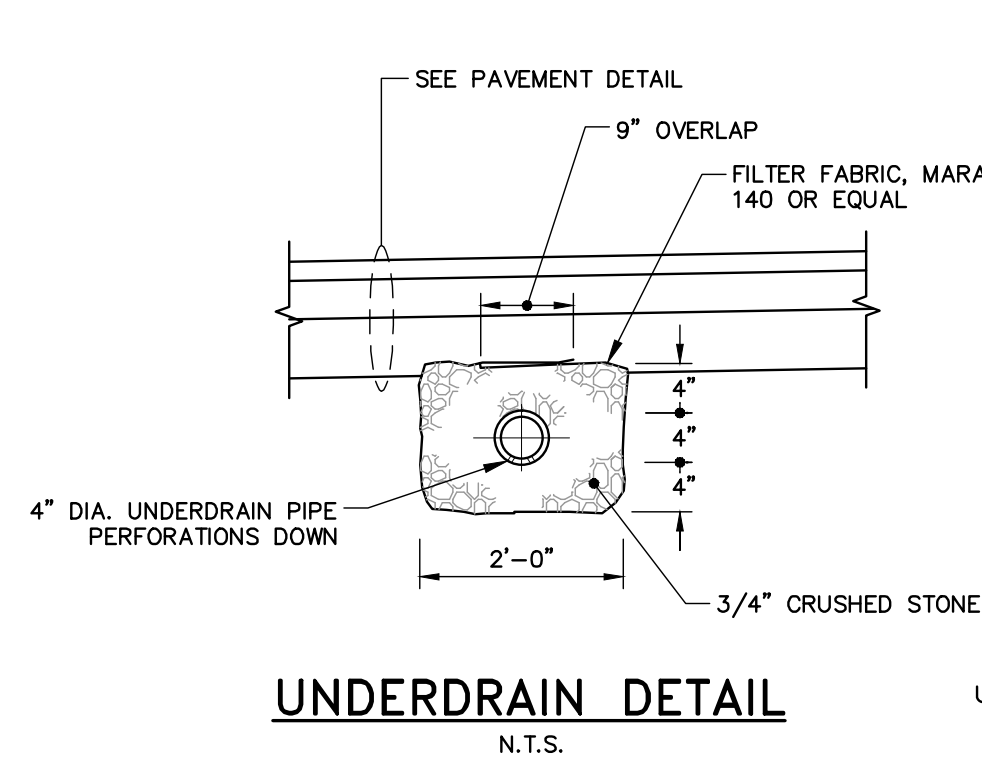

**UNDERDRAIN DETAIL**

N.T.S.

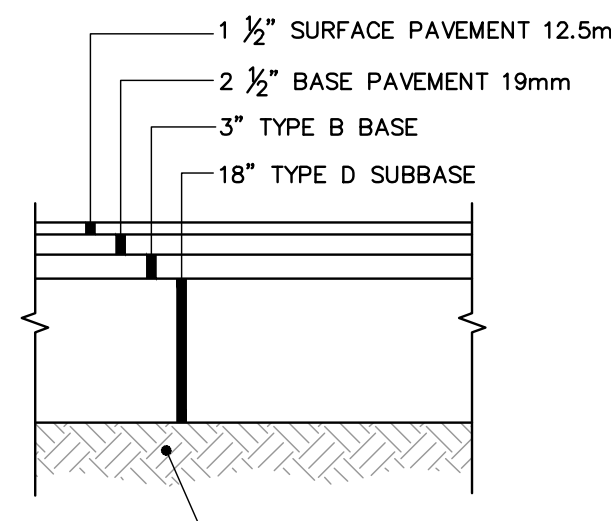

**DRIVEWAY AND PARKING LOT PAVEMENT DETAIL**

N.T.S.

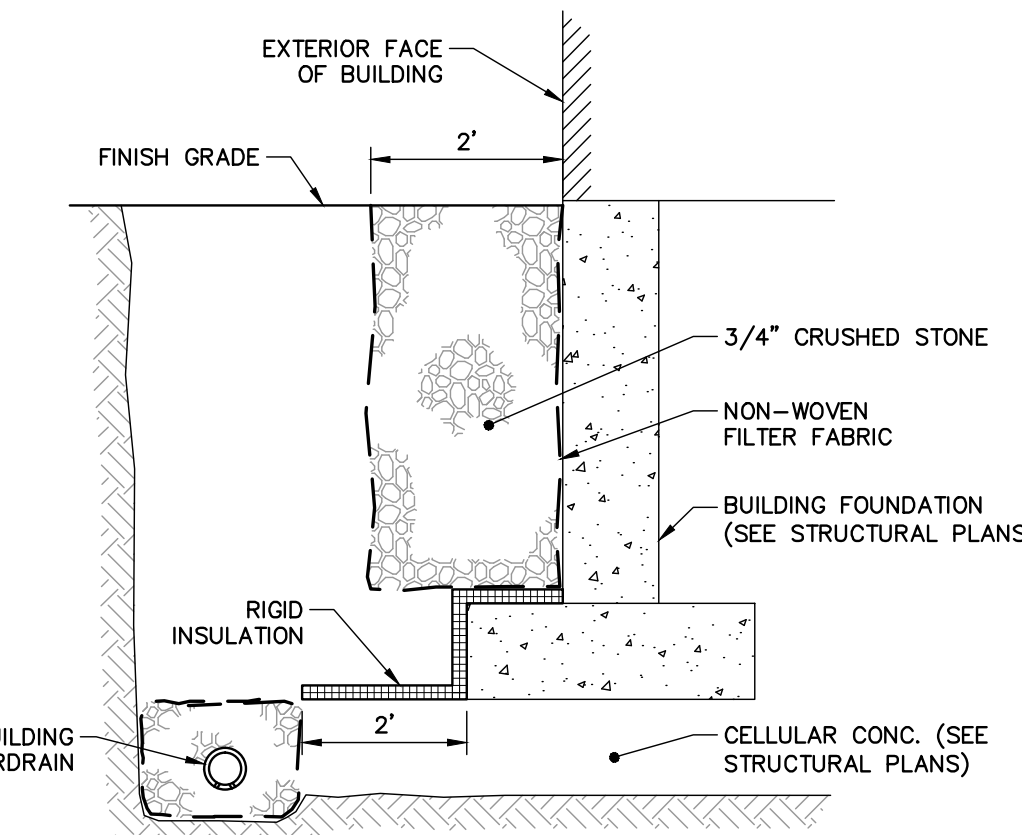

**CRUSHED STONE EDGE & FOUNDATION DRAIN DETAIL**

N.T.S.

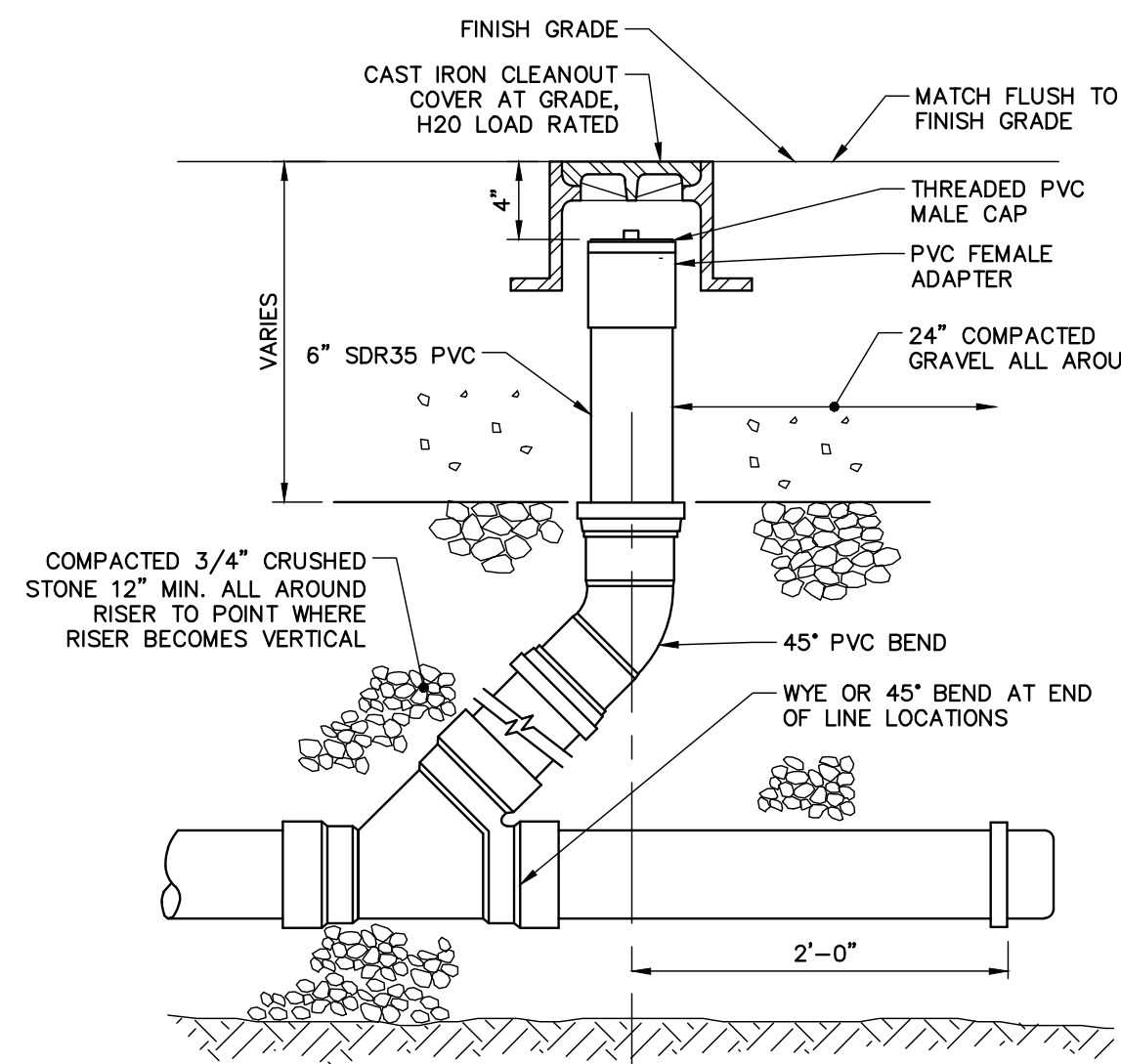

**CLEANOUT DETAIL**

N.T.S.

**NOTE:**

DETAIL FROM CITY OF PORTLAND, MAINE TECHNICAL STANDARDS MANUAL

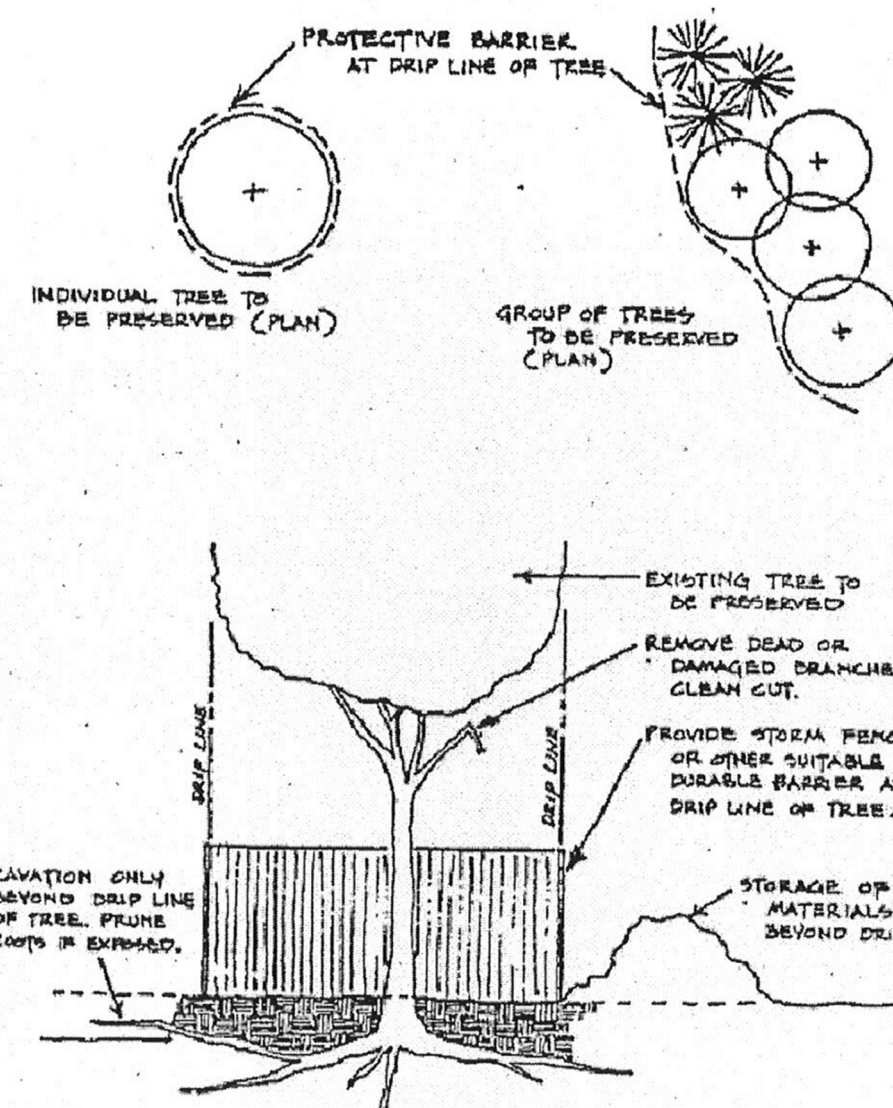

**TREE PRESERVATION DETAIL**

N.T.S.

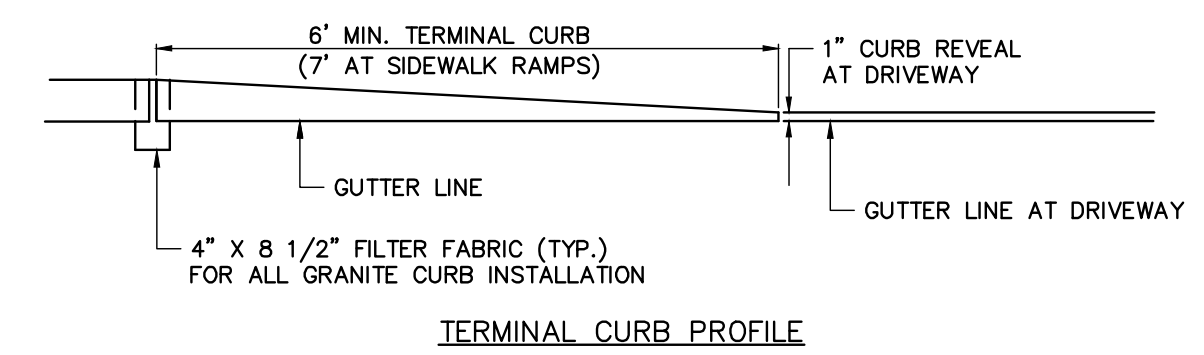

**TERMINAL CURB PROFILE**

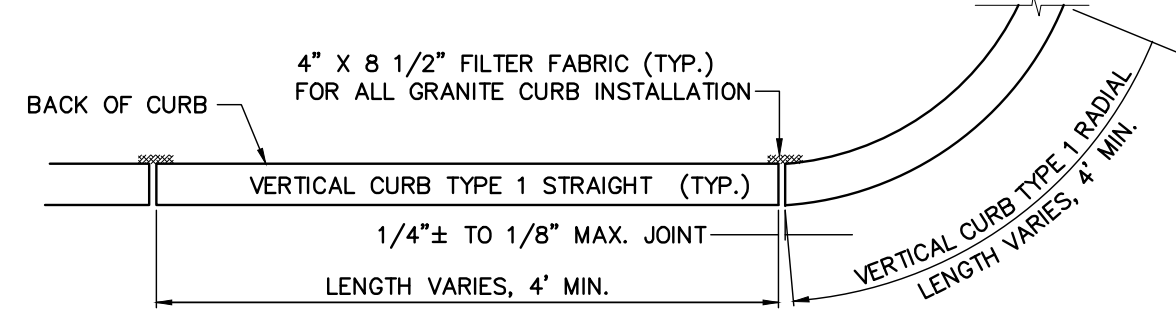

**VERTICAL GRANITE CURB PLAN VIEW**

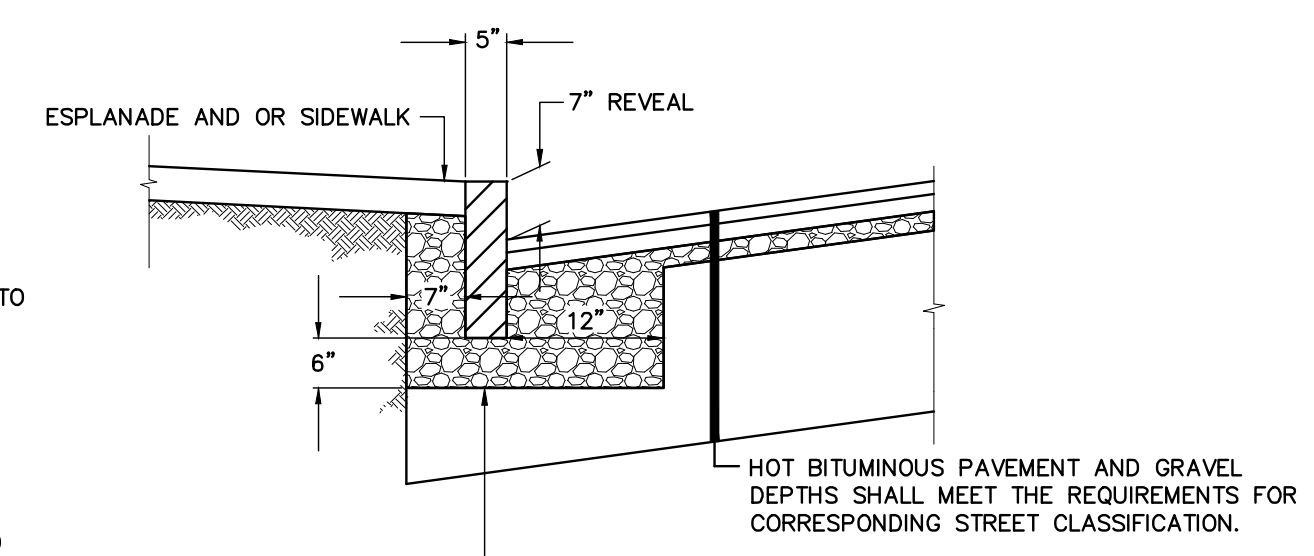

**VERTICAL GRANITE CURB CROSS SECTION**

**VERTICAL GRANITE CURB FULL DEPTH STREET CONSTRUCTION**

N.T.S.

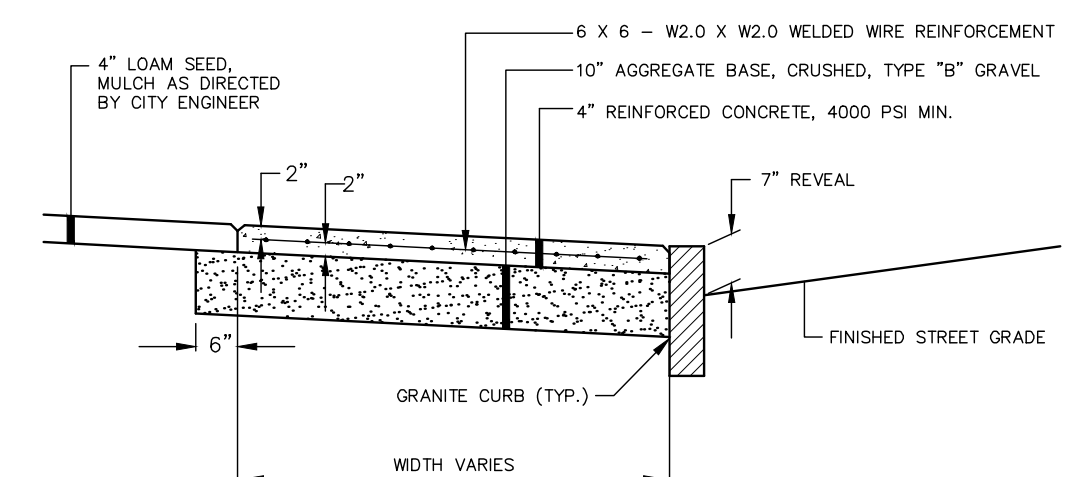

**REINFORCED CONCRETE SIDEWALK**

N.T.S.

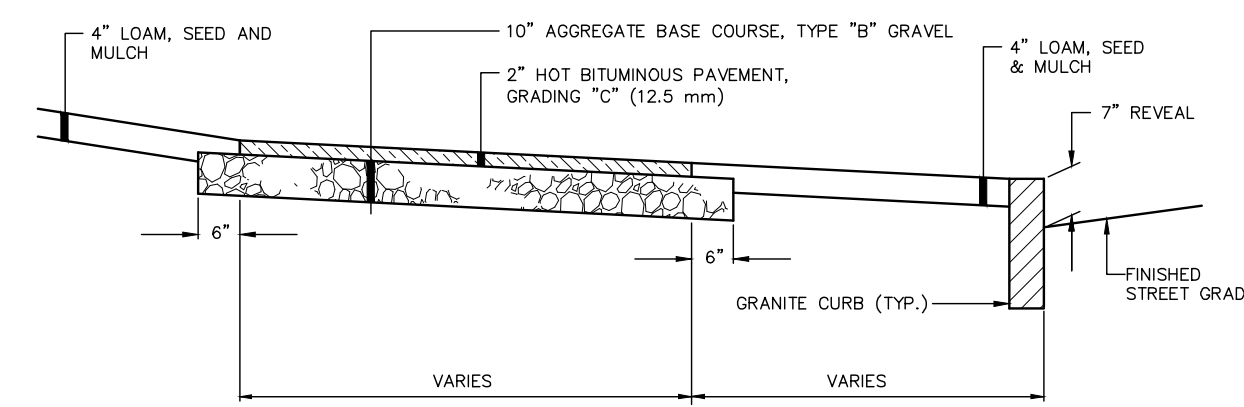

**BITUMINOUS SIDEWALK**

N.T.S.

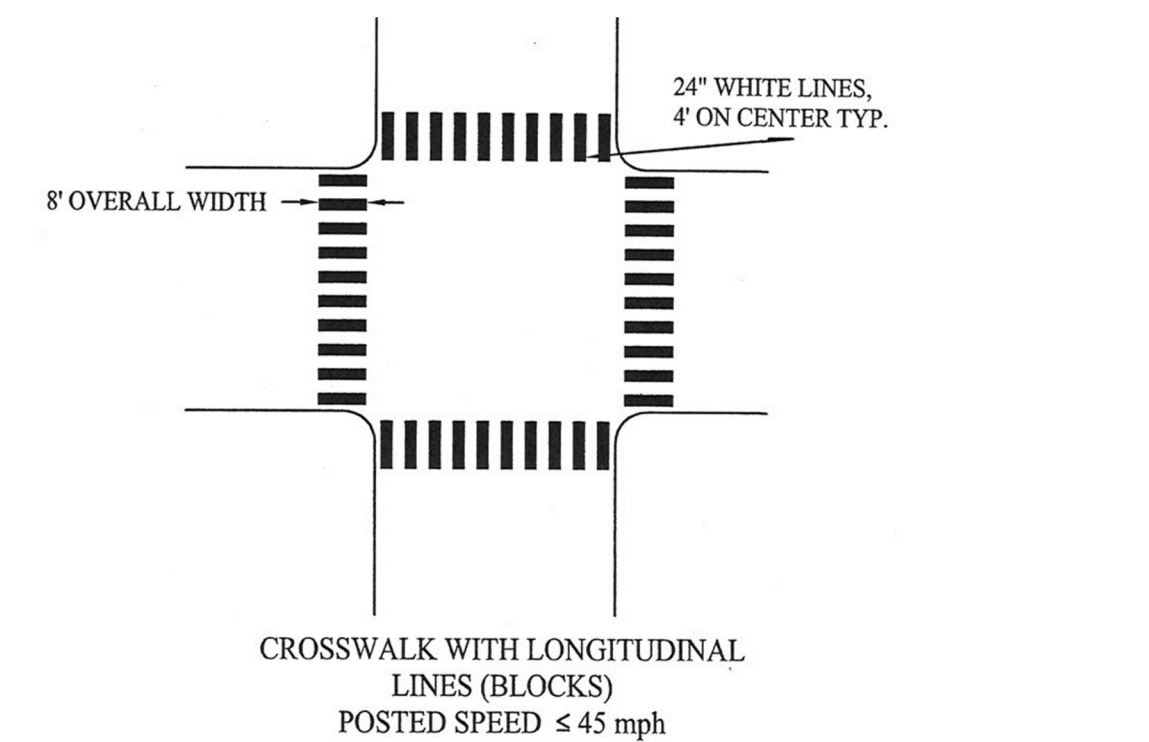

**TYPICAL CROSSWALK MARKINGS**

N.T.S.

**NOTE:**  
DETAIL FROM CITY OF PORTLAND, MAINE TECHNICAL STANDARDS MANUAL

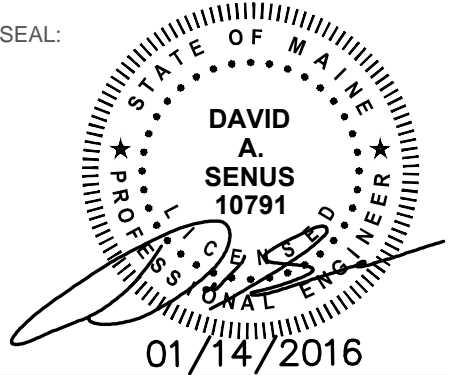

1
2
3
4
5
6