

DISPLAY THIS CARD ON PRINCIPAL FRONTAGE OF WORK CITY OF PORTLAND

Please Read Application And Notes, If Any, Attached

BUILDING INSPECTION

PERMIT ISSUED

Permit Number: 061023

JUL 18 2006

CITY OF PORTLAND

This is to certify that MARTELL MARY-ANNE

has permission to install a 30' x 52" pool w/ spa deck

AT 1646 WESTBROOK ST

248 A001001

provided that the person or persons who accept this permit shall comply with all of the provisions of the Statutes of the State and of the Ordinances of the City of Portland regulating the construction, maintenance and use of buildings and structures, and of the application on file in this department.

Notification of inspection must be given and when permission is procured before this building or part thereof is occupied or service is closed-in. YOUR NOTICE IS REQUIRED.

Apply to Public Works for street line and grade if nature of work requires such information.

A certificate of occupancy must be procured by owner before this building or part thereof is occupied.

OTHER REQUIRED APPROVALS

Fire Dept. _____

Health Dept. _____

Appeal Board _____

Other _____

Department Name

[Signature]
Director - Building & Inspection Services

PENALTY FOR REMOVING THIS CARD

City of Portland, Maine - Building or Use Permit Application

389 Congress Street, 04101 Tel: (207) 874-8703, Fax: (207) 874-8716

Permit No: 06-1023	Issue Date: 24	CBL: A001001
--------------------	----------------	--------------

Location of Construction: 1646 WESTBROOK ST	Owner Name: MARTELL MARY-ANNE E	Owner Address: 1646 WESTBROOK ST	Phone:
--	------------------------------------	-------------------------------------	--------

Business Name:	Contractor Name:	Contractor Address: JUL 18 2006	Phone:
----------------	------------------	------------------------------------	--------

Lessee/Buyer's Name:	Phone:	Permit Type: Swimming Pools	Zone: R1
----------------------	--------	--------------------------------	-------------

Past Use: Single Family Home	Proposed Use: Single Family Home- install a 30 x 52" pool w/ small deck	Permit Fee: \$60.00	Cost of Work: \$4,000.00	CEO District: 3
---------------------------------	--	------------------------	-----------------------------	--------------------

Proposed Project Description: install a 30' x 52" pool w/ small deck	FIRE DEPT: <input type="checkbox"/> Approved <input type="checkbox"/> Denied	INSPECTION: Use Group: J Type: NA R-ACC 7/18/06
	Signature:	Signature:

PEDESTRIAN ACTIVITIES DISTRICT (P.A.D.)		
Action: <input type="checkbox"/> Approved <input type="checkbox"/> Approved w/Conditions <input type="checkbox"/> Denied		
Signature:		Date:

Permit Taken By: Idobson	Date Applied For: 07/13/2006	Zoning Approval
-----------------------------	---------------------------------	------------------------

1. 2. Building permits do not include plumbing, septic or electrical work. 3. Building permits are void if work is not started within six (6) months of the date of issuance. False information may invalidate a building permit and stop all work..	Special Zone or Reviews <input type="checkbox"/> Shoreland <input type="checkbox"/> Wetland <input type="checkbox"/> Flood Zone <input type="checkbox"/> Subdivision <input type="checkbox"/> Site Plan Maj <input type="checkbox"/> Minor <input type="checkbox"/> MM <input type="checkbox"/> <i>Urulcondikaris</i> Date: 6/13/06 ASU	Zoning Appeal <input type="checkbox"/> Variance <input type="checkbox"/> Miscellaneous <input type="checkbox"/> Conditional Use <input type="checkbox"/> Interpretation <input type="checkbox"/> Approved <input type="checkbox"/> Denied late:	Historic Preservation <input checked="" type="checkbox"/> Not in District or Landmark <input type="checkbox"/> Does Not Require Review <input type="checkbox"/> Requires Review <input type="checkbox"/> Approved <input type="checkbox"/> Approved w/Conditions <input type="checkbox"/> Denied <i>AM</i> late:
--	--	---	---

CERTIFICATION

I hereby certify that I am the owner of record of the named property, or that the proposed work is authorized by the owner of record and that I have been authorized by the owner to make this application as his authorized agent and I agree to conform to all applicable laws of this jurisdiction. In addition, if a permit for work described in the application is issued, I certify that the code official's authorized representative shall have the authority to enter all areas covered by such permit at any reasonable hour to enforce the provision of the code(s) applicable to such permit.

SIGNATURE OF APPLICANT	ADDRESS	DATE	PHONE
RESPONSIBLE PERSON IN CHARGE OF WORK, TITLE		DATE	PHONE

City of Portland, Maine - Building or Use Permit

389 Congress Street, 04101 Tel: (207) 874-8703, Fax: (207) 874-8716

Permit No: 06-1023	Date Applied For: 07/13/2006	CBL: 248 A001001
------------------------------	--	----------------------------

Location of Construction: 1646 WESTBROOK ST	Owner Name: MARTELL MARY-ANNE E	Owner Address: 1646 WESTBROOK ST	Phone:
Business Name:	Contractor Name:	Contractor Address:	Phone:
Lessee/Buyer's Name	Phone:	Permit Type: Swimming Pools	

Proposed Use: Single Family Home- install a 30' x 52" pool w/ small deck	Proposed Project Description: install a 30' x 52" pool w/ small deck
--	--

Comments:
7/18/2006-mjn: Left message, need deck framing detail, have a description that does not include Beam Information.



Pool Installation/Construction Permit Application

If you or the property owner owes real estate or personal property taxes or user charges on any property within the City, payment arrangements must be made before permits of any kind are accepted.

164		me	
Total Square Footage of Proposed Structure Pool = 30' x 52" Deck = 8' x 12'		Square Footage of Lot 0.452 acres	
Lot# 1	MARY-ANNE MARTELL		207-780-8813
Lessee/Buyer's Name (If Applicable)	Applicant name, address & telephone: MARYANNE MARTELL 1646 Westbrook St Portland, Maine 04102		Cost Of Work: \$ 4,000.00 Fee: \$ 60.00/10
Dimensions of pool: 30' x 52" above or below ground _____			
Dimensions of decking and/or any platforms, sheds, or other structures: 8' x 12'			
Contractor's name, address & telephone:			
Who should we contact when the permit is ready: <u>Mary Anne Martell</u>			
Mailing address: 1646 Westbrook St Portland, ME 04102		Phone: <u>207-780-8813</u>	

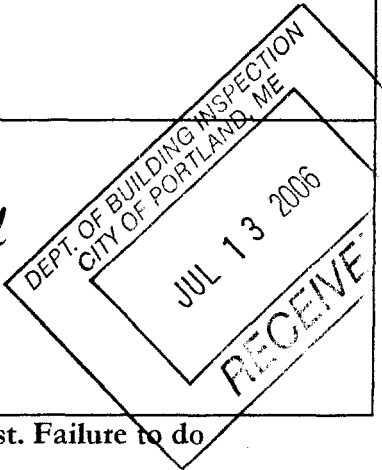

Please submit all of the information outlined in the pool application checklist. Failure to do so could result in the automatic denial of your permit.

In order to be sure the City fully understands the full **scope** of the project, the Planning and Development Department may request additional information prior to the issuance of a **permit**. For further information visit us on-line at www.portlandmaine.gov, stop by the Building Inspections office, room 325 City Hall or call 874-8703.

I hereby certify that I am the Owner of record of the named property, or that the owner of record authorizes the proposed **work** and that I have been authorized by the owner to make this application as his/her authorized agent. I agree to conform to all applicable laws of this jurisdiction. In addition, if a permit for work described in this application is issued, I certify that the Code Official's authorized representative shall have the authority to enter all areas covered by this permit at any reasonable hour to enforce the provisions of the codes applicable to this permit.

Signature of applicant: <u>Mary Anne Martell</u>	Date: <u>7/10/06</u>
--	----------------------

This is not a permit; you may not commence ANY work until the permit is issued.

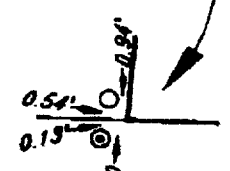
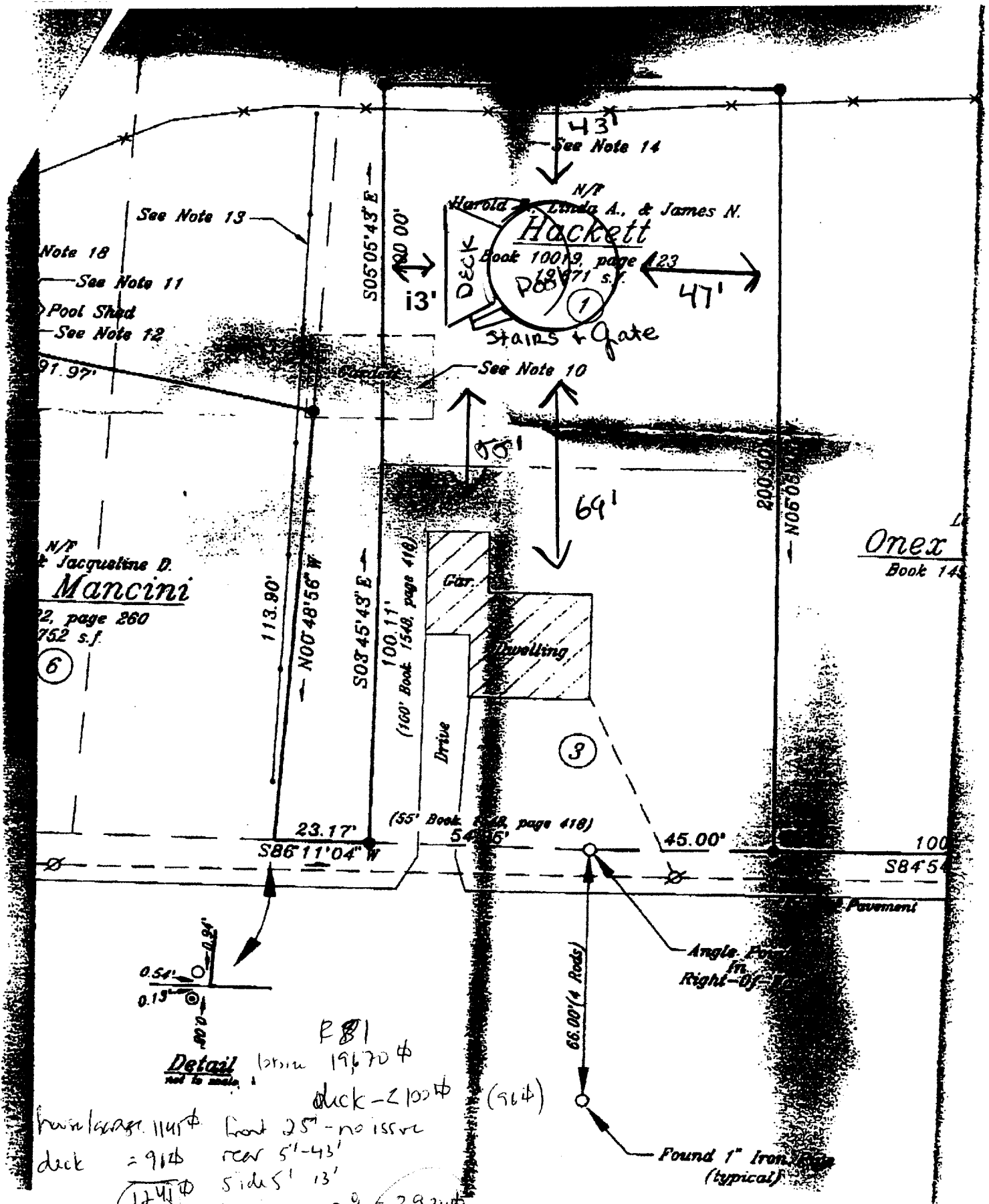

P81
 brown 19670 #
 deck - 2100 # (964)
 front 25' - no issue
 rear 5' - 43'
 sides 5' 13'
 lot coverage 20% = 3934 #
 frontage 1141 #
 deck = 91 #
 1241 #

MARTELL
 1646 Westbrook St
 Portland, Me 04102

pool - 10' from principal structure - 55' from garage
 ok - 10' from side yard - 47' from right
 10' from rear yard - 13' from left
 45' from rear

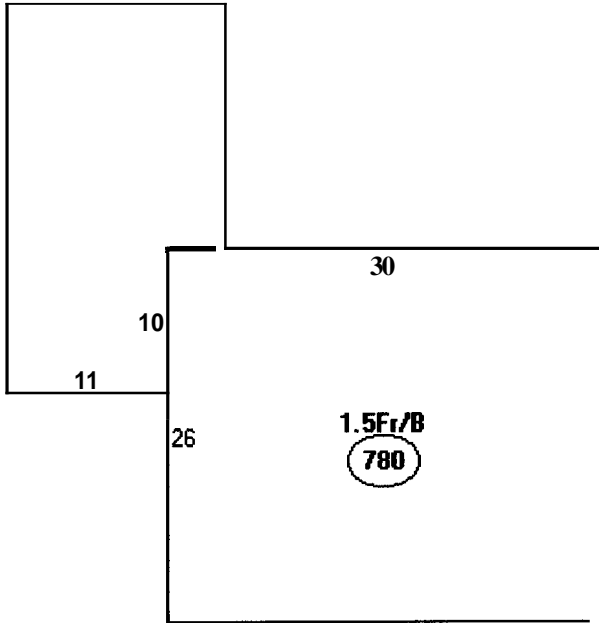

Descriptor/Area

A: 1.5Fr/B
780 sqft

E: FUB
365 sqft

= 1145 ϕ

MARTELL
1646 Westbrook St
Portland, Me
04102

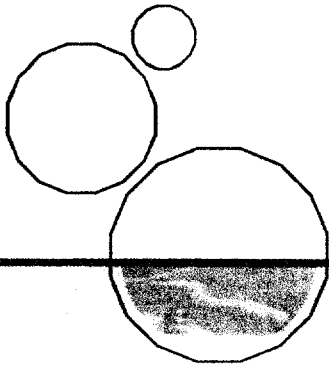

Piscine hors terre - Above-ground pool

Trévi 207

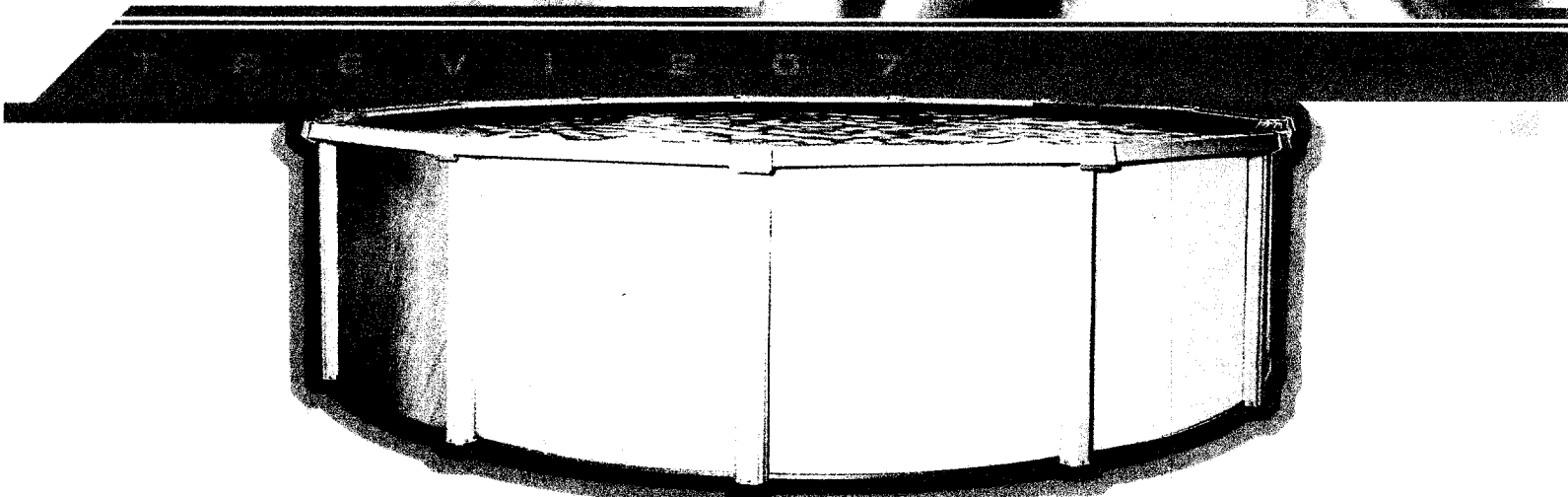

DISTRIBUTED BY
SEBAGO LAKE POOLS
Frost N' Flame
629 Main Street
GORHAM, ME 04038
(207) 856-1000 • (207) 856-7000



www.trevi.net
info@trevi.net

- Bordure sécuritaire en résine de synthèse.
- Montants en résine de synthèse ou en acier. Pour une piscine male, montants en acier seulement.
- Mur en acier ondulé offrant plus de robustesse.
- Revêtement du mur en polymère, à l'épreuve de la corrosion et de l'oxydation.
- Rail du bas en acier galvanisé.

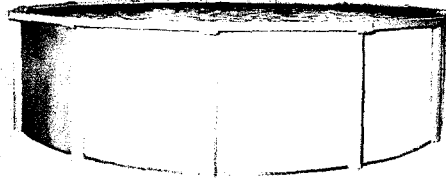

- Resin safety top seat.
- Resin or steel uprights. For oval pool, steel uprights only.
- Corrugated steel wall for greater sturdiness.
- Polymer wall coating to protect against corrosion and oxidation.
- Galvanized bottom track.

12' (3,66 m), 15' (4,57 m), 18' (5,48 m),
21' (6,40 m), 24' (7,31 m), 27' (8,23 m),
30' (9,14 m)

12' x 24' (3,65 m x 7,31 m),
15' x 24' (4,57 m x 7,31 m),
15' x 30' (4,57 m x 9,14 m),
18' x 33' (5,48 m x 10,05 m)

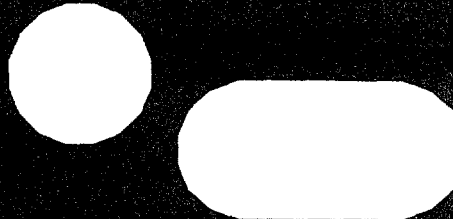

12' (3,66 m), 15' (4,57 m), 18' (5,48 m),
21' (6,40 m), 24' (7,31 m), 27' (8,23 m),
30' (9,14 m)

12 x 24 (3,65 m x 7,31 m),
15' x 24' (4,57 m x 7,31 m),
15' x 30 (4,57 m x 9,14 m),
18' x 33 (5,48 m x 10,05 m)

De qualité supérieure, la bordure en résine de synthèse, de calibre uniforme, avec traitement UV contre la décoloration, est dotée d'une mémoire moléculaire qui empêche la déformation. En plus, elle ne s'égratigne pas!

De conception unique à Trévi, le montant double pour section droite de la piscine male assure une grande résistance contre les pressions de l'eau tout en offrant un design très esthétique.

Fait d'acier galvanisé, le rail du bas plus sécuritaire garantit à la piscine une plus grande stabilité.

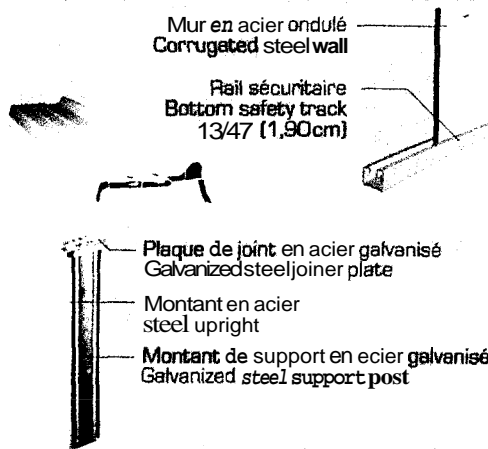

The superior quality top seat, made of synthetic resin, features uniform calibration, UV treatment against discoloration and a molecular memory to prevent warping. In addition, the top seat is totally resistant to corrosion and scratches.

Unique to Trévi, the double pool support post and stay assemblies are designed for superior strength as well as aesthetics [on the straight side of oval pool only].

The bottom safety track, made of galvanized steel, guarantees the stability of your pool.

- Revêtement plastifié SP.
- Couche de zinc fondu.
- Couche d'apprêt.
- Application d'une solution alcaline pour enlever les oxydes.
- Revêtement de polymère ultra résistant.
- Motif incrusté et durci à la chaleur.
- Couche d'apprêt.
- Couche de chromate antirouille.
- Corps en acier.
- Application d'une solution alcaline pour enlever les oxydes.

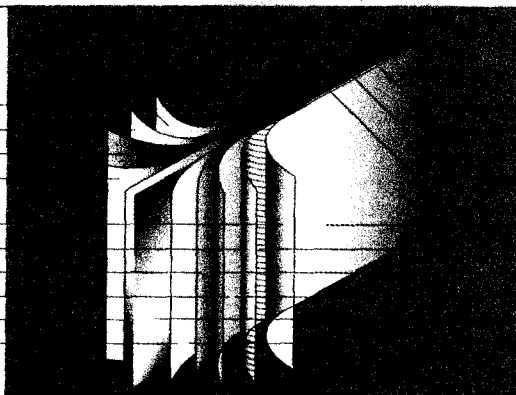

- Plasticized SP coating.
- Molten zinc coat.
- Primer coat.
- Application of an alkaline solution to cleanse the oxides.
- Ultra-resistant polymer.
- Heat-hardened inlay.
- Primer coat
- Chromate anti-rust coat.
- Steel wall core.
- Application of an alkaline solution to cleanse the oxides.

- Bordure de 8" (20cm) en résine de synthèse.
- Couronnement en polymère et en acier.
- Couvre-joint en résine de synthèse.
- Plaque de joint en acier.
- Mur de 48" (1,22 m) ou 52" (1,32 m) en acier.
- Montant en résine de synthèse ou en acier.

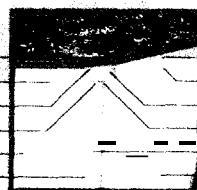

- 8" (20cm) resin top seat
- Polymer and steel coping
- Resin seat cap.
- Steel joint plate.
- Resin or steel upright.
- 48" (1,22 m) or 52" (1,32 m), steel wall.

Système exclusif de retenue de la toile.

Préviend le décrochement de la toile en cas de mouvement occasionnés par le gel ou le dégel et accroît la stabilité de la piscine.

(Offert sur les toiles avec jonc d'accrochage "U-bead" seulement)



Exclusif liner locking system.

Prevent liner setback in case of movements caused by freezing or thaw, and increases overall pool stability.

[Available only with "U-bead" liner]

Martell
1646 Westbrook Street
Portland, ME 04102

Free standing deck **8' x 12'** (flush but not attached to pool)

Setback from left property line is **13'**
Setback from house is 69'
Setback from garage is 55'
Setback from back of property is **43'**
Setback from right side of property is **47'**

1. Type of foundation system
 - a. 6" sona tubes
 - b. 4' depth below grade
 - c. Post brackets
 - d. Every 4'

2. Framing members
 - a. 4' x 4' columns
 - b. **N/A**(not attached to building)
 - c. **N/A**
 - d. 8' x 12' post every 4'
 - e. Joist size 2" x 8" every 16"
 - f. Joist hinges

3. Guardrails & handrail details
 - a. 18" guardrails
 - b. Cross rails & lattice, no baluster
 - c. Handrail 36"

4. Stair details with self-locking gate mechanism; lattice will be attached to all guardrails & front of gate
 - a. Tread depth 11"
 - b. Riser height 7 3/8"
 - c. Bull nose
 - d. Width of stairs 48"
 - e. Gate height is 48" with self-latching device