

Marge Schmuckal - Re: EP Christian Church Tomorrow

10/16/14

From: Barbara Barhydt  
To: Blais, Steve  
Date: 10/15/2014 3:26 PM  
Subject: Re: EP Christian Church Tomorrow  
CC: Jaegerman, Alex; Schmuckal, Marge

Tom Jewell - Steve B  
Kurt - Scott - Alex - Barbara - Marge  
Holmgren Tanbe

Hi Steve:

Threshold issue

I reserved the Planning Conference Room for the meeting, so please come to the 4th floor.

Thank you.

Barbara

insert trigger for site plan review

events room: mothers of preschoolers  
Veterans groups  
youths gathering

Barbara Barhydt  
Development Review Services Manager  
Planning Division  
389 Congress Street 4th Floor  
Portland, ME 04101  
(207) 874-8699  
Fax: (207) 756-8256  
bab@portlandmaine.gov

DO 3 services

1,000 parking spaces now  
grow to 2,000 - beyond that will be  
supplemented by other hubs

>>> Steve Blais <sblais@blaisce.com> Wednesday, October 15, 2014 2:30 PM >>>

Hi Barbara,  
Should we meet you at the planning front desk for our 9:30am meeting tomorrow? If not, let me know, which room. See you then.

- Steve

currently <sup>considered</sup> institutional use  
Industrial use

Steve G. Blais, PE, CFM, LEED AP  
Blais Civil Engineers, PA  
207-767-7300  
[www.BLAISce.com](http://www.BLAISce.com)

I want Greg Mitchell

Disclaimer- This email and any files transmitted with it are confidential and contain privileged or copyright information. You must not disclose, copy, distribute or use the contents of this email if you are not the intended recipient. If you have received this email in error, please notify the sender immediately, and delete this email message from your system.

would need level III TMP? Traffic Movement Permit

10/16/14



# EASTPOINT CHRISTIAN CHURCH

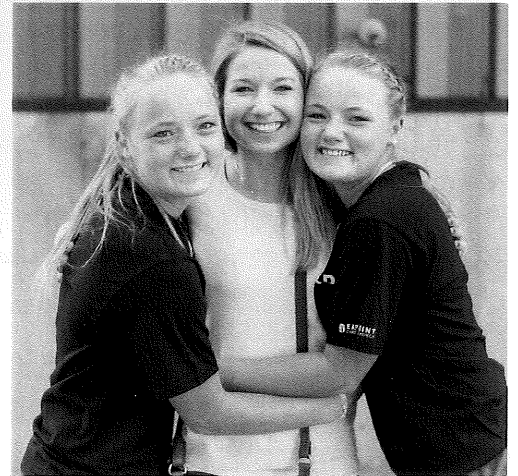

102 Hutchins Drive, Portland

# PROPOSAL

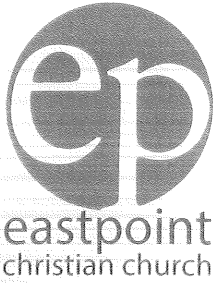

September 22, 2014

City Planning Department,

This letter is written with the intent to communicate the relocation efforts for Eastpoint Christian Church within the city of Portland.

**Brief History:**

We began in 2004 meeting at the Maine Mall Cinema with 15 people; moving 6 months later to the Sable Oaks Marriott where we grew to approximately 200. After two years at the Marriott, we moved to a warehouse in Scarborough on Route 1. Two and a half years later, due to continued growth of approximately 350 people, we moved to a warehouse in the Time Warner complex owned by the Sanborn Family at 58 City Line Drive in Portland. Within 4 years, we have tripled in size to nearly 1,000 attendees with three worship services each Sunday morning.

**Space Needs:**

Due to our growth, we have been searching for a year and a half for a building in the City of Portland that could house the size of our congregation and accommodate with ample parking. Currently there is no other church in Portland that would call for the space needs that we require, which makes our requirements quite unique in comparison.

We desire to be a Portland church and continue to engage with the city of Portland. Throughout our search efforts we have come up short in finding space and parking with one exception, The Unum building at 102 Hutchins Drive, which is zoned Moderate Industrial. This building allows for ample parking and space to grow. The fact that the heaviest use is on Sunday when other businesses will not be functioning makes it an ideal facility and location.

In looking at zones that welcome churches, there are few, if any, that could accommodate an 82,000 square foot building with necessary parking. We realize our size is unique and therefore presents a different set of needs.

We currently have a purchase and sales contract with Unum for 102 Hutchins Drive. We are also fully funded and prepared to purchase. This is a building we can afford and that meets our needs perfectly.

## **Contributions to Portland:**

It has been our passion at Eastpoint to be involved in our community and to identify ways to enhance the lives of those who live there. As we continue to grow, it has become clear to us that our call and obligation to the community of Portland will only increase. Below is an abbreviated list of current and future efforts we have planned as we grow and partner with the city of Portland:

- 1) We've developed an extensive ongoing partnership with CPPC (Community Partners for the Protection of Children). This collaboration includes membership on the Interfaith Committee, development and execution of the At-Risk Family Mentoring program, as well as involvement with Strong Fathers.
- 2) We have helped to establish Community Connection nights in South Portland, as well as in the Parkside neighborhood. These programs continue to flourish as the community comes together building stronger relationships with one another.
- 3) Working on community development with the Opportunity Alliance as members of the Parkside Action Team. We hope to bolster a stronger more self-sufficient community in this densely populated area.
- 4) We have been integral working with new Mainers as they arrive from Africa in need of support. Our intention was to relieve some of the strained support systems by having our congregants assume their rightful role in loving their neighbors. This is worked out through collaboration with organizations such as The Root Cellar and Hope Acts, as well as members teaching ESL. We've also been able to assist with necessities for the home, help with financial hardship, as well as life navigation in this new country. We have been able to impact hundreds of lives in this way.
- 5) On-going financial and volunteer support to The Root Cellar.
- 6) Participation on the board of the Parkside Neighborhood Association, as well as events such as the annual block party.
- 7) We have been blessed in our church community with a spirit of generosity that has allowed us to donate our entire Christmas and Easter offerings over the past few years to distribute nearly \$100,000 to the following organizations: Barbara Bush Children's Hospital, The Root Cellar, Hope Acts, Cancer Community Center and the Westbrook food pantry. Our sole intention in this endeavor is to see these donations increase.
- 8) Our Home Essentials ministry is available to provide food and household necessities to those in need. We want to establish a program that will go beyond handouts; helping families move toward self-sufficiency.
- 9) We support families in the community through marital, family and individual counseling.
- 10) Extensive children and teen programs are made available on a weekly basis, creating a safe environment for nearly 350 teens and elementary kids.
- 11) We currently hold leadership positions in Neighborhood Watch initiatives in the city.



12) We also have plans in the works to partner with organizations to address the homeless situation in the city.

13) We have begun collaboration planning with the Portland public school system. We desire to encourage teachers and students alike knowing that this is an important key to a flourishing community.

*can strike per Scott Taube*  
~~In addition to these partnerships, we would be pleased to make this building a destination for an Emergency Shelter.~~ The sizable generator offers an uninterrupted power supply to the building, which also includes a cafeteria and showers, making it an excellent Emergency Shelter if needed.

This just represents some of our involvement in Portland, either planned or ongoing currently. We really look forward to an open relationship whereby we can listen to city leaders and residents to determine the most effective ways to help and love our neighbors. We are hopeful you will help us continue this mission.

Sincerely,

Scott Taube, Lead Pastor

Eastpoint Christian Church 58 City Line Dr. Portland Maine 04102  
eastpointchristianchurch.com



102 Hutchins Drive  
**Portland**

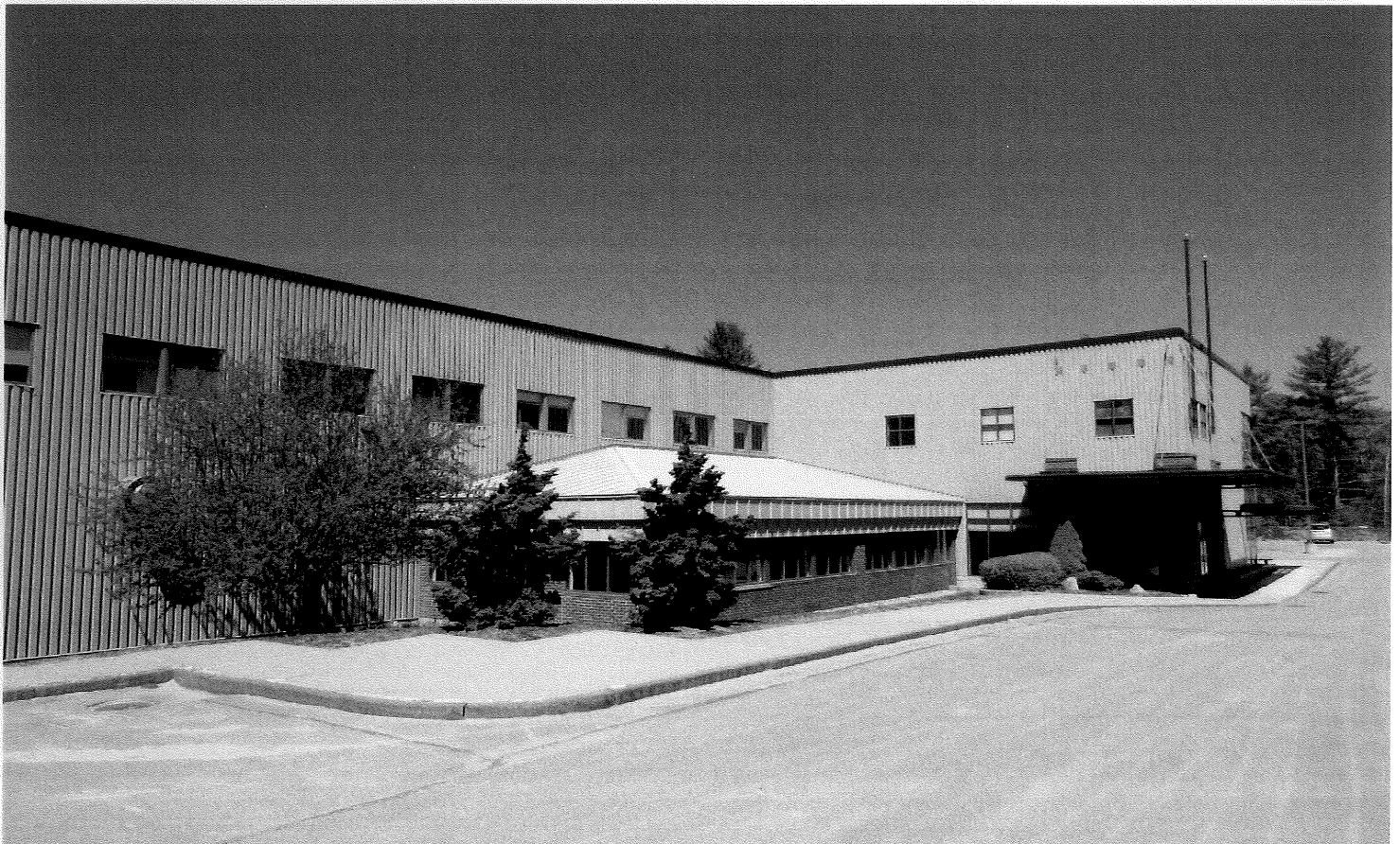

102 Hutchins Drive, Portland  
Eastpoint Christian Church

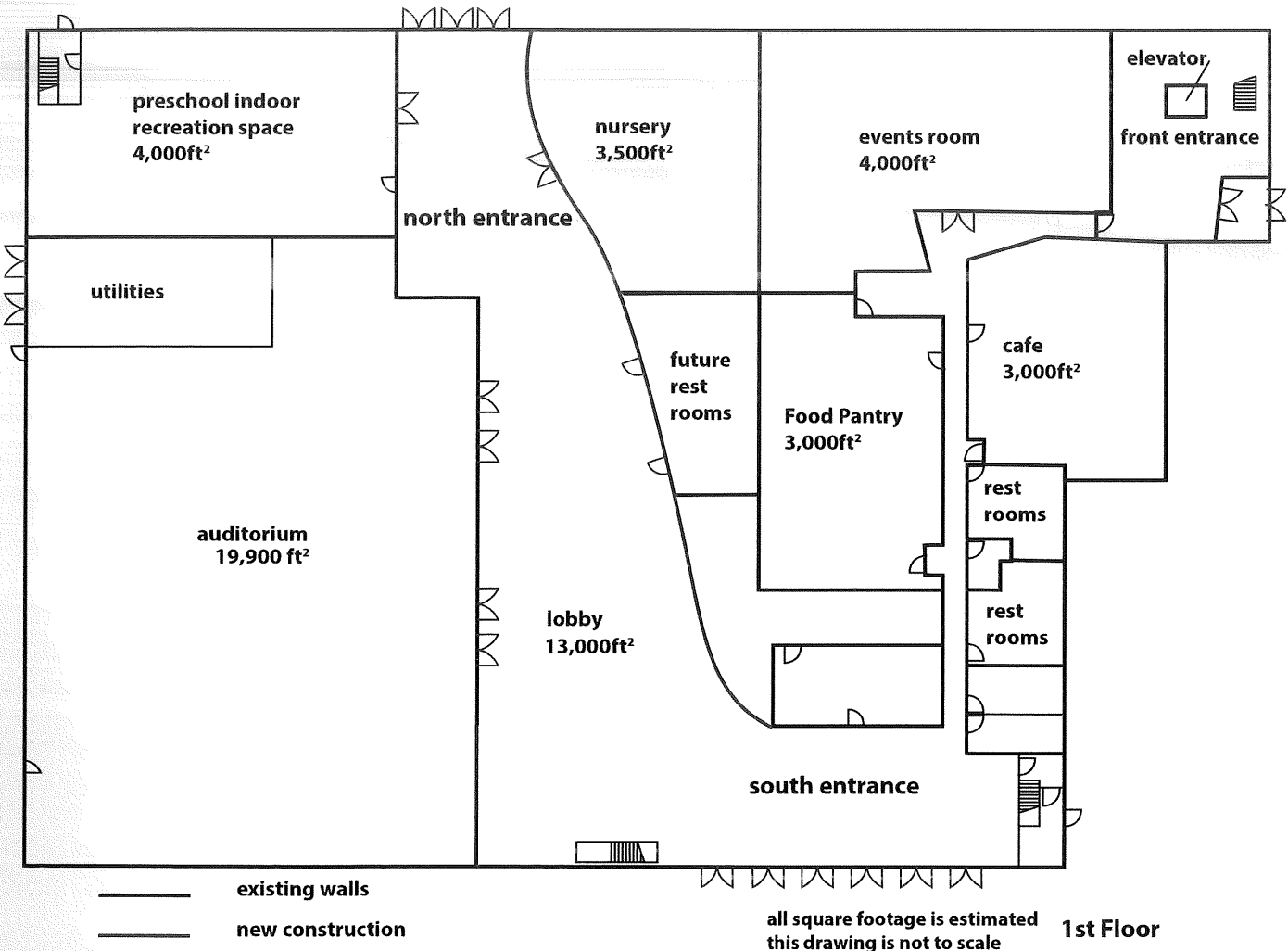

102 Hutchins Drive, Portland  
Eastpoint Christian Church

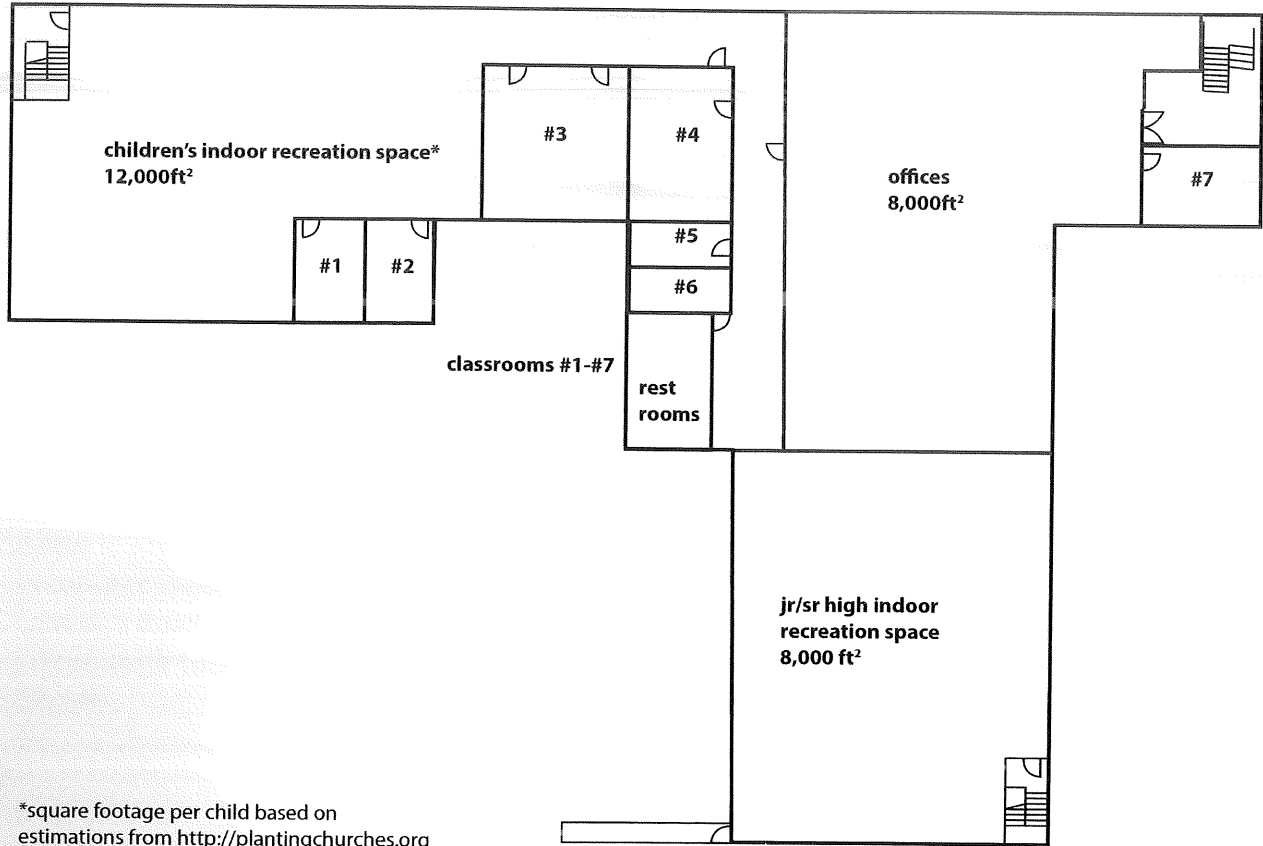

\*square footage per child based on estimations from <http://plantingchurches.org>

— existing walls  
= new construction

all square footage is estimated 2nd Floor  
this drawing is not to scale

# Room Use Descriptions

## **Auditorium**

- Sunday morning weekly events
- Mid-week activities

## **Nursery, Preschool & Children's Indoor Recreation Spaces**

- Sunday morning weekly events including; games, recreation, learning activities, creative arts stations, crafts, and supervised play.
- Mid-week activities, parties, children's holiday events.
- Summer Day Camp.
- Indoor Carinvals
- Mothers of Preschoolers events

## **Junior & Senior High School Indoor Recreation Space**

- Sunday Evening weekly events including; Games, recreation, large & small group studies, & lectures.
- Mid-week small groups and events
- Conferences

## **Classrooms**

- Volunteer training
- Leader's meetings
- Community Groups
- Classes

## **Offices**

- Staff Offices
- Administration space
- Individual & family counseling
- Staff meetings
- Copy & printing
- Project spaces

## **Food Pantry**

- Storage of food
- Storage of household items

## **Café**

- Staff gathering space
- Luncheons
- Community Group space

## **Lobby**

- Information Kiosks
- Seating areas



**102 Hutchins Drive, Portland  
Eastpoint Christian Church  
Parking Diagram**

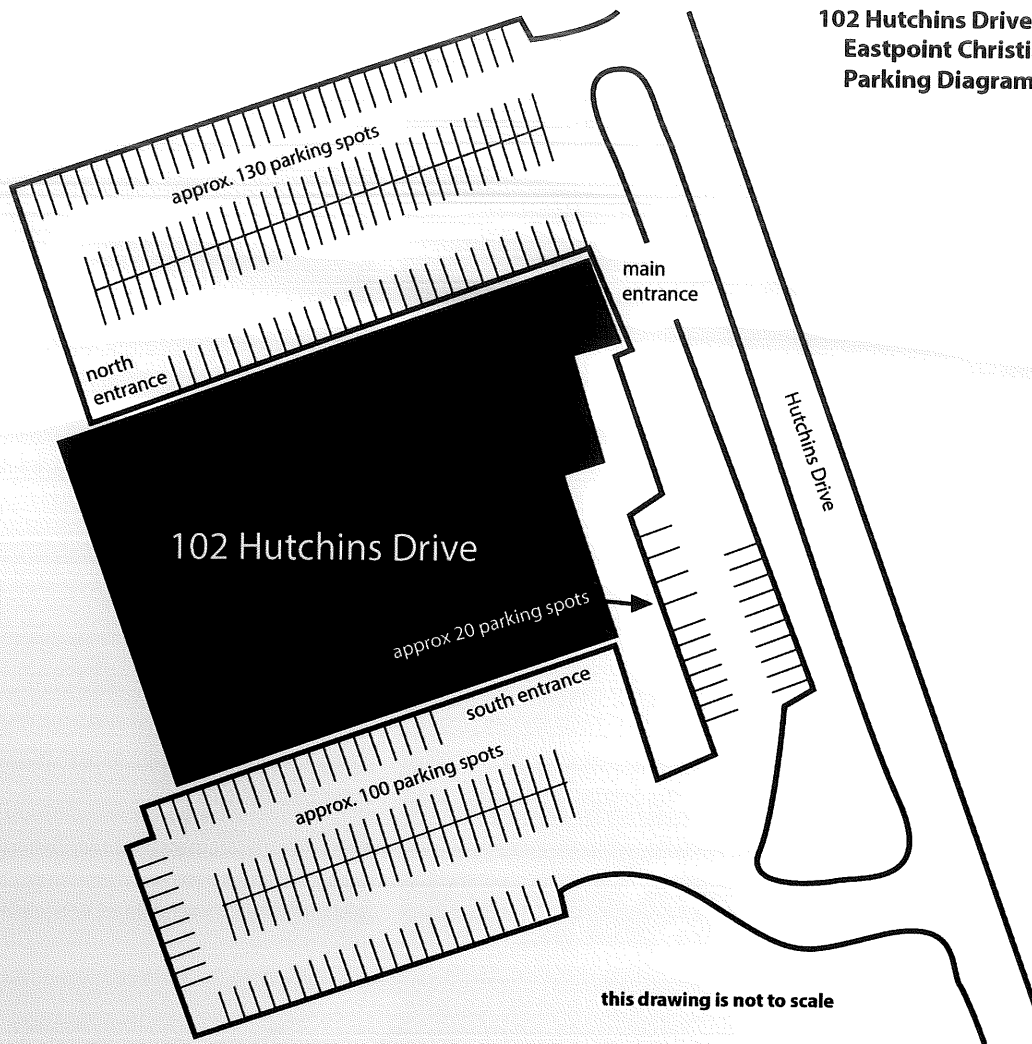

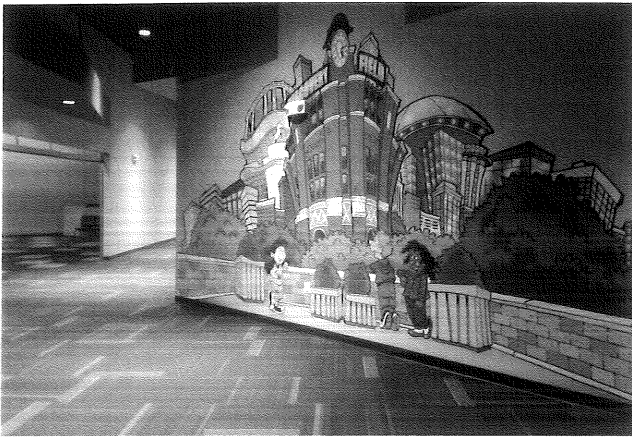

**Design Concepts  
for Future Building**



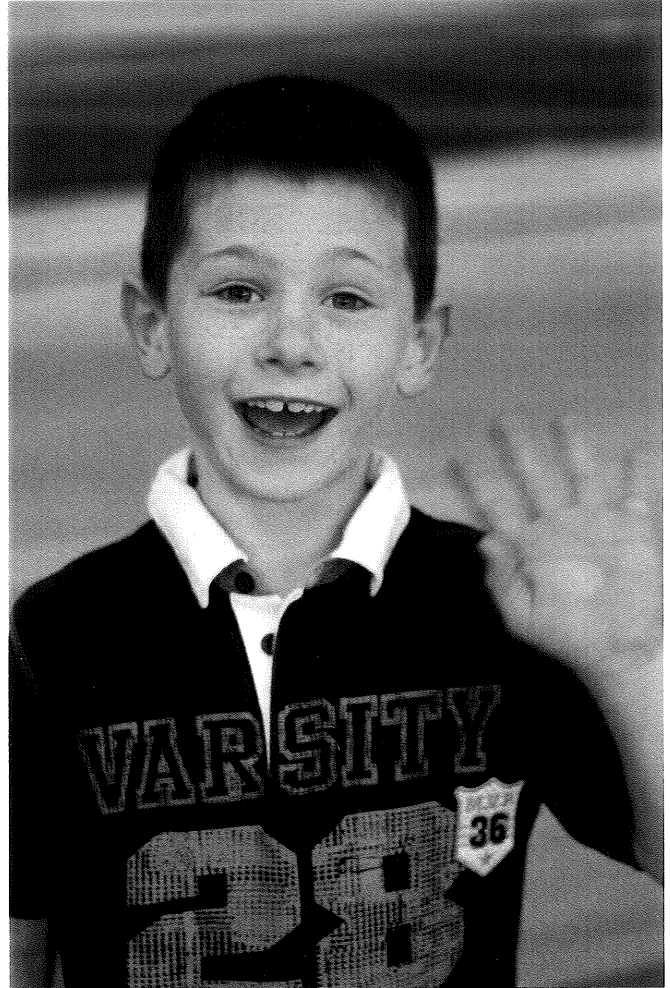
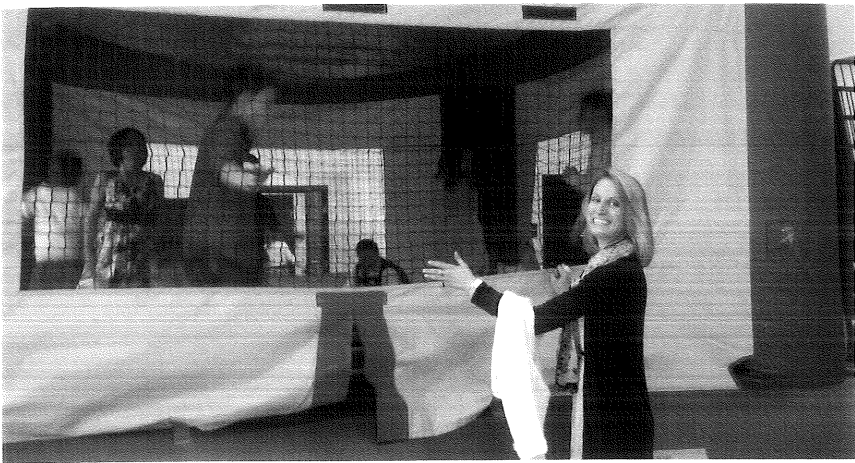

**Easter Sunday Service  
April 2014**



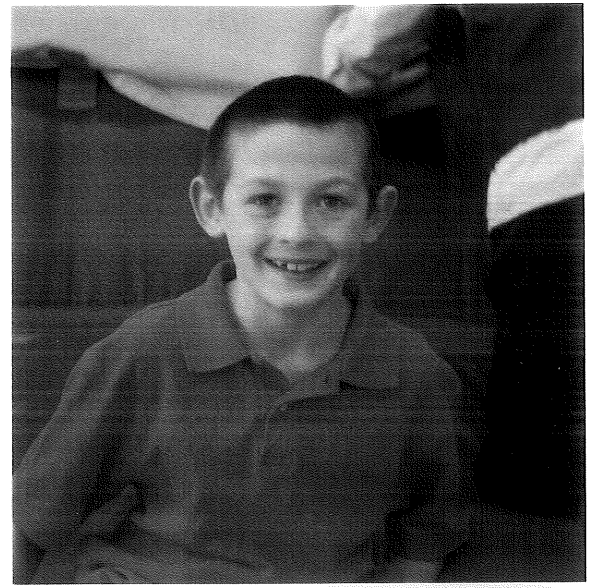

**Kids Adventure Week  
August 2014**

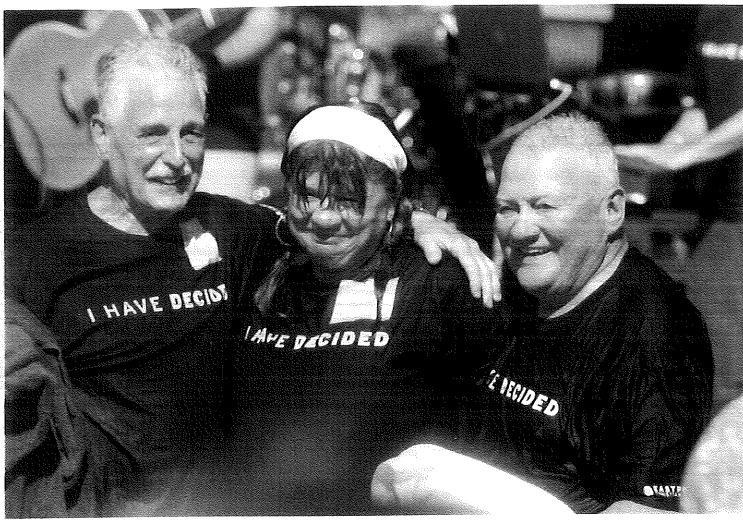

**Outdoor Service  
September 2014**



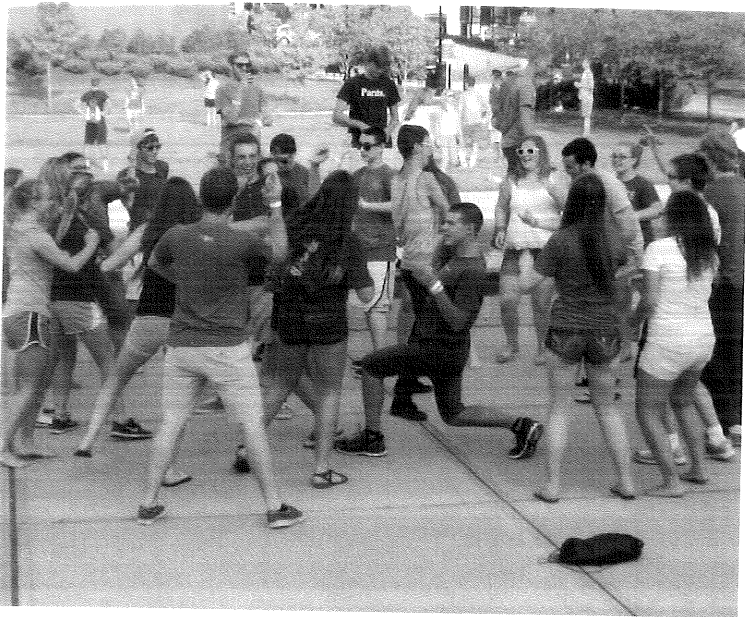

**Jr. & Sr. High Students  
Summer 2014**

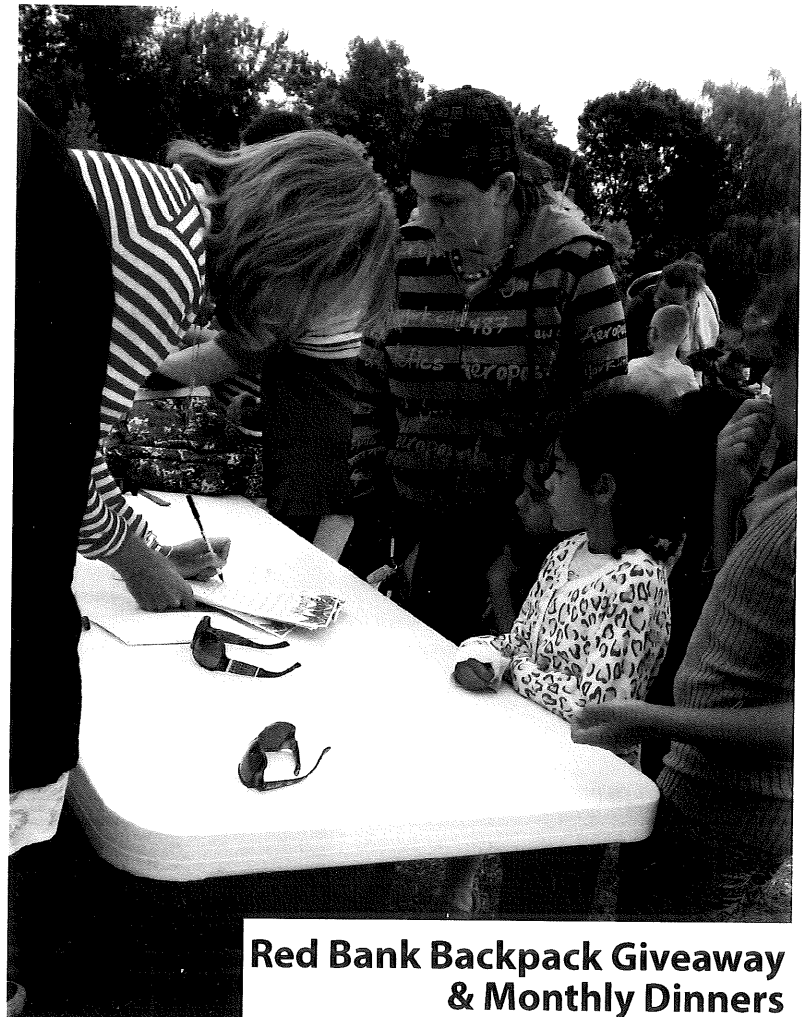
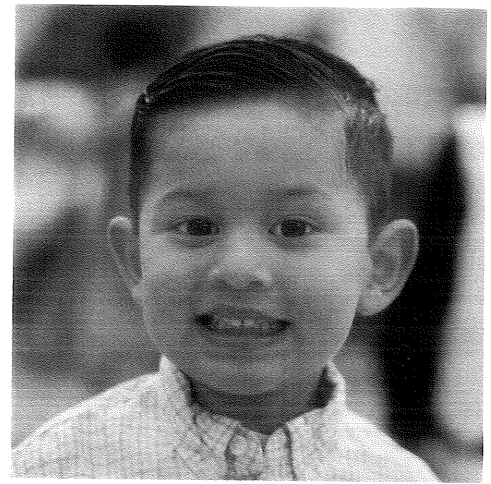

**Red Bank Backpack Giveaway  
& Monthly Dinners**



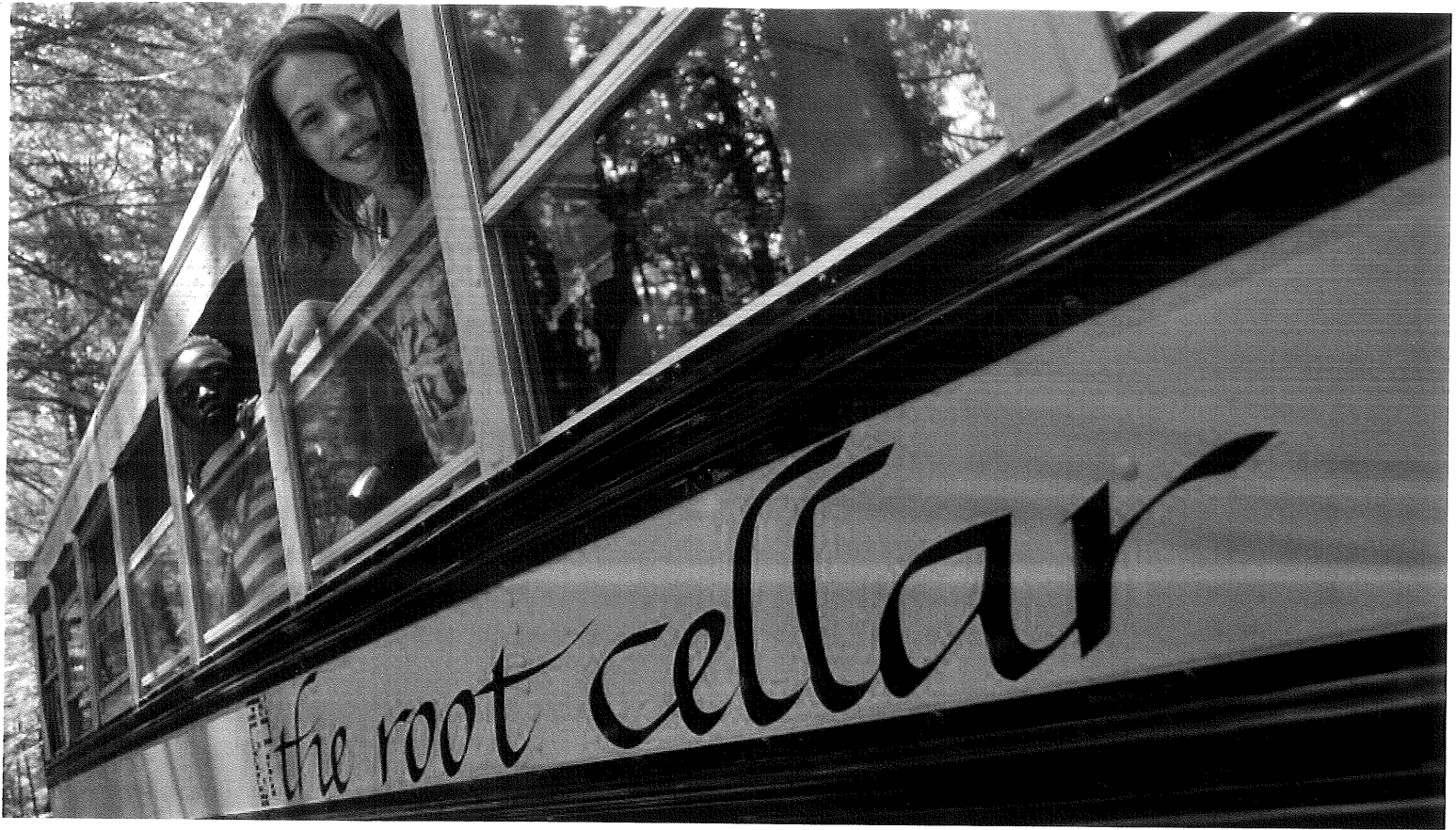

**Community Outreach  
Parkside, Root Cellar**