

DEMOLITION NOTES:

1. COORDINATE EXTENT OF DEMOLITION WITH LOCATIONS OF PARTITIONS DESCRIBED ON PLANS AND WITH LOCATIONS OF FINISHES NOTED AS EXISTING TO REMAIN.
2. ANY WALL, PARTITION OR SURFACE DISTURBED BECAUSE OF NEW WORK OR DEMOLITION SHALL BE PATCHED AND FINISHED CONTINUOUSLY TO THE NEAREST CORNER UNLESS NOTED OTHERWISE. MATCH EXISTING ADJACENT CONSTRUCTION FINISHES, CONTINUITY AND FIRE RATINGS UNLESS NOTED OTHERWISE.
3. PROTECT ALL FINISHES, MATERIALS AND EQUIPMENT NOTED AS EXISTING TO REMAIN. CONTRACTOR SHALL BE RESPONSIBLE TO REPLACE ALL FINISHES, MATERIALS AND EQUIPMENT DAMAGED DURING CONSTRUCTION.
4. DIMENSIONS INDICATED WITH A ARE EXISTING CONDITION AND NEED TO BE VERIFIED IN FIELD.
5. CONTRACTOR TO HOLD A PRE-DEMOLITION MEETING WITH OWNER, CONSTRUCTION MANAGER, SUB CONTRACTORS, ETC. PRIOR TO BEGINNING DEMOLITION WORK TO REVIEW HOSPITALS POLICIES, NOISE CONTROL MEASURES, ETC.
6. CLEARLY IDENTIFY AND TAG MECHANICAL, PLUMBING AND ELECTRICAL FIXTURES OR EQUIPMENT THAT ARE STILL IN USE PRIOR TO DEMOLITION TO AVOID ACCIDENTAL REMOVAL.
7. SEE MECHANICAL, ELECTRICAL AND PLUMBING DRAWINGS FOR THE SCOPE OF DEMOLITION IN THOSE DISCIPLINES.

DEMOLITION KEY NOTES:

- 1 REMOVE DOOR, FRAME AND HARDWARE. COORDINATE WITH OWNER THOSE ITEMS TO BE SALVAGED PRIOR TO REMOVAL.
- 2 REMOVE CEILING TILES AND GRID COMPLETE. COORDINATE WITH OWNER THOSE ITEMS TO BE SALVAGED PRIOR TO REMOVAL.
- 3 REMOVE EXISTING WALL IN ITS ENTIRETY FROM FLOOR TO STRUCTURE AS INDICATED BY DASHED LINE. PRIOR TO REMOVAL, IDENTIFY IF WALL IS LOAD BEARING. IF FOUND TO BE A BEARING WALL, NOTIFY ARCHITECT IMMEDIATELY.
- 4 REMOVE FINISH FLOOR MATERIAL (IF ANY) AND BASE. PREPARE SURFACE FOR NEW FINISHES AS REQUIRED BY SCHEDULE AND SPECIFICATIONS.
- 5 REMOVE ACCESS FLOORING AND STANDS AND SALVAGE FOR REUSE. CLEAN AND PREP SURFACE BELOW FOR NEW FLOOR FINISH.
- 6 REMOVE CEILING TILES AND SALVAGE FOR REUSE. GRID SYSTEM TO BE REMOVED ONLY WHERE ACCESS IS NEEDED FOR WORK ABOVE.
- 7 CUT OPENING TO ACCOMMODATE NEW CORRIDOR AND CLOSE TO NEW 1 HOUR CEILING ABOVE.
- 8 REMOVE FRAME COMPLETE. COORDINATE WITH OWNER THOSE ITEMS TO BE SALVAGED PRIOR TO REMOVAL.
- 9 REMOVE PORTION OF EXISTING WALL TO ALLOW FOR NEW CONSTRUCTION.
- 10 REMOVE PORTION OF RAISED CONCRETE SLAB WHERE INDICATED BY DASHED LINE.
- 11 REMOVE STAIR, RAMP, LANDING AND HANDRAIL COMPLETE.
- 12 REMOVE DOOR, FRAME AND HARDWARE. SALVAGE DOOR FOR REUSE IN THIS LOCATION.
- 13 ALL STAINED WOOD WALL BASE TO BE REMOVED. PATCH/REPAIR WALL AS REQUIRED TO PREP FOR NEW BASE.
- 14 REMOVE ACOUSTIC PANEL.
- 15 REMOVE PIPE AND CHAIN LINK FENCING COMPLETE. PATCH AND REPAIR CONCRETE FLOOR AREAS DAMAGED DURING FENCE REMOVAL.
- 16 REPAIR BOLLARD IF SALVAGEABLE. REPLACE IF NOT.
- 17 REMOVE PLUMBING FIXTURE COMPLETE. REFER TO PLUMBING DRAWINGS FOR EXTENT OF NEW WORK.

REV	DESCRIPTION	DATE
0	ISSUED FOR CONSTRUCTION	12-21-17

ISSUED FOR CONSTRUCTION
12-21-17

CURRENT ISSUE STATUS:

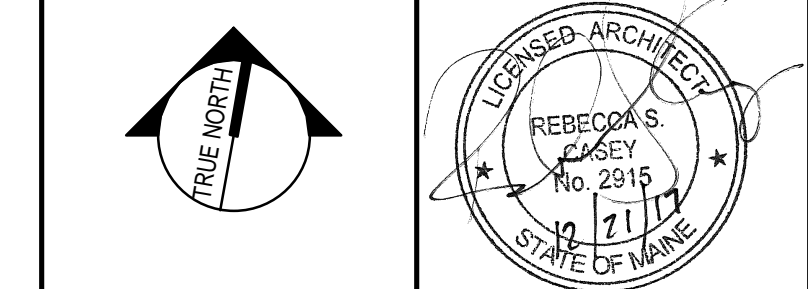

PROJECT NORTH:
SMRT Architects and Engineers
144 Fore Street/P.O. Box 618
Portland, Maine 04104



**MAINE MEDICAL CENTER
M.M.C. HUTCHINS DRIVE
RENOVATION**
PROJECT LOCATION

DEMOLITION PLAN - LEVEL 2

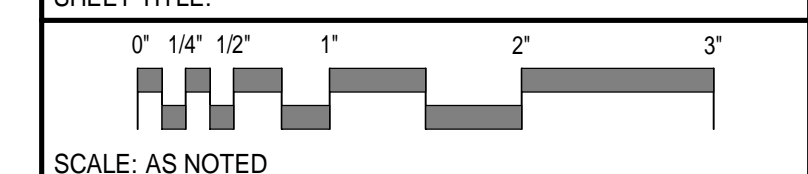

PROJECT MANAGER:	RSC	PROJECT NO.:	17123
A/E OF RECORD:	RSC		
JOB CAPTAIN:	SDL		
DRAWN BY:	SDL/JMM		
SMRT FILE:	AD102-17123	SHEET NO.:	AD102

DEMOLITION PLAN - LEVEL 2
3/32" = 1'-0" (A1)