

- ### LIFE SAFETY LEGEND
- H2 — 2 HOUR RATED HORIZONTAL EXIT & SMOKE BARRIER
 - O2 — 2 HOUR RATED OCCUPANCY SEPARATION & SMOKE BARRIER
 - F2 — 2 HOUR RATED FIRE BARRIER
 - F1 — 1 HOUR RATED FIRE BARRIER
 - S2 — 2 HOUR RATED SMOKE BARRIER
 - S1 — 1 HOUR RATED SMOKE BARRIER
 - S0 — SMOKE PARTITION
 - EXIT DISCHARGE
 - SMOKE CONTAINMENT BARRIER
 - STANDPIPE OR HOSE VALVE CABINET
 - FIRE DEPT. CONNECTION
 - TRAVEL DISTANCE
 - FIRE EXTINGUISHER CABINET
 - FIRE EXTINGUISHER WALL HUNG
 - EGRESS DOOR
 - ACCESSIBLE ENTRY/EGRESS
 - FIRE ALARM VISIBLE ONLY NOTIFICATION INDICATOR
 - FIRE ALARM AUDIBLE/VISIBLE NOTIFICATION INDICATOR
 - EXIT SIGN
 - TRAVEL PATH INDICATED BY PAINT STRIPING ON FLOOR
 - 1-HOUR CEILING ABOVE

REV	DESCRIPTION	DATE
0	ISSUED FOR CONSTRUCTION	12-21-17

REV	DESCRIPTION	DATE
0	ISSUED FOR CONSTRUCTION	12-21-17

ISSUED FOR CONSTRUCTION
12-21-17

CURRENT ISSUE STATUS:

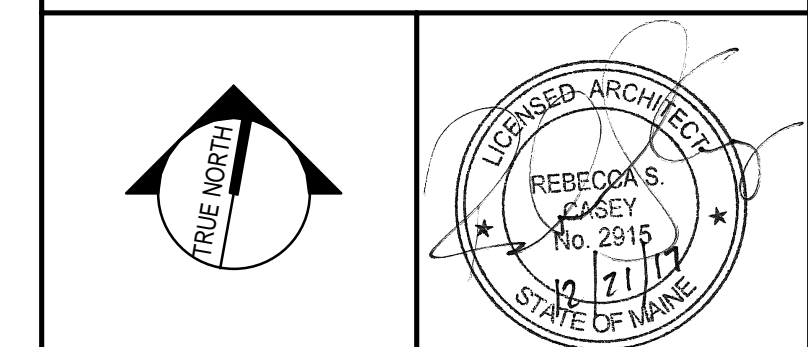

PROJECT NORTH:
SMRT Architects and Engineers
144 Fore Street/P.O. Box 618
Portland, Maine 04104



**MAINE MEDICAL CENTER
M.M.C. HUTCHINS DRIVE
RENOVATION**

PROJECT LOCATION
CODE COMPLIANCE PLAN - LEVEL 1

SHEET TITLE:
0' 1/4" 1/2" 1" 2" 3"

SCALE: AS NOTED

PROJECT MANAGER:	RSC	PROJECT NO.:	17123
A/E OF RECORD:	RSC		
JOB CAPTAIN:	SDL		
DRAWN BY:	SDL/JMM		
SMRT FILE:	A-101-17123	SHEET NO.:	A-101

CODE COMPLIANCE PLAN - LEVEL 1
3/32" = 1'-0" (A1)