



Project Title
CROSS INSURANCE RENOVATIONS
 2367 CONGRESS STREET
 PORTLAND, MAINE

GENERAL NOTES

1. REFER TO ELECTRICAL DRAWINGS FOR SPECIFIC ELECTRICAL REQUIREMENTS FOR FIRE ALARM, EMERGENCY LIGHTS & SMOKE/HEAT DETECTION.
2. REFER TO ARCHITECTURAL DRAWINGS FOR FIRE EXTINGUISHER TYPES.

Mark	Date	Description
01 - 29 - 18		CONSTRUCTION DRAWINGS

Issue Dates

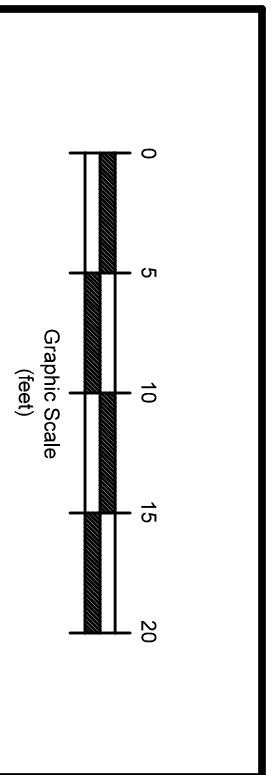

Drawing Title
LIFE SAFETY PLAN

Drawing Number

A00.2

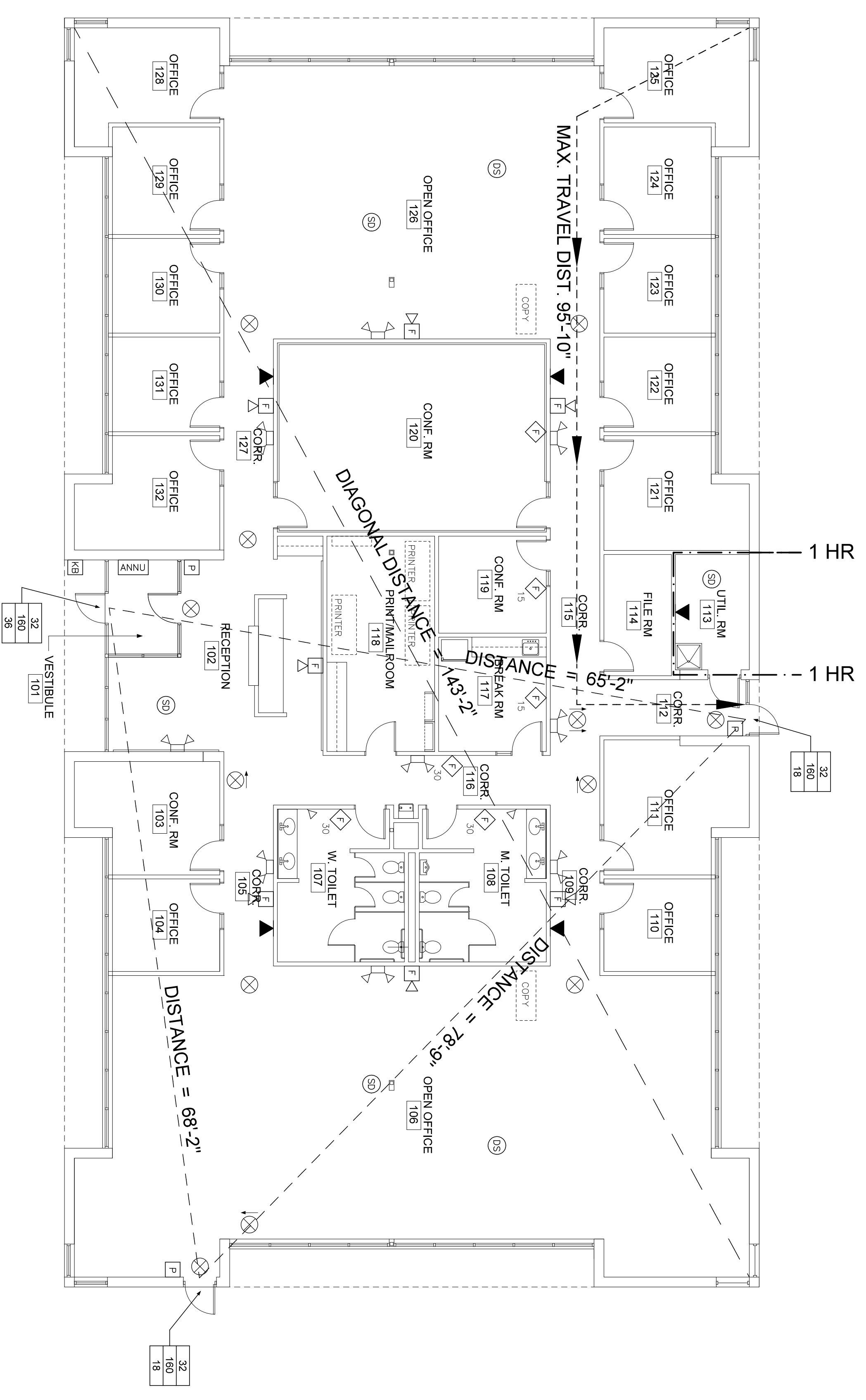

LIFE SAFETY PLAN
 1/8" = 1'-0"

MAINE STATE PLUMBING CODE (2015 UPC)

72 OCCUPANTS - 36 MALE / 36 FEMALE	WATER CLOSETS	URINALS	LAVATORIES
FIXTURES			
MEN	1 (1:50)	1 (1:100)	1 (1:75)
WOMEN	3 (3:50)		1 (1:50)
DRINKING FOUNTAINS - (1:150) - 1			

BUILDING DESIGN CODES:	MEANS OF EGRESS REQUIREMENTS: (2009 IBC)
AMERICAN WITH DISABILITIES ACT (ADA)	NO. OF MEANS OF EGRESS 2
IFAS - ACCESSIBILITY STANDARDS	MAX. TRAVEL DISTANCES 200 FT.
2009 NFPA 101 LIFE SAFETY CODE	MAX. DEAD END CORRIDOR 20 FT.
2009 IBC	MAX. COMMON PATH OF TRAVEL 75 FT.
2009 MAINE STATE PLUMBING CODE	MIN. CORRIDOR/STAIR WIDTH 44 INCHES
2007 NEC	
ACTUAL BUILDING AREA:	FIRE RESISTANCE ASSEMBLY RATINGS: (2009 IBC)
1st FLOOR AREA 7,895 SF	ELEVATOR SHAFTS 1 HOUR
TOTAL BUILDING AREA 7,895 SF	STAIR SHAFTS 1 HOUR
ALLOWABLE BUILDING AREA:	EXIT ACCESS CORRIDORS 1 HOUR
GROUP "B" 9,000 SF/FLR	FIRE BARRIERS 2 HOUR
TOTAL ALLOW. AREA 9,000 SF/FLR	FIRE WALLS 3 HOUR
OCCUPANCY CLASSIFICATIONS:	FIRE ALARM & DETECTION SYSTEMS
IBC - BUSINESS GROUP B	NOT REQUIRED - BUT PROVIDED
NFPA - EXISTING BUSINESS (CHAPTER 39)	ILLUMINATION OF MEAN OF EGRESS
CONSTRUCTION CLASSIFICATION:	REQUIRED PER NFPA
IBC - TYPE SB (COMBUSTIBLE/UNPROTECTED)	EMERGENCY LIGHTING
NFPA - TYPE IV (000)	REQUIRED PER NFPA
NUMBER OF STORES/BLDG. HT.	REQUIRED PER NFPA
ACTUAL - 1 STORES & 14 FEET	REQUIRED PER NFPA
ALLOWABLE - 2 STORES & 40 FEET	REQUIRED PER NFPA
OCCUPANT LOAD (Based on useable Area - 7,115 SF)	REQUIRED PER NFPA
BUSINESS 1/100 SF 72 PERSONS	REQUIRED PER NFPA
TOTAL OCCUPANCY 72 PERSONS	REQUIRED PER NFPA
FIRE SUPPRESSION:	REQUIRED PER NFPA
NO SPRINKLERS	REQUIRED PER NFPA
SEPARATION REQUIREMENTS	REQUIRED PER NFPA
N.A.	REQUIRED PER NFPA

CODE INFORMATION

A3

SYMBOL LEGEND

A2

PLUMBING FIXTURE COUNT

A1