

City of Portland, Maine – Building or Use Permit Application 389 Congress Street, 04101, Tel: (207) 874-8703, FAX: 874-8716

238-A-A-005

Location of Construction: 389 Congress St.		Owner: Seafair Assoc		Phone:	
Owner Address: 389 Congress St - Portland, ME		Leasee/Buyer's Name: Marshall & Leiby - CPA		Phone: 775-1111	
Contractor Name: Printers 1/45 34 Diamond St		Address: Portland, ME 04101		Phone: 772-4000	
Past Use: office sign		Proposed Use: office sign & signs		COST OF WORK: \$ PERMIT FEE: \$ 23.20	
Proposed Project Description: erect four signs - 4'x1', 4'x1', 2'x1', 3'x2'		FIRE DEPT. <input type="checkbox"/> Approved <input type="checkbox"/> Denied		INSPECTION: Use Group: U Type: Signature: <i>[Signature]</i>	
		Signature: Date:		PEDESTRIAN ACTIVITIES DISTRICT (P.A.D.) Action: <input type="checkbox"/> Approved <input type="checkbox"/> Approved with Conditions <input type="checkbox"/> Denied Signature: _____ Date: _____	

Permit No:
040983

Permit Issued:
PERMIT ISSUED
SEP 15 1994

Zone: CBL

CITY OF PORTLAND

Zoning Approval:

Special Zone or Reviews:

Shoreland
 Wetland
 Flood Zone
 Subdivision
 Site Plan maj minor mm

Zoning Appeal

Variance
 Miscellaneous
 Conditional Use
 Interpretation
 Approved
 Denied

Historic Preservation

Not in District or Landmark
 Does Not Require Review
 Requires Review

Action:

Approved
 Approved with Conditions
 Denied

Date: 9/9/94

[Signature]

1. This permit application doesn't preclude the Applicant(s) from meeting applicable State and Federal rules.
2. Building permits do not include plumbing, septic or electrical work.
3. Building permits are void if work is not started within six (6) months of the date of issuance. False information may invalidate a building permit and stop all work..

CERTIFICATION

I hereby certify that I am the owner of record of the named property, or that the proposed work is authorized by the owner of record and that I have been authorized by the owner to make this application as his authorized agent and I agree to conform to all applicable laws of this jurisdiction. In addition, if a permit for work described in the application issued, I certify that the code official's authorized representative shall have the authority to enter all areas covered by such permit at any reasonable hour to enforce the provisions of the code(s) applicable to such permit

SIGNATURE OF APPLICANT	ADDRESS:	DATE:	PHONE:
RESPONSIBLE PERSON IN CHARGE OF WORK, TITLE			PHONE:

White-Permit Desk Green-Assessor's Canary-D.P.W. Pink-Public File Ivory Card-Inspector

CEO DISTRICT 2/

[Signature]

COMMENTS

Done w/out Insp.

Inspection Record

Type	Date
Foundation: _____	_____
Framing: _____	_____
Plumbing: _____	_____
Final: _____	_____
Other: _____	_____

Post-It™ brand fax transmittal memo 7671 # of pages > 1	
To Fred Markle	From Bunnie Bond
Co. Print Mail of Maine	Co. Marshall & Libby
Dept.	Phone # 775-1111
Fax # 772-5144	Fax # 772 774-3439

9.06
 [Handwritten initials and date 11/94]

OWNERS CONSENT AND AGREEMENT

I, Gemini Associates, being the owner of the premises located at
(print property owners name)

2271 CONGRESS ST in Portland, Maine, hereby give consent to the
(print property address)

erection of a certain sign/~~awning~~/~~banner~~ owned by MARSHALL & LIBBY
(print lessee's name)

over the sidewalk or on building from said premises as described in
application to the Division of Inspection Services.

And in consideration of the issuance of said permit, owner of said premises,
in event said sign shall cease to serve the purpose for which it was erected
or shall become dangerous and in event the owner of said sign shall fail to
remove said sign or make it permanently safe in case the sign still serves
the purpose for which it was erected, hereby agree for himself or itself,
for his heirs, its successors, and his or its assigns, to completely remove
said sign.

[Signature]
 Signature of Property Owner
 Michael Pinette

[Signature]
 Signature of Lessee
 Paul R. Marshall

August 31, 1994
 Date

August 31, 1994
 Date

JOB NAME:
MARSHALL & LIBBY
 SALES REP.
FRED MERRILL

SIGN C

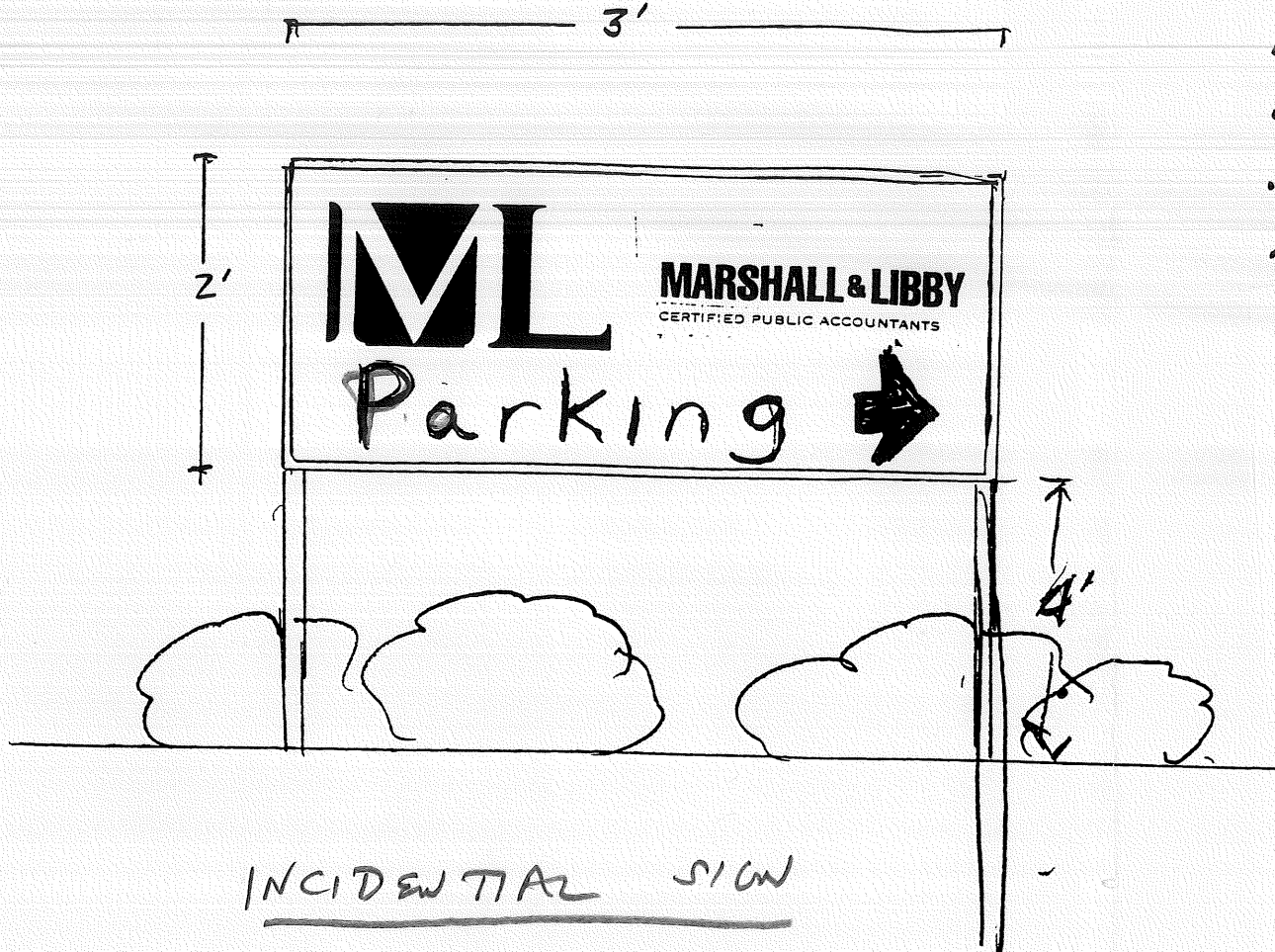

- POST & PANEL DIRECTIONAL
- NON-ILLUMINATED 9/F
 - 3' x 2' DIRECTIONAL
 - 3/4" 1100
 - WHITE 9/F
 - 2" x 2" POST

INCIDENTAL SIGN

- DIRECTIONAL - NON-ILLUMINATED
- DOUBLE-FACED
- 6 SQ FT TOTAL

NO.	DATE	REVISIONS	BY
1			
2			
3			
4			
5			



Signs:
 Vinyl Graphics & Lettering:
 Cars, Trucks & Boats
 ADA Signage
 Magnetic Signs
 Banners
 Neon Signs
 Metal • Wood • Acrylic
 Trade show Displays
 Interior & Exterior Signage
 Site Sign Management

34 Diamond Street
 Portland, Maine 04101
 Telephone: (207) 772-4000
 1-800-DIR-MAIL
 FAX (207) 772-5144

DATE **8.25.94**
 SCALE **NOT TO SCALE**
 DESIGNED BY **CLAW**

© COPYRIGHT BY THE SIGN SHOPPE
 AT PRINT MAIL OF MAINE.
 THIS DESIGN IS THE PROPERTY OF
 THE SIGN SHOPPE. ALL PRODUCTION
 AND DUPLICATION RIGHTS ARE
 RESERVED.

CHECKED BY
 DRAWING NUMBER **94082507**
 SHEET **2** OF **2**

DESIGNED FOR
MARSHALL & LIBBY

LOCATION
PORTLAND

DRAWING SPECIFICATIONS ACCEPTED BY
[Signature] **8/25/94**

JOB NAME:
MARSHALL & LIBBY

SALES REP.
FRAN MEARLE

SIGN B

Parking Directional # 2

- SINGLE FACED
- 3/4" MDO
- METAL POLE - 2" x 2"
- COMPLETE & INSTALLED

← 2' →



↑ 1' ↓

4'

INCIDENTAL SIGN

- NOW ILLUMINATED
- 2 SQ FT
- SINGLE FACED



FACE REPLACE

NO.	DATE	REVISIONS	BY
1			
2			
3			
4			
5			



Signs:
 Vinyl Graphics & Lettering:
 Cars, Trucks & Boats
 ADA Signage
 Magnetic Signs
 Banners
 Neon Signs
 Metal • Wood • Acrylic
 Trade show Displays
 Interior & Exterior Signage
 Site Sign Management

34 Diamond Street
 Portland, Maine 04101
 Telephone: (207) 772-4000
 1-800-DIR-MAIL
 FAX (207) 772-5144

DATE AUG 25, 1994

SCALE 1" = 6"

DESIGNED BY CLIENT

CHECKED BY

DRAWING NUMBER 94082507

SHEET 1 OF 2

© COPYRIGHT BY THE SIGN SHOPPE AT PRINT MAIL OF MAINE.
 THIS DESIGN IS THE PROPERTY OF THE SIGN SHOPPE. ALL PRODUCTION AND DUPLICATION RIGHTS ARE RESERVED.

DESIGNED FOR MARSHALL & LIBBY

LOCATION PORTLAND

DRAWING SPECIFICATIONS ACCEPTED BY [Signature] 8/25/94

JOB NAME:
MARSHALL & LIBBY
SALES REP:
FRED MENKLE

- SITE PLAN on BACK

Sign A

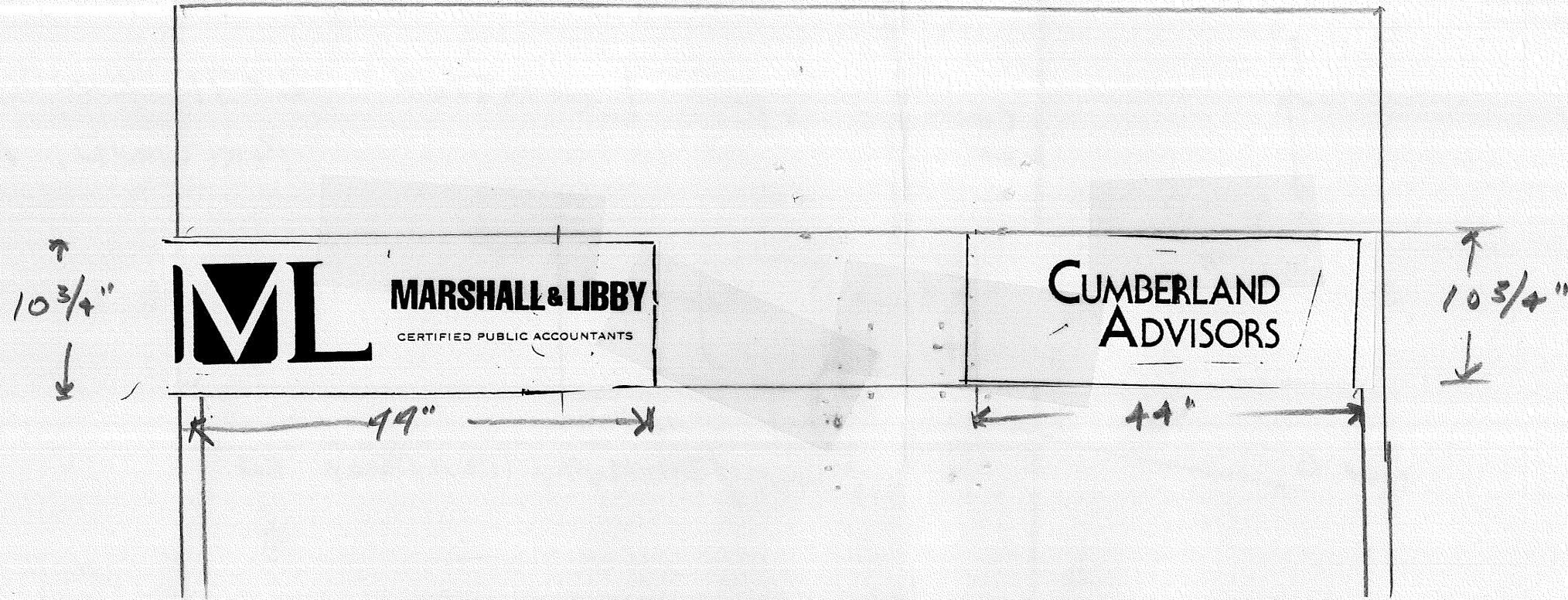

- FACE REPLACEMENTS
- D/F
- NON-ILLUMINATED
- TOTAL 8 SQ. FT. - BOTH SIGNS

NO.	DATE	REVISIONS	BY
1			
2			
3			
4			
5			



Signs:
 Vinyl Graphics & Lettering:
 Cars, Trucks & Boats
 ADA Signage
 Magnetic Signs
 Banners
 Neon Signs
 Metal • Wood • Acrylic
 Trade show Displays
 Interior & Exterior Signage
 Site Sign Management

34 Diamond Street
 Portland, Maine 04101
 Telephone: (207) 772-4000
 1-800-DIR-MAIL
 FAX (207) 772-5144

DATE 8.29.94

SCALE NOT TO SCALE

DESIGNED BY CLIENT

CHECKED BY

© COPYRIGHT BY THE SIGN SHOPPE AT PRINT MAIL OF MAINE.

THIS DESIGN IS THE PROPERTY OF THE SIGN SHOPPE. ALL PRODUCTION AND DUPLICATION RIGHTS ARE RESERVED.

DRAWING NUMBER 940829015

SHEET 1 OF 1

DESIGNED FOR MARSHALL & LIBBY

LOCATION PORTLAND, ME

DRAWING SPECIFICATIONS ACCEPTED BY

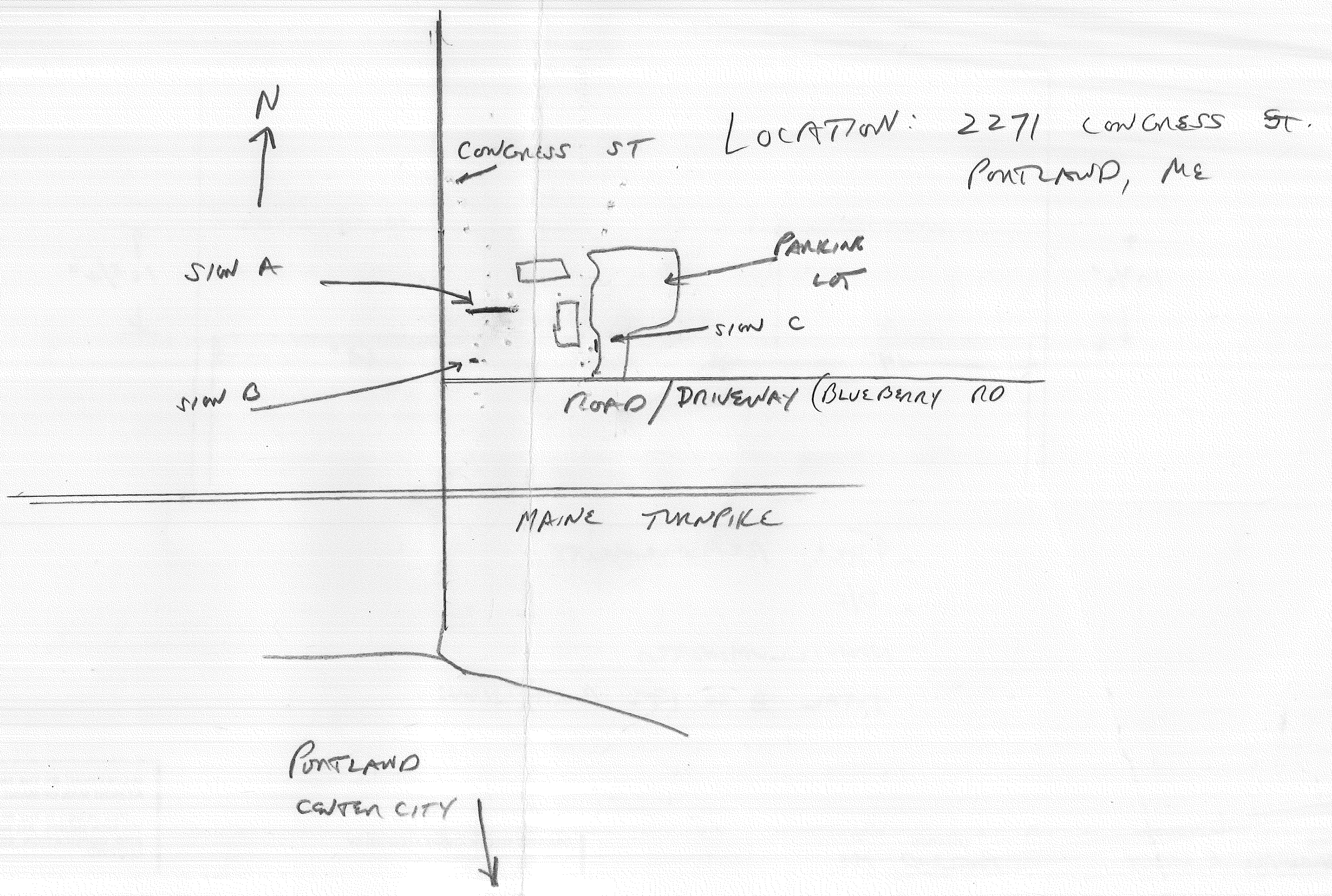

N
↑

LOCATION: 2271 CONGRESS ST.
PORTLAND, ME

CONGRESS ST

SIGN A

PARKING LOT

SIGN C

SIGN B

ROAD/DRIVEWAY (BLUEBERRY RD)

MAINE TURNPIKE

PORTLAND
CENTER CITY

↓