

- AREA OF REFUGE SYSTEM NOTES**
1. REPLACE EXISTING CORNELL COMMUNICATIONS, INC FOUR ZONE RESCUE ASSISTANCE ANNUNCIATOR PANEL WITH A NEW EIGHT ZONE PANEL - CORNELL #A4208. CHANGE BACKBOX AS REQUIRED.
 2. INSTALL CALL STATIONS, CORNELL #4201A IN ALL LOCATIONS INDICATED.
 3. PROVIDE, INSTALL AND CONNECT ALL WIRING AS REQUIRED.
 4. ALL WORK FOR THIS SYSTEM SHALL BE DONE BY A FACTORY AUTHORIZED INSTALLER.

Project Title
**WOODARD & CURRAN
 OFFICE ADDITION**

PORTLAND, MAINE

HA Project No. **05178**

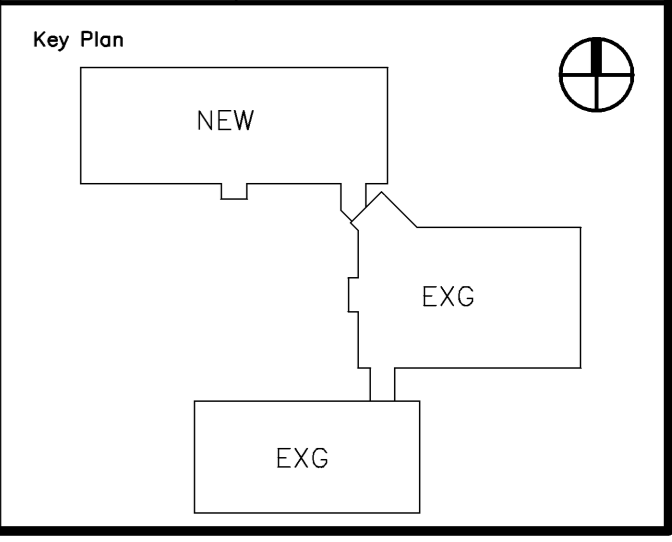

- KEY NOTES:**
- P01...SEE DETAILS B2, B3, & B4 ON DWG E70.1.
- P02...SEE DETAIL B1 ON DWG E70.1 FOR ELEC ROOM ELEVATIONS.

Mark	Date	Description
-	05-15-06	ISSUED FOR CONSTRUCTION
-	03-14-06	FINAL REVIEW
-	02-03-06	DD REVIEW

Issue Dates

Drawing Status

Drawing Title
**FIRST
 FLOOR PLAN
 POWER**

PA / PE: **JWT** Drawn By: **JWT**

Drawing Number
E20.1