

DISPLAY THIS CARD ON PRINCIPAL FRONTAGE OF WORK

CITY OF PORTLAND

BUILDING INSPECTION

PERMIT

Please Read Application And Notes, If Any, Attached

Permit Number: 040687
JUL 07 2004
CITY OF PORTLAND

This is to certify that Sturbridge Yankee Workshop Inc/Pine Bluff Corporation

has permission to Amendment to permit #04-02 interior operation

AT 2 Blueberry Rd

Call 238 A018001

provided that the person or persons, firm or corporation accepting this permit shall comply with all of the provisions of the Statutes of Maine and of the Ordinances of the City of Portland regulating the construction, maintenance and use of buildings and structures, and of the application on file in this department.

Apply to Public Works for street line and grade if nature of work requires such information.

Notification of inspection must be given and written permission procured before this building or part thereof is laid out or occupied. CLOSED-IN. HOUR NOTICE IS REQUIRED.

A certificate of occupancy must be procured by owner before this building or part thereof is occupied.

OTHER REQUIRED APPROVALS

Fire Dept. *[Signature]*

Health Dept. _____

Appeal Board _____

Other _____
Department Name

[Signature] 7/6/04
Director - Building & Inspection Services

PENALTY FOR REMOVING THIS CARD

City of Portland, Maine - Building or Use Permit Application

389 Congress Street, 04101 Tel: (207) 874-8703, Fax: (207) 874-8716

PERMIT ISSUED

Permit No: 04-0687	Issue Date: JUL 07 2004	CBL: 238 A018001
-----------------------	----------------------------	---------------------

Location of Construction: 2 Blueberry Rd	Owner Name: Sturbridge Yankee Workshop Inc	Owner Address: 90 Blueberry Rd CITY OF PORTLAND	Phone:
Business Name:	Contractor Name: Pine Brook Corporation	Contractor Address: 37 Route 236 - Suite 105 Kittery	Phone: 2074397547
Lessee/Buyer's Name	Phone:	Permit Type: Amendment to Commercial	Zone: IM

Past Use: Office/warehouse	Proposed Use: Office/warehouse: Amendment to permit #04-0248 interior alterations	Permit Fee: \$30.00	Cost of Work: \$0.00	CEO District: 3
		FIRE DEPT: <input checked="" type="checkbox"/> Approved <input type="checkbox"/> Denied	INSPECTION: Use Group: F1 Type: 2c 3/6/04 <i>[Signature]</i>	

Proposed Project Description:
Amendment to permit #04-0248 interior alterations

Signature: *[Signature]* Signature: *[Signature]*
PEDESTRIAN ACTIVITIES DISTRICT (P.A.D.)
 Action: Approved Approved w/Conditions Denied
 Signature: _____ Date: _____

Permit Taken By: kwd	Date Applied For: 0512512004	Zoning Approval		
-------------------------	---------------------------------	------------------------	--	--

1. This permit application does not preclude the Applicant(s) from meeting applicable State and Federal Rules. 2. Building permits do not include plumbing, septic or electrical work. 3. Building permits are void if work is not started within six (6) months of the date of issuance. False information may invalidate a building permit and stop all work..	Special Zone or Reviews <input type="checkbox"/> Shoreland <input type="checkbox"/> Wetland <input type="checkbox"/> Flood Zone <input type="checkbox"/> Subdivision <input type="checkbox"/> Site Plan Maj <input type="checkbox"/> Minor <input type="checkbox"/> MM <input type="checkbox"/> Date: <i>OK 4/9/04</i>	Zoning Appeal <input type="checkbox"/> Variance <input type="checkbox"/> Miscellaneous <input type="checkbox"/> Conditional Use <input type="checkbox"/> Interpretation <input type="checkbox"/> Approved <input type="checkbox"/> Denied Date: _____	Historic Preservation <input checked="" type="checkbox"/> Not in District or Landmark <input type="checkbox"/> Does Not Require Review <input type="checkbox"/> Requires Review <input type="checkbox"/> Approved <input type="checkbox"/> Approved w/Conditions <input type="checkbox"/> Denied <input type="checkbox"/> Denied Date: _____ <i>[Signature]</i>
--	--	---	---

CERTIFICATION

I hereby certify that I am the owner of record of the named property, or that the proposed work is authorized by the owner of record and that I have been authorized by the owner to make this application as his authorized agent and I agree to conform to all applicable laws of this jurisdiction. In addition, if a permit for work described in the application is issued, I certify that the code official's authorized representative shall have the authority to enter all areas covered by such permit at any reasonable hour to enforce the provision of the code(s) applicable to such permit.

SIGNATURE OF APPLICANT	ADDRESS	DATE	PHONE
RESPONSIBLE PERSON IN CHARGE OF WORK, TITLE		DATE	PHONE

City of Portland, Maine - Building or Use Permit

389 Congress Street, 04101 Tel: (207) 874-8703, Fax: (207) 874-8716

Permit No: 04-0687	Date Applied For: 05/25/2004	CBL: 238 A018001
------------------------------	--	----------------------------

Location of Construction: 2 Blueberry Rd	Owner Name: Sturbridge Yankee Workshop Inc	Owner Address: 90 Blueberry Rd	Phone:
Business Name:	Contractor Name: Pine Brook Corporation	Contractor Address: 37 Route 236 - Suite 105 Kittery	Phone: (207) 439-7547
Lessee/Buyer's Name	Phone:	Permit Type: Amendment to Commercial	
Proposed Use: Office/warehouse: Amendment to permit #04-0248 interior alterations		Proposed Project Description: Amendment to permit #04-0248 interior alterations	

Dept: Building	Status: Pending	Reviewer: Mike Nugent	Approval Date:
Note:			Ok to Issue: <input type="checkbox"/>
Dept: Fire	Status: Pending	Reviewer: Lt. MacDougal	Approval Date:
Note:			Ok to Issue: <input type="checkbox"/>

Comments:
06/21/2004-mjn: May need SPR for the 1500sq.ft. Driveway, called applicant and emailed Marge, Jay and Sarah

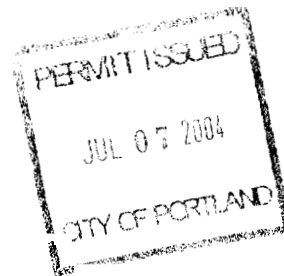

04-0687

All Purpose Building Permit Application

If you or the property owner owes real estate or personal property taxes or user charges on any property within the City, payment arrangements must be made before permits of any kind are accepted.

Location/Address of Construction: <u>BLUEBERRY RD 65.99</u>		
Total Square Footage of Proposed Structure		Square Footage of Lot <u>178,470</u>
Tax Assessor's Chart, Block & Lot Chart# <u>238</u> Block# <u>A-18</u> Lot#	Owner: <u>STURBRIDGE YANKEE WORKSHOP, INC</u>	Telephone: <u>(207) 774-9045</u>
Lessee/Buyer's Name (if Applicable)	Applicant name, address & telephone: <u>CRYSTAL WILSON PINE BROOK CORPORATION 37 ROUTE 236, SUITE 105 KIMBERT, ME 03904</u>	Cost Of Work: \$ <u>16,936</u> Fee: \$ <u>174.00</u>
Current use: <u>OFFICE WAREHOUSE</u>		
If the location is currently vacant, what was prior use: _____		
Approximately how long has it been vacant: _____		
Proposed use: <u>OFFICE WAREHOUSE</u> <i>amendments to permit</i>		
Project description: <u>ADD (1) 9x9 OVERHEAD DOOR & 16'x91' RAMP</u> <u>040348</u>		
Contractor's name, address & telephone: <u>PINE BROOK CORPORATION (207) 439.7547 37 ROUTE 236, SUITE 05 KIMBERT, ME 03904</u>		
Who should we contact when the permit is ready: <u>CRYSTAL WILSON</u>		
Mailing address: <u>PINE BROOK CORPORATION 37 ROUTE 236, SUITE 105 KIMBERT, ME 03904</u>		
We will contact you by phone when the permit is ready, You must come in and pick up the permit and review the requirements before starting any work, with a Plan Reviewer. A stop work order will be issued and a \$100.00 fee if any work starts before the permit is picked up. PHONE: <u>(207) 439.7547</u> <i>call</i>		

RECEIVED
MAY 26 2004

IF THE REQUIRED INFORMATION IS NOT INCLUDED IN THE SUBMISSIONS THE PERMIT WILL BE AUTOMATICALLY DENIED AT THE DISCRETION OF THE BUILDING/PLANNING DEPARTMENT, WE MAY REQUIRE ADDITIONAL INFORMATION IN ORDER TO APPROVE THIS PERMIT.

I hereby certify that I am the Owner of record of the named property, or that the owner of record authorizes the proposed work and that I have been authorized by the owner to make this application as his/her authorized agent. I agree to conform to all applicable laws or this jurisdiction. In addition, if a permit for work described in this application is issued, I certify that the Code Official's authorized representative shall have the authority to enter all areas covered by this permit at any reasonable hour to enforce the provisions of the codes applicable to this permit.

Signature of applicant: <i>[Signature]</i>	Date: <u>MAY 25, 2004</u>
--	---------------------------

This is NOT a permit, you may not commence ANY work until the permit is issued. If you are in a Historic District you may be subject to additional permitting and fees with the Planning Department on the 4th floor of City Hall

City of Portland, Maine - Building or Use Permit Application

389 Congress Street, 04101 Tel: (207) 874-8703, Fax: (207) 874-8716

Permit No: 04-0248 Issue Date: CBL: 238 A018001

Location of Construction: 2 Blueberry Rd	Owner Name: Sturbridge Yankee Workshop Inc	Owner Address: 90 Blueberry Rd	Phone:
Business Name:	Contractor Name: Pine Brook Corporation	Contractor Address: 37 Route 236 - Suite 105 Kittery	Phone: 2074397547
Lessee/Buyer's Name	Phone:	Permit Type: Alterations - Commercial	Zone:

Warehouse w/office space	Warehouse w/office space: Interior renovations to existing office	Permit Fee:	Cost of Work:	CEO District:
Proposed Project Description: Interior renovations to existing office		FIRE DEPT: <input type="checkbox"/> Approved <input type="checkbox"/> Denied	INSPECTION: Use Group: Type:	
		Signature:	Signature:	
		Action: <input type="checkbox"/> Approved <input type="checkbox"/> Approved w/Conditions <input type="checkbox"/> Denied		
		Signature:	Date:	

Permit Taken By: kwd	Date Applied For: 03/15/2004	Zoning Approval		
--------------------------------	--	------------------------	--	--

<ol style="list-style-type: none"> This permit application does not preclude the Applicant(s) from meeting applicable State and Federal Rules. Building permits do not include plumbing, septic or electrical work. Building permits are void if work is not started within six (6) months of the date of issuance. False information may invalidate a building permit and stop all work.. 	Special Zone or Reviews <input type="checkbox"/> Shoreland <input type="checkbox"/> Wetland <input type="checkbox"/> Flood Zone <input type="checkbox"/> Subdivision <input type="checkbox"/> Site Plan Maj <input type="checkbox"/> Minor <input type="checkbox"/> MM <input type="checkbox"/> late:	Zoning Appeal <input type="checkbox"/> Variance <input type="checkbox"/> Miscellaneous <input type="checkbox"/> Conditional Use <input type="checkbox"/> Interpretation <input type="checkbox"/> Approved <input type="checkbox"/> Denied Date:	Historic Preservation <input type="checkbox"/> Not in District or Landmark <input type="checkbox"/> Does Not Require Review <input type="checkbox"/> Requires Review <input type="checkbox"/> Approved <input type="checkbox"/> Approved w/Conditions <input type="checkbox"/> Denied Date:
---	---	---	---

CERTIFICATION

I hereby certify that I am the owner of record of the named property, or that the proposed work is authorized by the owner of record and that I have been authorized by the owner to make this application as his authorized agent and I agree to conform to all applicable laws of this jurisdiction. In addition, if a permit for work described in the application is issued, I certify that the code official's authorized representative shall have the authority to enter all areas covered by such permit at any reasonable hour to enforce the provision of the code(s) applicable to such permit.

SIGNATURE OF APPLICANT ADDRESS DATE PHONE

RESPONSIBLE PERSON IN CHARGE OF WORK, TITLE DATE PHONE

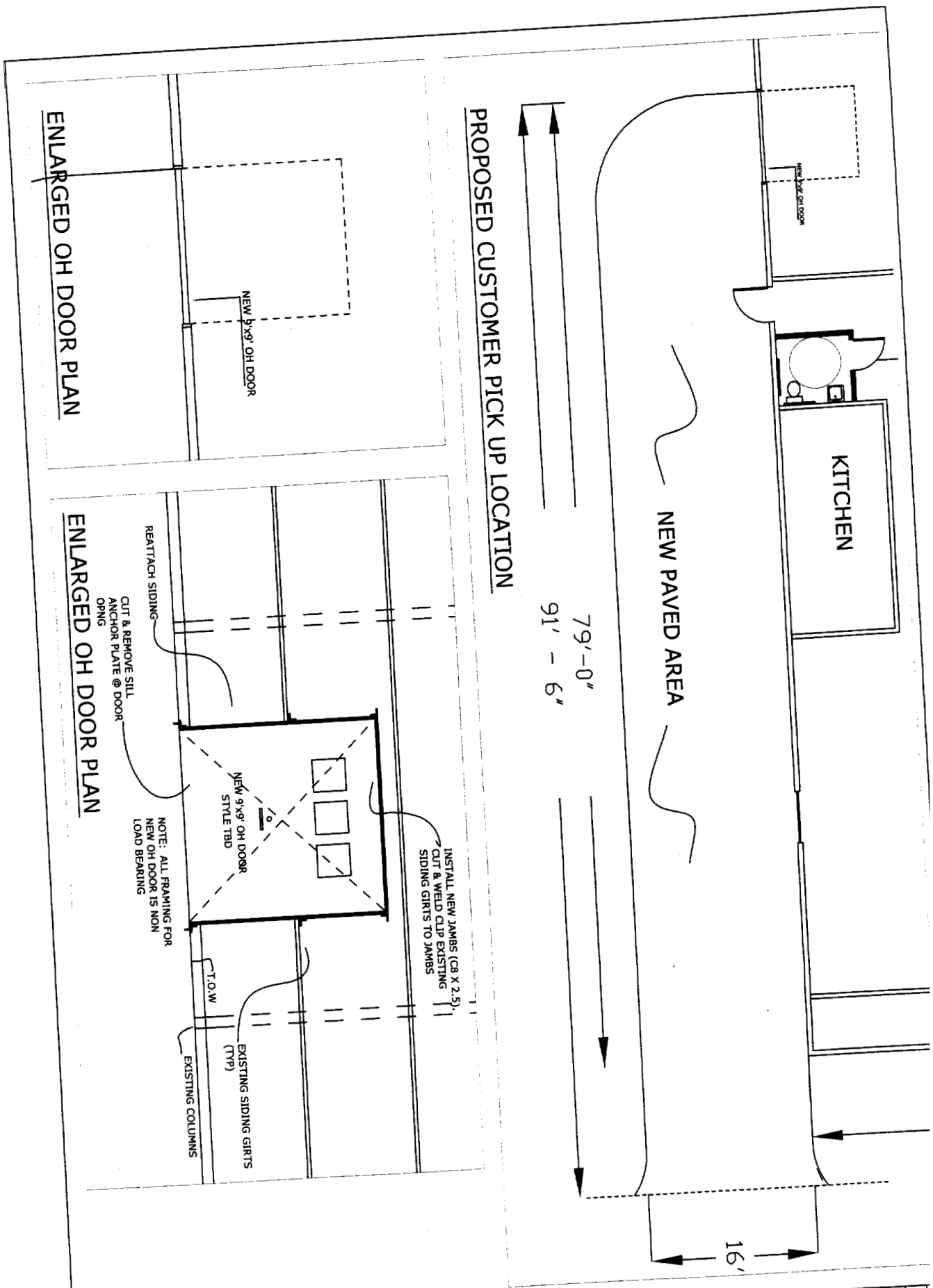

ENLARGED OH DOOR PLAN

ENLARGED OH DOOR PLAN

PROPOSED CUSTOMER PICK UP LOCATION

KITCHEN

NEW PAVED AREA

79'-0"
91'-6"

16'

REATTACH SIDING
CUT & REMOVE SILL
ANCHOR PLATE @ DOOR
OPNG

NOTE: ALL FRAMING FOR
NEW OH DOOR IS NON
LOAD BEARING

INSTALL NEW JAMBS (C9 X 2.5)
CUT & WELD CLIP EXISTING
SIDING GIRTS TO JAMBS

NEW 9'x9' OH DOOR
STYLE TBD

EXISTING SIDING GIRTS
(TYP)
EXISTING COLUMNS

STURBRIDGE YANKEE WORKSHOP
90 BLUEBERRY RD PORTLAND, MAINE

THE INFORMATION CONTAINED HEREIN IS CONFIDENTIAL AND PROPRIETARY, AND MAY NOT BE DISCLOSED OR USED IN ANY WAY
WITHOUT THE EXPRESSED WRITTEN PERMISSION OF PINE BROOK CORPORATION

57 KTL, 236, Kithery, Maine 03904
TEL. (207) 438-7847 FAX. (207) 438-8866

PINE BROOK CORPORATION

Customer
OH DOOR
PLAN &
ELEVATION
Date: 20 MAY 0
Scale: NTS
Type: A-3

Rev. Date

CMW