

NOTE:
 PLAN MAY NEED TO BE ADJUSTED
 TO MATCH SITE AND UTILITY
 CONSTRAINTS ONCE EXISTING
 CONDITIONS HAVE BEEN VERIFIED.

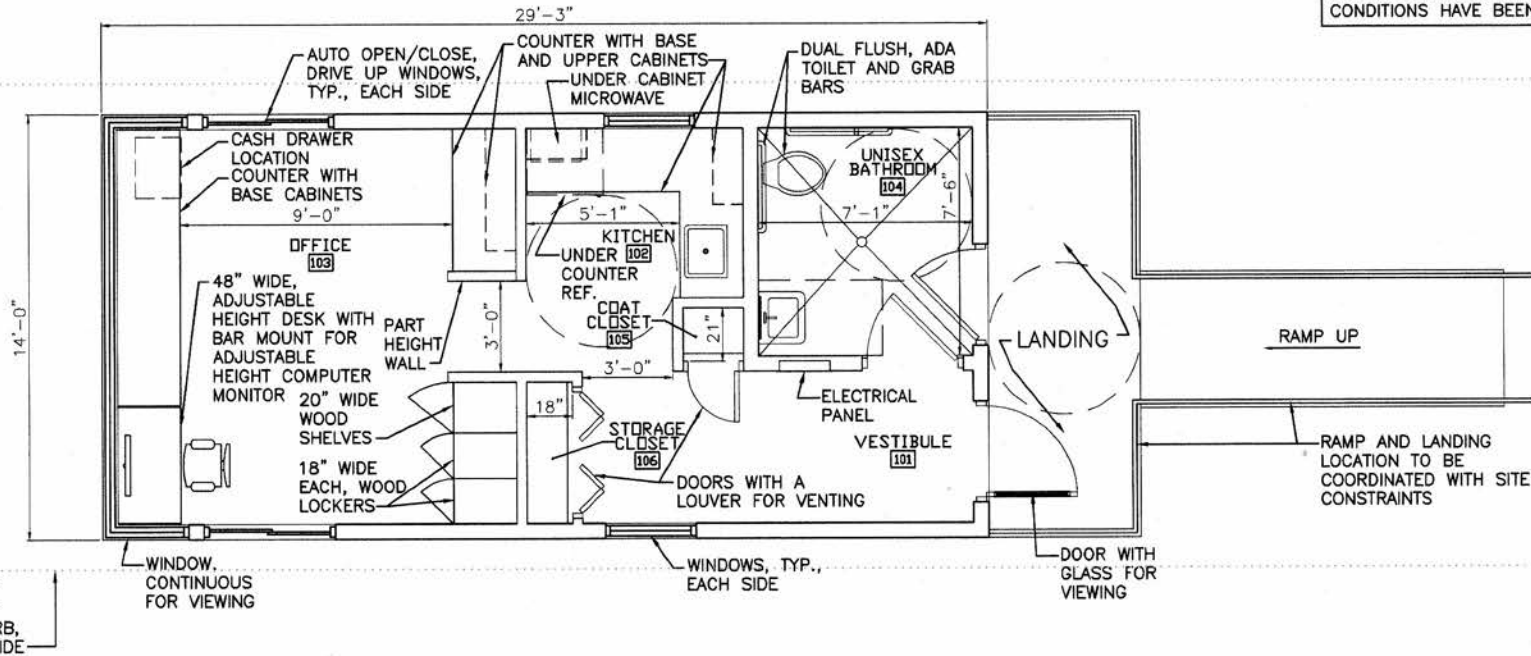

SCALE HOUSE PLAN

SCALE: 1/4" = 1'-0"

GENERAL:

- FLOORS AND WALL BASE - DURABLE AND MOISTURE RESISTANT
- WALLS - DURABLE AND MOISTURE RESISTANT
- CEILINGS - DROPPED ACOUSTICAL CEILINGS
- CASEWORK - DURABLE LAMINATE WITH BULL NOSE EDGING AND PROTECTED CORNERS
- WINDOWS - OPTIONS FOR SUN CONTROL
- DOORS - INSULATED METAL DOORS, FRAMES AND HARDWARE

RAMPED ADA ACCESS TO BUILDING:

ACCESSIBLE CONCRETE RAMP WITH METAL HANDRAILS

VESTIBULE 101:

- ACCESSIBLE MEANS OF EGRESS
- ACCESS TO UNISEX BATHROOM

KITCHEN 102:

- ACCESSIBLE COUNTER AND SINK
- CABINETS AND DRAWERS FOR STORAGE
- UNDER COUNTER REFRIGERATOR
- UNDER CABINET MICROWAVE

OFFICE 103:

- DURABLE COUNTERS WITH CABINETS
- SPACE FOR ADJUSTABLE SIT/STAND DESK
- CLEAR VIEW OF CLIENTS
- ACCESSIBILITY TO WORK SURFACES
- LOCKERS, CABINETS AND SHELVES FOR STORAGE

UNISEX BATHROOM 104:

- ACCESSIBLE BATHROOM FIXTURES
- GLAZED CERAMIC TILE FOR DURABILITY AND DAMAGE RESISTANCE
- INDEPENDENT HVAC

COAT CLOSET 105:

- STORAGE FOR COATS AND BOOTS

STORAGE CLOSET 106:

- NARROW STORAGE FOR VACUUM, SHOVELS AND MOPS

NOT FOR CONSTRUCTION
 FOR CLIENT REVIEW
 2/13/15

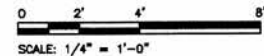

				ecomaine 64 BLUEBERRY LANE, PORTLAND, ME 04102			
C ISSUED FOR CLIENT REVIEW				RLB	DMD	CBC	1/13/14
B ISSUED FOR CLIENT REVIEW				RLB	DMD	CBC	1/13/14
A ISSUED FOR CLIENT REVIEW				RLB	DMD	CBC	1/13/14
REV	DESCRIPTION	DATE	BY	DATE	BY	DATE	DATE
				DATE	AS NOTED	PROJECT NO.	162.002.001
				DATE	12/29/14	DRAWING NO.	A1
				DATE	12/29/14	SHEET	1 OF 4
				DATE	12/29/14	DATE	12/29/14
				DATE	12/29/14	DATE	12/29/14
				DATE	12/29/14	DATE	12/29/14

PLEASE NOTE: THIS DOCUMENT MAY NOT ACCURATELY REPRESENT THE FINAL DOCUMENT. ONLY AN ENGINEER, ARCHITECT OR SURVEYOR SIGNED, SEALED AND DATED PAPER COPY, PROVIDED BY THIS OFFICE, MAY BE UTILIZED FOR BIDDING OR CONSTRUCTION PURPOSES.

Colby Company
 613.814.8113

474 York Street
 Portland, Maine 04101
 207.553.7713
 colbycoengineering.com

DATE: 12/29/14
 DESIGNED BY: RLB
 DRAWN BY: DMD
 CHECKED BY: DMD

PROJECT NO.: 162.002.001
 SHEET: 1 OF 4

DRAWING NO.

A1