

Temporary Bench Mark (TBM):
Lower flange nut on rear of hydrant.
Elevation: 98.75'

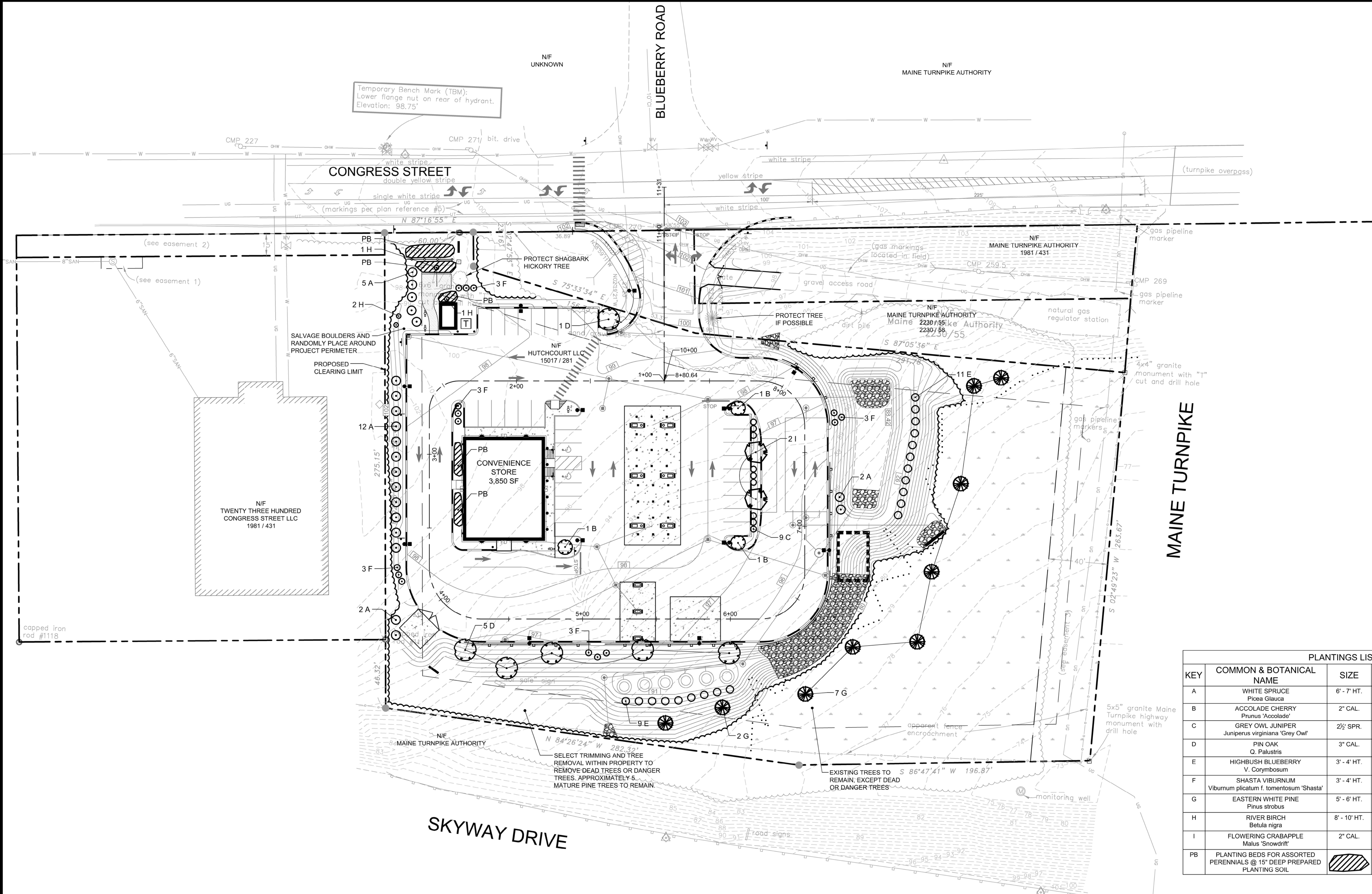

MAINE TURNPIKE

PLANTINGS LIST					
KEY	COMMON & BOTANICAL NAME	SIZE	ROOT	QTY	NOTES
A	WHITE SPRUCE <i>Picea Glauca</i>	6' - 7' HT.	B & B	21	
B	ACCOLADE CHERRY <i>Prunus 'Accolade'</i>	2" CAL.	B & B	3	
C	GREY OWL JUNIPER <i>Juniperus virginiana 'Grey Owl'</i>	2½" SPR.	B & B	9	
D	PIN OAK <i>Q. Palustris</i>	3" CAL.	B & B	6	
E	HIGHBUSH BLUEBERRY <i>V. Corymbosum</i>	3' - 4' HT.	CONT.	20	3 CANES
F	SHASTA VIBURNUM <i>Viburnum plicatum f. tomentosum 'Shasta'</i>	3' - 4' HT.	B & B	15	
G	EASTERN WHITE PINE <i>Pinus strobus</i>	5' - 6' HT.	B & B	9	
H	RIVER BIRCH <i>Betula nigra</i>	8' - 10' HT.	B & B	4	
I	FLOWERING CRABAPPLE <i>Malus 'Snowdrift'</i>	2" CAL.	B & B	2	
PB	PLANTING BEDS FOR ASSORTED PERENNIALS @ 15" DEEP PREPARED PLANTING SOIL				

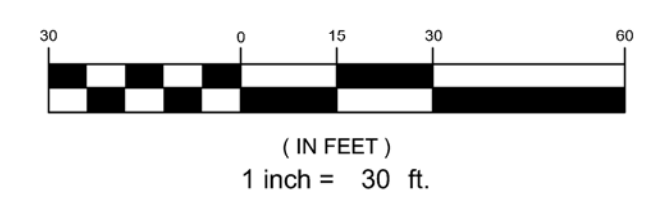

PRELIMINARY - NOT FOR CONSTRUCTION

REV	DATE	DESCRIPTION
3	04.18.13	REVISED PER CITY STAFF COMMENTS
2	04.09.13	SUBMITTED TO MEDEP STORMWATER DISCHARGE PERMIT
1	03.28.13	SUBMITTED TO CITY OF PORTLAND

STATE OF MAINE
STEPHEN B. BUSHEY
REGISTERED PROFESSIONAL ENGINEER
LIC. # 7429

PROJECT
MULTI-USE DEVELOPMENT
2282 CONGRESS ST., PORTLAND, ME

SHEET TITLE
LANDSCAPE PLAN

CLIENT
CJ DEVELOPERS, INC.
35 PRIMROSE LANE, FREEPORT, MAINE 04032

DH DeLUCA-HOFFMAN ASSOCIATES, INC.
778 MAIN STREET, SUITE 8
SOUTH PORTLAND, ME 04106
207.775.1121
WWW.DELUCAHOFFMAN.COM

DRAWN: CMW DATE: MAR. 2013
DESIGNED: SRB SCALE: 1" = 30'
CHECKED: SRB JOB NO. 3118
FILE NAME: 3118-SP

SHEET **C-5.0**