

1 Way Alternating Traffic Between 9:00 A.M. and 3:00 P.M.

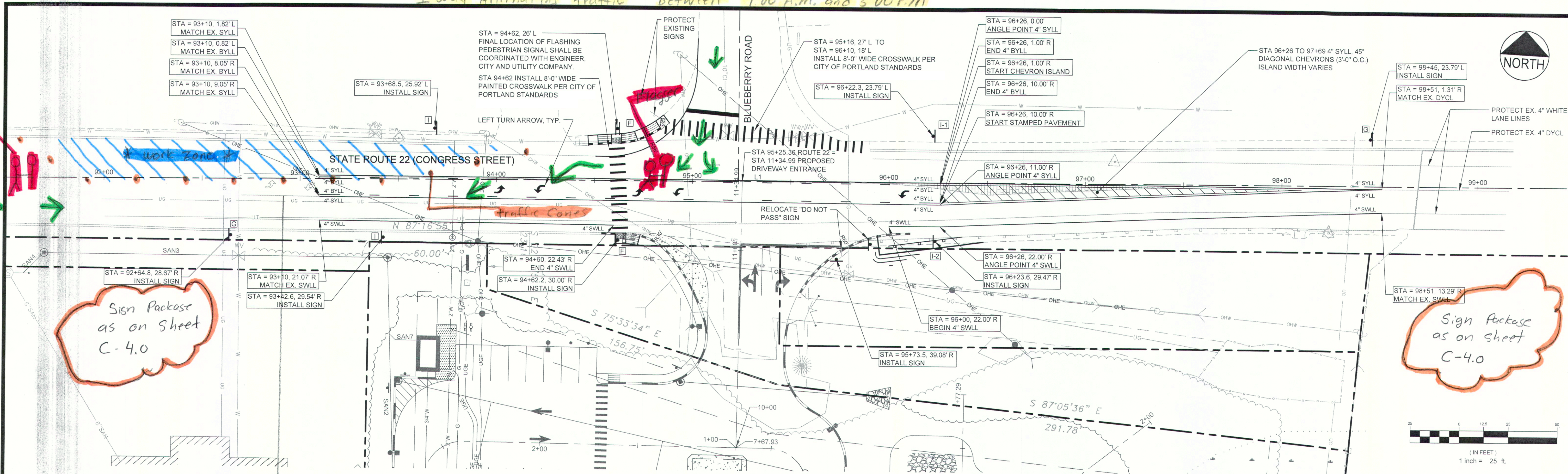

Sign Package as on sheet C-4.0

Sign Package as on sheet C-4.0

STATE ROUTE 22 (CONGRESS STREET) PLAN  
SCALE: 1" = 25'

SIGN LEGEND

RECTANGULAR RAPID FLASHING PEDESTRIAN CROSSING ASSEMBLY, SEE SHEET C-2.0 FOR DETAILS			
	AHEAD	ONLY	BEGIN
	36" x 36" 24" x 12"	24" x 36"	24" x 36" 24" x 12"
	F	G	I
			L-1
			L-2

Same layout for work zone on East Bound work zone except for opposite taper

All Work Zone Traffic Control items to be compliant with the Manual of Uniform Traffic Control Devices Version 2009.

PROJECT STATE ROUTE 22 (CONGRESS STREET) TURN LANE EXTENSION PROJECT 2282 CONGRESS STREET, PORTLAND, ME		<b>FST</b> 100 YEARS <b>FAY, SPOFFORD &amp; THORNDIKE</b> ENGINEERS - PLANNERS - SCIENTISTS 778 MAIN ST., SUITE 8, SOUTH PORTLAND, ME 04106
SHEET TITLE ROADWAY LAYOUT, SIGNAGE AND STRIPING PLAN		
CLIENT PORTLAND PROPERTY HOLDINGS, LLC 2 MAIN STREET, SUITE 200, TOPSHAM, MAINE 04086		DRAWN: CMW DESIGNED: BEK CHECKED: SRB FILE NAME: 3118.01-PLAN PROFILE SHEET: C-5.0
REVISIONS P.E. BO KENNEDY LIC. # 11994		DATE: JUNE 2013 SCALE: AS NOTED JOB NO. 3118.01
3 08.08.14 SUBMITTED TO CITY OF PORTLAND 2 07.22.14 SUBMITTED TO CITY OF PORTLAND AND MDOT 1 07.10.13 SUBMITTED TO UTILITY COMPANIES FOR REVIEW		