

STATE ROUTE #22 (CONGRESS STREET)

ROADWAY IMPROVEMENTS

PORTLAND, MAINE CUMBERLAND COUNTY OFFSITE IMPROVEMENTS PROJECT

PROJECT LENGTH: 550 FEET (0.10 MILES)
**RIGHT-OF-WAY REFERENCE: MAINE TURNPIKE AUTHORITY PROPERTY AND
 RIGHT-OF-WAY PLAN SECTION 1 - KITTEERY TO PORTLAND - SHEET 2 - REV 03/97**

DESIGNED BY:
 FAY, SPOFFORD & THORNDIKE
 778 MAIN STREET, SUITE 8
 SOUTH PORTLAND, MAINE 04105
 207.775.1121

SURVEY BY:
 TITCOMB ASSOCIATES
 133 GRAY ROAD
 FALMOUTH, MAINE 04105
 207.797.9199

PREPARED FOR:
 PORTLAND PROPERTY HOLDINGS, LLC
 2 MAIN STREET, SUITE 200
 TOPSHAM, MAINE 04086

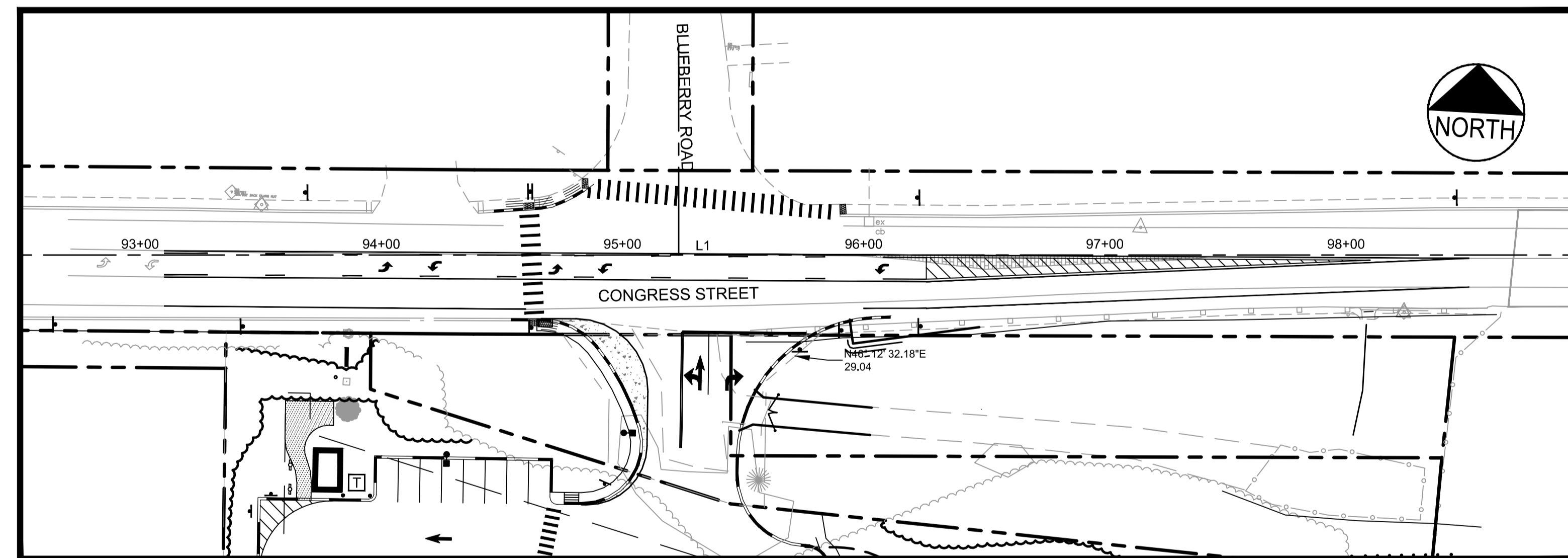
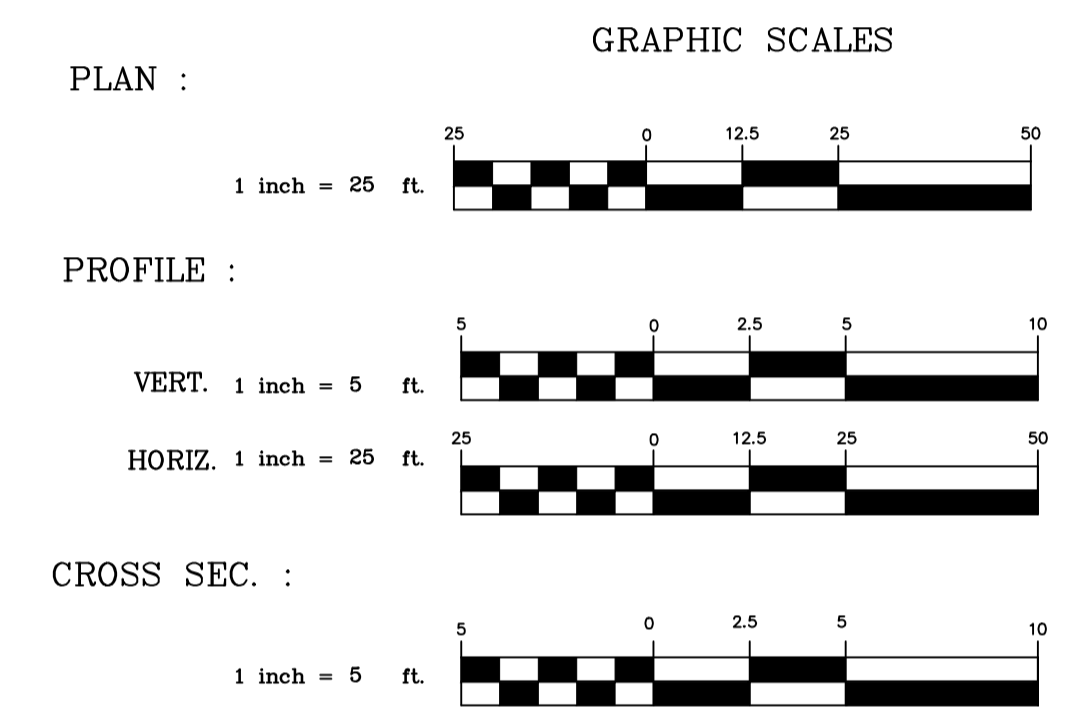

SCALE: 1" = 40'

EXISTING	DESCRIPTION	PROPOSED
	BUILDING	
	PROPERTY LINE	
	EDGE OF PAVEMENT	
	TOPOGRAPHIC CONTOUR	
	CENTER LINE	
	WOODEN FENCE	
	WIRE OR CHAIN LINK FENCE	
	STONE WALL	
	BITUMINOUS CURB	
	SLOPED GRANITE CURB	
	PAINTED DIRECTIONAL TRAFFIC ARROW	
	OVERHEAD ELECTRIC & TELEPHONE	
	OVERHEAD UTILITIES	
	UNDERGROUND ELECTRIC	
	SEWER LINE	
	STORM DRAIN LINE	
	WATER LINE	
	GUARD RAIL	
	CUT/FILL LINE	
	WATER VALVE	
	HYDRANT	
	MANHOLE	
	CATCH BASIN	
	POLE WITH LIGHT FIXTURE(S)	
	SIGNAL POLE W/ FOUNDATION	
	UTILITY POLE	
	FREESTANDING SIGN	
	IRON PIPE	
	IRON ROD	
	P.K. SPIKE	
	HIGHWAY MONUMENT	
	TREELINE	
	TREES/LANDSCAPING	
	SILT FENCE	
	LEDGE OUTCROP OR SHALLOW ROCK	
	WETLAND LIMITS	
	DETECTABLE WARNING SURFACE (TACTILE)	

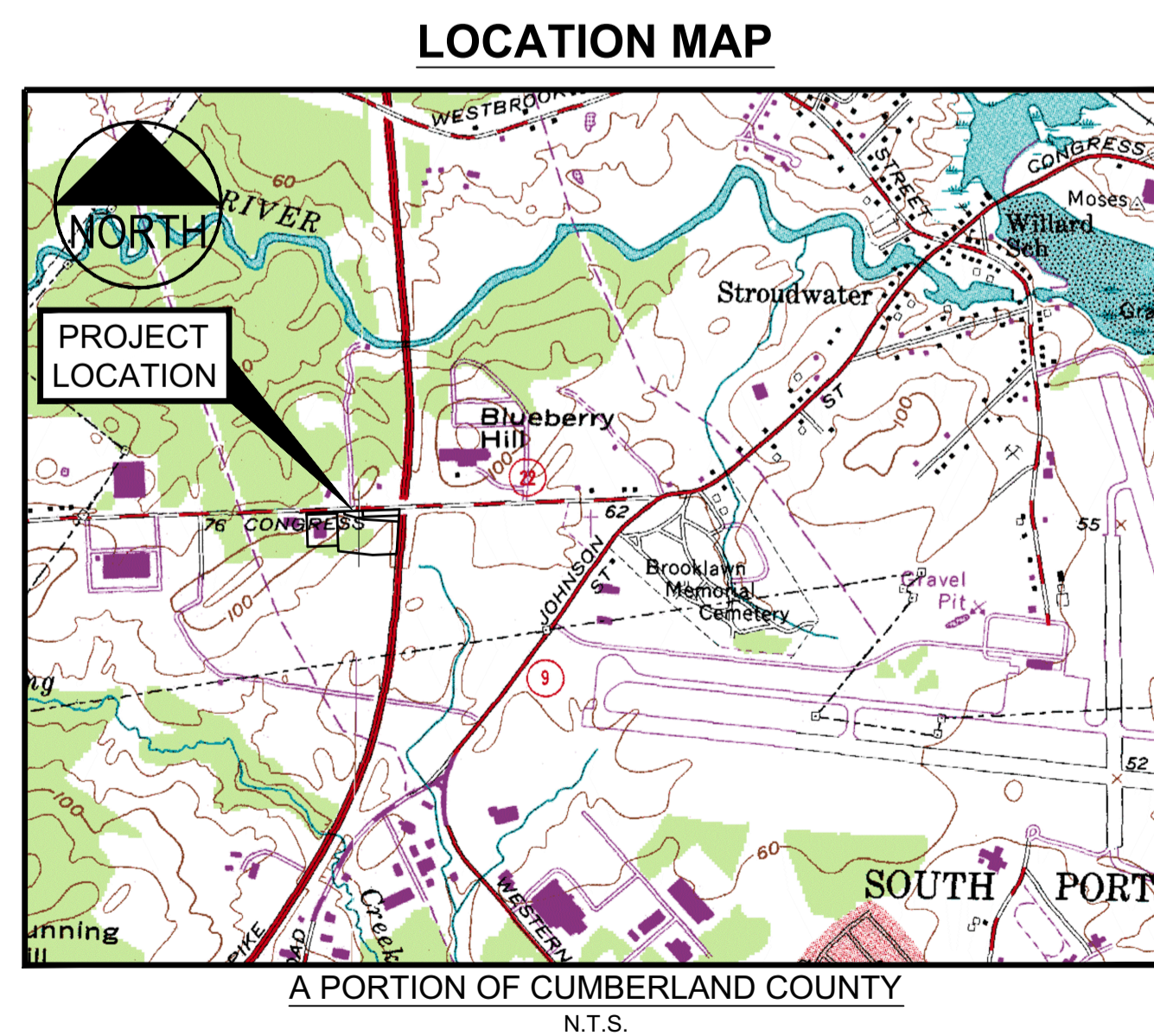

INDEX

C-1.0 OFF	COVER SHEET
C-1.1 OFF	GENERAL AND CONTRACTOR'S NOTES
C-2.0 OFF	TYPICAL SECTIONS
C-3.0 OFF	EXISTING CONDITIONS AND REMOVALS PLAN
C-4.0 OFF	GENERAL IMPROVEMENTS PLAN AND PROFILE
C-5.0 OFF	SIGNAGE AND STRIPING
C-6.0 OFF	CROSS SECTIONS
C-6.1 OFF	CROSS SECTIONS
C-6.2 OFF	CROSS SECTIONS
C-6.3 OFF	CROSS SECTIONS

- NOTES:**
- ALL WORK CONTEMPLATED UNDER THIS CONTRACT SHALL BE GOVERNED BY AND IN CONFORMITY WITH THE MDOT STANDARD SPECIFICATIONS (REVISION OF DECEMBER 2002) FOR HIGHWAYS, BRIDGES, AND SUPPLEMENTALS THERETO, EXCEPT AS MODIFIED ON THE PLANS AND IN THE SPECIAL PROVISIONS AND CITY OF PORTLAND TECHNICAL CONSTRUCTION STANDARDS. EXCEPT THAT MEASUREMENT & PAYMENT FOR ALL WORK SHALL BE AT THE LUMP SUM PRICE CONTAINED IN THE BASE BID & NO OTHER OR SEPARATE PAYMENT SHALL BE MADE. NO WORK SHALL BE PERFORMED WITHIN THE MDOT ROW UNTIL WRITTEN CONSTRUCTION APPROVAL HAS BEEN ISSUED BY THE DEPARTMENT AND THE CITY OF PORTLAND.
 - MAINTENANCE OF TRAFFIC TO BE DONE PER THE LATEST EDITION OF THE MANUAL ON UNIFORM TRAFFIC CONTROL DEVICES.
 - BEST MANAGEMENT PRACTICES FOR EROSION AND SEDIMENT CONTROL AS SPECIFIED IN THE MDOT BEST MANAGEMENT PRACTICE FOR EROSION AND SEDIMENTATION CONTROL MANUAL, FEBRUARY 2008 EDITION, ARE TO BE USED AS MINIMUM STANDARD FOR EROSION AND SEDIMENT CONTROL ON THIS PROJECT.
 - FIELD MONITORING/ENGINEERING TO BE PROVIDED BY FAY, SPOFFORD & THORNDIKE

P.E. BO KENNEDY
 LIC. # 11994

No.	DATE	DESCRIPTION
2	10.27.14	ADDED TACTILE WARNING STRIP AND R.O.W. LINE PER CITY COMMENTS
1	08.05.14	SUBMITTED TO CITY OF PORTLAND