

A1
FOUNDATION PLAN

A13
FDN. PART PLAN

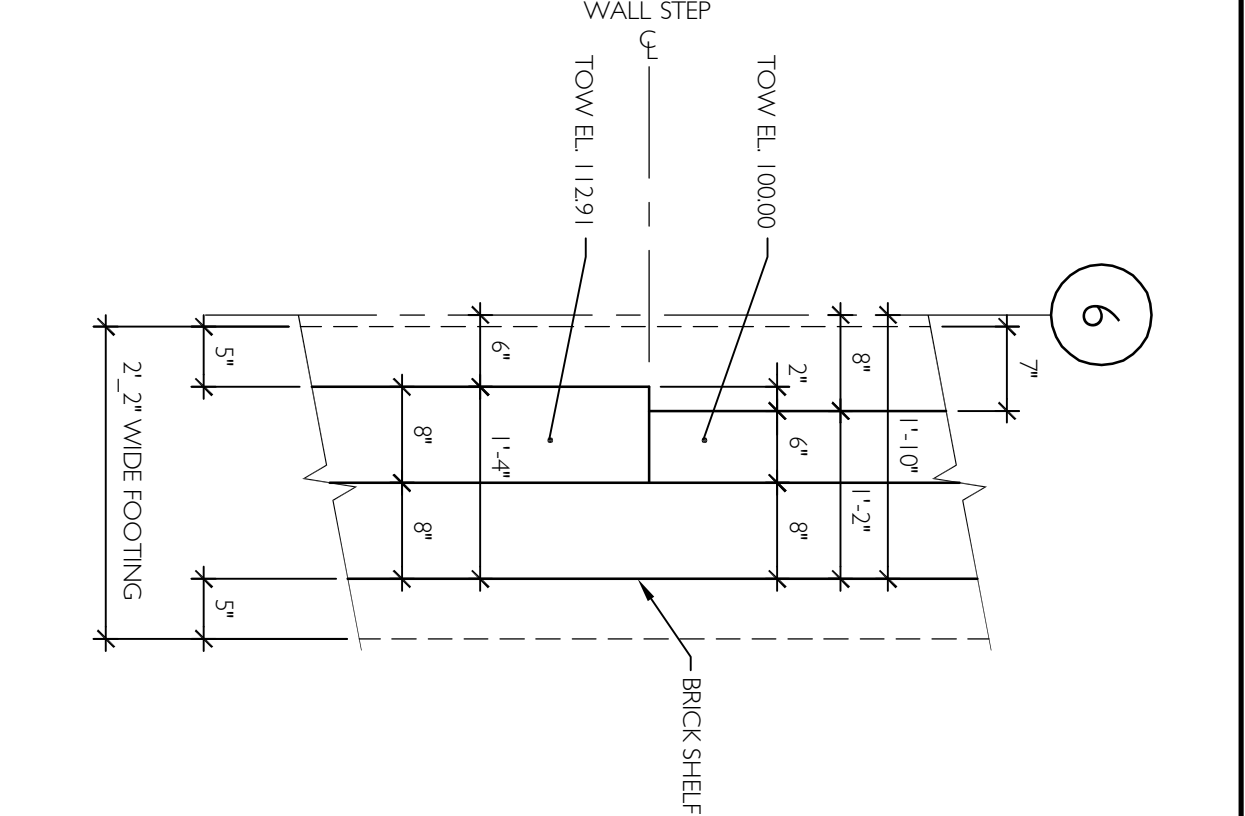

PIER TYPE	DETAIL
P1	I1 / S34
P2	I4 / S34
P3	I7 / S34
P4	I10 / S34
P5	I13 / S34
P6	F1 / S34
P7	F4 / S34
P8	F7 / S34
P9	F10 / S34

- NOTES:**
1. See Drawings S1.0 and S1.1 for additional notes and requirements.
 2. See Drawings S3.0 and S3.1 for required typical details.
 3. See A7 / S3.0 for control joint requirements in basement (contractor to lay out C/J locations not shown).
 4. Elevations specified on foundation plan are based on basement top of slab-on-grade datum EL. 1000.00'. Coordinate foundation dimensions with architectural drawings.
 5. **F4** indicates Footing Type. See E7 / S3.1 for footing schedule.
 6. Top of footing elevations (TOW*) and top of wall elevations (TOW**) shall remain constant between elevations shown.
 7. Basement foundation wall grids E / 1 to E / 6 and E / 6 to D / 6 shall not be backfilled above EL. 1000.00 until basement slab on grade and second floor composite slab have been placed.
 8. See Detail F7 / S3.3 for Underdrain Layout Plan. See A1 / S3.6 for Brick Steel Elevation Plan.
 9. **P8** indicates Pier Type. See schedule below for corresponding detail.

1/8" = 1'-0"

PROJECT TITLE:
**MAINE TURNPIKE AUTHORITY
ADMINISTRATION BUILDING**
PORTLAND, MAINE

**ISSUED FOR BIDDING / CONSTRUCTION
7-9-07**

PROJECT NORTH

This document does not supersede stamped structural document

Price Structural Engineers, Inc.

SMRT

FOUNDATION PLAN

SHEET No. **S2.0**

DATE: 7-9-07

PROJECT NO.: 06016

CAD FILE: MTA/S2.0/116-06

A/E OF RECORD: DAP

PROJECT MANAGER: SLB

PROJECT MANAGER: TOM/TDP

SCALE: 1/8" = 1'-0"

GRAPHIC SCALE: 0" 1"

REVISIONS:

NO.	DESCRIPTION	DATE
7-9-07	BIDDING/CONSTRUCTION	7-9-07