

CONNECT TO EXISTING SEWER MANHOLE FOLLOWING CITY OF PORTLAND STANDARD EXTERNAL DROP MANHOLE DETAIL. (SEE TYPICAL DETAIL, SHEET CU202.1) CORE-DRILL NEW 8" INV. IN AT ELEV. 64.00. CONNECT TO EXIST. 10" STUB AT ELEV. 59.14. CONTRACTOR SHALL VERIFY ALL EXISTING PIPE ELEVATIONS, TYPES AND CONDITION PRIOR TO BEGINNING SEWER CONSTRUCTION

PLAN
1" = 50'

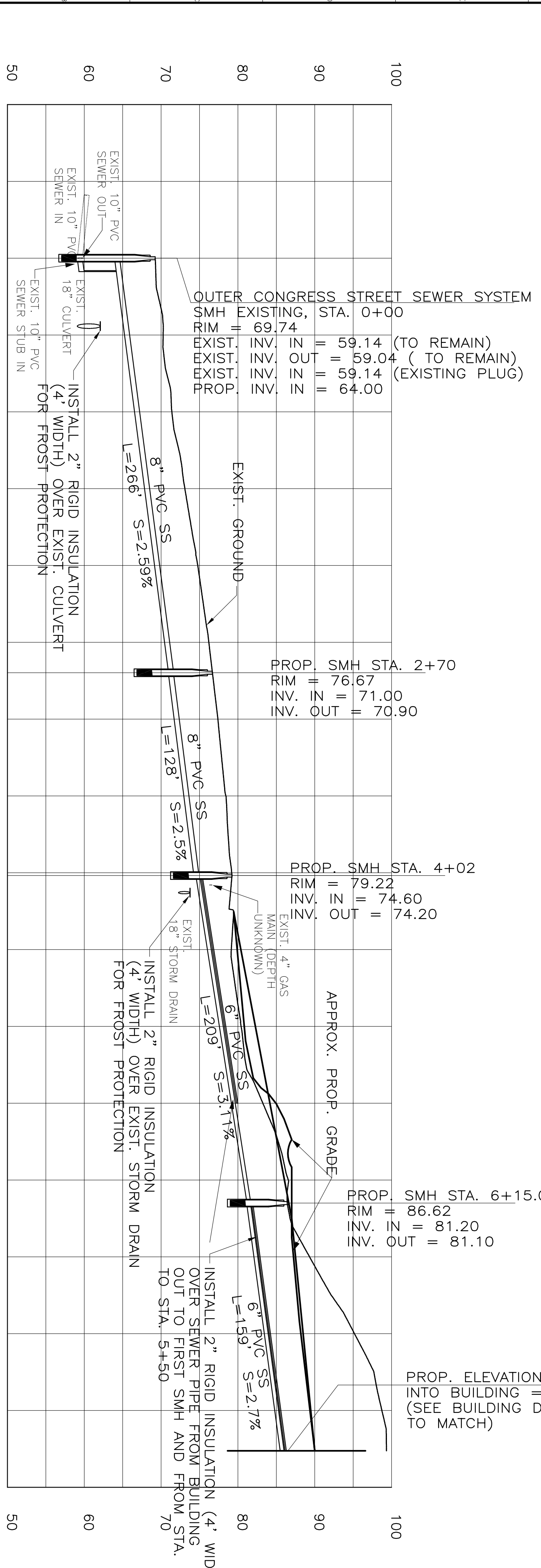

PROFILE
SCALE V: 1" = 10'
SCALE H: 1" = 50'

GENERAL NOTES FOR SEWERAGE CONSTRUCTION:

1. LOCATION OF ALL EXISTING UTILITIES ARE APPROXIMATE.
2. IT SHALL BE THE CONTRACTOR'S RESPONSIBILITY TO HAVE ALL THE UTILITIES LOCATE THEIR FACILITIES PRIOR TO THE START OF CONSTRUCTION.
3. PRIOR TO THE BEGINNING OF CONSTRUCTION, THE CONTRACTOR SHALL SECURE A STREET OPENING PERMIT FROM THE PORTLAND PUBLIC WORKS DEPARTMENT.
4. EXISTING PAVEMENT SHALL BE SAW CUT AND BUTTED TO THE NEW PAVEMENT. NO FEATHERING OF PAVEMENT WILL BE PERMITTED. THIS WORK SHALL BE CONSIDERED INCIDENTAL TO THE INSTALLATION OF SEWER PIPE IN THAT AREA. SEE TRENCH DETAILS ON SHEET CU202.
5. EXISTING DRAINAGE STRUCTURES SHALL NOT BE DISTURBED UNLESS OTHERWISE NOTED.
6. BEFORE CONNECTING NEW PIPES TO AN EXISTING SEWER MANHOLE, THE CONTRACTOR SHALL NOTIFY THE PUBLIC WORKS MAINTENANCE DIVISION OF THE PORTLAND PUBLIC WORKS DEPARTMENT. NO WORK SHALL BE DONE WITHOUT THEIR APPROVAL.
7. THE CONTRACTOR SHALL BE RESPONSIBLE FOR REPAIRING ANY TRENCH PAVEMENT THAT HAS EXPERIENCED EXCESSIVE SETTLEMENT, CRACKING, OR OPENING OF JOINTS. REPAIRS MAY INCLUDE OVERLAY, REMOVAL OF UNACCEPTABLE MATERIALS, COMPLETE REPLACEMENT, JOINT SEALING, OR REBUTTING PAVEMENT AS REQUIRED. THIS WORK MAY BE NECESSARY AFTER FINAL ACCEPTANCE OF WORK. PRIOR TO THE END OF THE UTILITY CONSTRUCTION, THIS WORK SHALL MANHOLE FRAMES SHALL BE SUPPLIED WITH SOLID MANHOLE COVERS; SEE STANDARD DETAILS.
8. ALL MANHOLE FRAMES SHALL BE SUPPLIED WITH SOLID MANHOLE COVERS; SEE STANDARD DETAILS.
9. NO ADDITIONAL PAYMENT WILL BE MADE FOR THE REMOVAL OF EXISTING PIPES.
10. PROPOSED RIM ELEVATIONS SHOWN ARE INTERPOLATED FROM PROPOSED AND EXISTING SPOTS. CONTRACTOR SHALL VERIFY ACTUAL RIM ELEVATIONS AND RELATIVE POSITION OF RIM AS SHOWN ON THE DETAILS.
11. LOCATION OF PROPOSED UTILITIES SHALL BE IN ACCORDANCE WITH THE CITY OF PORTLAND STREET DESIGN STANDARDS, AND ALL APPLICABLE INDUSTRY/UTILITY CODES.

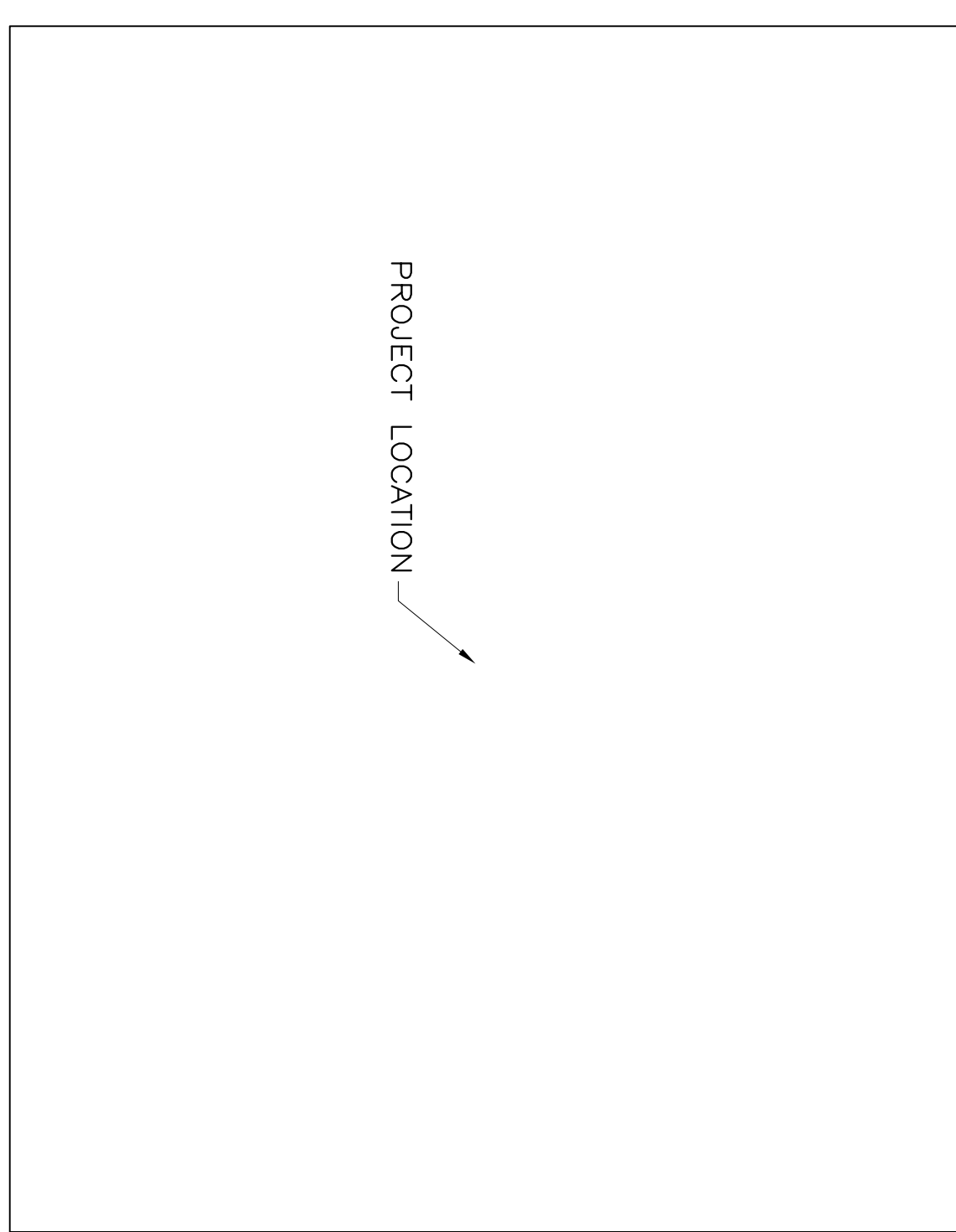

LOCUS MAP

PREPARED BY:
HNTB
ARCHITECTURE ENGINEERING PLANNING

SMRT
144 Fore Street/P.O. Box 618
Portland, Maine 04104
tel. (207) 772-3846
fax. (207) 772-1070

HNTB CORP.
2 THOMAS DRIVE
WESTBROOK, ME
04092

..011007\SMRT-logo-black.tif

PROJECT TITLE:
**MAINE TURNPIKE AUTHORITY
ADMINISTRATION BUILDING**
PORTLAND, MAINE

**ISSUED FOR BIDDING/CONSTRUCTION
7-9-07**

REV	DESCRIPTION	DATE
3	DOCS FOR OWNER REVIEW	6-11-07
2	ISSUED FOR CITY REVIEW	5-03-07
1	100% OWNER REVIEW	3-23-07
0	ISSUED FOR PERMITTING	1-16-07

GRAPHIC SCALE:
0' 1'

SCALE: AS NOTED

PROJECT MANAGER: GAB
JC/DRAWN BY: MFC
A/E OF RECORD: GAB
CAD FILE: X

PROJECT NO.: 2007.07
DATE: 01/07

SHEET TITLE:
SEWER PLAN
AND PROFILE

SHEET No. **CU201**