

NOTES:
 1. CEILING MOUNTED LIGHT SUPPORTS SHALL WITHSTAND A 200 LB. DEAD LOAD (MIN. 300 LB. IF MOUNTING A MONITOR ON THE TRACK). FRAMING SHALL BE BRACED LATERALLY AND LONGITUDINALLY TO PROVIDE A RIGID AND LEVEL SUPPORT.
 2. WHERE REQUIRED BY LOCAL CODE, NON-COMBUSTIBLE MATERIALS AND/OR 5/8" FIRE CODE RATED GYP. BRD. TO WRAP THIS SUPPORT MAY BE REQUIRED FOR FIRE RATED CEILINGS. VERIFY EXACT REQUIREMENTS WITH LOCAL AUTHORITIES.
 3. THIS IS A TYPICAL INSTALLATION. CONSULT HENRY SCHEIN DENTAL EQUIPMENT SALES SPECIALIST FOR EXACT REQUIREMENTS AND SPECS OF EQUIPMENT TO BE INSTALLED ON SITE.
 4. MOUNTING MATERIALS SUPPLIED AND INSTALLED BY CONTRACTOR.

D-6 CEILING MOUNTED TRACK LIGHT
 NOT TO SCALE

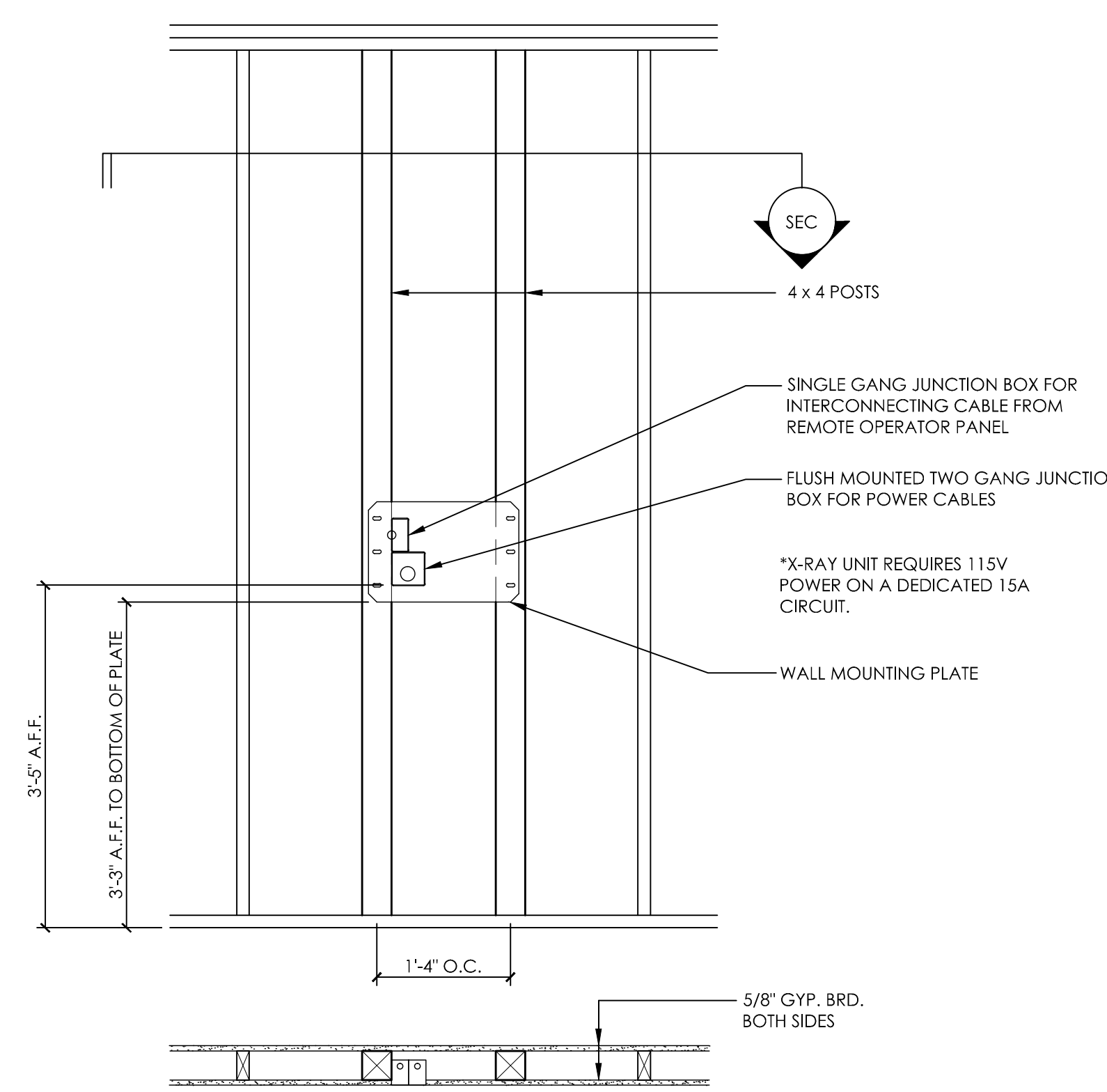

SEE MANUFACTURER'S INSTALLATION TEMPLATE FOR MORE DETAIL.
 THE WALL SUPPORT AND MOUNTING HARDWARE FOR THE UNIT MUST WITHSTAND A 100 LB. SHEAR LOAD AND A 400 LB. WITHDRAWAL FORCE AT EACH OF THE MOUNTING BOLTS. THE WALL FABRICATION AND ATTACHMENTS TO THE BUILDING STRUCTURE MUST BE CAPABLE OF WITHSTANDING A LOAD MOMENT OF 850 FT. LBS. AS OUTLINED IN THE MANUFACTURER'S INSTALLATION MANUAL.
 MOUNTING MATERIALS SUPPLIED AND INSTALLED BY CONTRACTOR.

D-9 PROGENY JB-70/PREVA X-RAY SUPPORT
 SCALE: 3/4" = 1'-0"

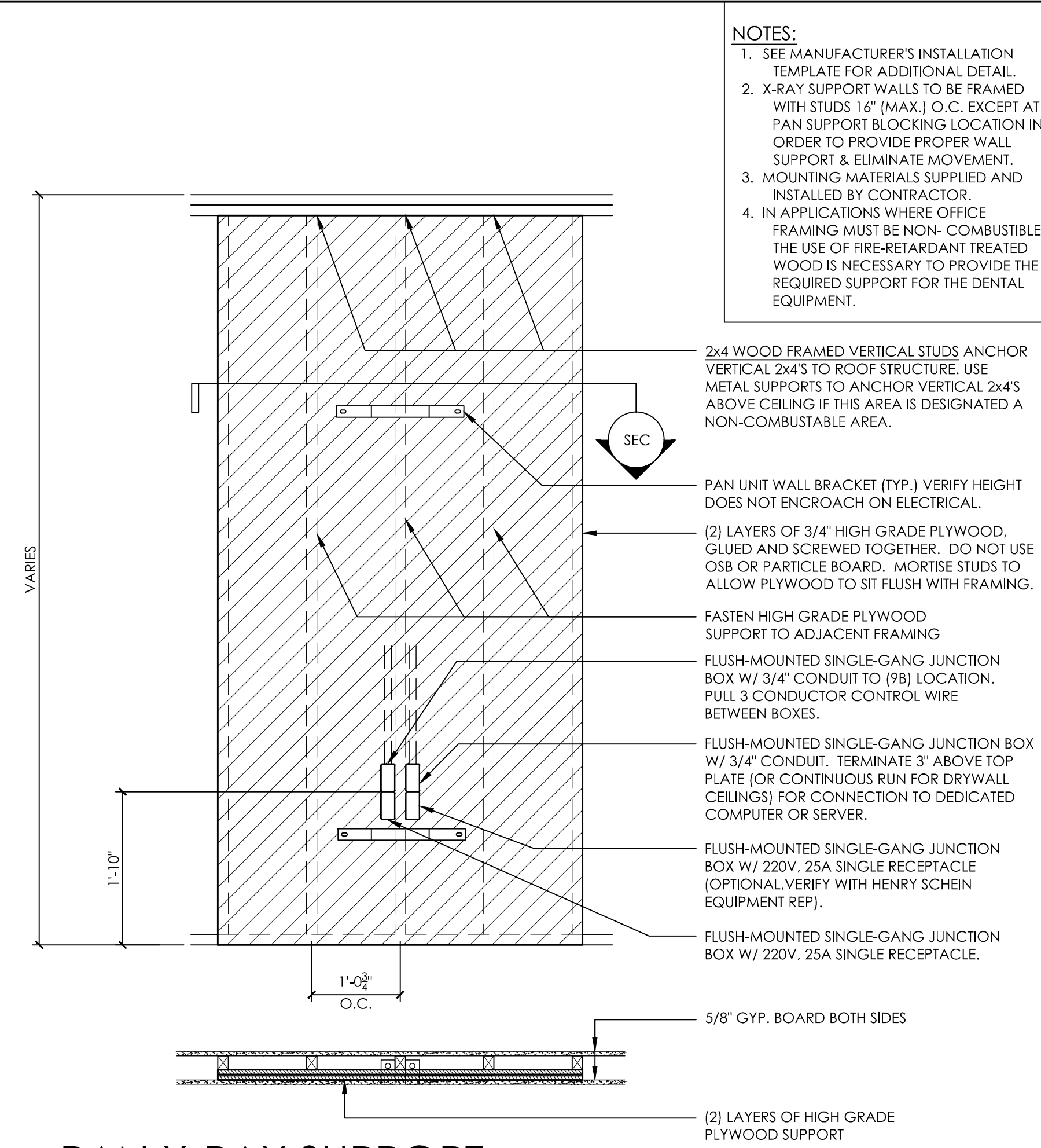

NOTES:
 1. SEE MANUFACTURER'S INSTALLATION TEMPLATE FOR ADDITIONAL DETAIL.
 2. X-RAY SUPPORT WALLS TO BE FRAMED WITH STUDS 16" (MAX.) O.C. EXCEPT AT PAN SUPPORT BLOCKING LOCATION IN ORDER TO PROVIDE PROPER WALL SUPPORT & ELIMINATE MOVEMENT.
 3. MOUNTING MATERIALS SUPPLIED AND INSTALLED BY CONTRACTOR.
 4. IN APPLICATIONS WHERE OFFICE FRAMING MUST BE NON-COMBUSTIBLE, THE USE OF FIRE-RETARDANT TREATED WOOD IS NECESSARY TO PROVIDE THE REQUIRED SUPPORT FOR THE DENTAL EQUIPMENT.

D-9C PAN X-RAY SUPPORT
 NOT TO SCALE

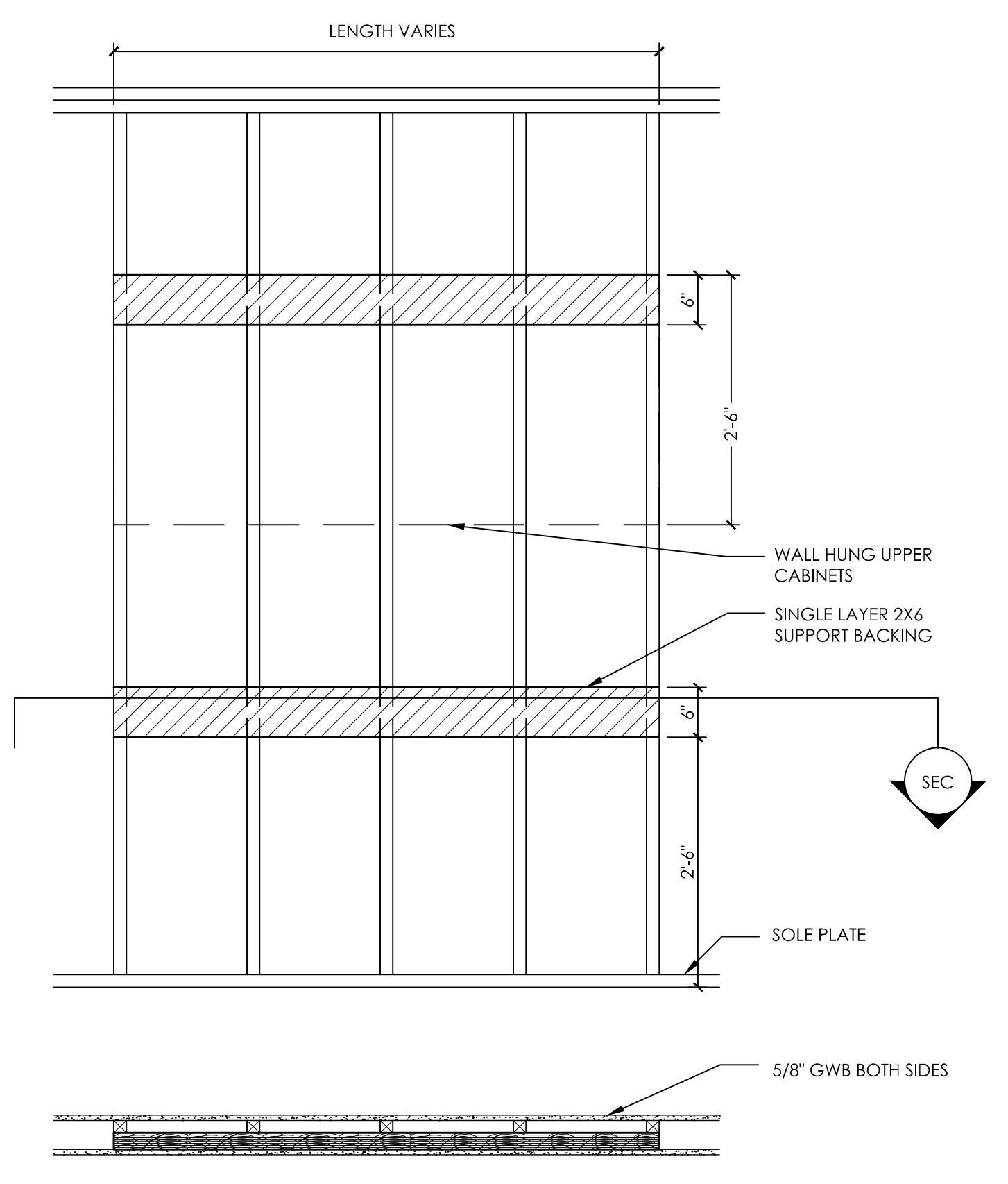

D-35 TYPICAL CABINERY BLOCKING
 SCALE: 3/4" = 1'-0"

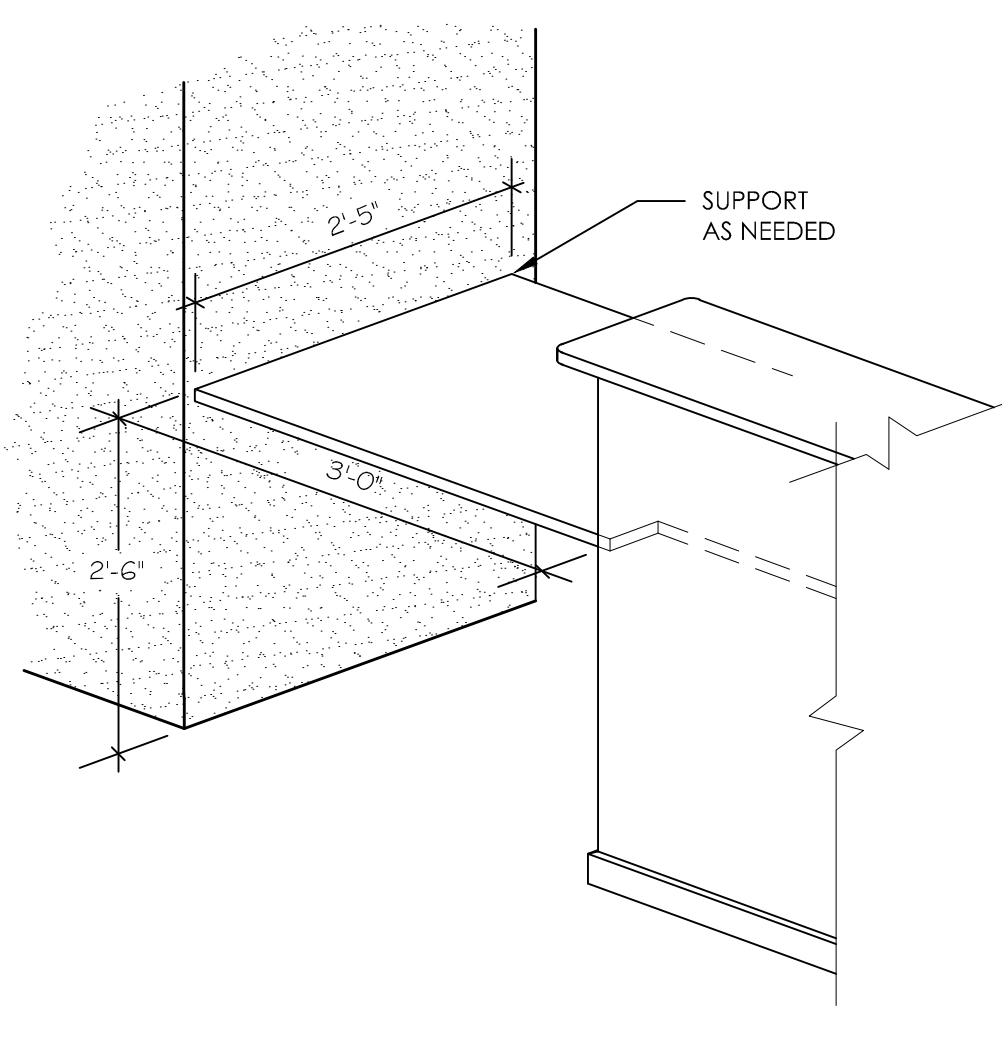

ADA ADA RECEPTION COUNTER DETAIL
 NOT TO SCALE

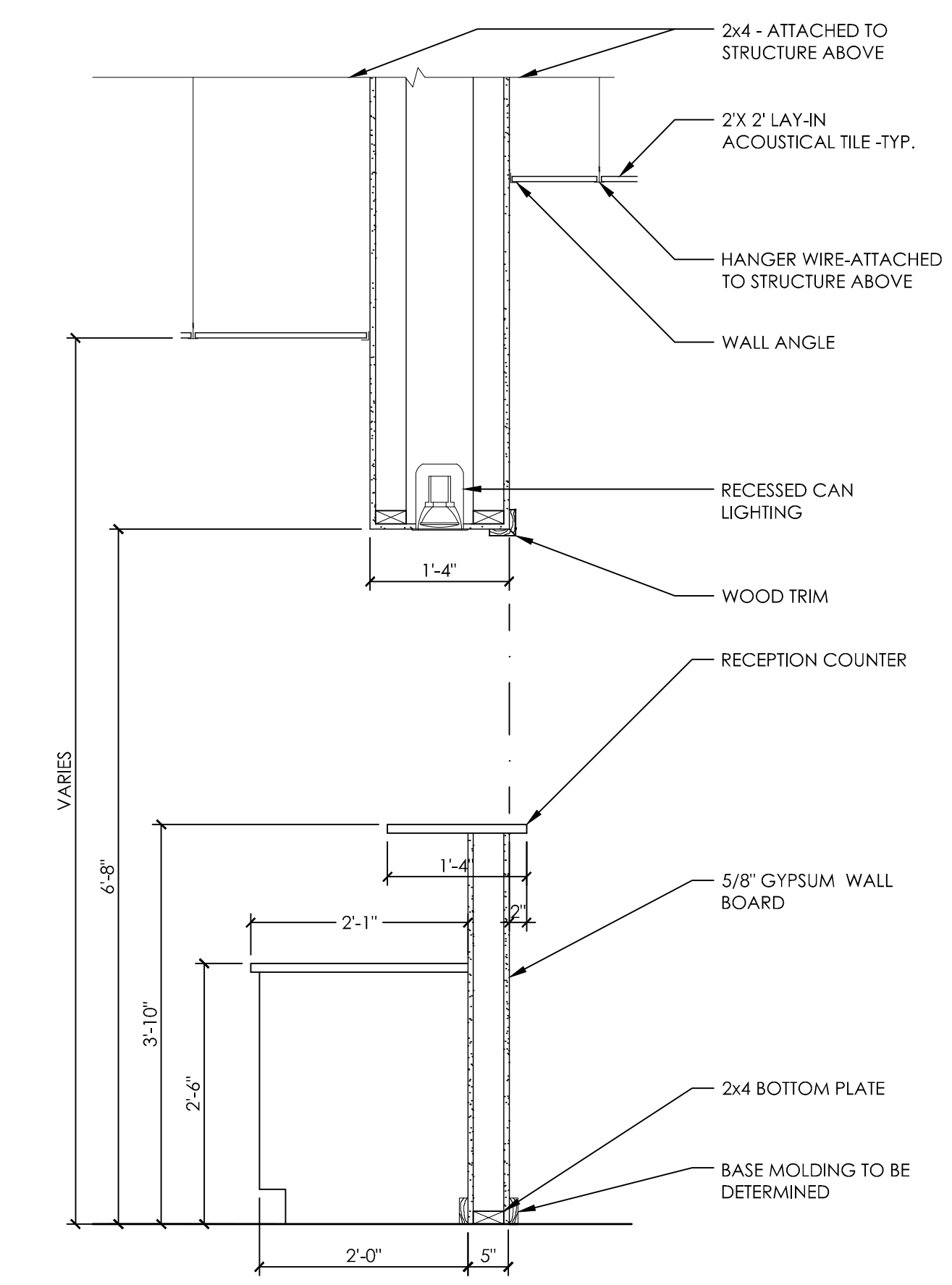

WS1 WALL SECTION AT RECEPTION
 SCALE 3/4" = 1'-0"

HENRY SCHEIN®
 DENTAL
 10920 WEST LINCOLN AVENUE
 WEST ALLIS, WI 53227

PROJECT:
PROSTHODONTIC ASSOCIATES
 LOCATION:
 131 JOHNSON ROAD
 PORTLAND, ME 04102

HENRY SCHEIN REP:
 JESSE LEVEILLE
 CENTER:
 BOSTON, MA
 PHONE #:
 (207) 233-4978

IMPORTANT NOTE:
 THIS DOCUMENT HAS BEEN PREPARED AS AN INSTRUMENT OF PROFESSIONAL SERVICE, AND IS NOT AN ARCHITECTURAL PLAN. THE IDEAS/DESIGNS INCLUDED HEREIN ARE THE SOLE PROPERTY OF HENRY SCHEIN DENTAL, AND ARE PRODUCED UNDER COPYRIGHT. THEY MAY NOT BE USED OR REPRODUCED WITHOUT EXPRESS WRITTEN CONSENT OF HENRY SCHEIN AND FULL PAYMENT OF ANY ASSOCIATED DESIGN FEES.
ALL DIMENSIONS ARE SUBJECT TO JOB-SITE VERIFICATION.

DRAWING NAME:
 PROSTHO-3d-F
 PROJECT START DATE:
 06/06/2013
 FINALS START DATE:
 08/15/2014
 DRAWN BY: AKL/CAS
 FINALS BY: AKL
 CHECKED BY: KS

REVISIONS:
 08/22/14 AKL
 10/22/14 AKL
 INT.SQ.FT. = 5167

SCALE: 3/4" = 1'-0"
 SHT. SIZE: D

CONSTRUCTION DETAILS
 SA.3