



John W. Einsiedler, R.A.
 Architecture
 148 Sea Road Kennebunk, Maine 04043
 Phone 207-985-9760 Facsimile 207-985-9818
 homepage johnw@architect.com email johnw@architect.com
 Architecture • Interior Design • Universal Design

TradesCenter Inc
 General Contractor • Design/Build
 Commercial • Industrial • Renovation

PROJECT: **440 Western Ave Associates Renovation**
 Portland/Maine
 131 Johnson Road



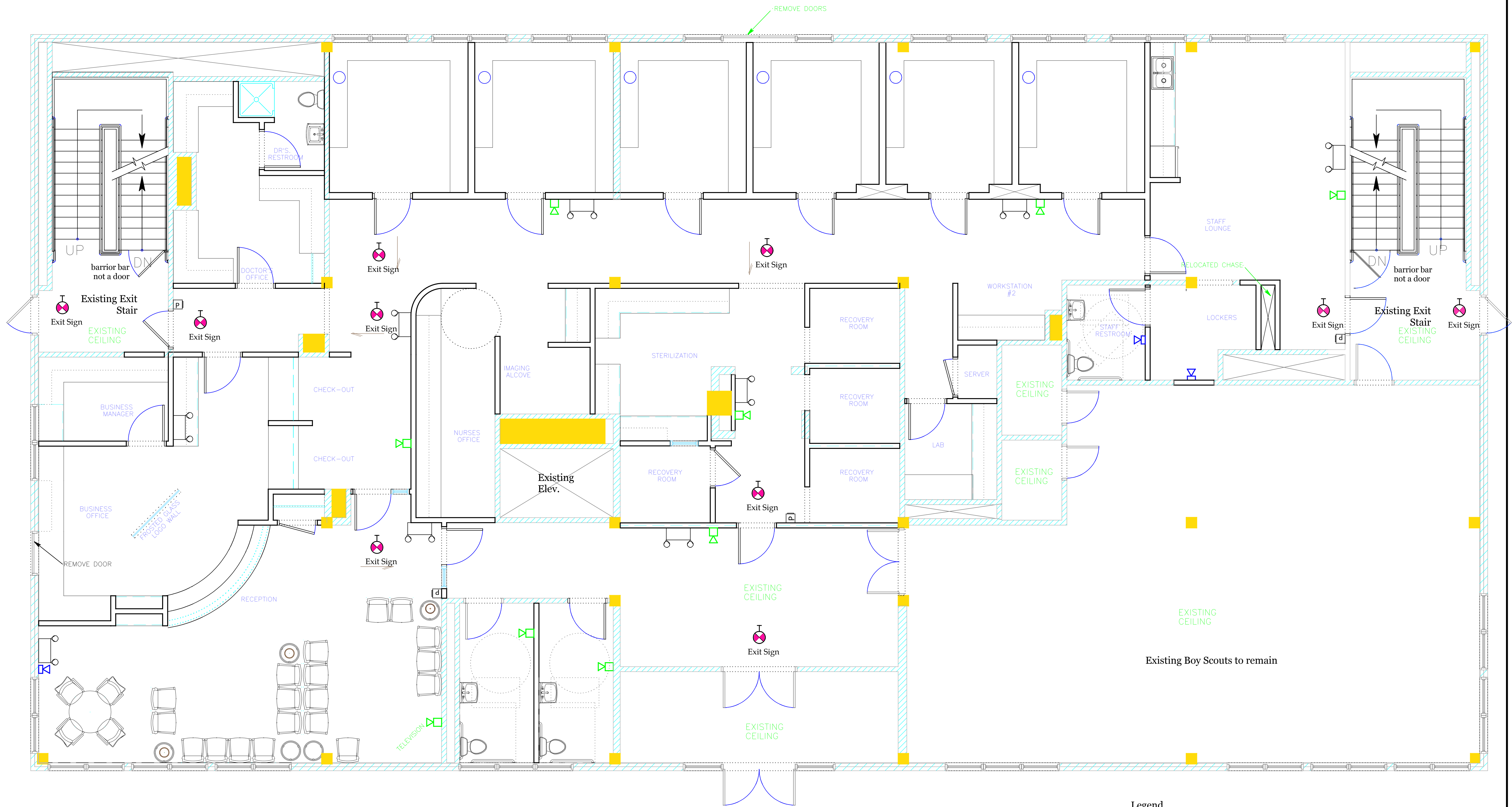

Drawings This Sheet:
FIRST FLOOR PLAN

A1

Construction Set
 December 11, 2014

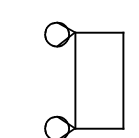

Legend

-  Emergency Light
-  H.S. Horn/Strobe
-  Strobe
-  Exit Sign
-  Pull Station

First Floor Plan
 Scale: 1/4" = 1'-0"
 NOTE: see Sheet A3 for
 Accessibility Details. All passage
 doors and openings 36", with
 lever handles.