

AZIMUTH LLC

**josef chalal
architect**
327 ocean house road
Cape Elizabeth, Maine
cell 207 318 3234
e: azimuth@maine.rr.com

Issued for Permit
August 27, 2014
revised: 9/12/2014

Tamaki, Single Family Residence
131 River's Edge Road,
Portland Maine
CBL: 229 A 045
ZD C8, Shoreland Overlay

Roof Plan

a3

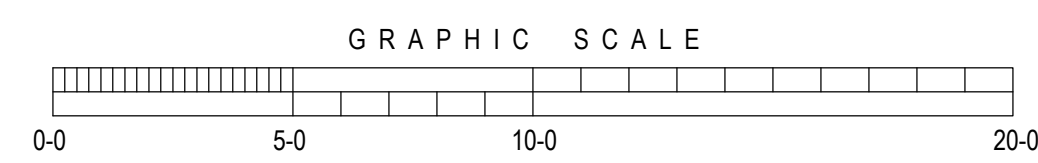
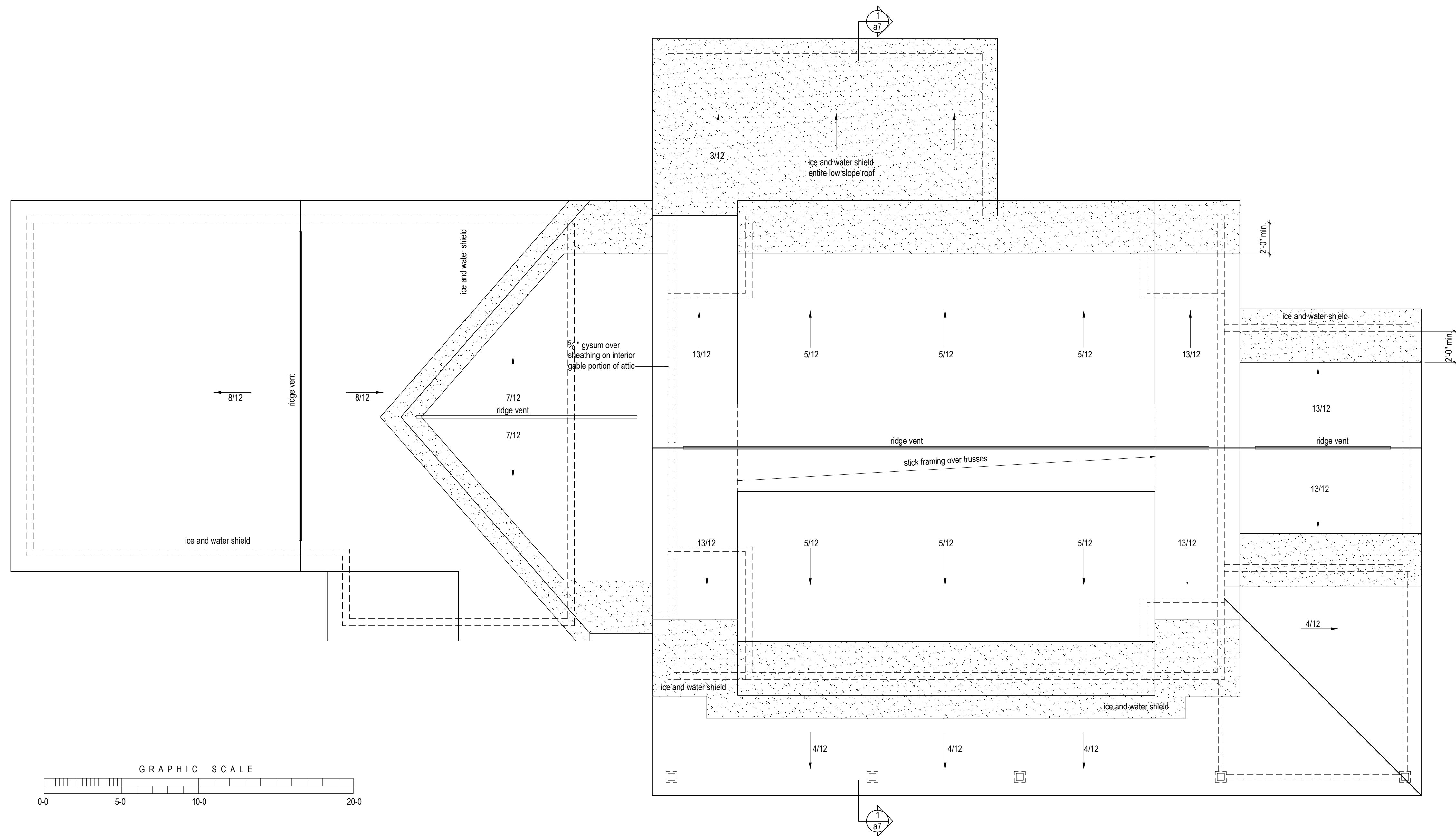

1 Roof plan
scale: 1/4" = 1'-0"