

DISPLAY THIS CARD ON PRINCIPAL FRONTAGE OF WORK CITY OF PORTLAND

BUILDING INSPECTION

PERMIT

Permit Number: 100680

PERMIT ISSUED

Please Read Application And Notes, If Any, Attached

This is to certify that ONEX COMPANY /Kevin Klin
has permission to Build a temporary ramp for disabled person owner 12 p on the front yard
AT 1700 WESTBROOK ST CBI 229 A002001 JUN 14 2010

provided that the person or persons, firm or corporation accepting this permit shall comply with all of the provisions of the Statutes of Maine and of the Ordinances of the City of Portland regulating the construction, maintenance and use of buildings and structures, and of the application on file in this department.

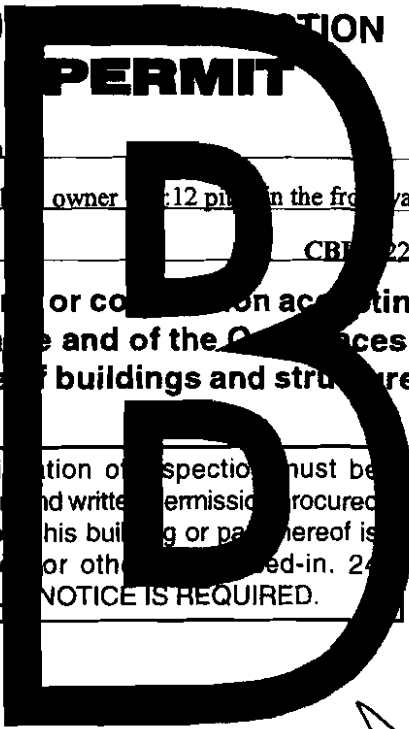

Apply to Public Works for street line and grade if nature of work requires such information.

Notification of inspection must be given and written permission procured before this building or part thereof is lathed or otherwise red-in. 24 HOUR NOTICE IS REQUIRED.

A certificate of occupancy must be procured by owner before this building or part thereof is occupied.

OTHER REQUIRED APPROVALS

Fire Dept. _____
Health Dept. _____
Appeal Board _____
Other _____
Department Name

Sam Bantz 6/14/10
Director - Building & Inspection Services

PENALTY FOR REMOVING THIS CARD

City of Portland, Maine - Building or Use Permit Application

389 Congress Street, 04101 Tel: (207) 874-8703, Fax: (207) 874-8716

Permit No: 10-0680	Issue Date: 06/14/2010	CBL: 229 A002001
-----------------------	---------------------------	---------------------

Location of Construction: 1700 WESTBROOK ST	Owner Name: ONEX COMPANY	Owner Address: 440 FOREST AVE	Phone: 775-0220
Business Name:	Contractor Name: Kevin Klingler	Contractor Address: 13 Grove St Mechanic Falls	Phone:
Lessee/Buyer's Name	Phone:	Permit Type: Additions - Dwellings	Zone: R-1

Past Use: Single Family	Proposed Use: Single Family build a temporary ramp for disabled owner at 1:12 pitch in the front yard	Permit Fee: \$50.00	Cost of Work: \$2,500.00	CEO District: 3
		FIRE DEPT: <input type="checkbox"/> Approved <input type="checkbox"/> Denied	INSPECTION: Use Group: R3 Type: SB	

Proposed Project Description:
Build a temporary ramp for disabled owner at 1:12 pitch in the front yard

Signature: _____
Signature: *JMB 6/14/10*

PEDESTRIAN ACTIVITIES DISTRICT (P.A.D.)

Action: Approved Approved w/Conditions Denied

Signature: _____ Date: _____

Permit Taken By: jmb	Date Applied For: 06/14/2010	Zoning Approval	
-------------------------	---------------------------------	------------------------	--

- This permit application does not preclude the Applicant(s) from meeting applicable State and Federal Rules.
- Building permits do not include plumbing, septic or electrical work.
- Building permits are void if work is not started within six (6) months of the date of issuance. False information may invalidate a building permit and stop all work..

Special Zone or Reviews	Zoning Appeal	Historic Preservation
<input type="checkbox"/> Shoreland	<input type="checkbox"/> Variance	<input checked="" type="checkbox"/> Not in District or Landmark
<input type="checkbox"/> Wetland	<input type="checkbox"/> Miscellaneous	<input type="checkbox"/> Does Not Require Review
<input type="checkbox"/> Flood Zone	<input type="checkbox"/> Conditional Use	<input type="checkbox"/> Requires Review
<input type="checkbox"/> Subdivision	<input type="checkbox"/> Interpretation	<input type="checkbox"/> Approved
<input type="checkbox"/> Site Plan <i>w/conditions</i>	<input type="checkbox"/> Approved	<input type="checkbox"/> Approved w/Conditions
Maj <input type="checkbox"/> Minor <input type="checkbox"/> MM <input type="checkbox"/>	<input type="checkbox"/> Denied	<input type="checkbox"/> Denied
Date: <i>JMB 6/14/10</i>	Date: _____	Date: <i>JMB</i>

PERMIT ISSUED

JUN 14 2010

City of Portland

CERTIFICATION

I hereby certify that I am the owner of record of the named property, or that the proposed work is authorized by the owner of record and that I have been authorized by the owner to make this application as his authorized agent and I agree to conform to all applicable laws of this jurisdiction. In addition, if a permit for work described in the application is issued, I certify that the code official's authorized representative shall have the authority to enter all areas covered by such permit at any reasonable hour to enforce the provision of the code(s) applicable to such permit.

SIGNATURE OF APPLICANT ADDRESS DATE PHONE

RESPONSIBLE PERSON IN CHARGE OF WORK, TITLE DATE PHONE



General Building Permit Application

If you or the property owner owes real estate or personal property taxes or user charges on any property within the City, payment arrangements must be made before permits of any kind are accepted.

Location/Address of Construction: <u>1700 Westbrodc St. Portland, ME 04102</u>		
Total Square Footage of Proposed Structure/Area <u>2410 sq. feet</u>	Square Footage of Lot <u>1 STORY</u>	
Tax Assessor's Chart, Block & Lot Chart# <u>209</u> Block# <u>A</u> Lot# <u>2</u> Book # <u>14598</u> Page # <u>346</u>	Applicant *must be owner, Lessee or Buyer* Name <u>Patricia Rogers (owner)</u> Address <u>1700 Westbrodc St. Ream</u> City, State & Zip <u>Portland, ME 04102</u>	Telephone: <u>775-0220</u>
Lessee/DBA (If Applicable)	Owner (if different from Applicant) Name Address City, State & Zip	Cost Of \$ Work: \$ <u>2,500</u> C of O Fee: \$ Total Fee: \$ <u>30.00</u>
Current legal use (i.e. single family) <u>single family</u> If vacant, what was the previous use? <u>-</u> Proposed Specific use: <u>Temporary ramp for wheel chair</u> Is property part of a subdivision? <u>no</u> If yes, please name _____ Project description: <u>A temporary wheelchair ramp with 1-12 pitch, including 3 5' x 5' rest areas. Ramp is 30' total in length ending at an 8' x 8' landing. NO section of ramp is longer than 10'. Ramp to be built with all P.T. lumber with 2' x 6" supports 16 inches on center.</u>		
Contractor's name: <u>Kevin Klingler</u> ^{12x12" concrete "castle" block footings} Address: <u>13 Grove Street Mechanic Falls, ME 04256</u> City, State & Zip: _____ Telephone: <u>461-2999</u> Who should we contact when the permit is ready: <u>Patricia Rogers</u> Telephone: <u>775-0220</u> Mailing address: <u>1700 Westbrook St. Ptk. Ream ME 04102</u>		

Please submit all of the information outlined on the applicable Checklist. Failure to do so will result in the automatic denial of your permit.

In order to be sure the City fully understands the full scope of the project, the Planning and Development Department may request additional information prior to the issuance of a permit. For further information or to download copies of this form and other applications visit the Inspections Division on-line at www.portlandmaine.gov, or stop by the Inspections Division office, room 315 City Hall or call 874-8703.

I hereby certify that I am the Owner of record of the named property, or that the owner of record authorizes the proposed work and that I have been authorized by the owner to make this application as his/her authorized agent. I agree to conform to all applicable laws of this jurisdiction. In addition, if a permit for work described in this application is issued, I certify that the Code Official's authorized representative shall have the authority to enter all areas covered by this permit at any reasonable hour to enforce the provisions of the codes applicable to this permit.

Signature: Patricia R. Ream Date: 6.14.2010

This is not a permit; you may not commence ANY work until the permit is issue

City of Portland, Maine - Building or Use Permit

389 Congress Street, 04101 Tel: (207) 874-8703, Fax: (207) 874-8716

Permit No: 10-0680	Date Applied For: 06/14/2010	CBL: 229 A002001
-----------------------	---------------------------------	---------------------

Location of Construction: 1700 WESTBROOK ST	Owner Name: ONEX COMPANY	Owner Address: 440 FOREST AVE	Phone: () 775-0220
Business Name:	Contractor Name: Kevin Klingler	Contractor Address: 13 Grove St Mechanic Falls	Phone:
Lessee/Buyer's Name	Phone:	Permit Type: Additions - Dwellings	

Proposed Use: Single Family build a temporary ramp for disabled owner at 1:12 pitch in the front yard	Proposed Project Description: Build a temporary ramp for disabled owner at 1:12 pitch in the front yard
--	--

Dept: Zoning	Status: Approved with Conditions	Reviewer: Jeanine Bourke	Approval Date: 06/14/2010
Note:	Ok to Issue: <input checked="" type="checkbox"/>		
1) This property shall remain a single family dwelling. Any change of use shall require a separate permit application for review and approval.			
2) This permit is being approved on the basis of plans submitted. Any deviations shall require a separate approval before starting that work.			
Dept: Building	Status: Approved with Conditions	Reviewer: Jeanine Bourke	Approval Date: 06/14/2010
Note:	Ok to Issue: <input checked="" type="checkbox"/>		
1) Framing shall be a minimum of 2x6, no frost protection required.			
2) Application approval based upon information provided by applicant. Any deviation from approved plans requires separate review and approval prior to work.			

Comments: 6/14/2010-jmb: Mike Rogers came in on 6/11, to get this emergency ramp in for access for parent coming home from the hospital next Wednesday. Patricia R. Came in today with the plans to build.

BUILDING PERMIT INSPECTION PROCEDURES

Please call 874-8703 or 874-8693 (ONLY)

or email: buildinginspections@portlandmaine.gov

With the issuance of this permit, the owner, builder or their designee is required to provide adequate notice to the City of Portland Inspection Services for the following inspections. Appointments must be requested 48 to 72 hours in advance of the required inspection. The inspection date will need to be confirmed by this office.

- **Please read the conditions of approval that is attached to this permit!! Contact this office if you have any questions.**
- **Permits expire in 6 months, if the project is not started or ceases for 6 months.**
- **If the inspection requirements are not followed as stated below additional fees may be incurred due to the issuance of a "Stop Work Order" and subsequent release to continue with construction.**

 X **Final inspection required at completion of work.**

The project cannot move to the next phase prior to the required inspection and approval to continue, REGARDLESS OF THE NOTICE OR CIRCUMSTANCES.

IF THE PERMIT REQUIRES A CERTIFICATE OF OCCUPANCY, IT MUST BE PAID FOR AND ISSUED TO THE OWNER OR DESIGNEE BEFORE THE SPACE MAY BE OCCUPIED.



CITY OF PORTLAND, MAINE

Department of Building Inspections

Original Receipt

6-14-2010

Received from Patricia Rogers

Location of Work 1700 Westbrook St

Cost of Construction \$ _____ Building Fee: _____

Permit Fee \$ _____ Site Fee: _____

Certificate of Occupancy Fee: _____

Total: 50

Building (U) _____ Plumbing (U) _____ Electrical (U) _____ Site Plan (U) _____

Other _____

CBL: 224-A2

Check #: CEL Total Collected \$ 50

**No work is to be started until permit issued.
Please keep original receipt for your records.**

Taken by: [Signature]

WHITE - Applicant's Copy
YELLOW - Office Copy
PINK - Permit Copy

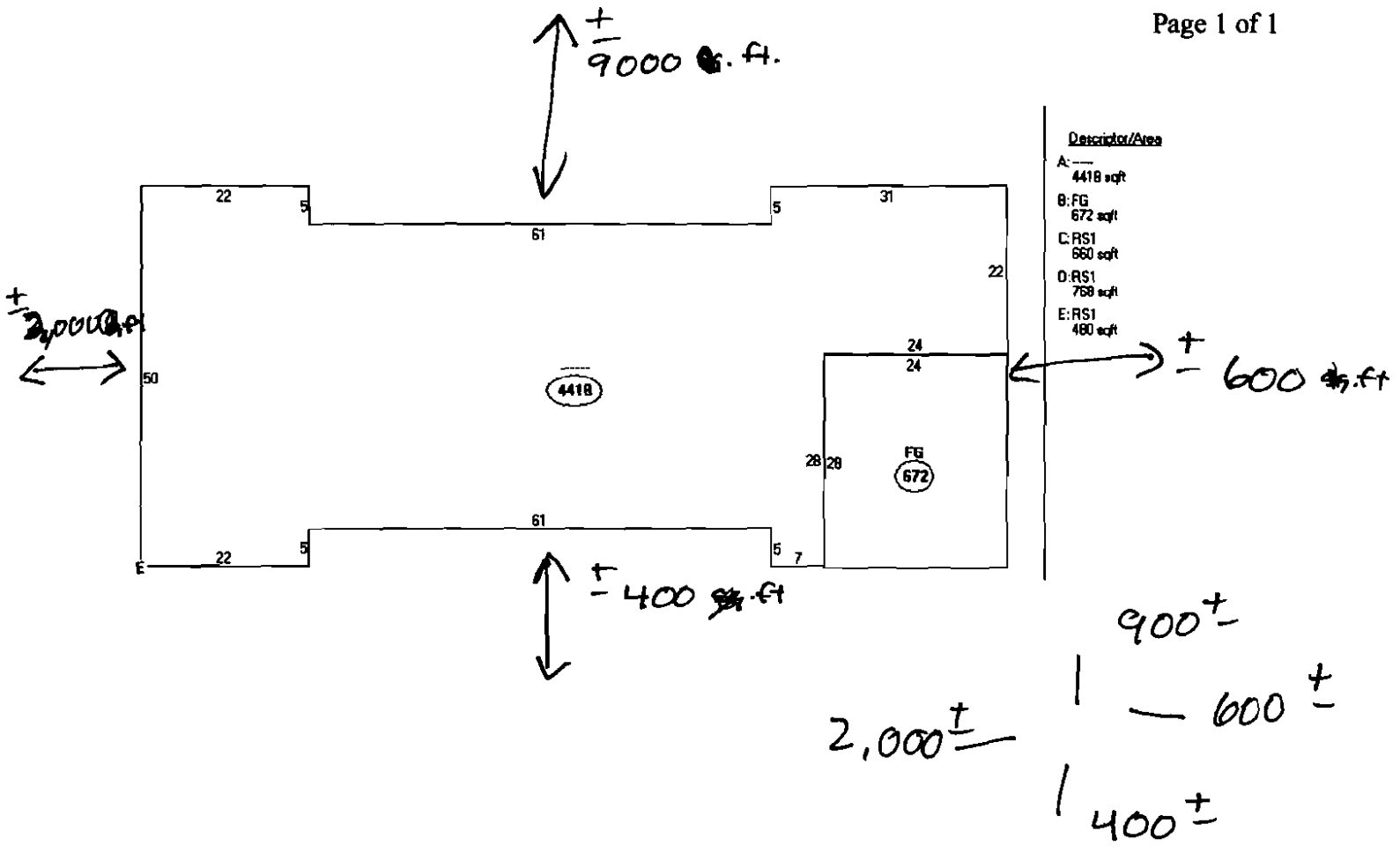

R-1 Zone Several Acres
 Front 25' Req 400' shown
 Side 12' Req 2,000 & 600'

1700 Westbrook Street
 Portland, Maine 04102



elevation "29 FRONT DOOR

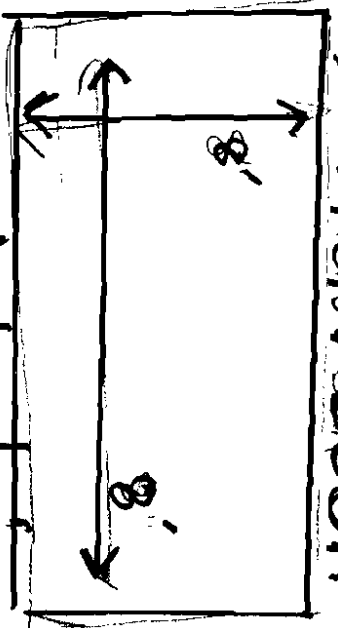

1700 Westbrook St.
Portland, ME 04102

29" grade to Landing
1:12 slope

no ~~grab~~ grabable
handrail required

← existing paved walkway
is 24"

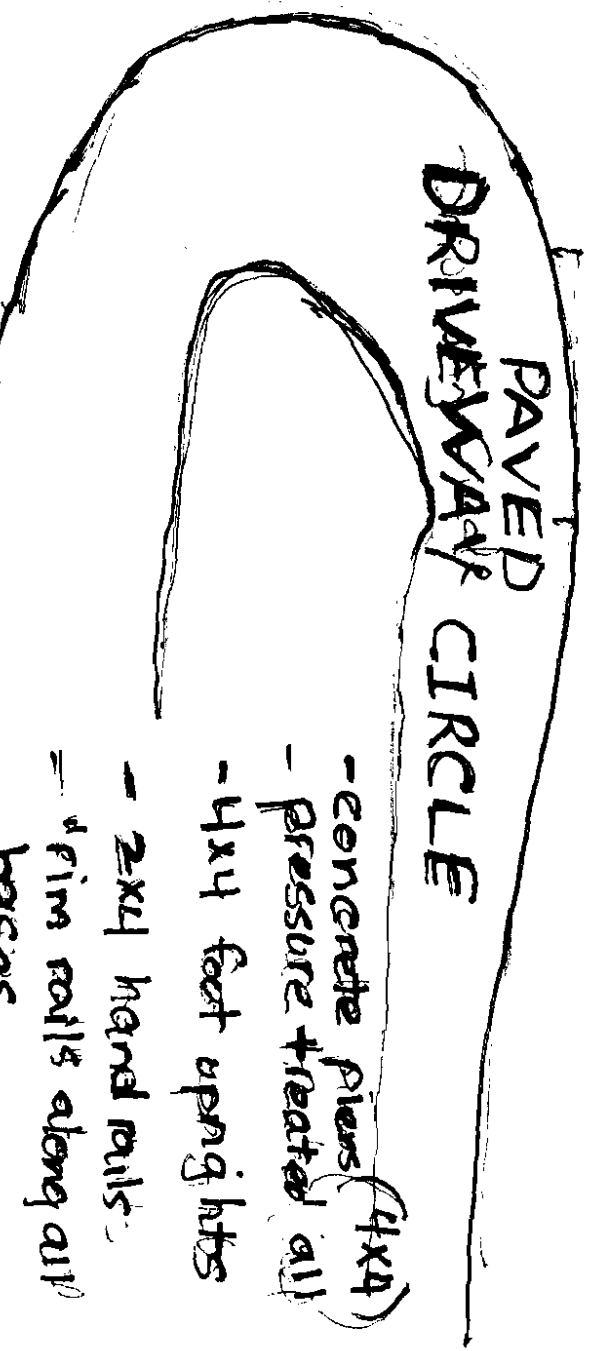
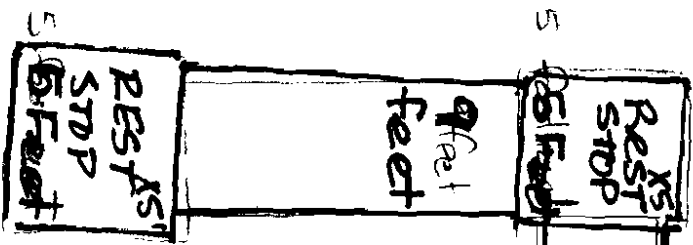

PAVED DRIVEWAY CIRCLE

- concrete piers (4x4)
- pressure treated all
- 4x4 feet uprights
- 2x4 hand rails
- 4" rim rails along all bases